

SEE SHEET 2B-2 AND 2B-3 FOR SUPERELEVATION

PROJECT REFERENCE NO.	SHEET NO.
U-5604	EC-8/CONST.5
RW SHEET NO.	
ROADWAY DESIGN ENGINEER	HYDRAULICS ENGINEER

-Y3-	-Y3-	-L-	-L-	-L-	-Y5-
PI Sta 10+70.67 Δ = 16° 45' 03.1" (RT) D = 11' 56" 11.8" L = 140.33' T = 70.67' R = 480.00' SE = EXIST. RO = SEE PLANS	PI Sta 11+90.25 Δ = 35° 55' 11.1" (LT) D = 37' 12" 18.2" L = 96.55' T = 49.92' R = 154.00' SE = SEE PLANS RO = SEE PLANS	PI Sta 28+36.16 Δ = 35° 21' 19.9" (LT) D = 8' 44" 50.8" L = 404.18' T = 208.76' R = 655.00' SE = EXIST. RO = EXIST.	PI Sta 32+22.35 Δ = 20° 33' 34.6" (RT) D = 10' 44" 58.8" L = 191.26' T = 96.67' R = 533.00' SE = SEE PLANS RO = SEE PLANS	PI Sta 35+55.95 Δ = 24° 06' 54.3" (RT) D = 15' 26" 37.0" L = 156.15' T = 79.25' R = 371.00' SE = SEE PLANS RO = SEE PLANS	PI Sta 11+77.69 Δ = 12° 24' 39.2" (RT) D = 16' 22" 12.8" L = 75.81' T = 38.06' R = 350.00' SE = SEE PLANS RO = SEE PLANS

-RBT2-	-RBT3-	-RI-
PI Sta 10+00.00 Δ = 35° 59' 21.6" (RT) D = 154' 51" 12.4" L = 232.47' T = 0.00' R = 37.00' SE = SEE PLANS RO = SEE PLANS	PI Sta 10+00.01 Δ = 35° 57' 12.8" (RT) D = 154' 51" 12.4" L = 232.45' T = 0.00' R = 37.00' SE = SEE PLANS RO = SEE PLANS	PI Sta 11+11.99 Δ = 44° 18' 58.7" (RT) D = 20' 50" 05.4" L = 212.70' T = 111.99' R = 275.00' SE = SEE PLANS RO = SEE PLANS

RELEASE FOR CONSTRUCTION
DATE FEBRUARY 5, 2018

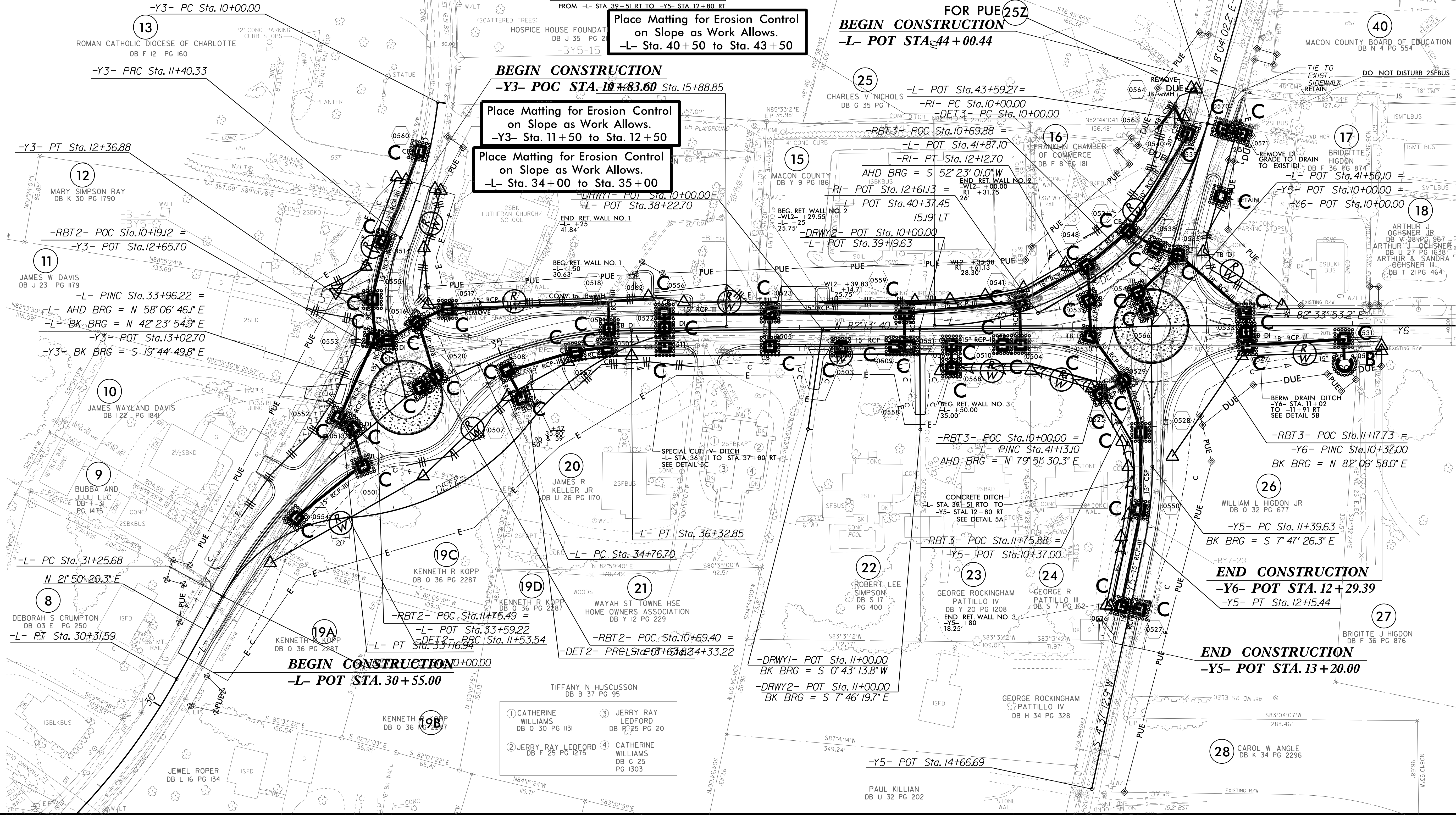
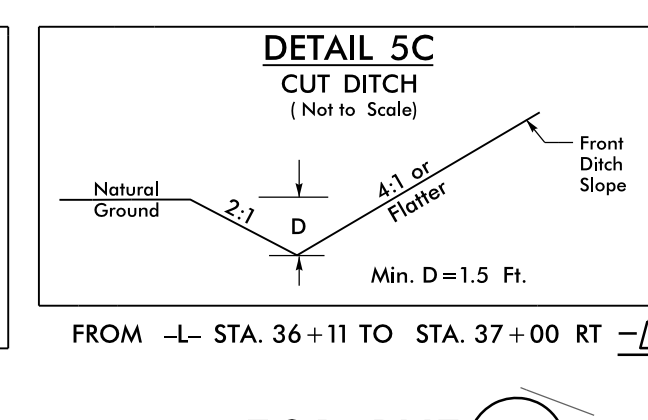
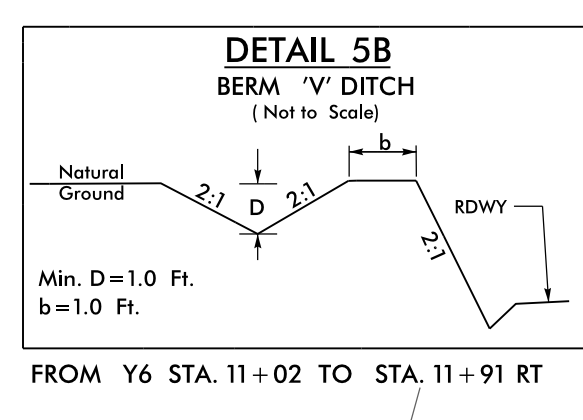
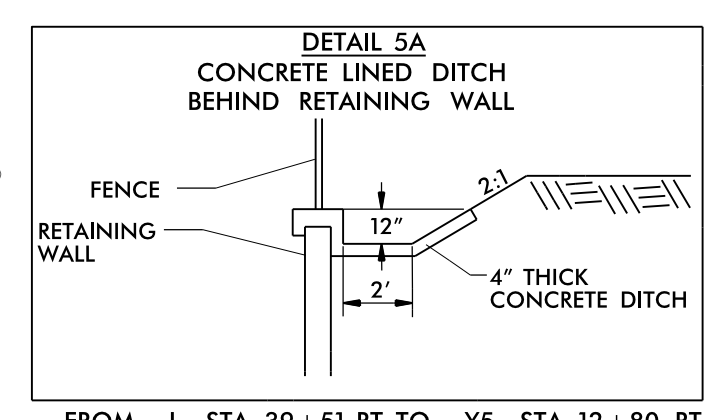

Place Matting for Erosion Control on Slope as Work Allows.
-L- Sta. 40+50 to Sta. 43+50

Place Matting for Erosion Control on Slope as Work Allows.
-Y3- STA. 11+50 to Sta. 12+50

Place Matting for Erosion Control on Slope as Work Allows.
-L- Sta. 34+00 to Sta. 35+00

FOR PUE 25Z
BEGIN CONSTRUCTION
-L- POT STA. 44+00.44

END CONSTRUCTION
-Y6- POT STA. 12+29.39
-Y5- PT Sta. 12+15.44

END CONSTRUCTION
-Y5- POT STA. 13+20.00

- 1 CATHERINE WILLIAMS DB O 30 PG 131
- 2 JERRY RAY LEDFORD DB F 25 PG 1275
- 3 JERRY RAY LEDFORD DB R 25 PG 20
- 4 CATHERINE WILLIAMS DB G 25 PG 1303

REVISIONS

8/17/19

7/13/2018 10:56:42 AM
T:\Projects\2018\U-5604_Hyd.ec.psh8.dgn