

02/03/98

| | |
|--|-----------------|
| PROJECT REFERENCE NO. U-5604 | SHEET NO. E2 |
| | |
| DOCUMENT NOT CONSIDERED FINAL UNLESS ALL SIGNATURES COMPLETED | |

- LEGEND:**
- ✕ PROPOSED ROADWAY FIXTURE (SEE LUMINAIRE SUMMARY)
 - ⊗ EXISTING ROADWAY FIXTURE (SEE LUMINAIRE SUMMARY)
 - ▽ PROPOSED ELECTRICAL SERVICE (BY OTHERS)
 - PROPOSED ELECTRICAL JUNCTION BOX (STANDARD SIZE)
 - PROPOSED (2) 2" CONDUITS FOR FUTURE USE

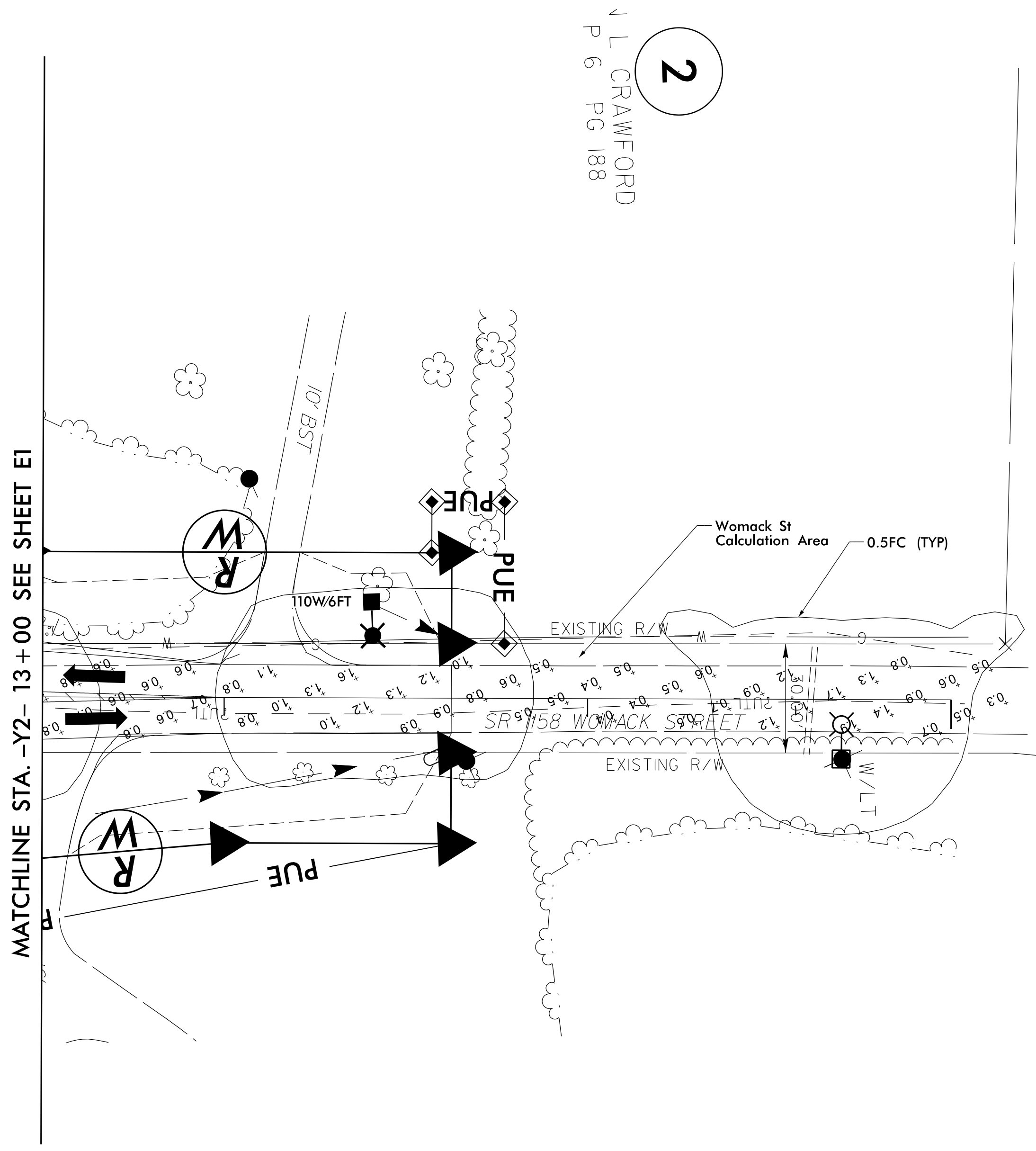
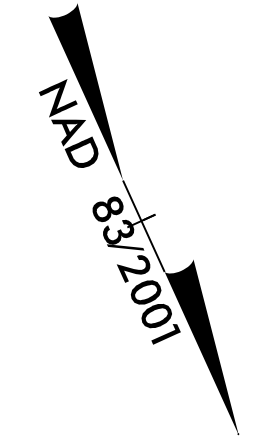

| Label | Calculation Type | Units | Target Avg | Avg | Max | Min | Target Avg/Min | Avg/Min |
|----------------------------|------------------|-------|------------|-----|-----|-----|----------------|---------|
| Georgia Rd South of Womack | Illuminance | Fc | 0.7 | 0.9 | 1.7 | 0.3 | 4.0 | 3.0 |
| Womack St | Illuminance | Fc | 0.4 | 1.1 | 2.3 | 0.3 | 6.0 | 3.6 |
| Georgia Rd North of Womack | Illuminance | Fc | 0.7 | 0.8 | 2.4 | 0.3 | 4.0 | 2.7 |
| Womack St Roundabout | Illuminance | Fc | 1.4 | 1.5 | 2.3 | 0.6 | 3.0 | 2.6 |

| Quantity | Symbol | Description | Luminaire Lumens | Total Light Loss Factor | Luminaire Watts | Arrangement | Arm Length |
|----------|--------------|---|------------------|-------------------------|-----------------|-------------|------------|
| 21 | ■✕ 110W/12FT | Proposed 110W LED Duke Roadway Fixture Mounted at 30ft on a 12ft Arm and a Direct Bury (Type A) Pole (unless otherwise noted) | 9337 | 0.85 | 108 | SINGLE | 12 |
| 2 | ■✕ 150W/12FT | Proposed 150W LED Duke Roadway Fixture Mounted at 30ft on a 12ft Arm and a Direct Bury (Type A) Pole (unless otherwise noted) | 12641 | 0.85 | 146 | SINGLE | 12 |
| 11 | ■✕ 220W/12FT | Proposed 220W LED Duke Roadway Fixture Mounted at 20ft on a 12ft Arm and a Direct Bury (Type A) Pole (unless otherwise noted) | 18641 | 0.85 | 216 | SINGLE | 12 |
| 21 | ■✕ 110W/6FT | Proposed 110W LED Duke Roadway Fixture Mounted at 30ft on a 6ft Arm and a Direct Bury (Type A) Pole (unless otherwise noted) | 9337 | 0.85 | 108 | SINGLE | 6 |
| 3 | ■✕ 150W/20FT | Proposed 150W LED Duke Roadway Fixture Mounted at 30ft on a 20ft Arm and a Direct Bury (Type A) Pole (unless otherwise noted) | 12641 | 0.85 | 146 | SINGLE | 20 |
| 6 | □⊗ | Existing 150W HPS Flat Glass Duke Roadway Fixture | 10721 | 0.69 | 193 | SINGLE | 6 |

- GENERAL NOTES:**
- CONTRACTOR TO INSTALL CONDUITS UNDER ROADWAYS AS SHOWN IN PLANS FOR FUTURE USE BY DUKE ENERGY.
 - DUKE ENERGY TO INSTALL ELECTRICAL SERVICE AND LIGHTING FIXTURES AT LOCATIONS SHOWN IN PLANS.
 - DUKE ENERGY TO DESIGN AND INSTALL LIGHTING BRANCH CIRCUITS TO PROPOSED LIGHTS.

\$\$\$SYTIME\$\$\$\$DOWN\$\$\$\$USE R/WAVE\$\$\$\$

| | | | | |
|---|--------------|-------------|----------|--|
| 2 | | | | |
| 1 | | | | |
| Rev. | Date | Description | Approved | |
| NORTH CAROLINA DEPARTMENT OF TRANSPORTATION DESIGN SERVICES LIGHTING/ELECTRICAL SECTION | | | | |
| Drawn By: | Approved By: | Dwg No.: | | |