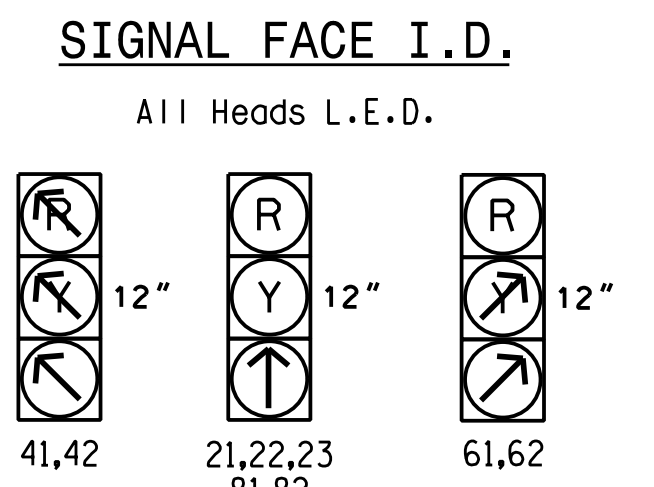

TABLE OF OPERATION

| SIGNAL FACE | PHASE | | | |
|-------------|-------|------|------|-------|
| | 02+6 | 03+8 | 04+8 | FLASH |
| 21,22,23 | | R | R | R |
| 41,42 | R | R | R | R |
| 61,62 | / | R | R | R |
| 81,82 | R | | | R |



OASIS 2070E LOOP & DETECTOR INSTALLATION CHART

| LOOP | INDUCTIVE LOOPS | | | DETECTOR PROGRAMMING | | | | | | | | |
|------|-----------------|----------------------------|-------|----------------------|-------|---------|-----------|-----------------|--------------|------------|-------------|----------|
| | SIZE (FT) | DISTANCE FROM STOPBAR (FT) | TURNS | NEW LOOP | PHASE | CALLING | EXTENSION | FULL TIME DELAY | STRETCH TIME | DELAY TIME | SYSTEM LOOP | NEW CARD |
| 2A | 6X40 | 0 | * | * | 2 | Y | Y | - | - | - | - | * |
| 2B | 6X40 | 0 | * | * | 2 | Y | Y | - | - | - | - | * |
| 2C | 6X40 | 0 | * | * | 2 | Y | Y | - | - | - | - | * |
| 4A | 6X40 | 0 | * | * | 3/4 | Y | Y | - | - | - | - | * |
| 6A | 6X6 | 300 | * | * | 6 | - | Y | - | 2.4 | - | - | * |
| 6B | 6X6 | 300 | * | * | 6 | - | Y | - | 2.4 | - | - | * |
| 6C | 6X40 | 0 | * | * | 6 | Y | Y | - | - | - | - | * |
| 6D | 6X40 | 0 | * | * | 6 | Y | Y | - | - | - | - | * |
| 8A | 6X40 | 0 | * | * | 8 | Y | Y | - | - | - | - | * |
| 8B | 6X40 | 0 | * | * | 8 | Y | Y | - | - | - | - | * |

- ### 3 Phase Fully Actuated Gilead Road Closed Loop System
- #### NOTES
- Refer to "Roadway Standard Drawings NCDOT" dated January 2018 and "Standard Specifications for Roads and Structures" dated January 2018.
 - Do not program signal for late night flashing operation unless otherwise directed by the Engineer.
 - Omit phase 4 during phase 2+6 on.
 - Program controller to clear from phase 2+6 to phase 4 by progressing through phase 3.
 - Omit phase 3 during phase 4 on.
 - Phase 3 provides red clearance time for vehicles traveling Eastbound on Gilead Rd.
 - Set all detector units to presence mode.
 - Reposition existing signal heads numbered 61 and 62.
 - Program all phases for "Red Rest".
 - Incorporate Video Detection system for vehicle detection.
 - Provide the Engineer with the Manufacturer's approved Video Detection locations and mounting heights to obtain detection zones as shown.
 - Maximum times shown in timing chart are for free-run operation only. Coordinated signal system timing values supersede these values.
 - Closed loop system data: Controller Asset #1106

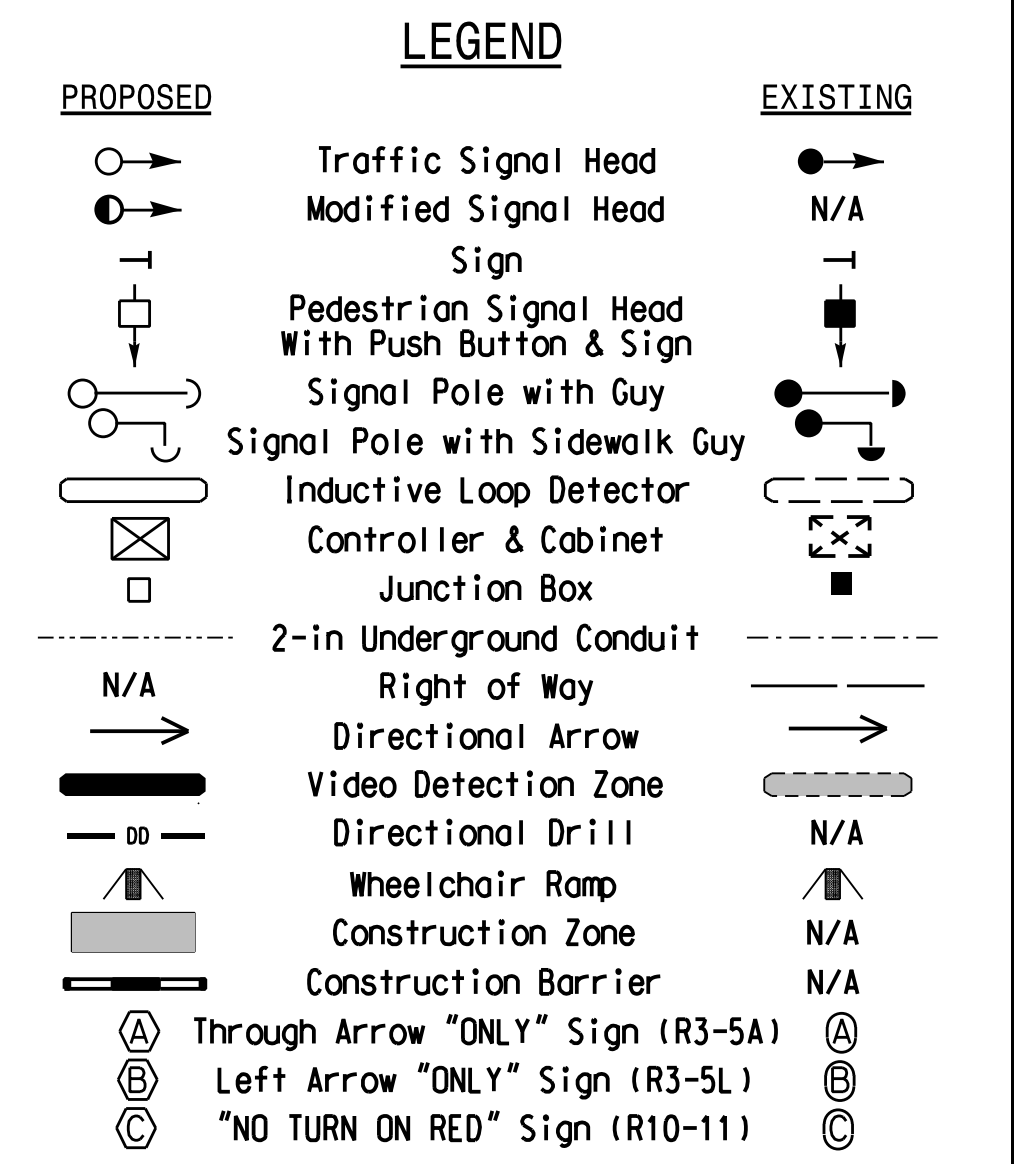

OASIS 2070E TIMING CHART

| FEATURE | PHASE | | | | |
|-------------------------|-------|-----------|-----|-----|-----|
| | 2 | 3 (DUMMY) | 4 | 6 | 8 |
| Min Green 1 * | 10 | 1 | 10 | 10 | 10 |
| Extension 1 * | 2.0 | 0.0 | 2.0 | 2.0 | 2.0 |
| Max Green 1 * | 60 | 1 | 60 | 60 | 60 |
| Yellow Clearance | 3.7 | 3.0 | 3.0 | 4.3 | 4.1 |
| Red Clearance | 1.4 | 3.8 | 4.2 | 1.9 | 3.1 |
| Red Revert | 5.0 | 5.0 | 5.0 | 5.0 | 5.0 |
| Walk 1 * | - | - | - | - | - |
| Don't Walk 1 | - | - | - | - | - |
| Seconds Per Actuation * | - | - | - | - | - |
| Max Variable Initial * | - | - | - | - | - |
| Time Before Reduction * | - | - | - | - | - |
| Time To Reduce * | - | - | - | - | - |
| Minimum Gap | - | - | - | - | - |
| Recall Mode | - | - | - | - | - |
| Vehicle Call Memory | - | - | - | - | - |
| Dual Entry | ON | ON | ON | ON | ON |
| Simultaneous Gap | ON | ON | ON | ON | ON |

* These values may be field adjusted. Do not adjust Min Green and Extension times for phases 2 and 6 lower than what is shown. Min Green for all other phases should not be lower than 4 seconds.

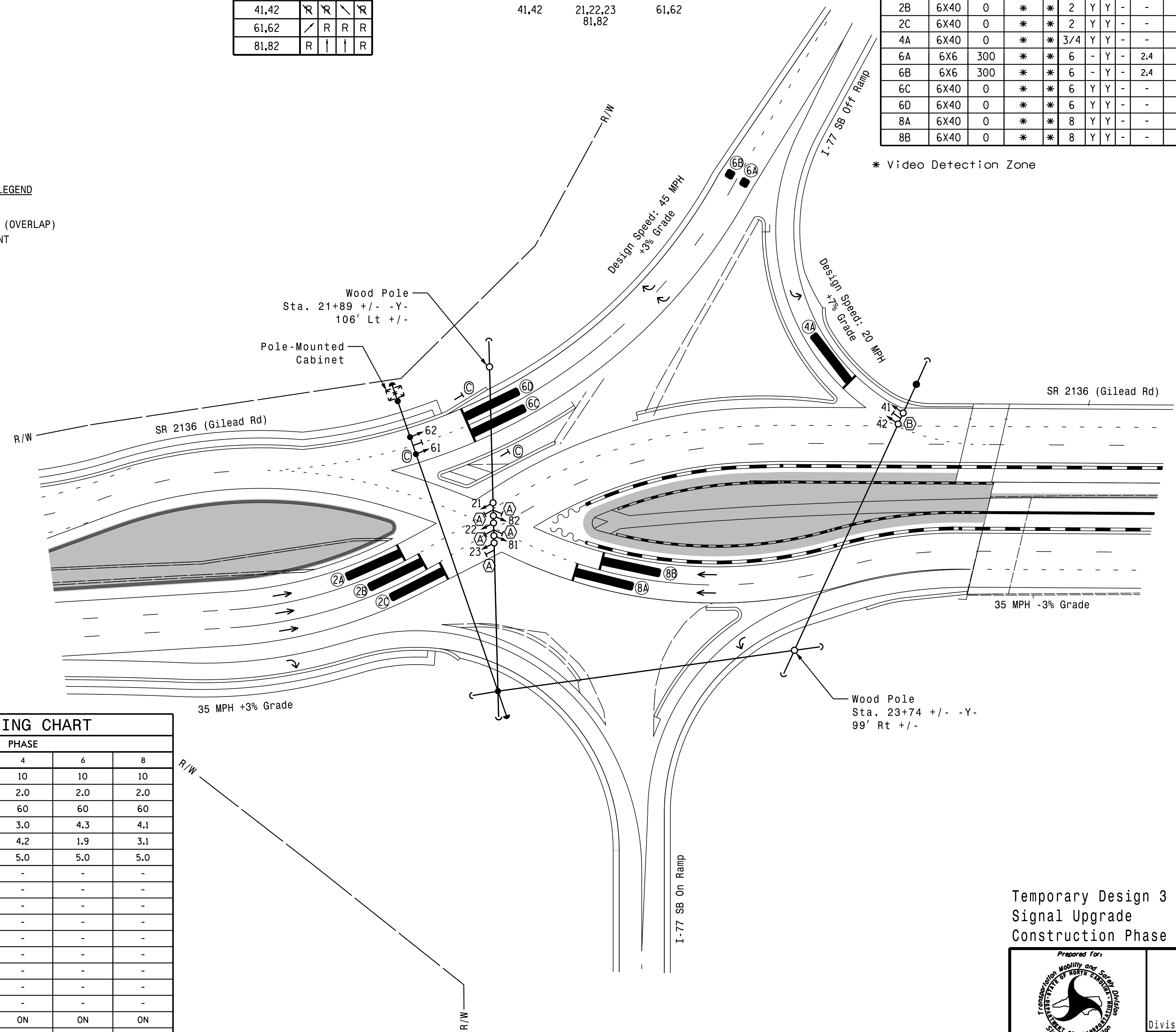

Temporary Design 3
Signal Upgrade
Construction Phase IV

DOCUMENT NOT CONSIDERED FINAL UNLESS ALL SIGNATURES COMPLETED

| | | | |
|-----------------------------|---------------------------------------------------------------------------------------------------|-------------------------------------------------------|--|
| | SR 2136 (Gilead Road) at I-77 SB Ramps | | |
| | Division 10 Mecklenburg Co., Huntersville PLAN DATE: December 2017 REVIEWED BY: A.D. Klinksiek | PREPARED BY: A.H. Thornburg REVIEWED BY: N.R. Simmons | |
| SCALE: 0" = 40' 1" = 40' | | REVISIONS: | |

HNTB HNTB NORTH CAROLINA, P.C.
343 E. Six Forks Road, Suite 200
Raleigh, North Carolina 27609
NC License No: C-1554
(919) 546-8997