

PHASING DIAGRAM

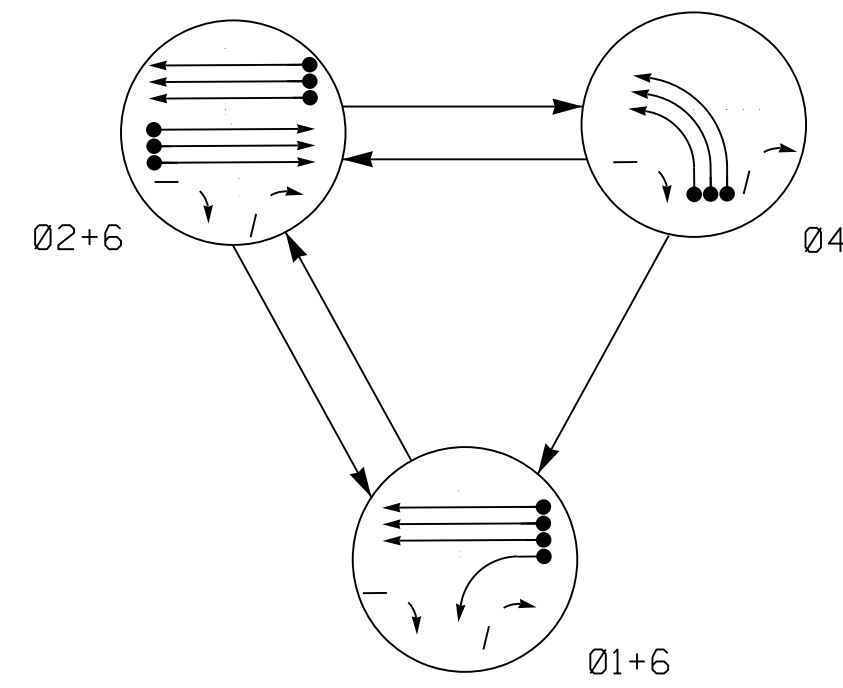

PHASING DIAGRAM DETECTION LEGEND

- DETECTED MOVEMENT
- ← UNDETECTED MOVEMENT (OVERLAP)
- UNSIGNALIZED MOVEMENT
- ⚡ PEDESTRIAN MOVEMENT

SIGNAL FACE	PHASE			
	01+6	02+6	04	FLASH
11	←	←	←	←
21,22,23	R	G	R	Y
41,42,43	←	←	←	←
61,62,63	G	G	R	Y

SIGNAL FACE I.D.

All Heads L.E.D.

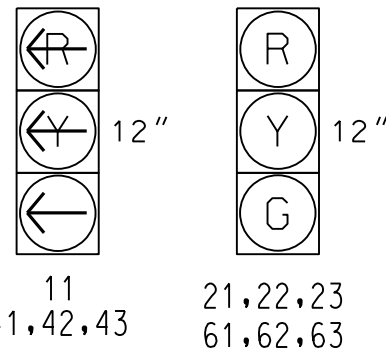

ASC/3 DETECTOR INSTALLATION CHART													
DETECTOR				PROGRAMMING									
LOOP	SIZE (FT)	DISTANCE FROM STOPBAR (FT)	TURNS	NEW LOOP	PHASE	CALLING	USE ADDED INITIAL	EXTEND TIME	DELAY TIME	USE ADDED INITIAL	TYPE	SYSTEM LOOP	NEW CARD
1A	6X40	0	*	-	1	Yes	-	-	-	-	S	-	X
2A	6X6	300	*	-	2	Yes	X	-	-	-	N	-	X
2B	6X6	300	*	-	2	Yes	X	-	-	-	N	-	X
2C	6X6	300	*	-	2	Yes	X	-	-	-	N	-	X
2D	6X40	0	*	-	2	Yes	X	2.0	5	-	G	-	X
2E	6X40	0	*	-	2	Yes	X	2.0	5	-	G	-	X
2F	6X40	0	*	-	2	Yes	X	2.0	5	-	G	-	X
4A	6X40	0	*	-	4	Yes	-	-	-	-	S	-	X
4B	6X40	0	*	-	4	Yes	-	-	-	-	S	-	X
4C	6X40	0	*	-	4	Yes	-	-	-	-	S	-	X
6A	6X6	300	*	-	6	Yes	X	-	-	-	N	-	X
6B	6X6	300	*	-	6	Yes	X	-	-	-	N	-	X
6C	6X6	300	*	-	6	Yes	X	-	-	-	N	-	X
6D	6X40	0	*	-	6	Yes	X	2.0	5	-	G	-	X
6E	6X40	0	*	-	6	Yes	X	2.0	5	-	G	-	X
6F	6X40	0	*	-	6	Yes	X	2.0	5	-	G	-	X

* Video Detection Area
Camera locations should be confirmed in the field by the contractor in order to provide detection of the areas indicated.

3 Phase Fully Actuated Fayetteville Signal System

NOTES

- Refer to "Roadway Standard Drawings NCDOT" dated January 2018 and "Standard Specifications for Roads and Structures" dated January 2018.
- Do not program signal for late night flashing operation unless otherwise directed by the Engineer.
- Phase 1 may be lagged.
- Set all detector units to presence mode.
- Locate new cabinet foundation so as not to obstruct sight distance of vehicles turning right on red. Relocate existing cabinet and controller onto new foundation.
- Maximum times shown in timing chart are for free-run operation only. Coordinated signal system timing values supersede these values.
- Field adjust temporary poles as needed.

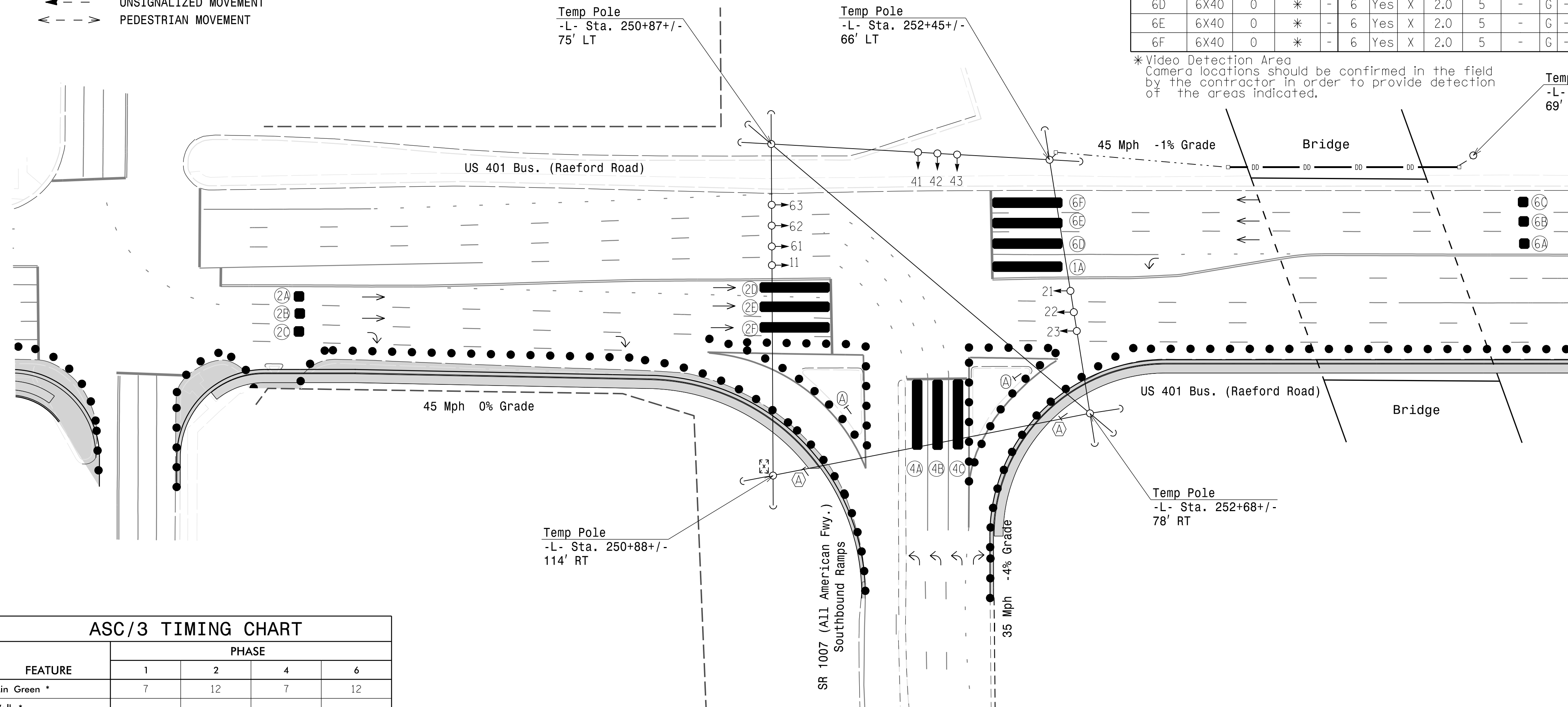

ASC/3 TIMING CHART

FEATURE	PHASE			
	1	2	4	6
Min Green *	7	12	7	12
Walk *	-	-	-	-
Ped Clear	-	-	-	-
Veh. Extension *	2.0	6.0	2.0	6.0
Max 1 *	15	60	25	60
Yellow	3.0	4.5	3.0	4.6
Red Clear	2.8	1.3	3.3	1.2
Red Revert	-	-	-	-
Actuations B4 Add *	-	-	-	-
Seconds /Actuation *	-	-	-	-
Max Initial *	-	-	-	-
Time Before Reduction *	-	15	-	15
Time To Reduce *	-	30	-	30
Minimum Gap	-	3.0	-	3.0
Locking Detector	-	-	-	-
Recall Position	-	VEH. RECALL	-	VEH. RECALL
Dual Entry	-	-	-	-
Simultaneous Gap	X	X	X	X

* These values may be field adjusted. Do not adjust Min Green and Extension times for phases 2 and 6 lower than what is shown. Min Green for all other phases should not be lower than 4 seconds.

LEGEND

- | PROPOSED | EXISTING |
|--|----------|
| ○ → Traffic Signal Head | ● → |
| ○ → Modified Signal Head | N/A |
| ○ → Sign | ○ → |
| ○ → Pedestrian Signal Head With Push Button & Sign | ○ → |
| ○ → Signal Pole with Guy | ○ → |
| ○ → Signal Pole with Sidewalk Guy | ○ → |
| □ → Inductive Loop Detector | □ → |
| □ → Controller & Cabinet | □ → |
| □ → Junction Box | □ → |
| --- 2-in Underground Conduit | --- |
| N/A → Right of Way | --- |
| → Directional Arrow | → |
| ▬ Video Detection Area | N/A |
| ▬ Construction Zone | N/A |
| ● ● ● Drums | N/A |
| (A) "YIELD" Sign (R1-2) | (A) |

Signal Upgrade Temporary Design 1 - TMP Phase I

US 401 Bus. (Raeford Road) at SR 1007 (All American Freeway) Southbound Ramps

Division 6 Cumberland County Fayetteville

PLAN DATE: March 2018 REVIEWED BY: E D Harris

PREPARED BY: J. Hambright REVIEWED BY: B L Watson

REVISIONS	INIT.	DATE

3/29/2018

SIG. INVENTORY NO. 06-032011

DOCUMENT NOT CONSIDERED FINAL UNLESS ALL SIGNATURES COMPLETED