

PROJECT REFERENCE NO.	SHEET NO.
U-4405	EC-59/CONST.22
RW SHEET NO.	HYDRAULICS ENGINEER
ROADWAY DESIGN ENGINEER	

NOTES: ANY DEVIATION FROM OPTIONS GIVEN WILL REQUIRE PRIOR APPROVAL BY ENGINEER.

ADDITIONAL EROSION CONTROL DEVICES MAY NEED TO BE INSTALLED AS DIRECTED.

INSTALL FABRIC INSERT INLET PROTECTION DEVICE IN LIEU OF ROCK INLET SEDIMENT TRAP TYPE 'C' AS DIRECTED TO AVOID PONDING OF RUNOFF IN ROADWAY OPEN TO PUBLIC TRAFFIC

-L-
 Pls Sta 257+51.40
 $\Delta s = 0' 31' 15.1''$
 $Ls = 100.00'$
 $LT = 66.67'$
 $ST = 33.33'$

Pl Sta 258+20.74
 $\Delta = 0' 45' 00.9''$ (LT)
 $D = 1' 02' 30.3''$
 $L = 72.02'$
 $T = 36.01'$
 $R = 5,500.00'$
 $SE = 0.025$

-RPB-
 Pl Sta 31+40.19
 $\Delta = 14' 06' 13.2''$ (RT)
 $D = 6' 21' 58.3''$
 $L = 221.54'$
 $T = 111.33'$
 $R = 900.00'$
 $SE = 0.08$

-AA-
 Pls Sta 37+96.65
 $\Delta s = 5' 00' 00.0''$
 $Ls = 400.00'$
 $LT = 266.77'$
 $ST = 133.43'$

NC GRID
 NAD 83/NA 2011

MATCHLINE SEE SHEET 31
 -RPB- STA 31+00

48 x 24 x 3
 1.5 inch Skimmer
 with 0.875 inch
 Orifice Diameter
 4 ft. weir
 ID 31.1

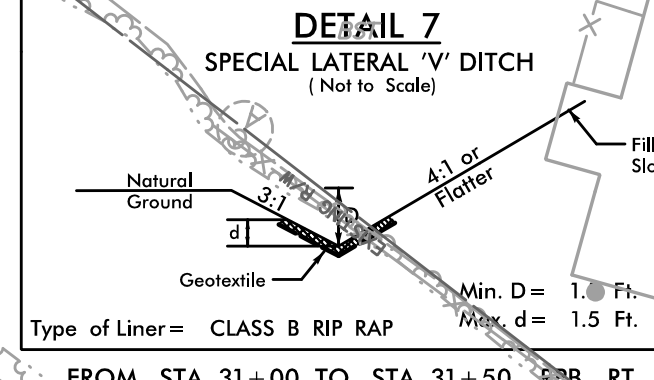

MATCHLINE SEE SHEET 21
 -L- STA 245+00

MATCHLINE SEE SHEET 23
 -L- STA 258+00

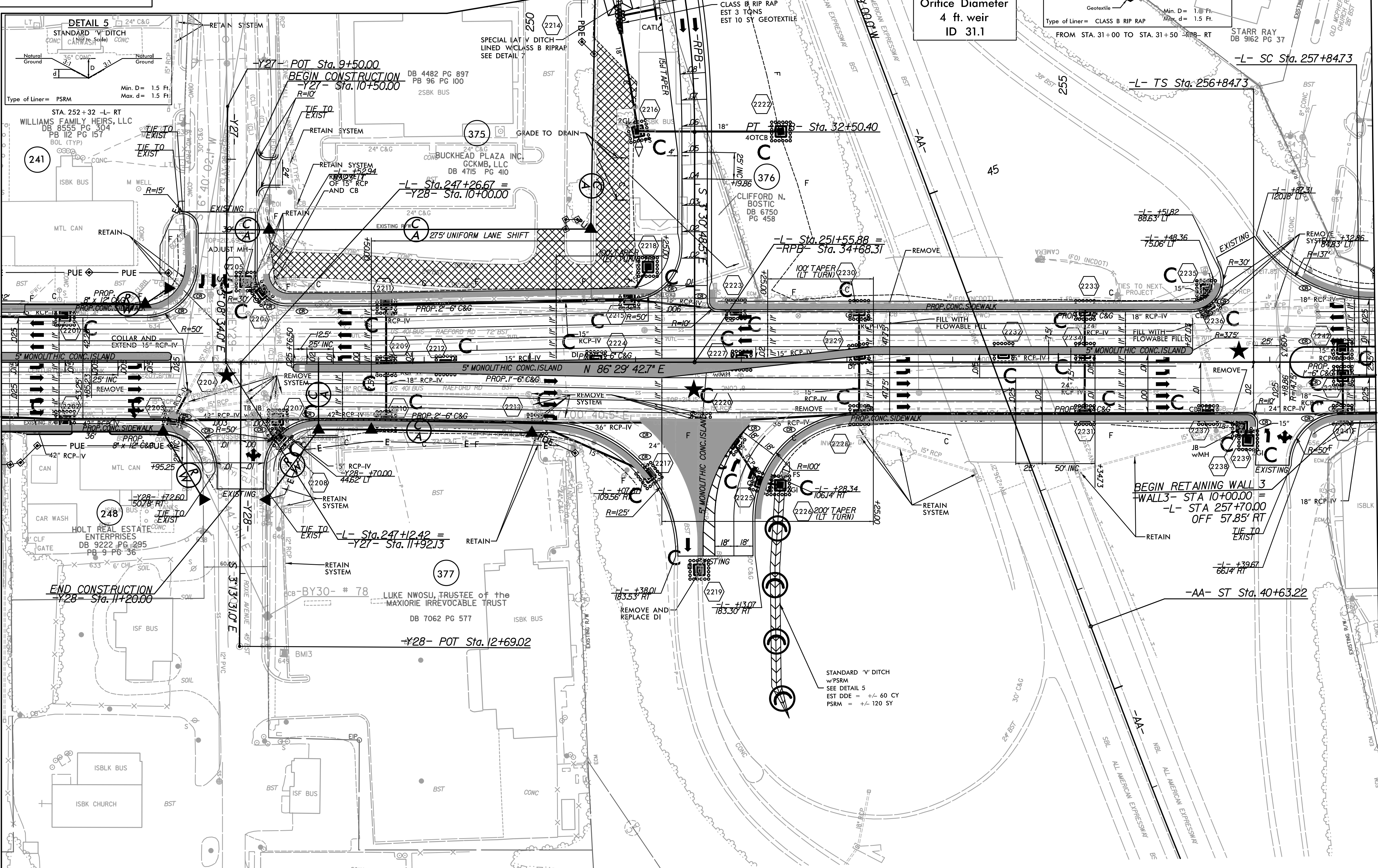

NOTE: SEE SHEET 41 FOR -L- PROFILE
 SEE SHEET 49 FOR -Y28- PROFILE
 SEE SHEET 45 FOR -RPB- PROFILE

★ PROPOSED SIGNAL
 ■ PROP CONC SIDEWALK

** A DESIGN EXCEPTION FOR LANE WIDTH IS REQUIRED FOR -L- STA. 38+95.00 TO -L- 319+95.00

8/17/99
 REVISIONS
 10:38:41 AM
 R:\Environmental\Design\4405.REU.EC.psh_22_1.mxd
 10/31/01