

PROJECT REFERENCE NO. U-4405	SHEET NO. 13
ROADWAY DESIGN ENGINEER	HYDRAULICS ENGINEER
<p>DOCUMENT NOT CONSIDERED FINAL UNLESS ALL SIGNATURES COMPLETED</p>	

-L-
 Pts Sta 139+95.56 PI Sta 144+71.01
 $\Theta_s = 1' 43' 07.9"$ $\Delta = 19' 18' 58.8" (RT)$
 $L_s = 150.00'$ $D = 2' 17' 30.6"$
 $LT = 100.00'$ $T = 842.83'$
 $ST = 50.00'$ $R = 2,500.00'$
 $SE = 0.03$

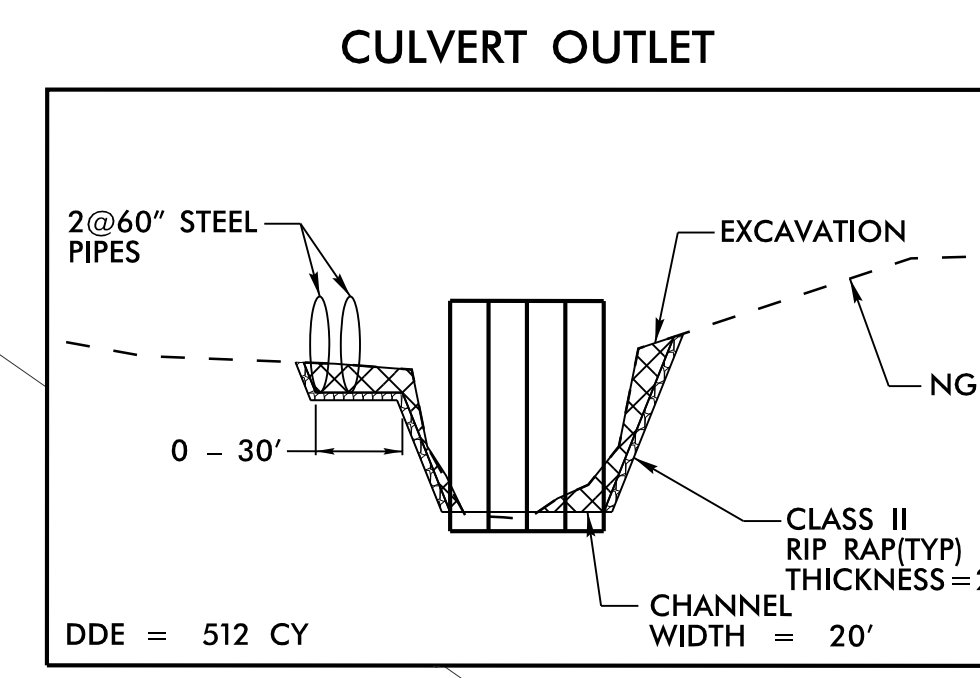
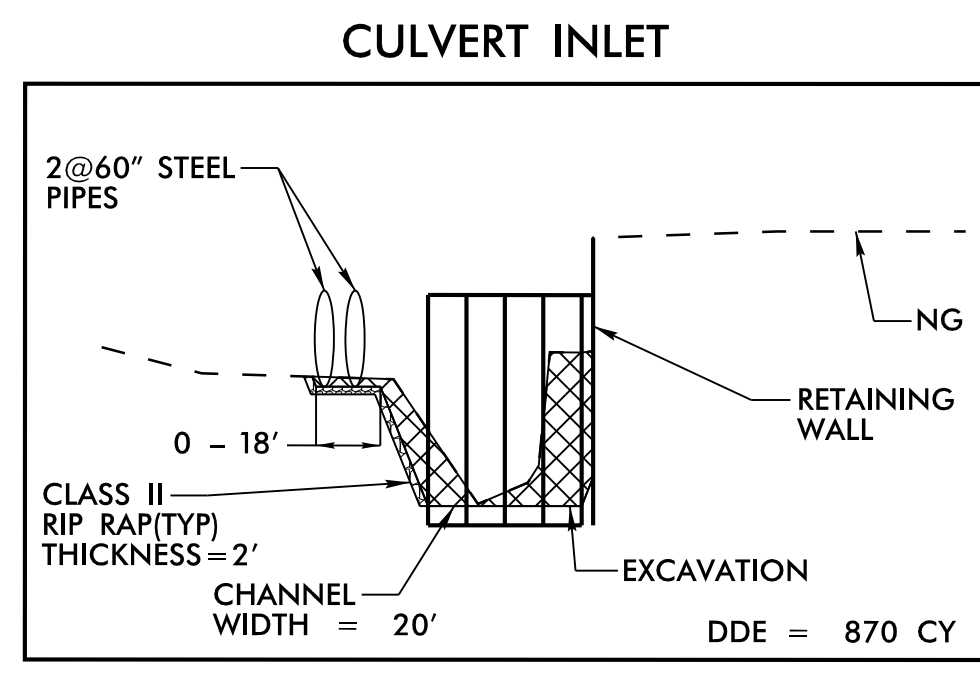

NC GRID
 NAD 83/NA 2011

MATCHLINE SEE SHEET 12
 -L- STA 128+00

MATCHLINE SEE SHEET 14
 -L- STA 141+00

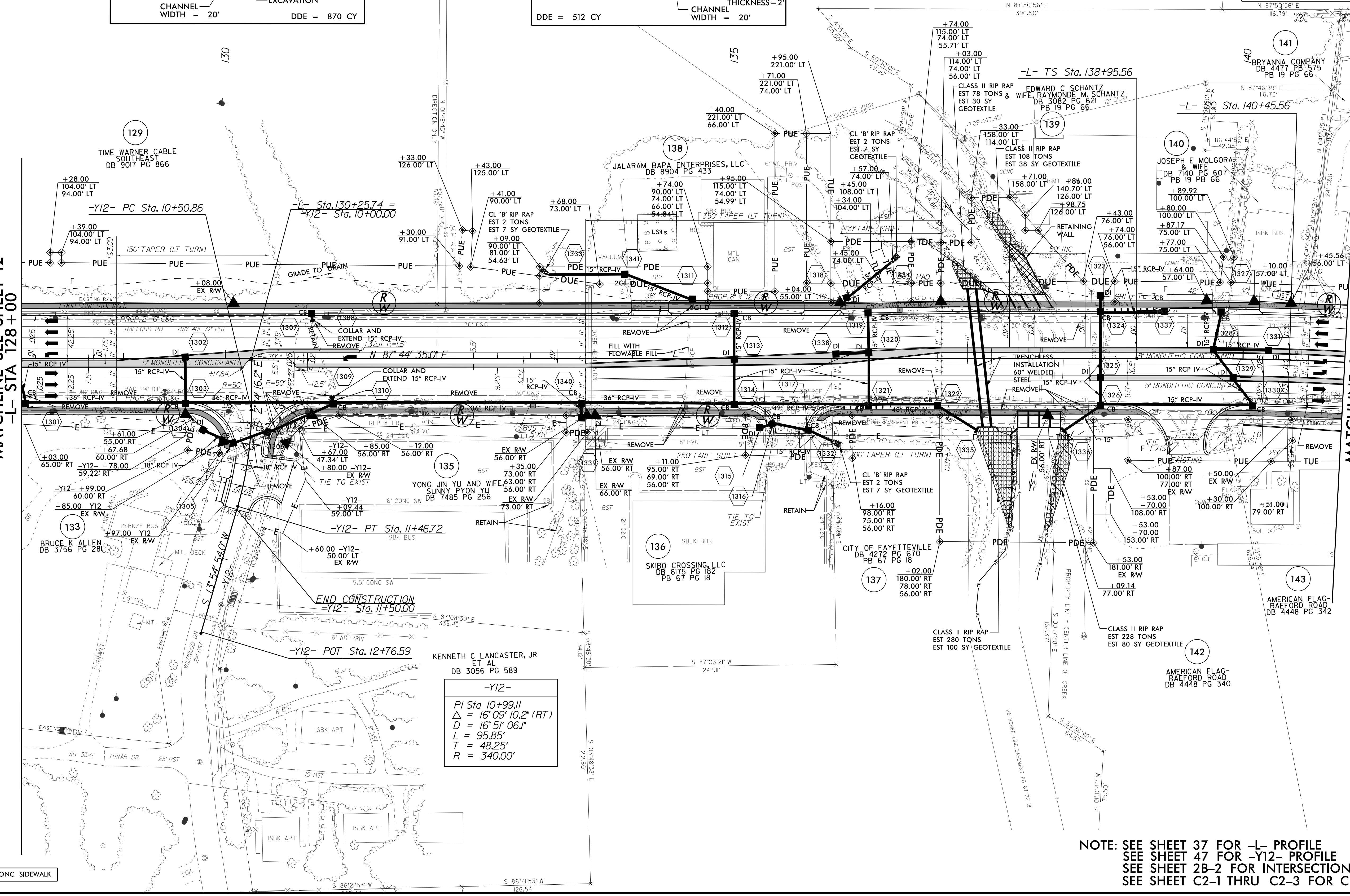

KENNETH C LANCASTER, JR
 ET AL
 DB 3056 PG 589
 -Y12-
 $PI Sta 10+99.11$
 $\Delta = 16' 09' 10.2" (RT)$
 $D = 16' 51' 06.1"$
 $L = 95.85'$
 $T = 48.25'$
 $R = 340.00'$

NOTE: SEE SHEET 37 FOR -L- PROFILE
 SEE SHEET 47 FOR -Y12- PROFILE
 SEE SHEET 2B-2 FOR INTERSECTION DETAILS
 SEE SHEET C2-1 THRU C2-3 FOR CULVERT PLANS

PROP CONC SIDEWALK

REVISIONS

15 JUN 2018 14:29
 R:\Projects\14405\14405_rdy_psh_13.dgn
 \$\$\$\$\$\$DISPERM\$\$\$\$\$\$