

PROJECT REFERENCE NO.	SHEET NO.
U-4405	EC-35/CONST.29
RW SHEET NO.	
ROADWAY DESIGN ENGINEER	HYDRAULICS ENGINEER

NOTES: ANY DEVIATION FROM OPTIONS GIVEN WILL REQUIRE PRIOR APPROVAL BY ENGINEER.

ADDITIONAL EROSION CONTROL DEVICES MAY NEED TO BE INSTALLED AS DIRECTED.

INSTALL FABRIC INSERT INLET PROTECTION DEVICE IN LIEU OF ROCK INLET SEDIMENT TRAP TYPE 'C' AS DIRECTED TO AVOID PONDING OF RUNOFF IN ROADWAY OPEN TO PUBLIC TRAFFIC

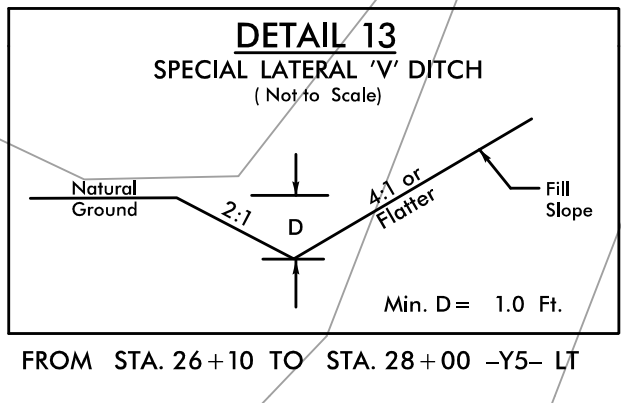

NOTE: PLACE TEMPORARY ROCK SEDIMENT DAMS TYPE - B AND TEMPORARY ROCK SILT CHECKS TYPE - A AT DRAINAGE OUTLETS.

CLEARING AND GRUBBING EROSION CONTROL FOR CONSTRUCTION SHEET 29

NC GRID
NAD 83/NA 2011

REVISIONS

MATCHLINE SEE SHEET 9
-Y5- STA 23+00

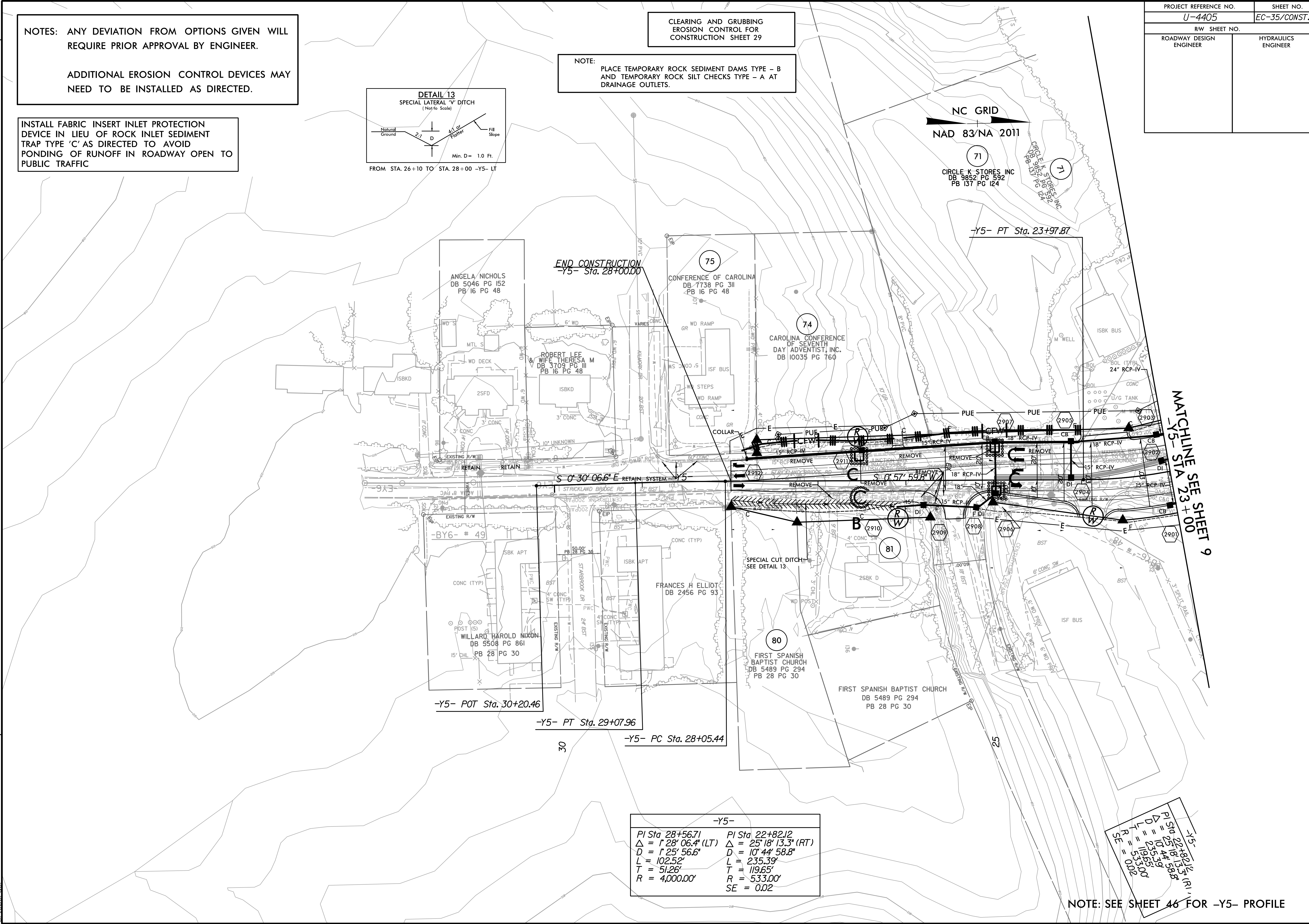

ANGELA NICHOLS
DB 5046 PG 152
PB 16 PG 48

ROBERT LEE & WIFE THERESA M
DB 3709 PG III
PB 16 PG 48

CONFERENCE OF CAROLINA
DB 7738 PG 311
PB 16 PG 48

CAROLINA CONFERENCE OF SEVENTH DAY ADVENTIST, INC.
DB 10035 PG 760

FRANCES H ELLIOT
DB 2456 PG 93

WILLARD HAROLD NIXON
DB 5508 PG 861
PB 28 PG 30

FIRST SPANISH BAPTIST CHURCH
DB 5489 PG 294
PB 28 PG 30

FIRST SPANISH BAPTIST CHURCH
DB 5489 PG 294
PB 28 PG 30

-Y5-	
PI Sta 28+56.71	PI Sta 22+82.12
$\Delta = 1' 28' 06.4''$ (LT)	$\Delta = 25' 18' 13.3''$ (RT)
$D = 1' 25' 56.6''$	$D = 10' 44' 58.8''$
$L = 102.52'$	$L = 235.39'$
$T = 51.26'$	$T = 119.65'$
$R = 4,000.00'$	$R = 533.00'$
	$SE = 0.02$

-Y5-	
PI Sta 22+82.12	PI Sta 22+82.12
$\Delta = 10' 44' 58.8''$	$\Delta = 10' 44' 58.8''$
$L = 235.39'$	$L = 235.39'$
$T = 119.65'$	$T = 119.65'$
$R = 533.00'$	$R = 533.00'$
	$SE = 0.02$

NOTE: SEE SHEET 46 FOR -Y5- PROFILE

8/17/99
10:30:46 AM
R:\Environmental\Design\4405_REU_EC_psh_29.dgn