

**DEFAULT TABLE OF OPERATION**

SIGNAL FACE	PHASE						FLASH
	01+5	01+6	02+5	02+6	04+8	Y	
11	←	←	←	←	←	←	Y
21,22,23	R	R	G	G	R	Y	
41,42	R	R	R	R	G	R	
51	←	←	←	←	←	←	Y
61,62	R	G	R	G	R	Y	
81,82	R	R	R	R	G	R	

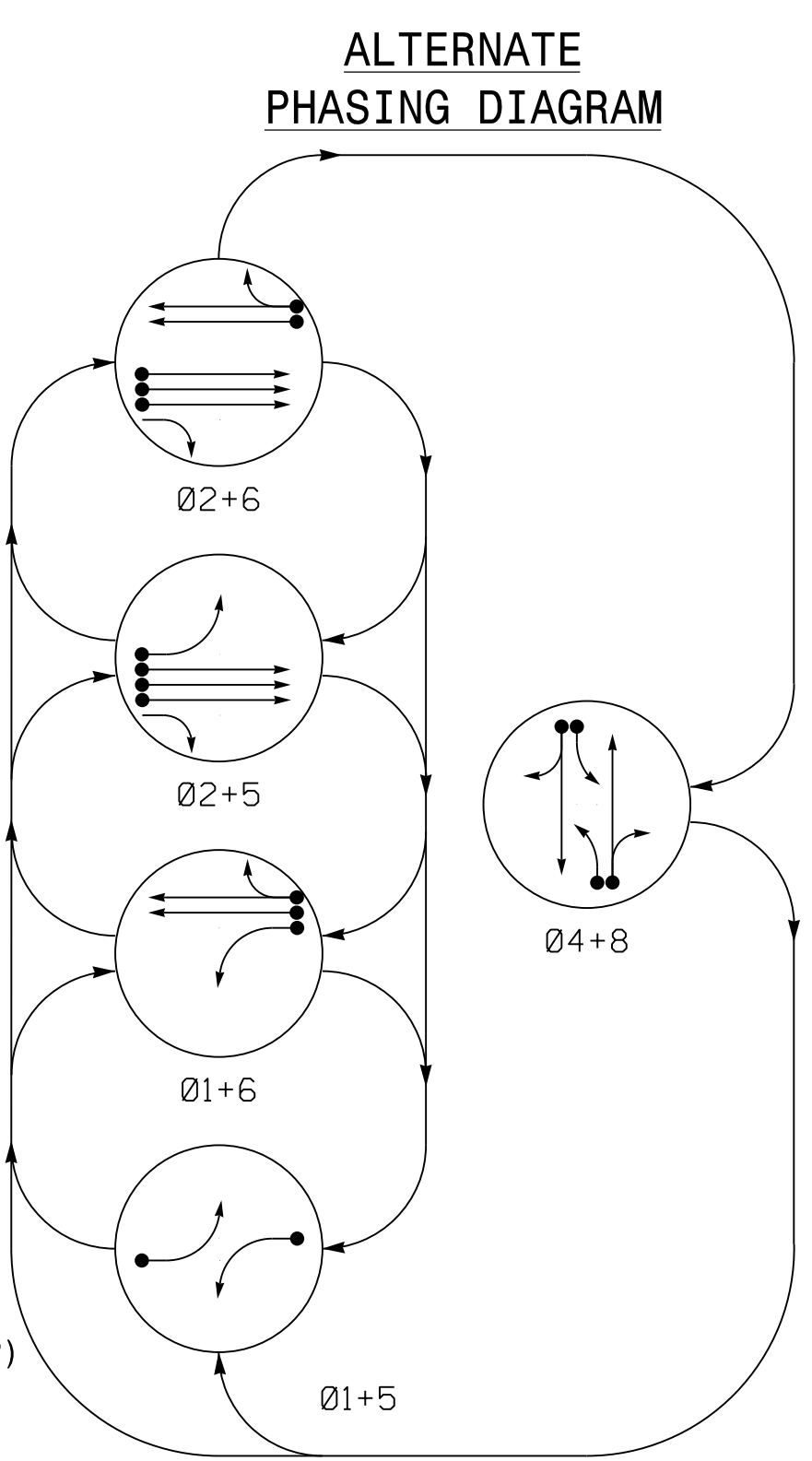

**ALTERNATE TABLE OF OPERATION**

SIGNAL FACE	PHASE						FLASH
	01+5	01+6	02+5	02+6	04+8	Y	
11	←	←	←	←	←	←	Y
21,22,23	R	R	G	G	R	Y	
41,42	R	R	R	R	G	R	
51	←	←	←	←	←	←	Y
61,62	R	G	R	G	R	Y	
81,82	R	R	R	R	G	R	

**ASC/3 DETECTOR INSTALLATION CHART**

LOOP	SIZE (FT)	DISTANCE FROM STOPBAR (FT)	TURNS	NEW LOOP	PROGRAMMING						
					PHASE	CALLING	EXTEND TIME	DELAY TIME	USE ADDED INITIAL	SYSTEM LOOP TYPE	NEW CARD
1A	6X40	0	*	-	1	Yes	-	15★	-	S	-
2A	6X6	300	*	-	2	Yes	-	-	-	N	-
2B	6X6	300	*	-	2	Yes	-	-	-	N	-
2C	6X6	300	*	-	2	Yes	-	-	-	N	-
2D	6X40	0	*	-	2	Yes	2.0	5	-	G	-
2E	6X40	0	*	-	2	Yes	2.0	5	-	G	-
2F	6X40	0	*	-	2	Yes	2.0	5	-	G	-
4A	6X40	0	*	-	4	Yes	-	3	-	S	-
4B	6X40	0	*	-	4	Yes	-	10	-	S	-
5A	6X40	0	*	-	5	Yes	-	15★	-	S	-
6A	6X6	300	*	-	6	Yes	-	-	-	N	-
6B	6X6	300	*	-	6	Yes	-	-	-	N	-
6C	6X40	0	*	-	6	Yes	2.0	5	-	G	-
6D	6X40	0	*	-	6	Yes	2.0	5	-	G	-
8A	6X40	0	*	-	8	Yes	-	3	-	S	-
8B	6X40	0	*	-	8	Yes	-	10	-	S	-

**5 Phase Fully Actuated Fayetteville Signal System**

**NOTES**

1. Refer to "Roadway Standard Drawings NCDOT" dated January 2018 and "Standard Specifications for Roads and Structures" dated January 2018.
2. Do not program signal for late night flashing operation unless otherwise directed by the Engineer.
3. Phase 1 and/or phase 5 may be lagged.
4. Set all detector units to presence mode.
5. The Division (City) Traffic Engineer will determine the hours of use for each phasing plan.
6. Maximum times shown in timing chart are for free-run operation only. Coordinated signal system timing values supersede these values.

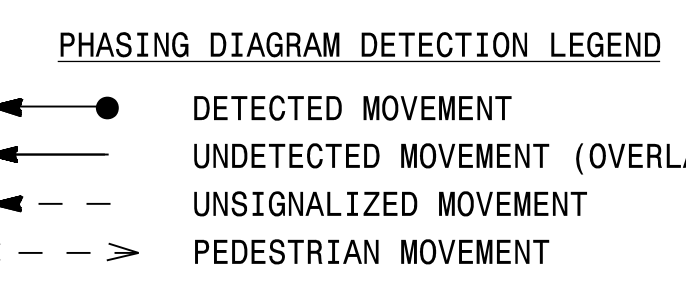

**SIGNAL FACE I.D.**

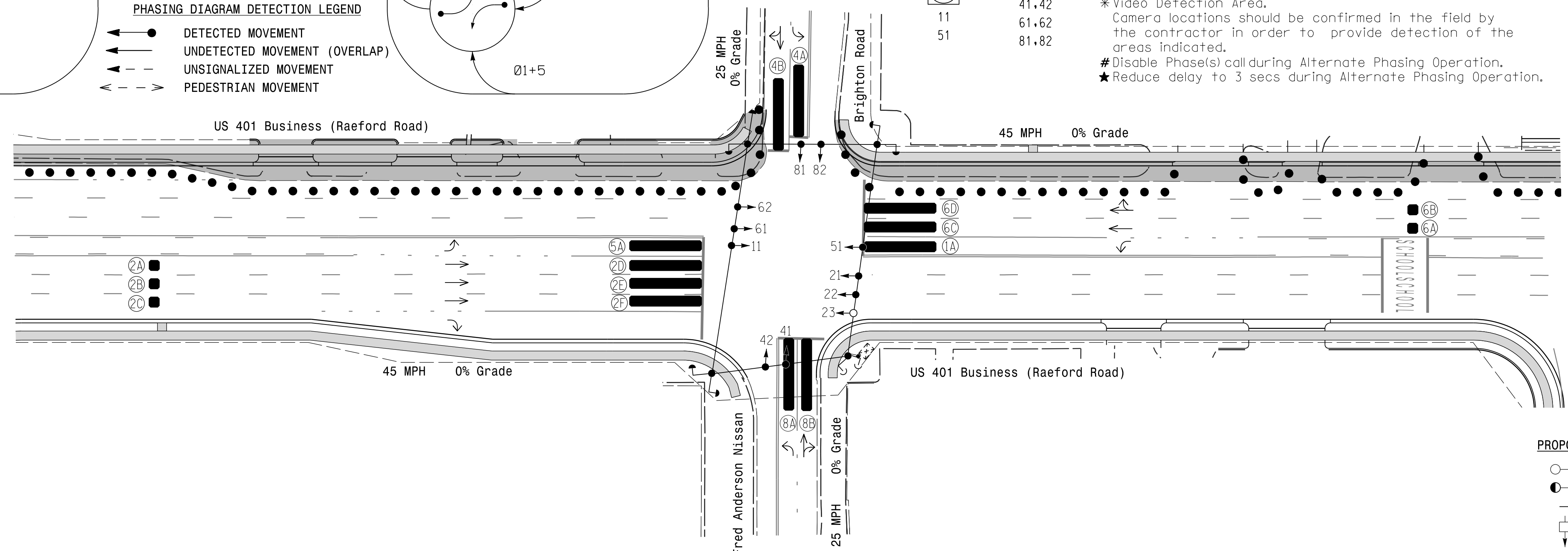
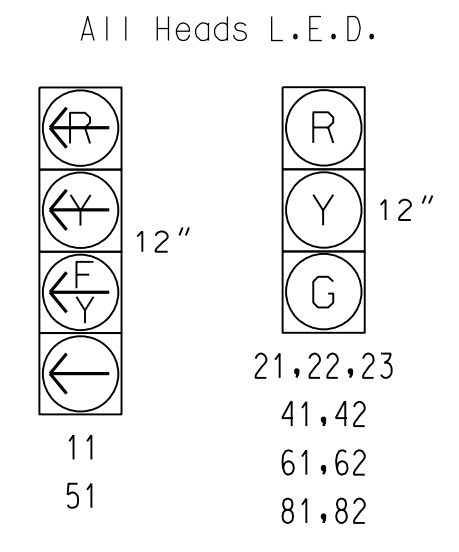

**ASC/3 TIMING CHART**

FEATURE	PHASE					
	1	2	4	5	6	8
Min Green *	7	12	7	7	12	7
Walk *	-	-	-	-	-	-
Ped Clear	-	-	-	-	-	-
Veh. Extension *	2.0	6.0	2.0	2.0	6.0	2.0
Max 1 *	15	90	25	15	90	25
Yellow	3.0	4.5	3.2	3.0	4.5	3.2
Red Clear	2.6	1.1	2.9	2.4	1.1	2.2
Red Revert	-	-	-	-	-	-
Actuations B4 Add *	-	-	-	-	-	-
Seconds / Actuation *	-	-	-	-	-	-
Max Initial *	-	-	-	-	-	-
Time Before Reduction *	-	15	-	-	15	-
Time To Reduce *	-	45	-	-	45	-
Minimum Gap	-	3.0	-	-	3.0	-
Locking Detector	-	-	-	-	-	-
Recall Position	-	VEH. RECALL	-	-	VEH. RECALL	-
Dual Entry	-	-	X	-	-	X
Simultaneous Gap	X	X	X	X	X	X

\* These values may be field adjusted. Do not adjust Min Green and Extension times for phases 2 and 6 lower than what is shown. Min Green for all other phases should not be lower than 4 seconds.

**LEGEND**

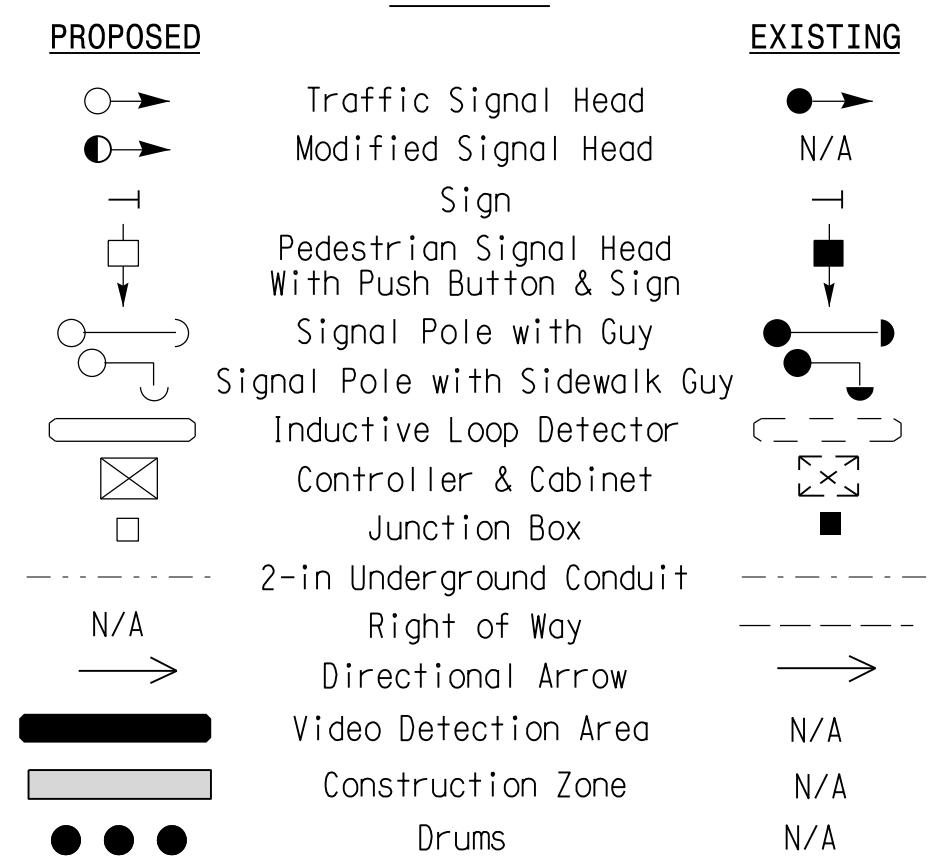

**Signal Upgrade Temporary Design 2 - TMP Phase II**

US 401 Business (Raeford Road) at Brighton Road/ Fred Anderson Nissan

Division 6 Cumberland County Fayetteville

PLAN DATE: March 2018 REVIEWED BY: E D Harris

PREPARED BY: R M Muncey REVIEWED BY: B L Watson

3/29/2018 10:45:11 AM User: rlmuncey

DOCUMENT NOT CONSIDERED FINAL UNLESS ALL SIGNATURES COMPLETED