

DEFAULT PHASING DIAGRAM

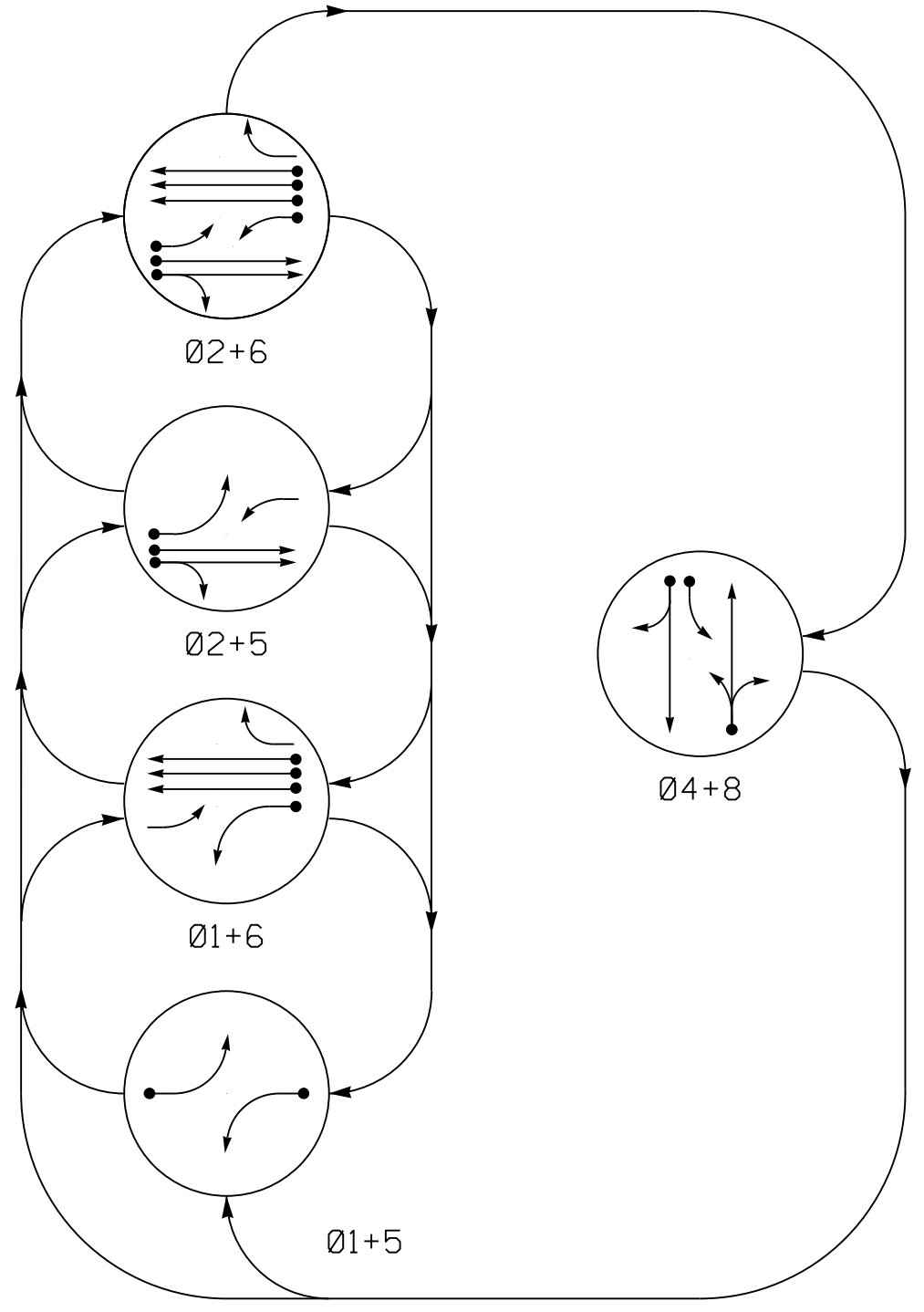

DEFAULT TABLE OF OPERATION

SIGNAL FACE	PHASE				FLASH
	Ø1+5	Ø1+6	Ø2+5	Ø2+6	
11	←	←	←	←	Y
21,22	R	R	G	G	R
41,42	R	R	R	R	G
51	←	←	←	←	Y
61,62,63	R	G	R	G	R
81,82	R	R	R	R	G

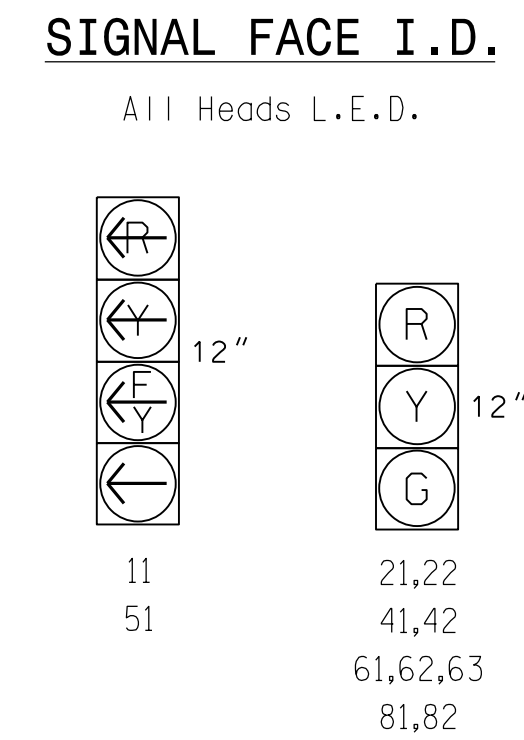

ALTERNATE PHASING DIAGRAM

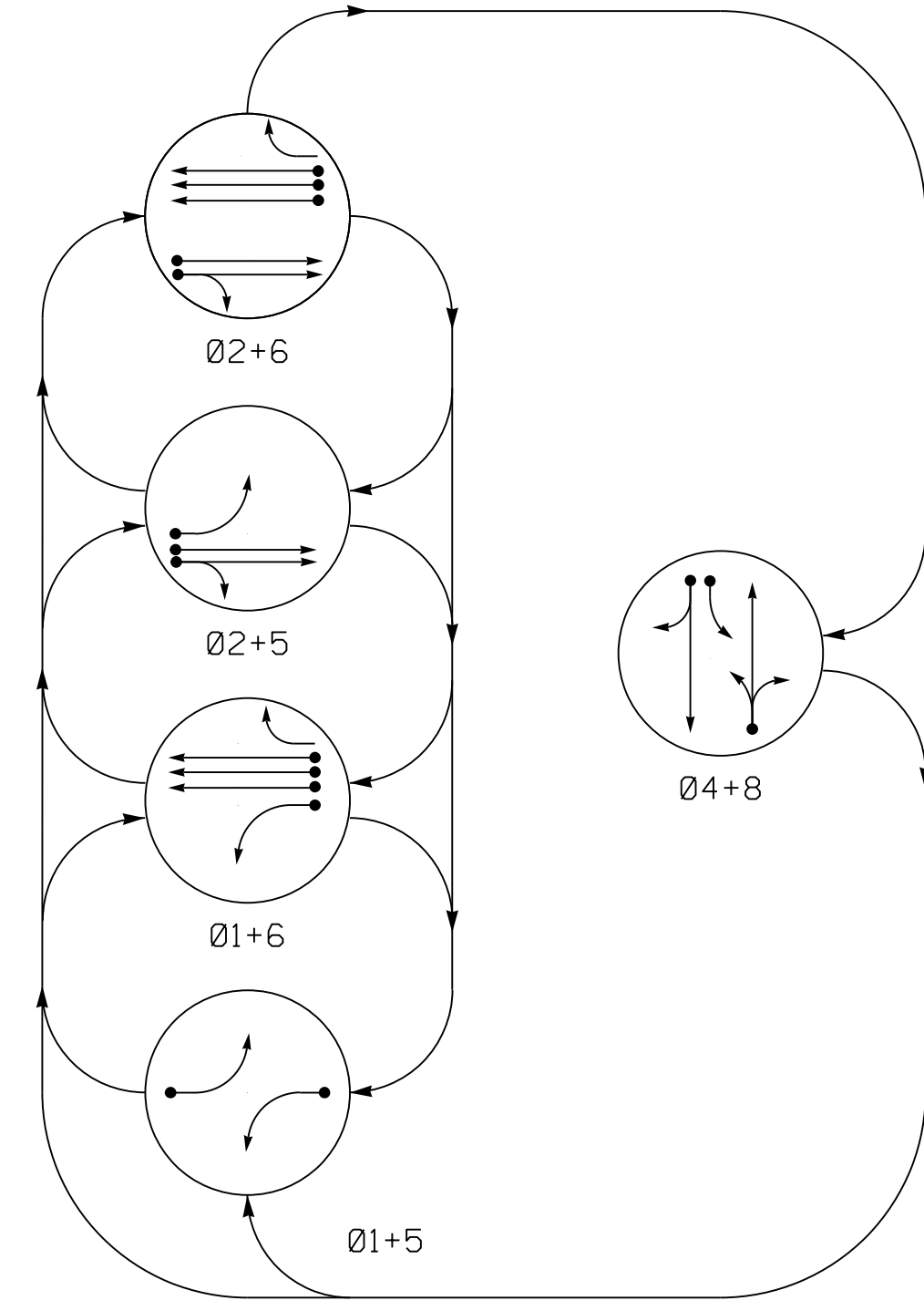

ALTERNATE TABLE OF OPERATION

SIGNAL FACE	PHASE				FLASH
	Ø1+5	Ø1+6	Ø2+5	Ø2+6	
11	←	←	←	←	Y
21,22	R	R	G	G	R
41,42	R	R	R	R	G
51	←	←	←	←	Y
61,62,63	R	G	R	G	R
81,82	R	R	R	R	G

ASC/3 DETECTOR INSTALLATION CHART

LOOP	SIZE (FT)	DISTANCE FROM STOPBAR (FT)	TURNS	NEW LOOP	PROGRAMMING				TYPE	SYSTEM LOOP	NEW CARD	
					PHASE	CALLING	EXTEND TIME	DELAY TIME				
1A	6X40	0	*	-	1	Yes	-	15★	-	S	-	X
2A	6X6	300	*	-	2	Yes	-	3	-	G	-	X
2B	6X6	300	*	-	2	Yes	-	-	-	N	-	X
2C	6X40	0	*	-	2	Yes	2.0	5	-	G	-	X
2D	6X40	0	*	-	2	Yes	2.0	5	-	G	-	X
4A	6X40	0	*	-	4	Yes	-	3	-	S	-	X
4B	6X40	0	*	-	4	Yes	-	10	-	S	-	X
5A	6X40	0	*	-	5	Yes	-	15★	-	S	-	X
6A	6X6	300	*	-	6	Yes	-	-	-	N	-	X
6B	6X6	300	*	-	6	Yes	-	-	-	N	-	X
6C	6X6	300	*	-	6	Yes	-	-	-	N	-	X
6D	6X40	0	*	-	6	Yes	2.0	5	-	G	-	X
6E	6X40	0	*	-	6	Yes	2.0	5	-	G	-	X
6F	6X40	0	*	-	6	Yes	2.0	5	-	G	-	X
8A	6X40	0	*	-	8	Yes	-	5	-	S	-	X

5 Phase Fully Actuated Fayetteville Signal System

NOTES

- Refer to "Roadway Standard Drawings NCDOT" dated January 2018 and "Standard Specifications for Roads and Structures" dated January 2018.
- Do not program signal for late night flashing operation unless otherwise directed by the Engineer.
- Phase 1 and/or phase 5 may be lagged.
- Set all detector units to presence mode.
- Locate new cabinet foundation so as not to obstruct sight distance of vehicles turning right on red. Relocate existing cabinet and controller onto new foundation.
- The Division (City) Traffic Engineer will determine the hours of use for each phasing plan.
- Maximum times shown in timing chart are for free-run operation only. Coordinated signal system timing values supersede these values.
- Field adjust temporary poles as needed.

*Video Detection Area. Camera locations should be confirmed in the field by the contractor in order to provide detection of the areas indicated.
#Disable Phase(s) calling during Alternate Phasing Operation.
★Reduce delay from 15 to 3 seconds during Alternate Phasing Operation.

PHASING DIAGRAM DETECTION LEGEND

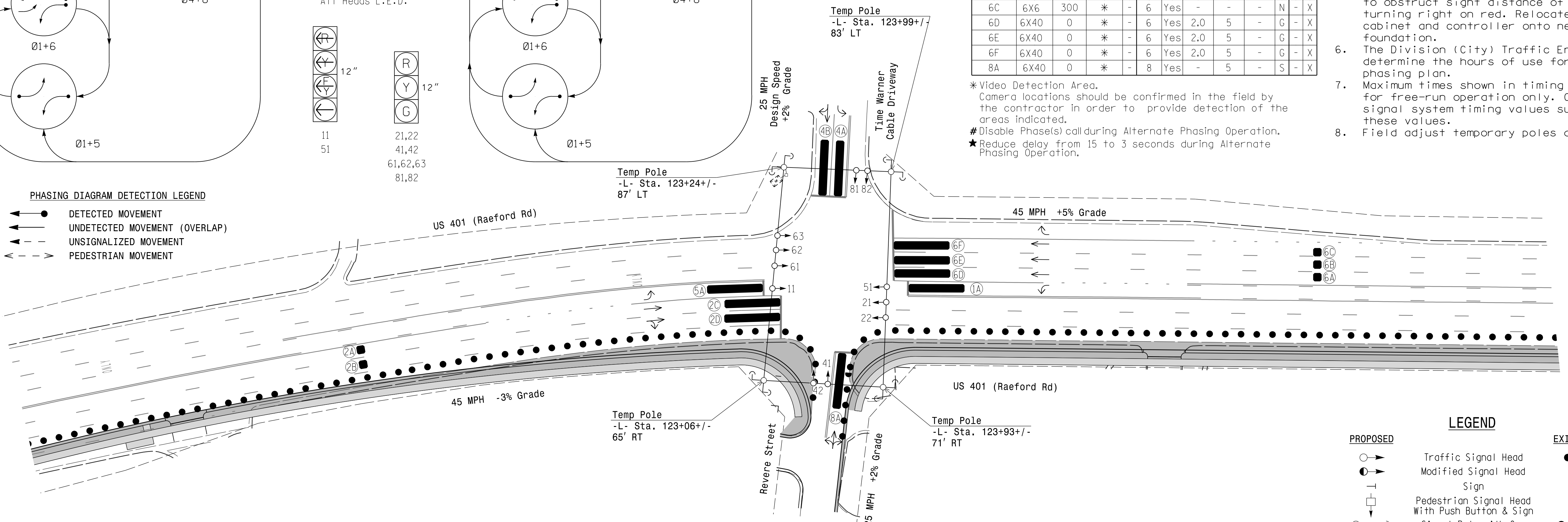
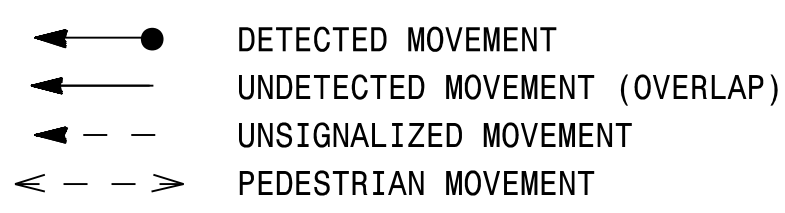

ASC/3 TIMING CHART

FEATURE	PHASE					
	1	2	4	5	6	8
Min Green *	7	12	7	7	12	7
Walk *	-	-	-	-	-	-
Ped Clear	-	-	-	-	-	-
Veh. Extension *	2.0	6.0	2.0	2.0	6.0	2.0
Max 1 *	20	90	30	20	90	30
Yellow	3.0	4.8	3.1	3.0	4.8	3.1
Red Clear	2.3	1.2	2.8	2.8	1.2	2.6
Actuations B4 Add *	-	-	-	-	-	-
Seconds /Actuation *	-	-	-	-	-	-
Max Initial *	-	-	-	-	-	-
Time Before Reduction *	-	15	-	-	15	-
Time To Reduce *	-	45	-	-	45	-
Minimum Gap	-	3.0	-	-	3.0	-
Locking Detector	-	-	-	-	-	-
Recall Position	-	VEH. RECALL	-	-	VEH. RECALL	-
Dual Entry	-	-	-	-	-	-
Simultaneous Gap	X	X	X	X	X	X

* These values may be field adjusted. Do not adjust Min Green and Extension times for phases 2 and 6 lower than what is shown. Min Green for all other phases should not be lower than 4 seconds.

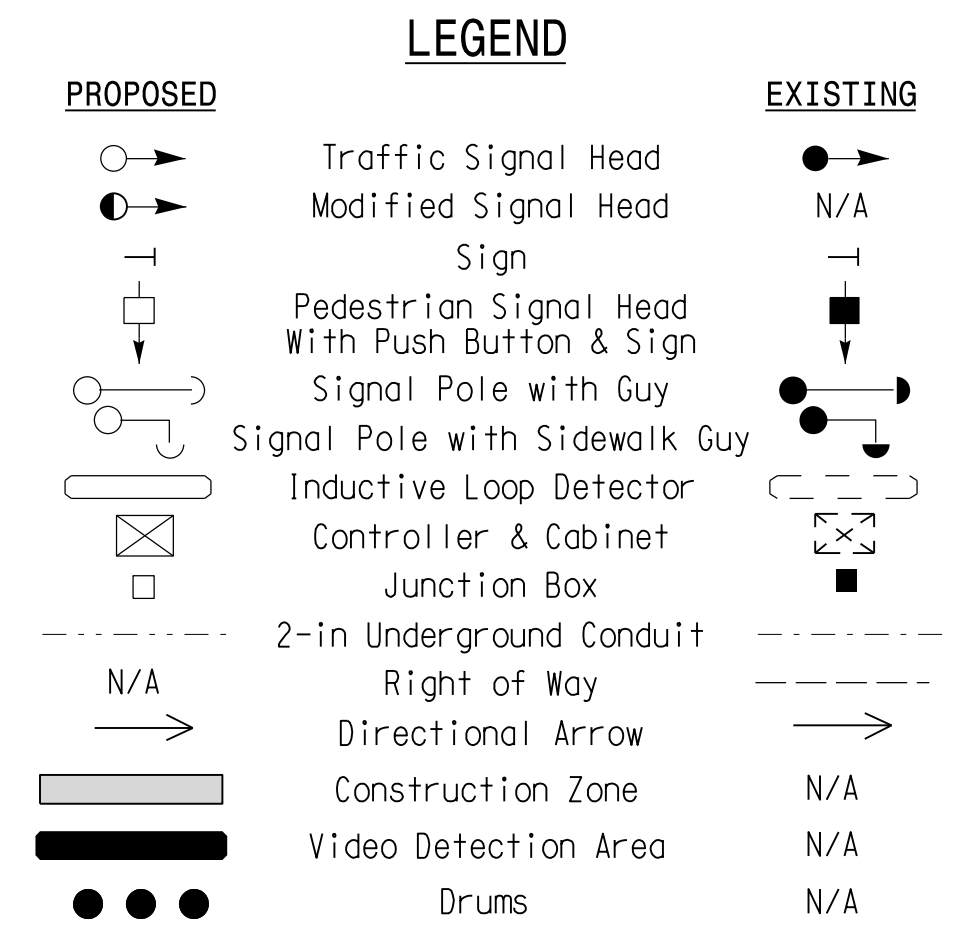

Signal Upgrade Temporary Design 1 - TMP Phase I

Stantec Consulting Services Inc. 801 Jones Franklin Road-Suite 300 Raleigh, NC 27606 Tel. (919) 851-6866 Fax. (919) 851-7024 www.stantec.com License No. F-0672

US 401 (Raeford Road) at Revere Street/ Time Warner Cable Driveway Division 6 Cumberland County Fayetteville PLAN DATE: March 2018 REVIEWED BY: E D Harris PREPARED BY: R M Muncey REVIEWED BY: B L Watson

3/29/2018

DOCUMENT NOT CONSIDERED FINAL UNLESS ALL SIGNATURES COMPLETED

3/29/2018

3/29/2018 11:43:11 AM User: rmmuncey