

8/17/99

CLEARING AND GRUBBING  
EROSION CONTROL FOR  
CONSTRUCTION SHEET 19

NOTE:  
PLACE TEMPORARY ROCK SEDIMENT DAMS TYPE - B  
AND TEMPORARY ROCK SILT CHECKS TYPE - A AT  
DRAINAGE OUTLETS.

INSTALL FABRIC INSERT INLET PROTECTION  
DEVICE IN LIEU OF ROCK INLET SEDIMENT  
TRAP TYPE 'C' AS DIRECTED TO AVOID  
PONDING OF RUNOFF IN ROADWAY OPEN TO  
PUBLIC TRAFFIC

NOTES: ANY DEVIATION FROM OPTIONS GIVEN WILL  
REQUIRE PRIOR APPROVAL BY ENGINEER.

ADDITIONAL EROSION CONTROL DEVICES MAY  
NEED TO BE INSTALLED AS DIRECTED.

-L-  
PI Sta 215+19.81  
 $\Delta = 2' 41'' 44.8'' (RT)$   
 $D = 0' 34'' 22.6''$   
 $L = 470.50'$   
 $T = 235.29'$   
 $R = 10,000.00'$   
SE = NC

NC GRID  
NAD 83/NA 2011

PROJECT REFERENCE NO. U-4405	SHEET NO. EC-24/CONST.19
RW SHEET NO.	
ROADWAY DESIGN ENGINEER	HYDRAULICS ENGINEER

REVISIONS

MATCHLINE SEE SHEET 18  
-L- STA 205+00

MATCHLINE SEE SHEET 20  
-L- STA 218+50

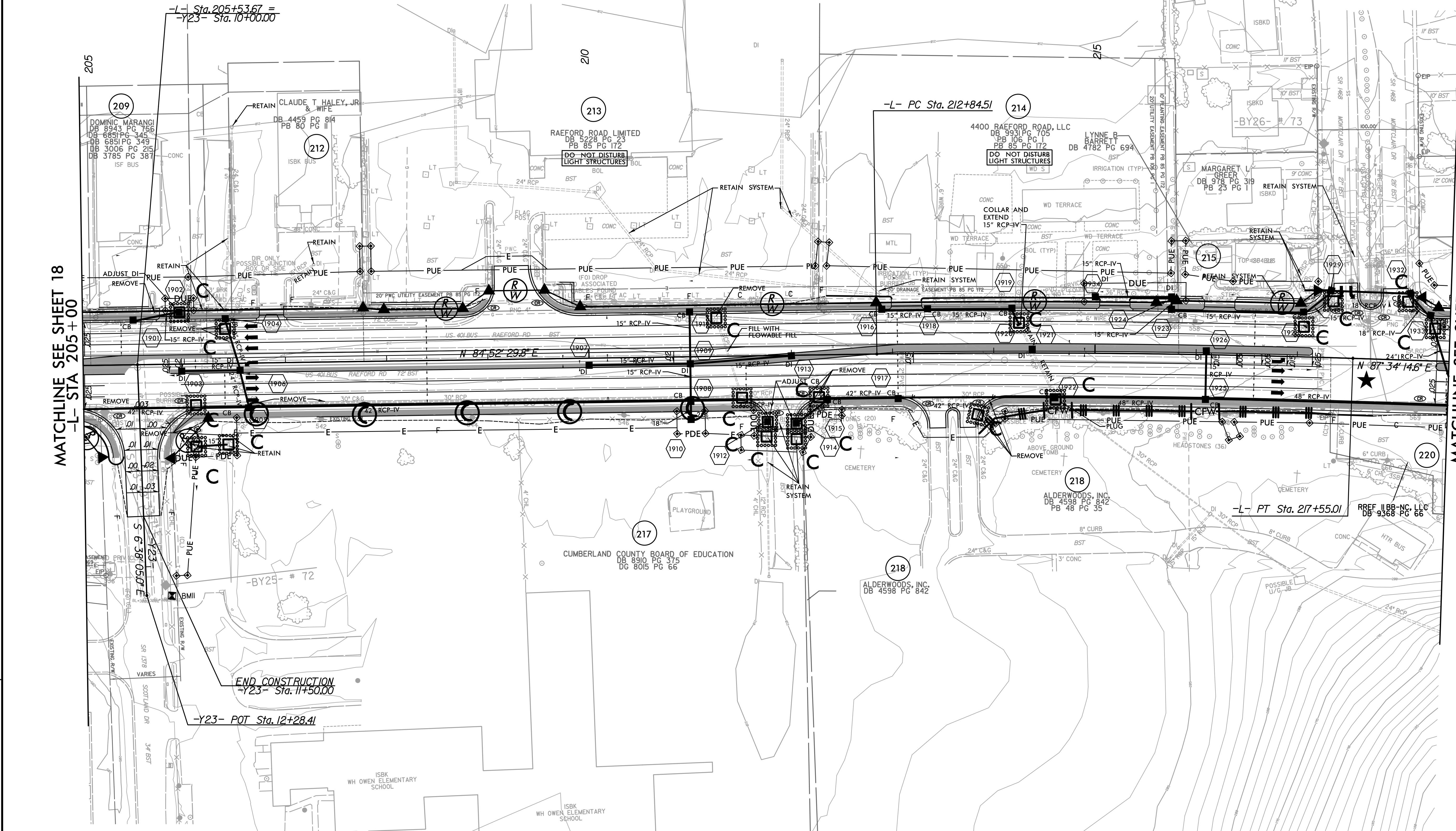

★ PROPOSED SIGNAL

▬ PROP CONC SIDEWALK

\*\* A DESIGN EXCEPTION FOR LANE WIDTH IS  
REQUIRED FOR -L- STA. 38+95.00 TO -L- 319+95.00

NOTE: SEE SHEET 39 & 40 FOR -L- PROFILE  
SEE SHEET 48 FOR -Y23- PROFILE

10:28:00 AM  
R:\Environmental\Design\4405\_REU\_EC\_psh\_19.dgn