

PHASING DIAGRAM

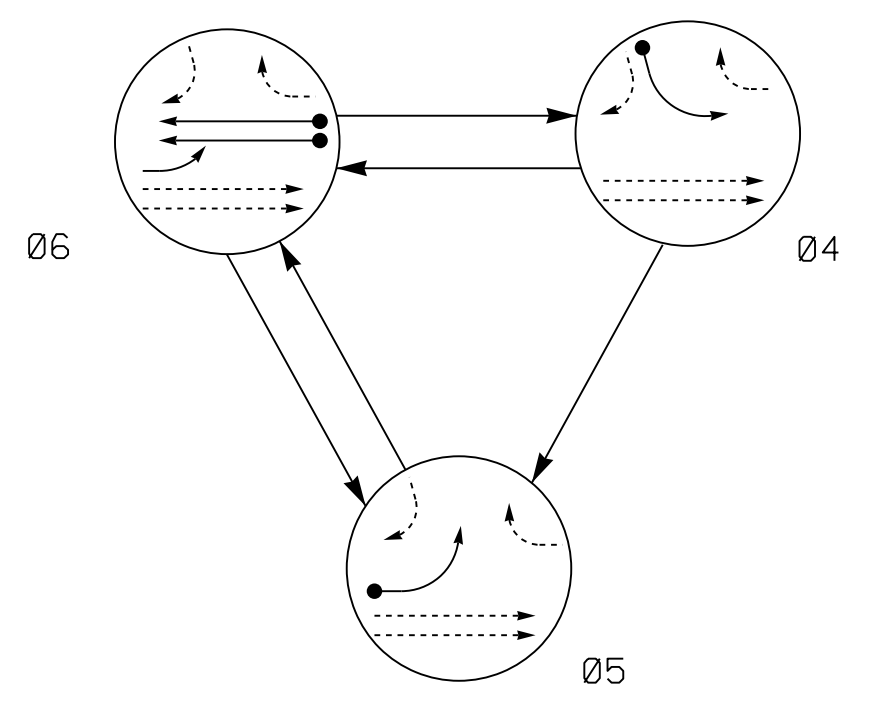

PHASING DIAGRAM DETECTION LEGEND

- → DETECTED MOVEMENT
- UNDETECTED MOVEMENT (OVERLAP)
- UNSIGNALIZED MOVEMENT
- ⚡ PEDESTRIAN MOVEMENT

TABLE OF OPERATION

SIGNAL FACE	PHASE			
	Ø 5	Ø 6	Ø 4	FLASH
41,42	R	R	G	R
51	←	←	←	←
61,62	R	G	R	Y

SIGNAL FACE I.D.

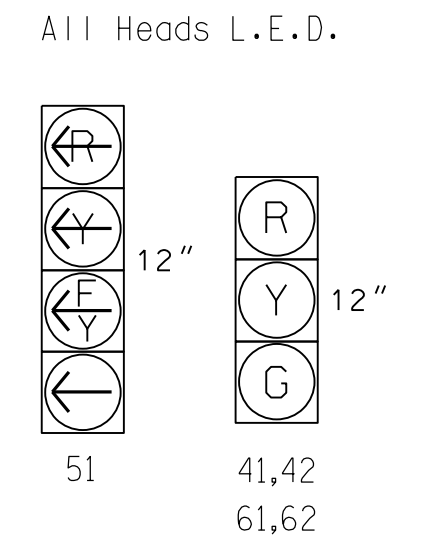

OASIS 2070 LOOP & DETECTOR INSTALLATION CHART

LOOP	SIZE (FT)	DISTANCE FROM STOPBAR (FT)	TURNS	NEW LOOP	DETECTOR PROGRAMMING				SYSTEM LOOP	NEW CARD	
					PHASE	CALLING	EXTENSION	FULL TIME DELAY			
4A	6X40	0	2-4-2	Y	4	Y	Y	-	-	-	Y
5A	6X40	0	2-4-2	Y	5	Y	Y	-	-	-	Y
6A	6X6	300	5	Y	6	Y	Y	-	-	-	Y
6B	6X6	300	5	Y	6	Y	Y	-	-	-	Y

3 Phase Fully Actuated (Isolated)

NOTES

- Refer to "Roadway Standard Drawings NCDOT" dated January 2018 and "Standard Specifications for Roads and Structures" dated January 2018.
- Do not program signal for late night flashing operation unless otherwise directed by the Engineer.
- Set all detector units to presence mode.
- Locate new cabinet so as not to obstruct sight distance of vehicles turning right on red.

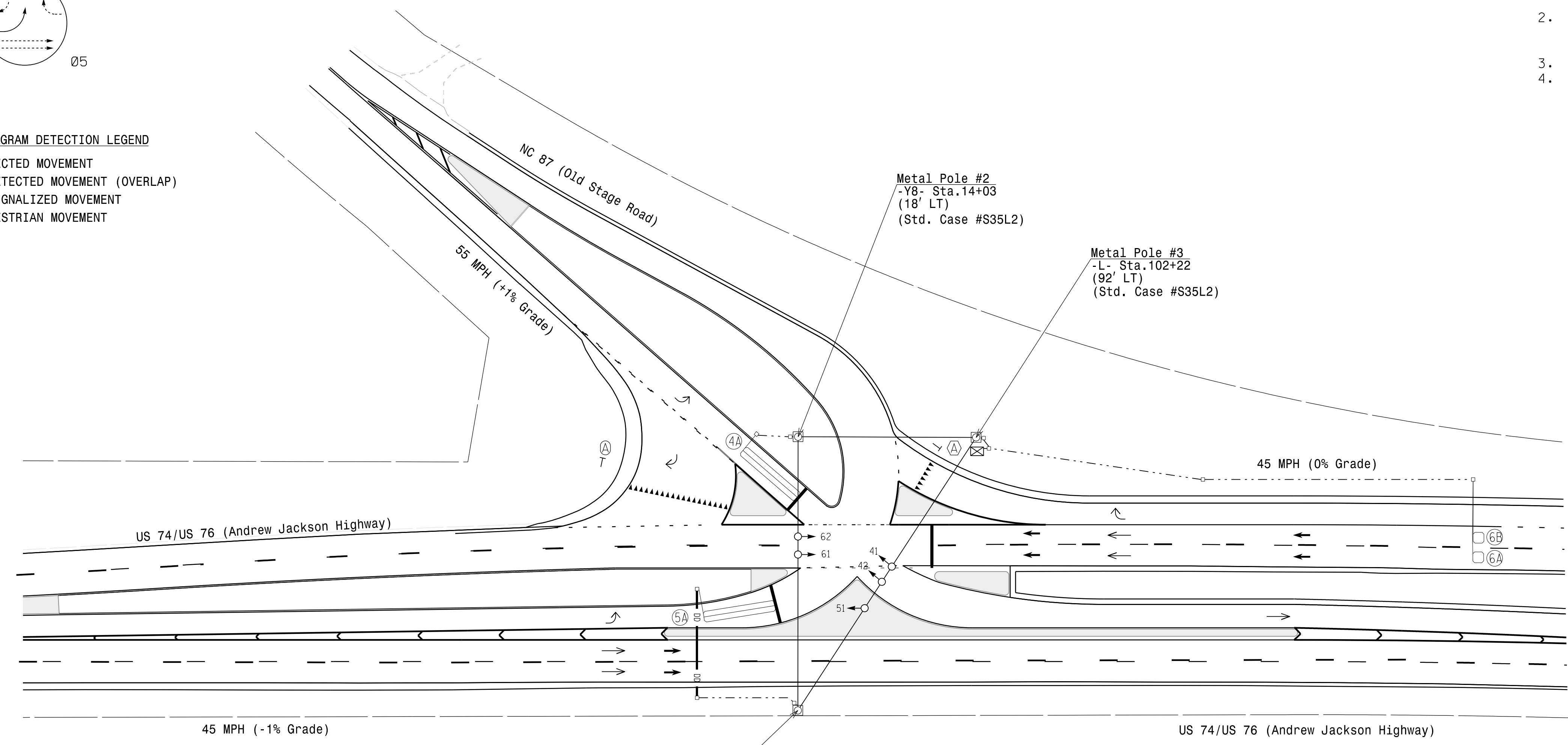

OASIS 2070 TIMING CHART

FEATURE	PHASE		
	4	5	6
Min Green 1 *	7	7	12
Extension 1 *	3.0	3.0	6.0
Max Green 1 *	25	20	60
Yellow Clearance	3.0	3.0	4.5
Red Clearance	2.3	2.4	1.2
Red Revert	-	-	-
Walk 1 *	-	-	-
Don't Walk 1	-	-	-
Seconds Per Actuation *	-	-	1.5
Max Variable Initial *	-	-	34
Time Before Reduction *	-	-	15
Time To Reduce *	-	-	30
Minimum Gap	-	-	3.0
Recall Mode	-	-	MIN RECALL
Vehicle Call Memory	-	-	YELLOW
Dual Entry	-	-	-
Simultaneous Gap	ON	ON	ON

* These values may be field adjusted. Do not adjust Min Green and Extension times for phase 6 lower than what is shown. Min Green for all other phases should not be lower than 4 seconds.

LEGEND

PROPOSED	EXISTING
○ → Traffic Signal Head	● → N/A
● → Modified Signal Head	N/A
⊥ Sign	⊥
⊥ Pedestrian Signal Head	⊥
⊥ With Push Button & Sign	⊥
○ → Signal Pole with Guy	● →
○ → Signal Pole with Sidewalk Guy	● →
⊠ Inductive Loop Detector	⊠
□ Controller & Cabinet	⊠
□ Junction Box	□
--- 2-in Underground Conduit	---
N/A Right of Way	---
→ Directional Arrow	→
○ Metal Strain Pole	□
--- Directional Drill	N/A
(A) "YIELD" Sign (R1-2)	(A)

New Installation

DOCUMENT NOT CONSIDERED FINAL UNLESS ALL SIGNATURES COMPLETED

<p>Stantec Consulting Services Inc. 801 Jones Franklin Road-Suite 300 Raleigh, NC 27606 Tel. (919) 851-6866 Fax. (919) 851-7024 www.stantec.com License No. F-0672</p>		<p>US 74/76 (Andrew Jackson Highway) at NC 87 (Old Stage Road)</p>	
		<p>Division 6 Columbus County Delco</p> <p>PLAN DATE: May 2018 REVIEWED BY: E D Harris</p> <p>PREPARED BY: J B Hambricht REVIEWED BY: B L Watson</p>	<p>750 N. Greenfield Pkwy, Garner, NC 27529</p> <p>SCALE: 0 40 (1"=40')</p>

4/28/2018 10:48:10 AM C:\Users\jhambricht\OneDrive\Documents\Projects\2018\042818\042818.dgn
 4/28/2018 10:48:10 AM C:\Users\jhambricht\OneDrive\Documents\Projects\2018\042818\042818.dgn
 4/28/2018 10:48:10 AM C:\Users\jhambricht\OneDrive\Documents\Projects\2018\042818\042818.dgn