

FINAL GRADE PLAN

PROJECT REFERENCE NO. W-5601EV		SHEET NO. EC-18/CONST.06
RW SHEET NO.		
ROADWAY DESIGN ENGINEER		HYDRAULICS ENGINEER

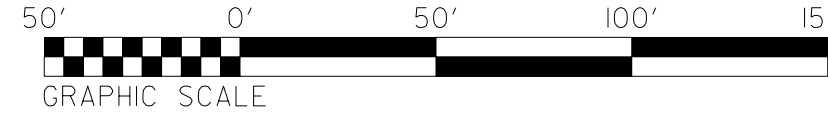

-L-
PI Sta 50+17.07
 $\Delta = 9' 10" 52.2" (RT)$
 $D = 0' 44" 04.4"$
 $L = 1,249.88'$
 $T = 626.28'$
 $R = 7,800.00'$
 $e = exist$

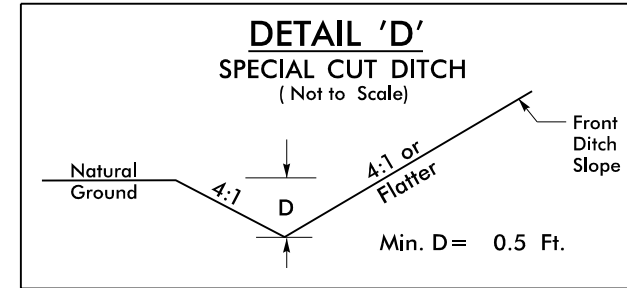

FROM STA. 46+50 TO STA. 48+90 -L- LT

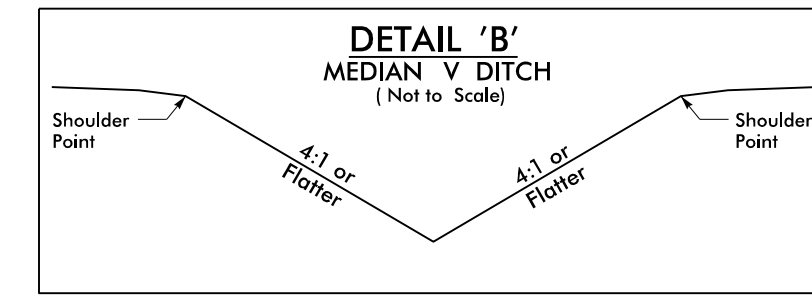

FROM STA. 49+00 TO STA. 49+58 -L- MED

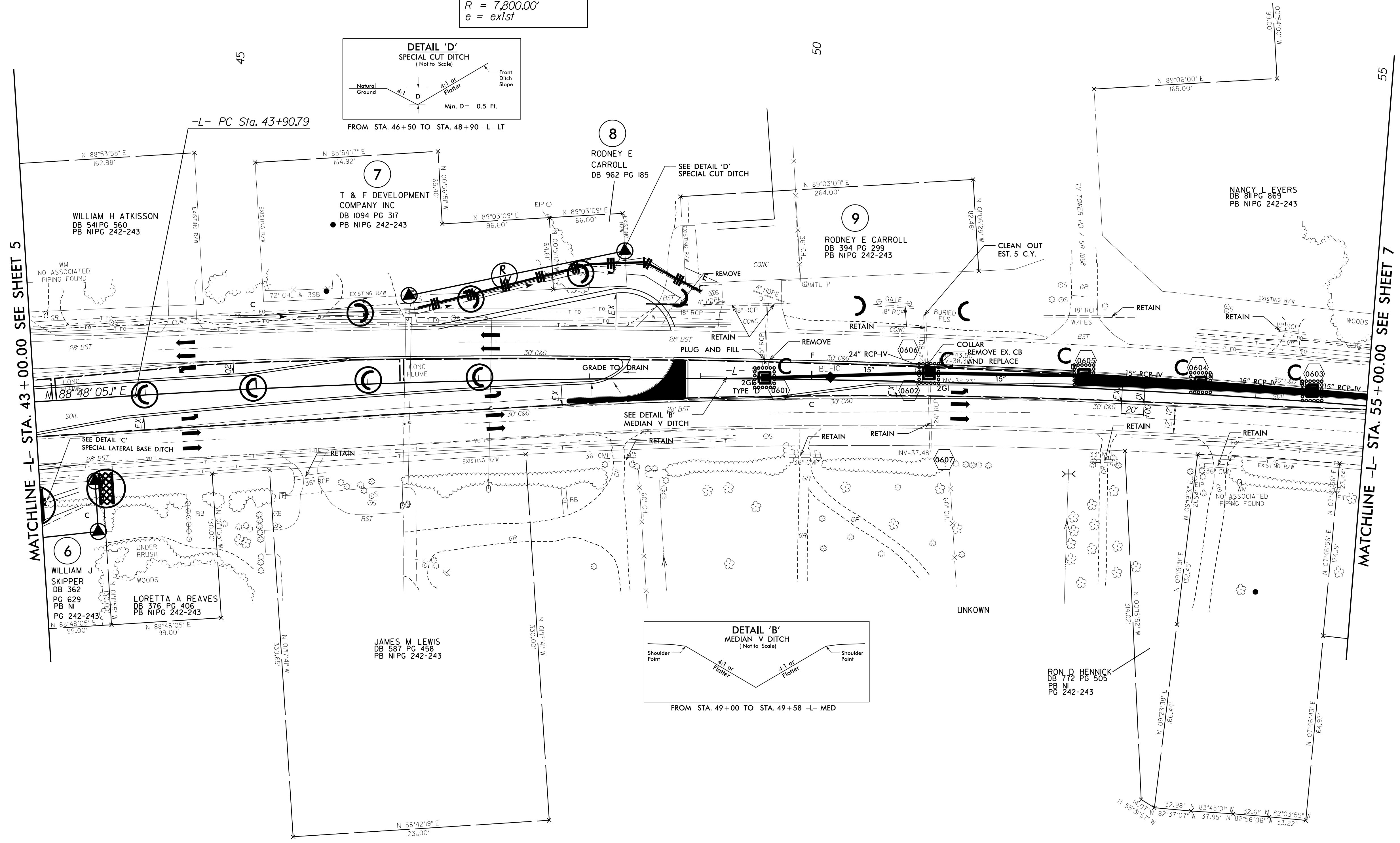

NAD 83/2001

REVISIONS

8/17/99

DATE PLOTTED: 08/17/99
SCALE: 1"=40'
DRAWN BY: JLR
CHECKED BY: JLR
DATE: 08/17/99