

| | |
|--|--------------------|
| TIP NO. W-5601EV | SHEET NO. PMP-3 |
| APPROVED: _____ | |
| DATE: _____ | |
| SEAL | |
| | |
| 5/24/2018 | |
| DOCUMENT NOT CONSIDERED FINAL UNLESS ALL SIGNATURES COMPLETED | |
| | |

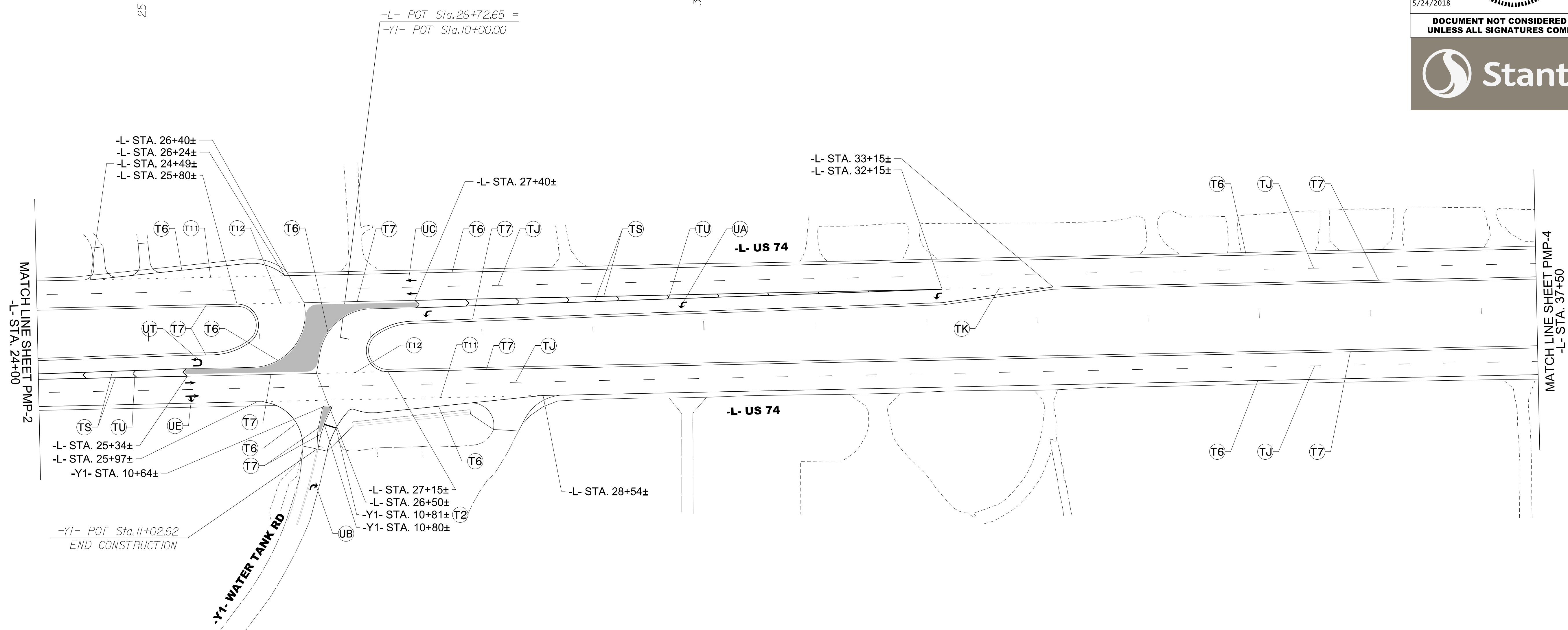

| THERMOPLASTIC PAVEMENT MARKING LEGEND | |
|---------------------------------------|---|
| (UA) ← LEFT TURN ARROW | (T2) WHITE STOPBAR (24") |
| (UB) ↗ RIGHT TURN ARROW | (T6) WHITE EDGELINE (6") |
| (UC) ↑ STRAIGHT ARROW | (T7) YELLOW EDGELINE (6") |
| (UE) ↘ STRAIGHT/RIGHT ARROW | (T11) 2 FT-6 FT/SP WHITE MINISKIP (6") |
| (UT) ↻ U-TURN ARROW | (T12) 2 FT-6 FT/SP YELLOW MINISKIP (6") |
| | (TJ) 10 FT WHITE SKIP (6") |
| | (TK) 3 FT - 9 FT/SP WHITE MINISKIP (6") |
| | (TS) WHITE GORELINE (12") |
| | (TU) WHITE DIAGONAL (12") |

PAVEMENT MARKING DETAIL

5/24/2018
 Us\Traffic\CADD\PM\plan_sheets\W-5601EV_pmp_03.dgn
 angood