

8/17/99

MI ENGINEERING
1011 SCHUB DRIVE, SUITE 100
RALEIGH, NC 27606
(919) 851-6606
FIRM PE NUMBER: P-0671



Stantec Consulting Services Inc.
801 Jones Franklin Road
Suite 300
Raleigh, NC 27606
Tel. (919) 851-6866
Fax. (919) 851-7024
www.stantec.com
License No. F-0672

PROJECT REFERENCE NO. W-5601EV	SHEET NO. 11
R/W SHEET NO.	
ROADWAY DESIGN ENGINEER	HYDRAULICS ENGINEER
5/29/2018	5/29/2018

**DOCUMENT NOT CONSIDERED FINAL
UNLESS ALL SIGNATURES COMPLETED**

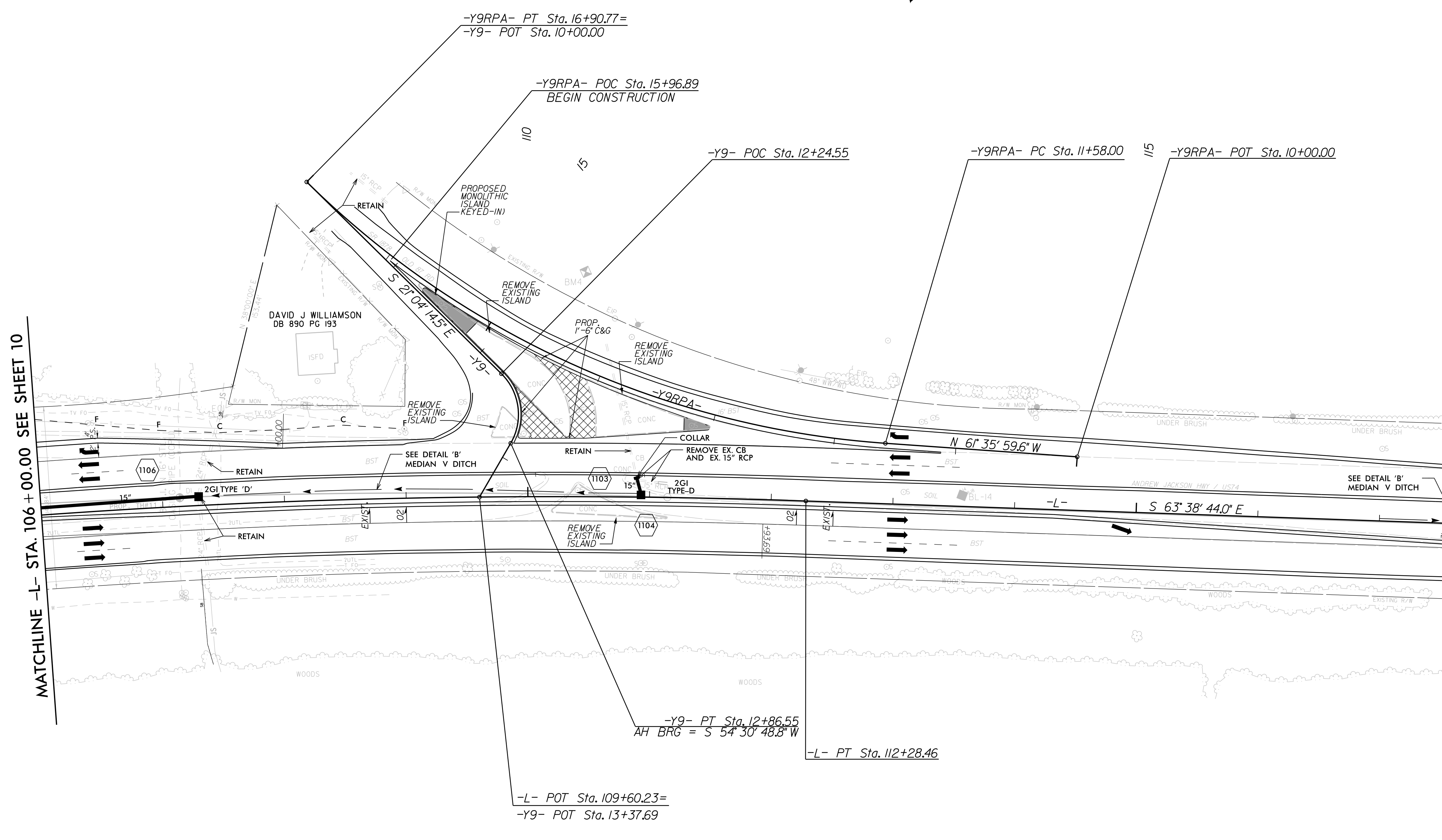
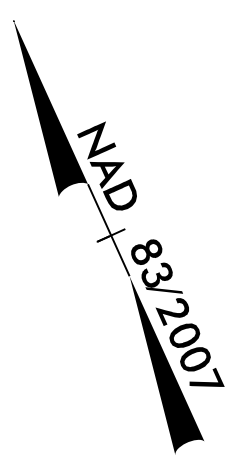

MATCHLINE -L- STA. 106+00.00 SEE SHEET 10

MATCHLINE -L- STA. 118+00.00 SEE SHEET 12

REVISIONS

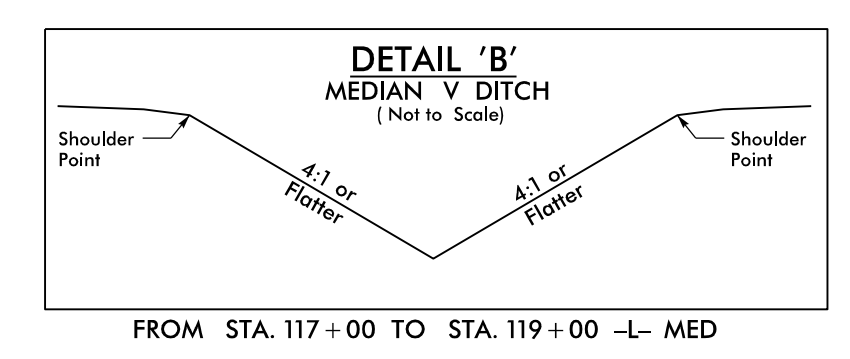
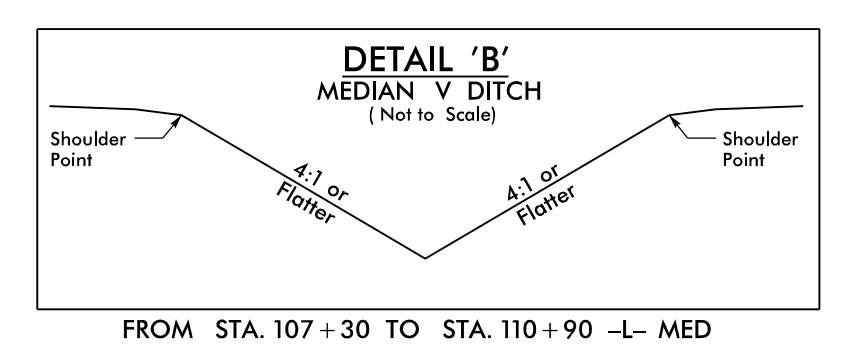

-Y9RPA-
PI Sta 14+36.08
$\Delta = 40^\circ 31' 45.1''$ (RT)
$D = 7^\circ 36' 25.9''$
$L = 532.77'$
$T = 278.08'$
$R = 753.18'$

-Y9-
PI Sta 12+61.00
$\Delta = 75^\circ 35' 03.3''$ (RT)
$D = 12^\circ 54' 21.3''$
$L = 62.00'$
$T = 36.45'$
$R = 47.00'$

-L-
PI Sta 108+14.24
$\Delta = 8^\circ 03' 30.3''$ (RT)
$D = 0^\circ 58' 16.0''$
$L = 829.81'$
$T = 415.59'$
$R = 5,900.00'$

PLACE BLOCKOUT PER RSD 904.50 SHEET 2 OF 2 IN 2' CONCRETE ISLAND FOR SIGNS SHOWN ON SIGNING PLANS OR DIRECTED BY THE ENGINEER.

NOTE:
SEE SHEET 2B-4 FOR INTERSECTION DETAIL
SEE SHEET 19 FOR -L- PROFILE

5/29/2018
U:\Roadway\Pro\W5601EV_r.dwg_psh11.dgn
-chao