

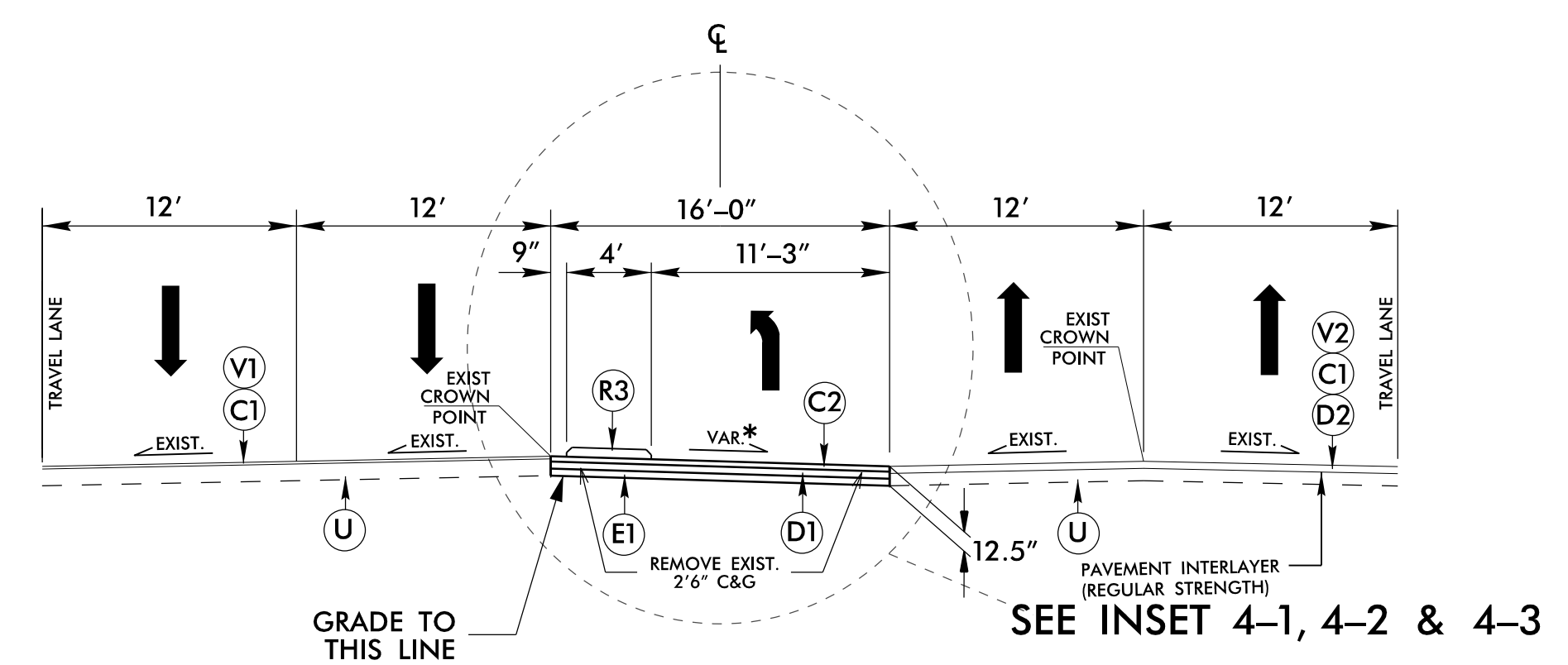

PROJECT REFERENCE NO. W-5601EV	SHEET NO. 2A-4
ROADWAY DESIGN ENGINEER SEAL 022037	PAVEMENT DESIGN ENGINEER SEAL 022896

DOCUMENT NOT CONSIDERED FINAL UNLESS ALL SIGNATURES COMPLETED



TYPICAL SECTION No. 4

USE TYPICAL SECTION No. 4:
 -L- STA. 71+00.00 TO 81+72.78
 -L- STA. 86+31.75 TO 93+31.75
 *SEE PLANS FOR SUPERELEVATION

INSET 4-1
 -L- STA. 56+37.66 TO 61+62.01

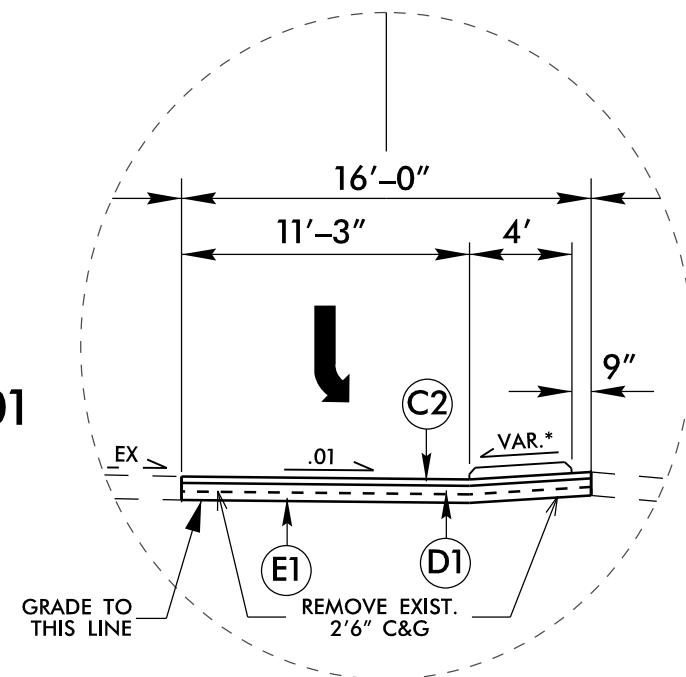

INSET 4-2
 -L- STA. 64+87.01 TO 71+00.00

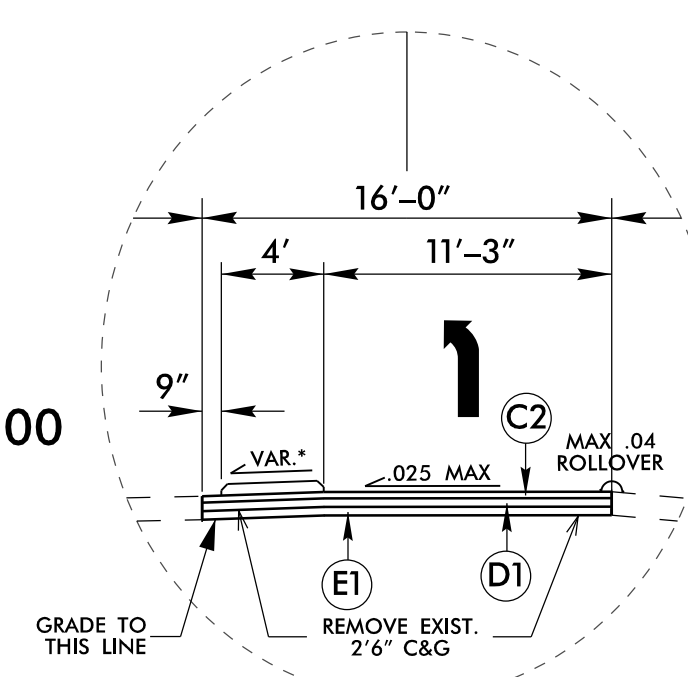

INSET 4-3
 -L- STA. 81+72.78 TO 87+31.64
 -L- STA. 92+56.24 TO 100+97.17
 -Y8- STA. 12+05.93 TO 14+43.65
 -Y9RPA- STA. 13+19.88 TO 15+09.53

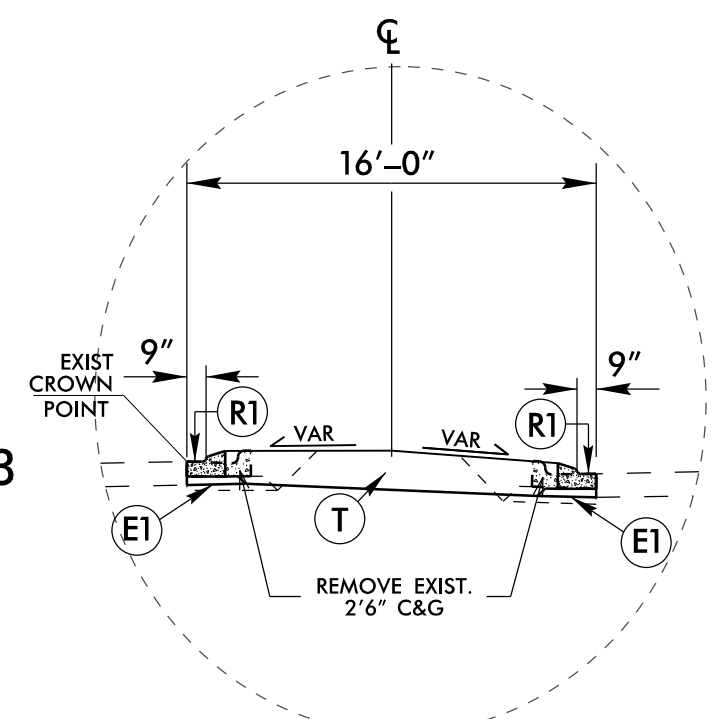

PAVEMENT SCHEDULE	
C1	1.5" S9.5C
C2	3" S9.5C
C3	VAR. DEPTH S9.5C
D1	4" I19.0C
D2	2.5" I19.0C
D3	VAR. DEPTH I19.0C
E1	5.5" B25.0C
E2	VAR. DEPTH B25.0C
R1	1'-6" C&G
R2	2'-6" C&G
R3	CONC. MONO. ISLAND (KEYED-IN)
T	EARTH MATERIAL
U	EXISTING PAVEMENT
V1	MILLING 1.5" DEPTH
V2	MILLING 4" DEPTH
W	WEDGING
Y	MILLED RUMBLE STRIPS

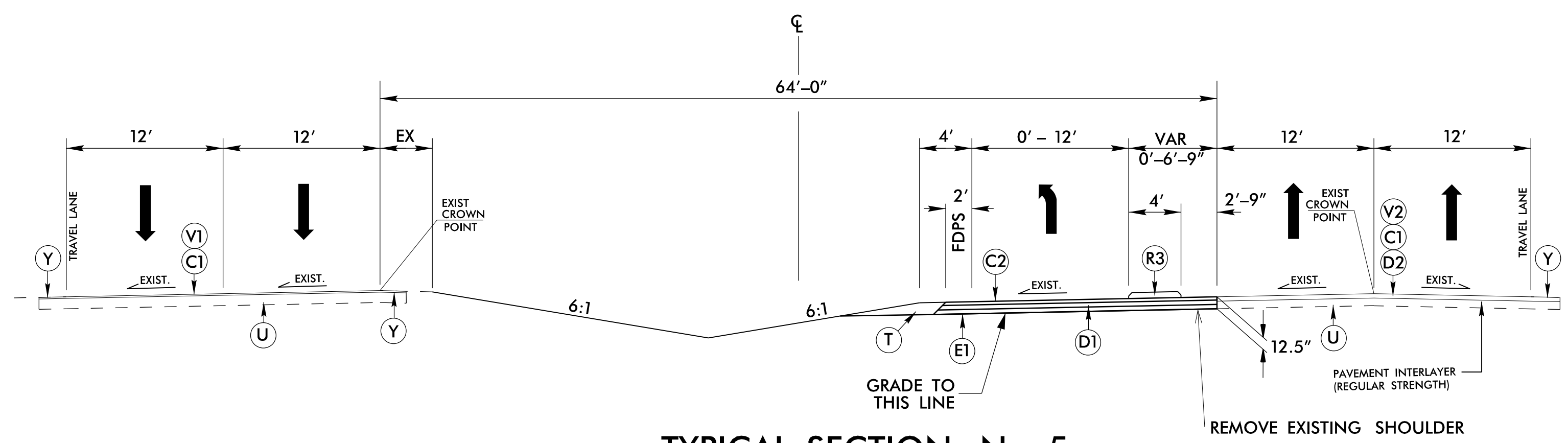

TYPICAL SECTION No. 5

USE TYPICAL SECTION No. 5:
 -L- STA. 19+59.11 TO 26+72.65
 -L- STA. 26+72.65 TO 33+15.04 (MIRRORED)
 -L- STA. 40+71.53 TO 48+88.60
 -L- STA. 49+62.19 TO 56+43.26
 -L- STA. 101+99.53 TO 118+54.44
 -L- STA. 120+56.60 TO 127+40.43 (MIRRORED)
 -L- STA. 127+14.47 TO 133+69.54
 -L- STA. 133+69.54 TO 139+53.96 (MIRRORED)
 -L- STA. 138+40.87 TO 144+24.87
 -L- STA. 148+86.85 TO 155+59.42
 -L- STA. 155+59.42 TO 162+31.20 (MIRRORED)