

**This electronic collection of documents is provided
for the convenience of the user
and is Not a Certified Document –**

**The documents contained herein were originally issued
and sealed by the individuals whose names and license
numbers appear on each page, on the dates appearing
with their signature on that page.**

**This file or an individual page
shall not be considered a certified document.**

09/06/99

TIP PROJECT: U-5114

CONTRACT: C204104

STATE OF NORTH CAROLINA
DIVISION OF HIGHWAYS

PROJECT NO.	SHEET NO.
U-5114	UO-1

DOCUMENT NOT CONSIDERED FINAL
UNLESS ALL SIGNATURES COMPLETED

UTILITIES BY OTHERS PLANS MECKLENBURG COUNTY

LOCATION: US 21 (STATESVILLE ROAD) AND SR 2136 (GILEAD ROAD)
TYPE OF WORK: POWER, GAS, AND COMMUNICATIONS

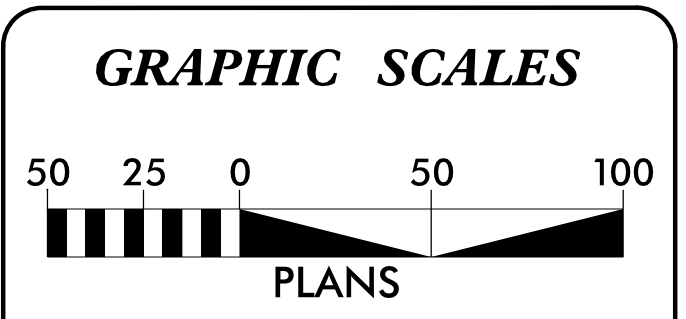
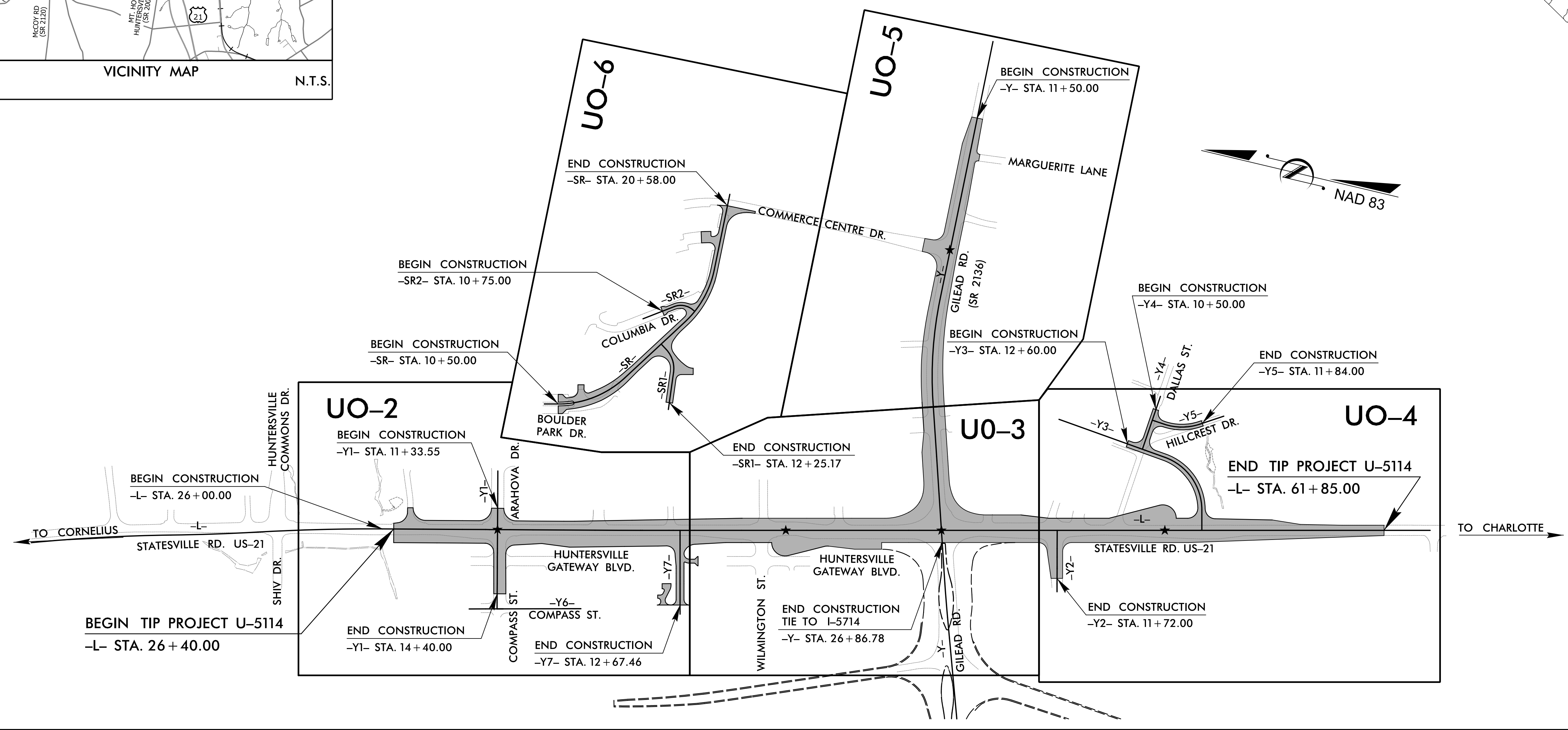
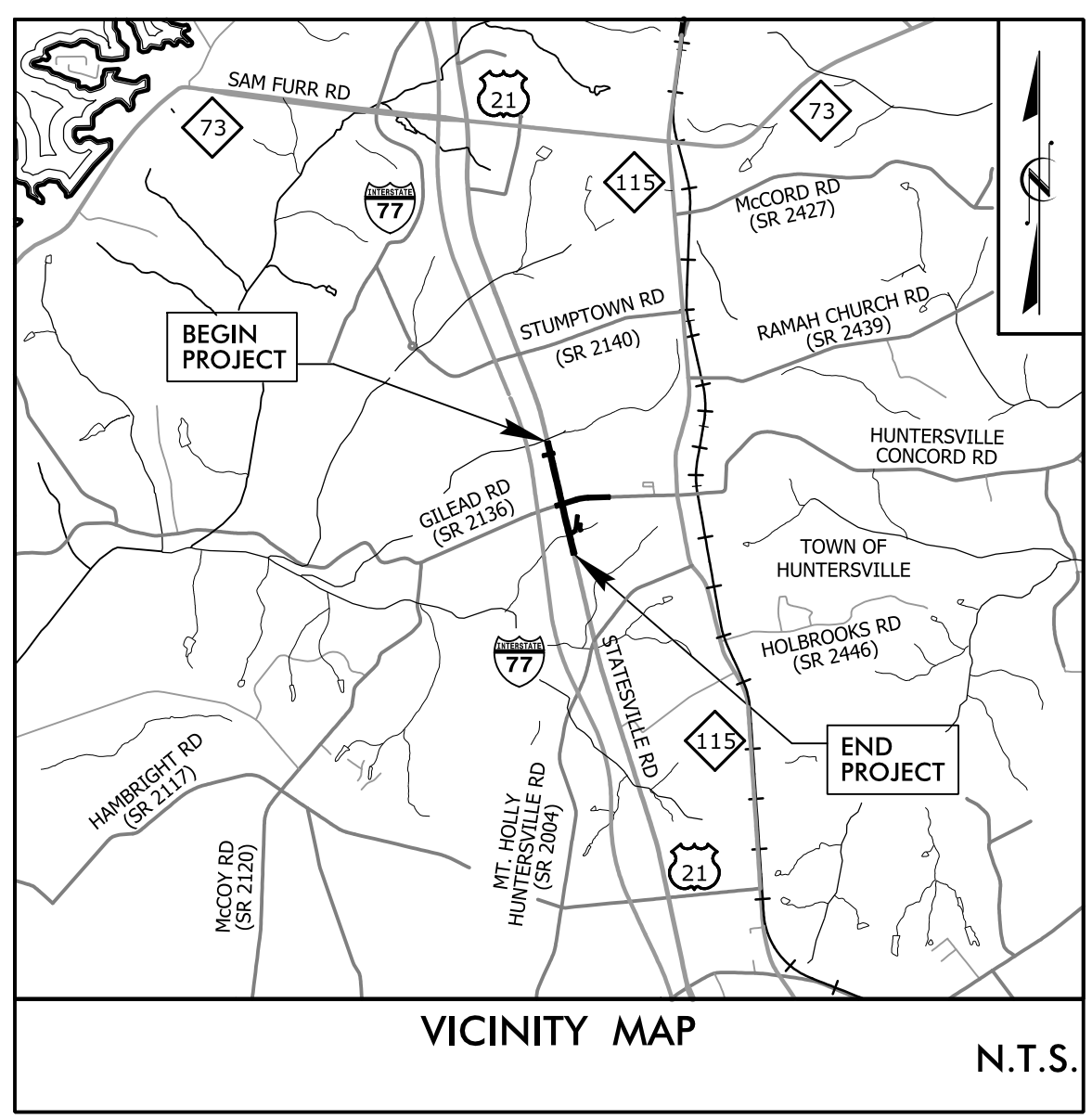
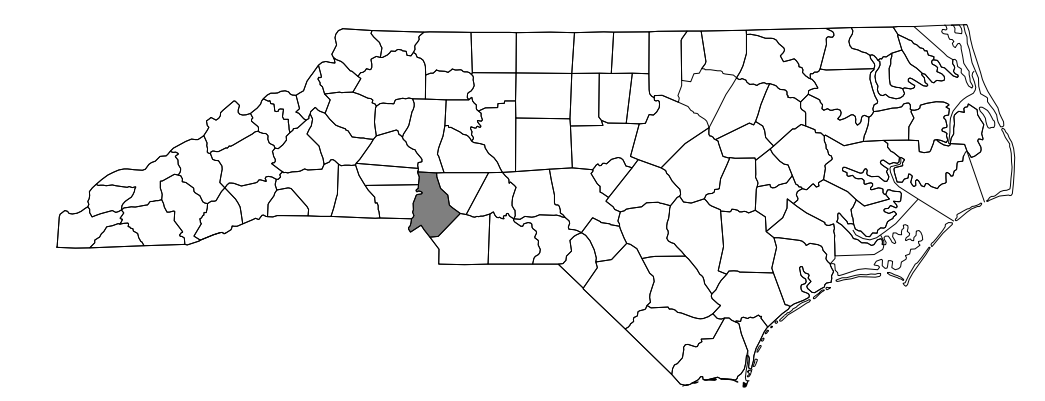

INDEX OF SHEETS

SHEET NO.	DESCRIPTION
UO-1	TITLE SHEET
UO-2 TO UO-6	UTILITIES BY OTHERS PLANS

- UTILITY OWNERS ON PROJECT**
- (1) POWER - DUKE ENERGY & ELECTRICITIES
 - (2) GAS - PEIDMONT NATURAL GAS
 - (3) COMMUNICATIONS - CHARTER COMMUNICATIONS, AT&T, TPRC BROADBAND, & WINDSTREAM

PREPARED BY:

9904 Manor View Drive
Concord, NC 28027
NC License Number P-0324

PREPARED FOR THE OFFICE OF:
**DIVISION OF HIGHWAYS
UTILITIES ENGINEERING
SECTION**

1591 MAIL SERVICES CENTER
RALEIGH, NC 27699-1591
PHONE (919) 250-4128
FAX (919) 250-4119

DAVID JARRETT, P.E. UTILITIES ENGINEER

5/17/2018

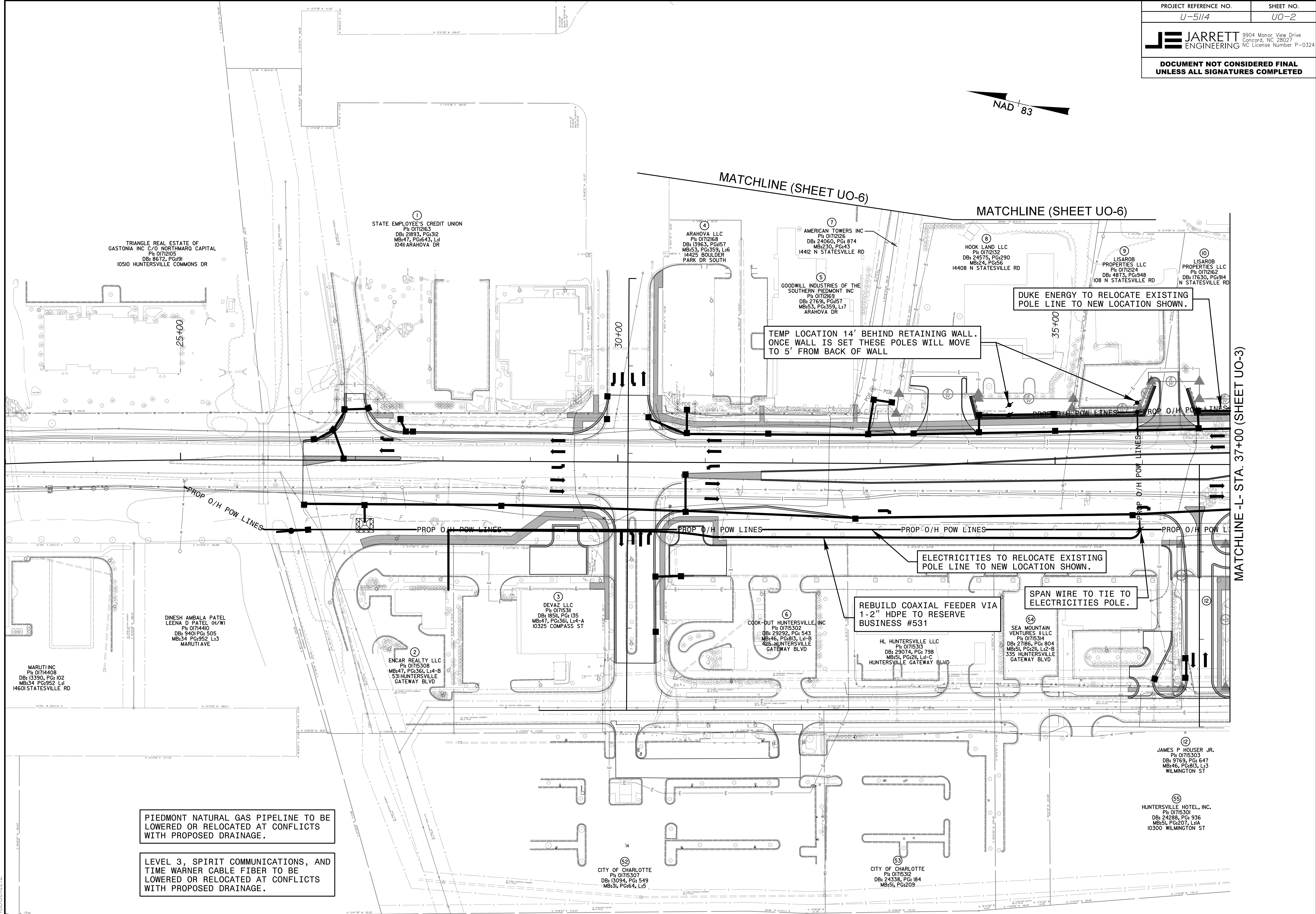
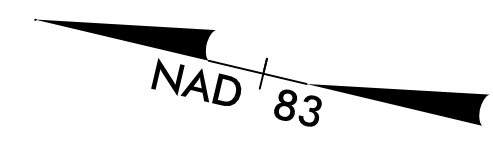

PIEDMONT NATURAL GAS PIPELINE TO BE LOWERED OR RELOCATED AT CONFLICTS WITH PROPOSED DRAINAGE.

LEVEL 3, SPIRIT COMMUNICATIONS, AND TIME WARNER CABLE FIBER TO BE LOWERED OR RELOCATED AT CONFLICTS WITH PROPOSED DRAINAGE.

6/4/2018
 R:\Utilities\ubo_plans\U-5114_ubo_U02.dgn
 mabelaziz

MATCHLINE - L- STA. 37+00 (SHEET UO-3)

MATCHLINE (SHEET UO-6)

MATCHLINE (SHEET UO-6)

TRIANGLE REAL ESTATE OF GASTONIA INC C/O NORTHMARO CAPITAL
 Ph: 01712105
 DB: 8672, PG:91
 10510 HUNTERVILLE COMMONS DR

① STATE EMPLOYEE'S CREDIT UNION
 Ph: 0172163
 DB: 2893, PG:312
 MB:47, PG:643, L1
 10411 ARAHOVA DR

④ ARAHOVA LLC
 Ph: 0172168
 DB: 13963, PG:157
 MB:53, PG:359, L1-6
 14425 BOULDER PARK DR SOUTH

⑦ AMERICAN TOWERS INC
 Ph: 0171226
 DB: 24060, PG: 874
 MB:230, PG:43
 14412 N STATESVILLE RD

⑧ HOOK LAND LLC
 Ph: 0171232
 DB: 24575, PG:290
 MB:24, PG:56
 14408 N STATESVILLE RD

⑨ LISAROB PROPERTIES LLC
 Ph: 0171214
 DB: 4873, PG:948
 MB:17630, PG:914
 108 N STATESVILLE RD

⑩ LISAROB PROPERTIES LLC
 Ph: 01712162
 DB: 17630, PG:914
 N STATESVILLE RD

TEMP LOCATION 14' BEHIND RETAINING WALL. ONCE WALL IS SET THESE POLES WILL MOVE TO 5' FROM BACK OF WALL

DUKE ENERGY TO RELOCATE EXISTING POLE LINE TO NEW LOCATION SHOWN.

ELECTRICITIES TO RELOCATE EXISTING POLE LINE TO NEW LOCATION SHOWN.

REBUILD COAXIAL FEEDER VIA 1-2" HDPE TO RESERVE BUSINESS #531

SPAN WIRE TO TIE TO ELECTRICITIES POLE.

MARUTI INC
 Ph: 0174408
 DB: 13390, PG: 102
 MB:34 PG:952 L1
 14601 STATESVILLE RD

DINESH AMBALA PATEL
 LEENA D PATEL (H/W)
 Ph: 01714410
 DB: 9401 PG: 505
 MB:34 PG:952 L1-3
 MARUTI AVE

② ENCAR REALTY LLC
 Ph: 01715308
 MB:47, PG:361, L1-4-B
 531 HUNTERVILLE GATEWAY BLVD

③ DEVAZ LLC
 Ph: 01715311
 DB: 18511, PG: 135
 MB:47, PG:361, L1-4-A
 10325 COMPASS ST

⑥ COOK-OUT HUNTERVILLE, INC
 Ph: 01715302
 DB: 23292, PG: 543
 MB:46, PG:813, L1-B
 425 HUNTERVILLE GATEWAY BLVD

HL HUNTERVILLE LLC
 Ph: 01715313
 DB: 29074, PG: 798
 MB:51, PG:211, L1-C
 HUNTERVILLE GATEWAY BLVD

⑤ SEA MOUNTAIN VENTURES HILL LLC
 Ph: 01715314
 DB: 27186, PG: 804
 MB:51, PG:211, L1-2-B
 335 HUNTERVILLE GATEWAY BLVD

⑫ JAMES P HOUSER JR.
 Ph: 01715303
 DB: 9769, PG: 647
 MB:46, PG:813, L1-3
 WILMINGTON ST

⑬ HUNTERVILLE HOTEL, INC.
 Ph: 01715301
 DB: 24288, PG: 936
 MB:51, PG:207, L1-A
 10300 WILMINGTON ST

⑭ CITY OF CHARLOTTE
 Ph: 01715307
 DB: 13094, PG: 549
 MB:31, PG:64, L1-5

⑮ CITY OF CHARLOTTE
 Ph: 01715312
 DB: 24338, PG: 184
 MB:51, PG:209

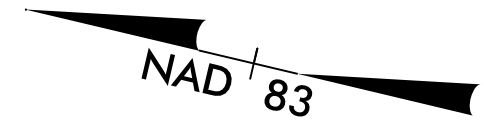

MATCHLINE -Y- STA. 22+00 (SHEET UO-5)

MATCHLINE -L- STA. 37+00 (SHEET UO-2)

MATCHLINE -L- STA. 49+50 (SHEET UO-4)

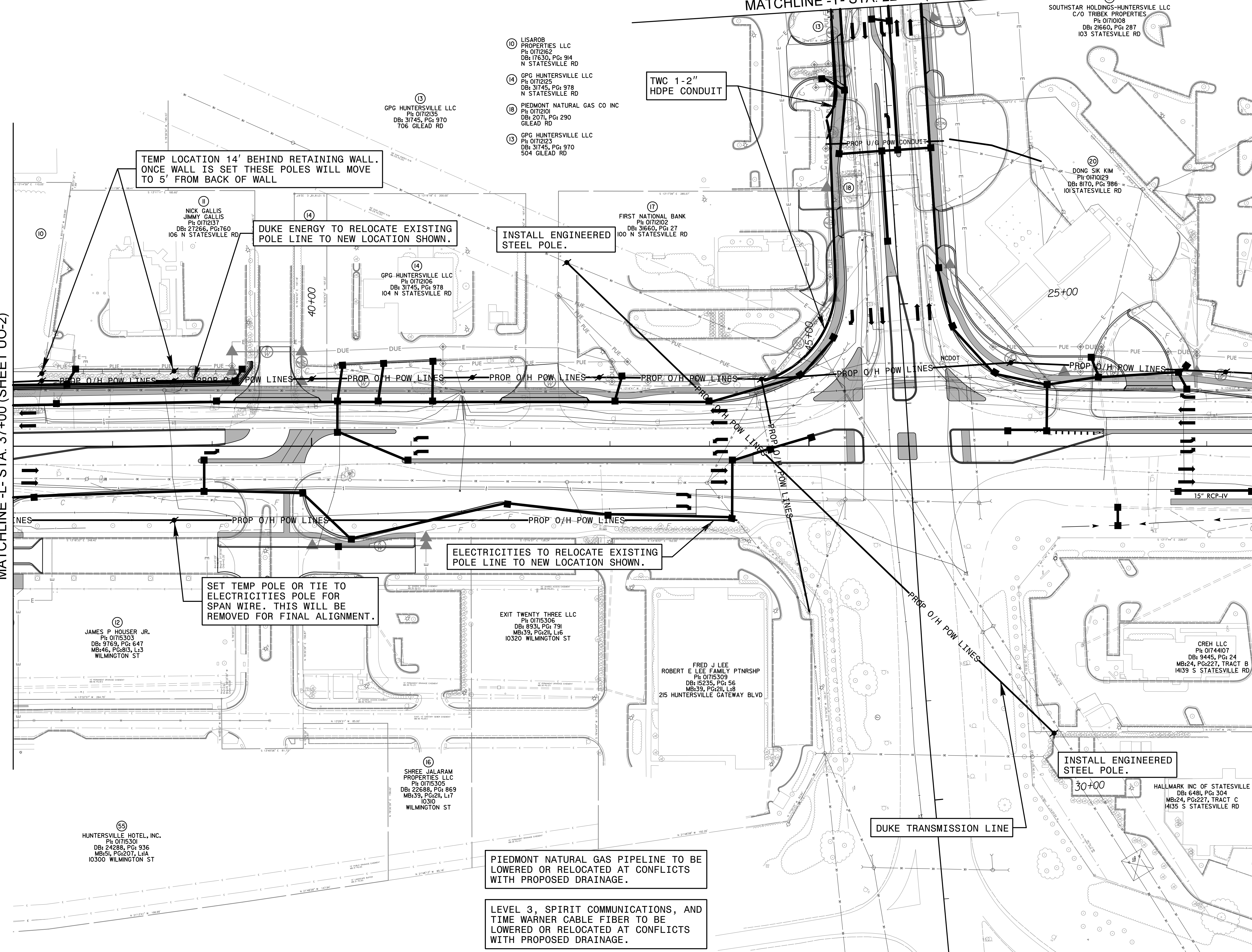

- ⑩ LISAROB PROPERTIES LLC
Pl: 0171262
DB: 17630, PG: 914
N STATESVILLE RD
- ⑪ GPG HUNTERSVILLE LLC
Pl: 0171225
DB: 31745, PG: 978
N STATESVILLE RD
- ⑫ GPG HUNTERSVILLE LLC
Pl: 0171235
DB: 31745, PG: 970
706 GILEAD RD
- ⑬ GPG HUNTERSVILLE LLC
Pl: 0171201
DB: 2371, PG: 290
GILEAD RD
- ⑭ GPG HUNTERSVILLE LLC
Pl: 0171201
DB: 31745, PG: 970
504 GILEAD RD
- ⑮ SOUTHSTAR HOLDINGS-HUNTERSVILLE LLC
C/O TRIBEK PROPERTIES
Pl: 0171009
DB: 21660, PG: 287
103 STATESVILLE RD
- ⑯ DONG SIK KIM
Pl: 0171029
DB: 8170, PG: 986
101 STATESVILLE RD
- ⑰ FIRST NATIONAL BANK
Pl: 0171202
DB: 31660, PG: 27
100 N STATESVILLE RD
- ⑱ NICK GALLIS
JIMMY GALLIS
Pl: 0171237
DB: 27266, PG: 760
106 N STATESVILLE RD
- ⑳ GPG HUNTERSVILLE LLC
Pl: 0171206
DB: 31745, PG: 978
104 N STATESVILLE RD
- ㉑ JAMES P HOUSER JR.
Pl: 0171533
DB: 9769, PG: 647
MB: 46, PG: 813, L: 3
WILMINGTON ST
- ㉒ EXIT TWENTY THREE LLC
Pl: 0171536
DB: 8931, PG: 791
MB: 39, PG: 211, L: 6
10320 WILMINGTON ST
- ㉓ FRED J LEE
ROBERT E LEE FAMILY PTRNSHP
Pl: 0171539
DB: 15235, PG: 56
MB: 39, PG: 221, L: 6
215 HUNTERSVILLE GATEWAY BLVD
- ㉔ SHREE JALARAM PROPERTIES LLC
Pl: 0171535
DB: 22688, PG: 869
MB: 39, PG: 211, L: 7
10310 WILMINGTON ST
- ㉕ HUNTERSVILLE HOTEL, INC.
Pl: 01715301
DB: 24288, PG: 936
MB: 51, PG: 207, L: 1A
10300 WILMINGTON ST
- ㉖ CREH LLC
Pl: 0174407
DB: 9445, PG: 24
MB: 24, PG: 227, TRACT B
14139 S STATESVILLE RD
- ㉗ HALLMARK INC OF STATESVILLE
DB: 6481, PG: 304
MB: 24, PG: 227, TRACT C
14135 S STATESVILLE RD

5/2/2018
 F:\Utilities\ubo_plans\U-5114_ubo_UO3.dgn
 mabelaziz



MATCHLINE -L- STA. 49+50 (SHEET U0-3)

ELECTRICITIES TO INSTALL
CONDUITS FOR FUTURE ACCESS.

DUKE ENERGY TO RELOCATE
EXISTING POLE LINE TO
NEW LOCATION SHOWN.

1-2" HDPE
CONDUIT

PERMANENT RELOCATION OF DUKE ENERGY'S
POWERLINE, POLES, AND HARDWARE.

TRENCH 1-2"
HDPE CONDUIT

DUKE ENERGY TO BUILD TEMPORARY POLE
LINE TO ENABLE NCDOT TO CONSTRUCT EAST
SIDE OF ROADWAY. THIS PORTION OF LINE,
POLES, AND HARDWARE WILL BE REMOVED
UPON COMPLETION OF NEW ROAD BED.

PIEDMONT NATURAL GAS PIPELINE TO BE
LOWERED OR RELOCATED AT CONFLICTS
WITH PROPOSED DRAINAGE.

LEVEL 3, SPIRIT COMMUNICATIONS, AND
TIME WARNER CABLE FIBER TO BE
LOWERED OR RELOCATED AT CONFLICTS
WITH PROPOSED DRAINAGE.

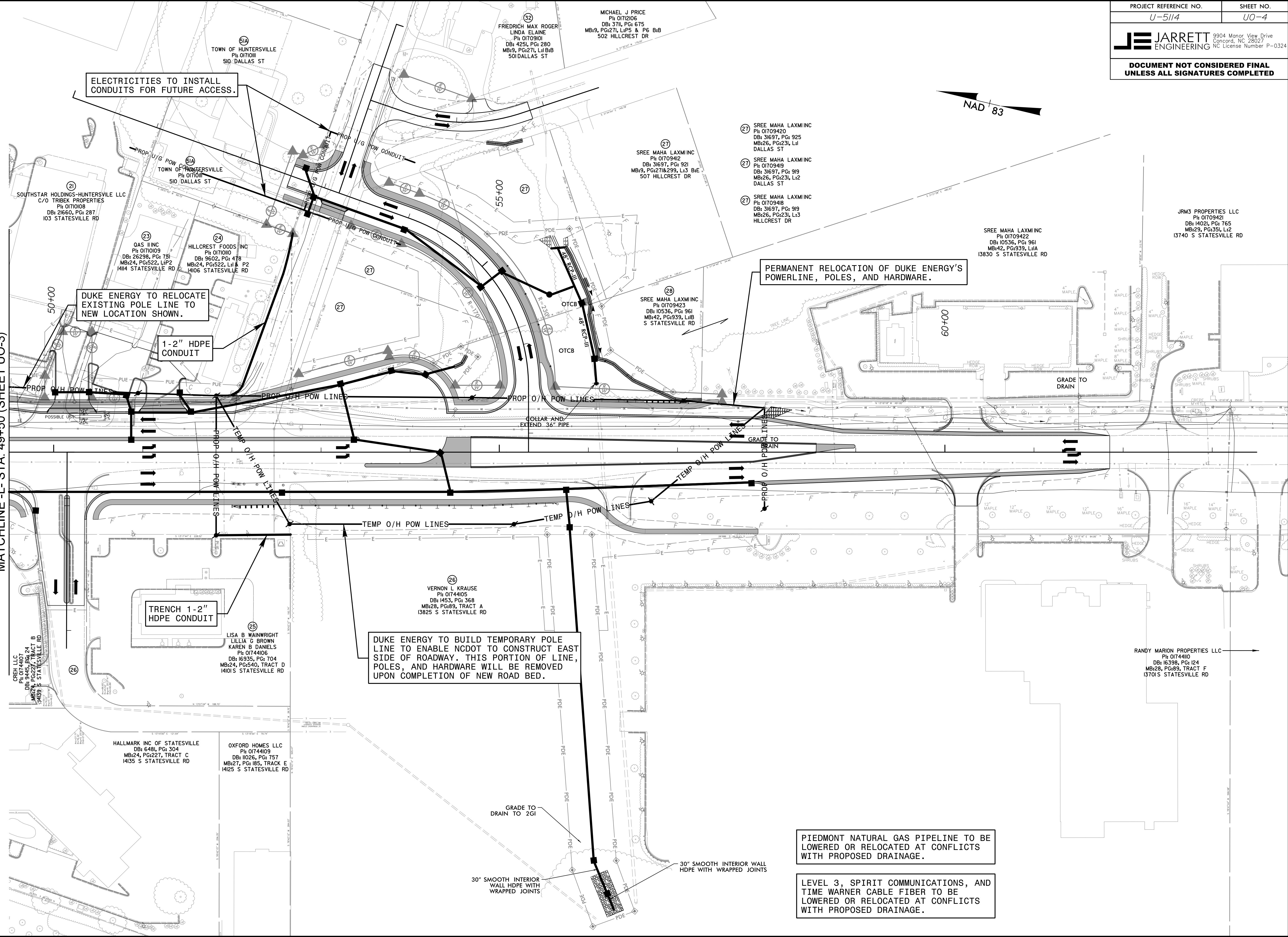

21 SOUTHSTAR HOLDINGS-HUNTERSVILLE LLC
C/O TRIBEX PROPERTIES
Pl: 0170108
DB: 21660, PG: 287
103 STATESVILLE RD

23 OAS II INC
Pl: 0170109
DB: 26298, PG: 751
MB:24, PG:522, LP2
1414 STATESVILLE RD

24 HILLCREST FOODS INC
Pl: 0170110
DB: 9602, PG: 478
MB:24, PG:522, L1 & P2
14106 STATESVILLE RD

32 FRIEDRICH MAX ROGER
LINDA ELAINE
Pl: 0170901
DB: 4251, PG: 280
MB:9, PG:271, L1 B:B
501 DALLAS ST

MICHAEL J PRICE
Pl: 0172106
DB: 371, PG: 675
MB:9, PG:271, L1 P:6 B:B
502 HILLCREST DR

27 SREE MAHA LAXMI INC
Pl: 0170942
DB: 31697, PG: 925
MB:26, PG:231, L:1
DALLAS ST

27 SREE MAHA LAXMI INC
Pl: 0170949
DB: 31697, PG: 919
MB:26, PG:231, L:2
DALLAS ST

27 SREE MAHA LAXMI INC
Pl: 0170948
DB: 31697, PG: 919
MB:26, PG:231, L:3
HILLCREST DR

SREE MAHA LAXMI INC
Pl: 01709422
DB: 10536, PG: 961
MB:42, PG:939, L:1A
13830 S STATESVILLE RD

JRM3 PROPERTIES LLC
Pl: 01709421
DB: 14021, PG: 765
MB:29, PG:351, L:2
13740 S STATESVILLE RD

28 SREE MAHA LAXMI INC
Pl: 01709423
DB: 10536, PG: 961
MB:42, PG:939, L:1B
S STATESVILLE RD

26 VERNON L KRAUSE
Pl: 0174405
DB: 1453, PG: 368
MB:28, PG:89, TRACT A
13825 S STATESVILLE RD

25 LISA B WAINWRIGHT
LILLIA C BROWN
KAREN B DANIELS
Pl: 0174406
DB: 16935, PG: 704
MB:24, PG:540, TRACT D
14101 S STATESVILLE RD

26 CREY LLC
Pl: 0174407
DB: 9445, PG: 24
MB:24, PG:227, TRACT B
14109 S STATESVILLE RD

HALLMARK INC OF STATESVILLE
DB: 6481, PG: 304
MB:24, PG:227, TRACT C
14135 S STATESVILLE RD

OXFORD HOMES LLC
Pl: 0174409
DB: 11026, PG: 757
MB:27, PG: 185, TRACT E
14129 S STATESVILLE RD

RANDY MARION PROPERTIES LLC
Pl: 0174410
DB: 16398, PG: 124
MB:26, PG:89, TRACT F
13701 S STATESVILLE RD

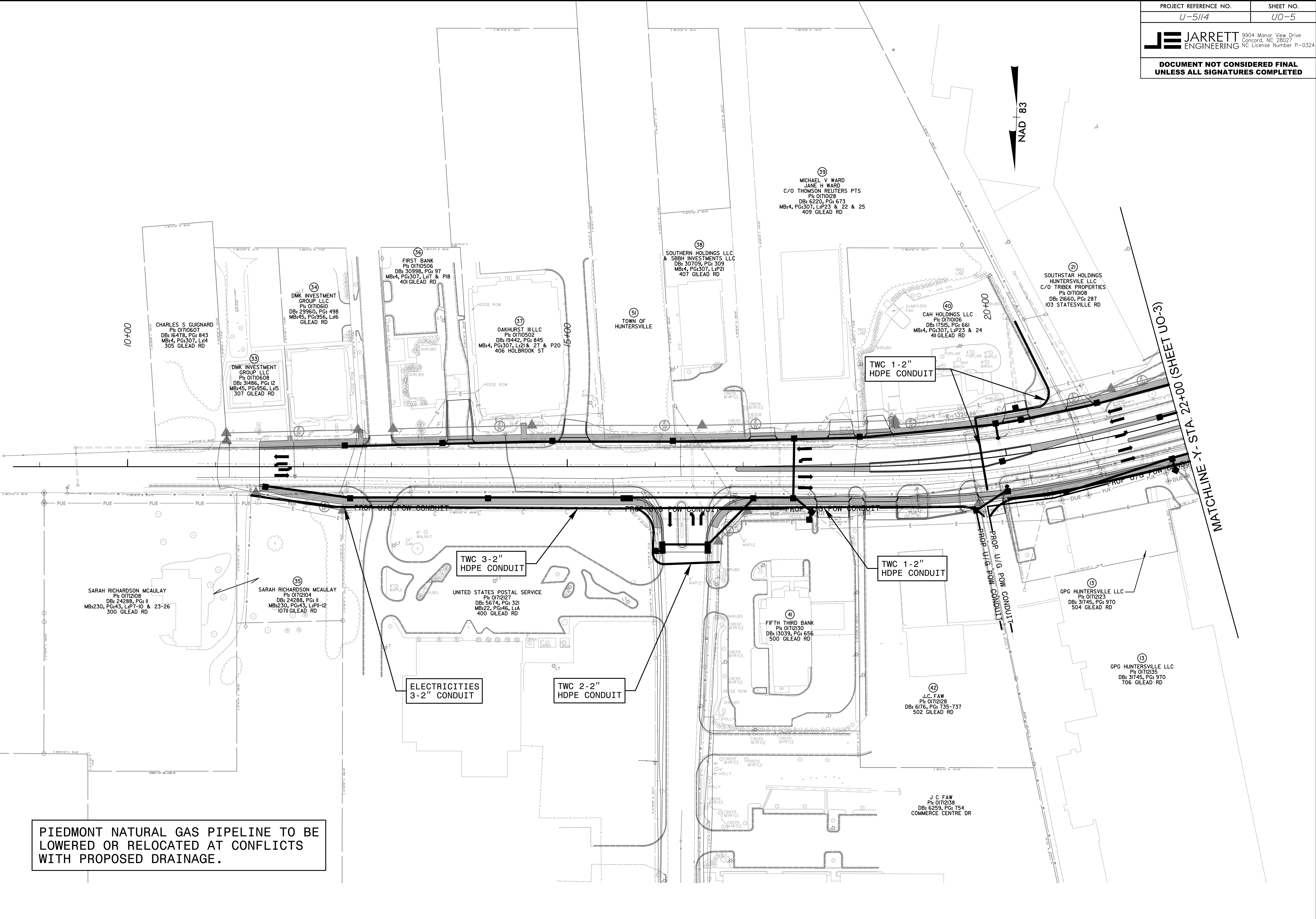
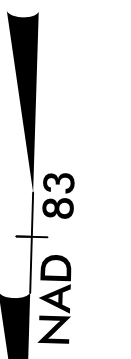

PIEDMONT NATURAL GAS PIPELINE TO BE LOWERED OR RELOCATED AT CONFLICTS WITH PROPOSED DRAINAGE.

MATCHLINE - Y-STA. 22+00 (SHEET U0-3)

5/2/2018
P:\Utilities\ubo_plans\U-5114_UBO_U05.dgn
mabelaziz

SARAH RICHARDSON MCAULLAY
Pl: 0171208
DB: 24288, PG: II
MB: 230, PG: 43, LP: 10, & 23-26
300 GILEAD RD

SARAH RICHARDSON MCAULLAY
Pl: 0171204
DB: 24288, PG: II
MB: 230, PG: 43, LP: 12
10711 GILEAD RD

**ELECTRICITIES
3-2" CONDUIT**

TWC 2-2" HDPE CONDUIT

TWC 3-2" HDPE CONDUIT

UNITED STATES POSTAL SERVICE
Pl: 0171227
DB: 5674, PG: 321
MB: 22, PG: 46, LA
400 GILEAD RD

TWC 2-2" HDPE CONDUIT

FIFTH THIRD BANK
Pl: 0171230
DB: 13039, PG: 656
500 GILEAD RD

TWC 1-2" HDPE CONDUIT

J.C. FAW
Pl: 0171228
DB: 6176, PG: 735-737
502 GILEAD RD

J.C. FAW
Pl: 0171238
DB: 6259, PG: 754
COMMERCE CENTRE DR

PROP. UFG POW CONDUIT

GPG HUNTERSVILLE LLC
Pl: 0171223
DB: 31745, PG: 970
504 GILEAD RD

GPG HUNTERSVILLE LLC
Pl: 0171235
DB: 31745, PG: 970
706 GILEAD RD

TWC 1-2" HDPE CONDUIT

CAH HOLDINGS LLC
Pl: 0171016
DB: 17515, PG: 661
MB: 4, PG: 307, LP: 23 & 24
411 GILEAD RD

SOUTHSTAR HOLDINGS HUNTERSVILLE LLC
C/O TRIBEX PROPERTIES
Pl: 0171018
DB: 21660, PG: 287
103 STATESVILLE RD

MICHAEL V WARD
JANE H WARD
C/O THOMSON RELIERS PTS
Pl: 0171028
DB: 6220, PG: 673
MB: 4, PG: 307, LP: 23 & 22 & 25
409 GILEAD RD

SOUTHERN HOLDINGS LLC & SBBH INVESTMENTS LLC
DB: 30709, PG: 309
MB: 4, PG: 307, LP: 21
407 GILEAD RD

OAKHURST III LLC
Pl: 0171052
DB: 19442, PG: 845
MB: 4, PG: 307, LP: 21 & 27 & P20
406 HOLBROOK ST

FIRST BANK
Pl: 0171056
DB: 30998, PG: 97
MB: 4, PG: 307, LP: 7 & P18
401 GILEAD RD

DMK INVESTMENT GROUP LLC
Pl: 0171010
DB: 29960, PG: 498
MB: 45, PG: 956, LP: 6
GILEAD RD

DMK INVESTMENT GROUP LLC
Pl: 0171069
DB: 31486, PG: 12
MB: 45, PG: 956, LP: 5
307 GILEAD RD

CHARLES S GUIGNARD
Pl: 01710607
DB: 16478, PG: 843
MB: 4, PG: 307, LP: 14
305 GILEAD RD

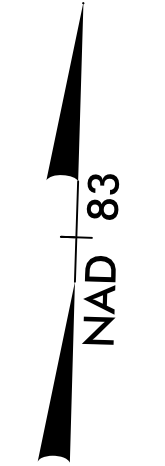

MATCHLINE (SHEET UO-2)

MATCHLINE (SHEET UO-2)

MATCHLINE (SHEET UO-3)

5
GOODWILL INDUSTRIES OF THE SOUTHERN PIEDMONT INC
Pl: 0171269
DB: 27631, PG: 57
MB: 53, PG: 359, L: 7
ARAHOVA DR

44
JAMES FUNERAL SERVICES LLC
Pl: 0171266
DB: 26647, PG: 81
MB: 53, PG: 359, L: 4
ARAHOVA DR

45
PARKVIEW NC ASSOCIATES LP
Pl: 0171240
DB: 904, PG: 703
MB: 30, PG: 845, L: B
301 COLUMBIA DR

7
AMERICAN TOWERS INC
Pl: 0171216
DB: 24060, PG: 874
MB: 230, PG: 43
1442 N STATESVILLE RD

46
PIEMONT NATURAL GAS INC
Pl: 0171271
DB: 26150, PG: 660
MB: 53, PG: 29, L: 9
1445 BOULDER PARK DR SOUTH

49
PARKVIEW NC ASSOCIATES LP
Pl: 0171257
DB: 904, PG: 703
MB: 30, PG: 845, L: D
221 COMMERCE CENTRE DR

FOUR & ASSOCIATES
Pl: 0171234
DB: 5542, PG: 39
MB: 55, PG: 540/541, L: 2
COMMERCE CENTRE DR

13
GPG HUNTERSVILLE LLC
Pl: 0171220
DB: 31745, PG: 970
706 GILEAD RD

48
NHC PARTNERSHIP 8 LP
Pl: 0171256
DB: 10408, PG: 134
MB: 30, PG: 845, L: A
COMMERCE CENTRE DR

JOLLEY-NESTOR ENTERPRISES LLC
Pl: 0171261
DB: 15341, PG: 144
MB: 39, PG: 393, TRACT: 2
122 COMMERCE CENTRE DR

13
GPG HUNTERSVILLE LLC
Pl: 0171235
DB: 31745, PG: 970
706 GILEAD RD

GLENN GARRIS DADRE GARRIS
Pl: 0171239
DB: 8770, PG: 946
MB: 24, PG: 264, PART OF TRACT 2
115 COMMERCE CENTRE DR

CHARLES FAMILY LP
Pl: 0171233
DB: 10518, PG: 350
MB: 24, PG: 264, TRACT: 1
102 COMMERCE CENTRE DR

J C FAW
Pl: 0171238
DB: 6259, PG: 754
COMMERCE CENTRE DR

SINGLE STORY BRICK "THE DANCE SPOT"

SINGLE STORY WOOD FRAME "THE PETITE ACADEMY"

SINGLE STORY BLOCK

SINGLE STORY BRICK "ROSDALE ID"

PROP U/G POW CONDUIT

15+00

20+00