

PHASING DIAGRAM

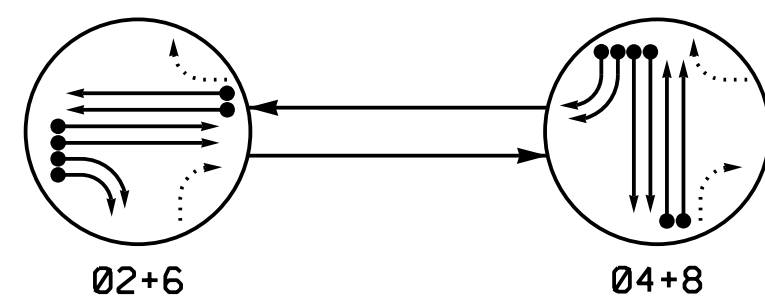

PHASING DIAGRAM DETECTION LEGEND

- DETECTED MOVEMENT
- ◄ UNDETECTED MOVEMENT (OVERLAP)
- ◄ UNSIGNALIZED MOVEMENT
- ◄ PEDESTRIAN MOVEMENT

SIGNAL FACE I.D.

All Heads L.E.D.

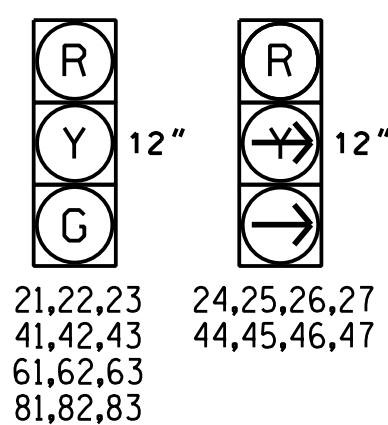

TABLE OF OPERATION

SIGNAL FACE	PHASE		
	02+6	04+8	FLASH
21,22,23	G	R	Y
24,25,26,27	-	R	Y
41,42,43	R	G	R
44,45,46,47	R	-	R
61,62,63	G	R	Y
81,82,83	R	G	R

OASIS 2070E LOOP & DETECTOR INSTALLATION CHART

LOOP	SIZE (FT)	DISTANCE FROM STOPBAR (FT)	TURNS	NEW LOOP	DETECTOR PROGRAMMING				STRETCH TIME	DELAY TIME	SYSTEM LOOP	NEW CARD
					PHASE	CALLING	EXTENSION	FULL TIME DELAY				
2A	6X6	70	*	*	2	Y	Y	-	-	-	-	*
2B	6X6	70	*	*	2	Y	Y	-	-	-	-	*
2C	6X6	70	*	*	2	Y	Y	-	-	-	-	*
2D	6X6	70	*	*	2	Y	Y	-	-	-	-	*
4A	6X6	300	*	*	4	-	Y	-	2.4	-	-	*
4B	6X6	300	*	*	4	-	Y	-	2.4	-	-	*
4C	6X40	0	*	*	4	Y	Y	-	-	-	-	*
4D	6X40	0	*	*	4	Y	Y	-	-	-	-	*
4E	6X40	0	*	*	4	Y	Y	-	-	15	-	*
4F	6X40	0	*	*	4	Y	Y	-	-	15	-	*
6A	6X6	70	*	*	6	Y	Y	-	-	-	-	*
6B	6X6	70	*	*	6	Y	Y	-	-	-	-	*
8A	6X6	300	*	*	8	-	Y	-	2.4	-	-	*
8B	6X6	300	*	*	8	-	Y	-	2.4	-	-	*
8C	6X40	0	*	*	8	Y	Y	-	-	-	-	*
8D	6X40	0	*	*	8	Y	Y	-	-	-	-	*

* Video Detection Zone

2 Phase Fully Actuated Gilead Road Closed Loop System

NOTES

1. Refer to "Roadway Standard Drawings NCDOT" dated January 2018 and "Standard Specifications for Roads and Structures" dated January 2018.
2. Do not program signal for late night flashing operation unless otherwise directed by the Engineer.
3. Set all detector units to presence mode.
4. Reposition existing signal heads numbered 21,22,23,24,25,26,27,44, 45,46,47,61,63,62,81, and 82.
5. Incorporate Video Detection system for vehicle detection.
6. Provide the Engineer with the Manufacturer's approved Video Detection locations and mounting heights to obtain detection zones as shown.
7. Maximum times shown in timing chart are for free-run operation only. Coordinated signal system timing values supersede these values.
8. Closed loop system data: Master Asset #11042 Controller Asset #0617

LEGEND

- | PROPOSED | EXISTING |
|----------|----------|
| | |
| | |
| | |
| | |
| | |
| | |
| | |
| | |
| | |
| | |
| | |
| | |
| | |
| | |
| | |
| | |
| | |
| | |
| | |

OASIS 2070E TIMING CHART

FEATURE	PHASE			
	2	4	6	8
Min Green 1 *	10	7	10	7
Extension 1 *	3.0	2.0	3.0	2.0
Max Green 1 *	60	30	60	30
Yellow Clearance	4.0	4.3	3.9	4.3
Red Clearance	2.1	2.8	3.6	1.7
Red Revert	2.0	2.0	2.0	2.0
Walk 1 *	-	-	-	-
Don't Walk 1 *	-	-	-	-
Seconds Per Actuation *	-	-	-	-
Max Variable Initial *	-	-	-	-
Time Before Reduction *	-	-	-	-
Time To Reduce *	-	-	-	-
Minimum Gap	-	-	-	-
Recall Mode	MIN RECALL	-	MIN RECALL	-
Vehicle Call Memory	YELLOW	-	YELLOW	-
Dual Entry	-	ON	-	ON
Simultaneous Gap	ON	ON	ON	ON

* These values may be field adjusted. Do not adjust Min Green and Extension times for phases 2 and 6 lower than what is shown. Min Green for all other phases should not be lower than 4 seconds.

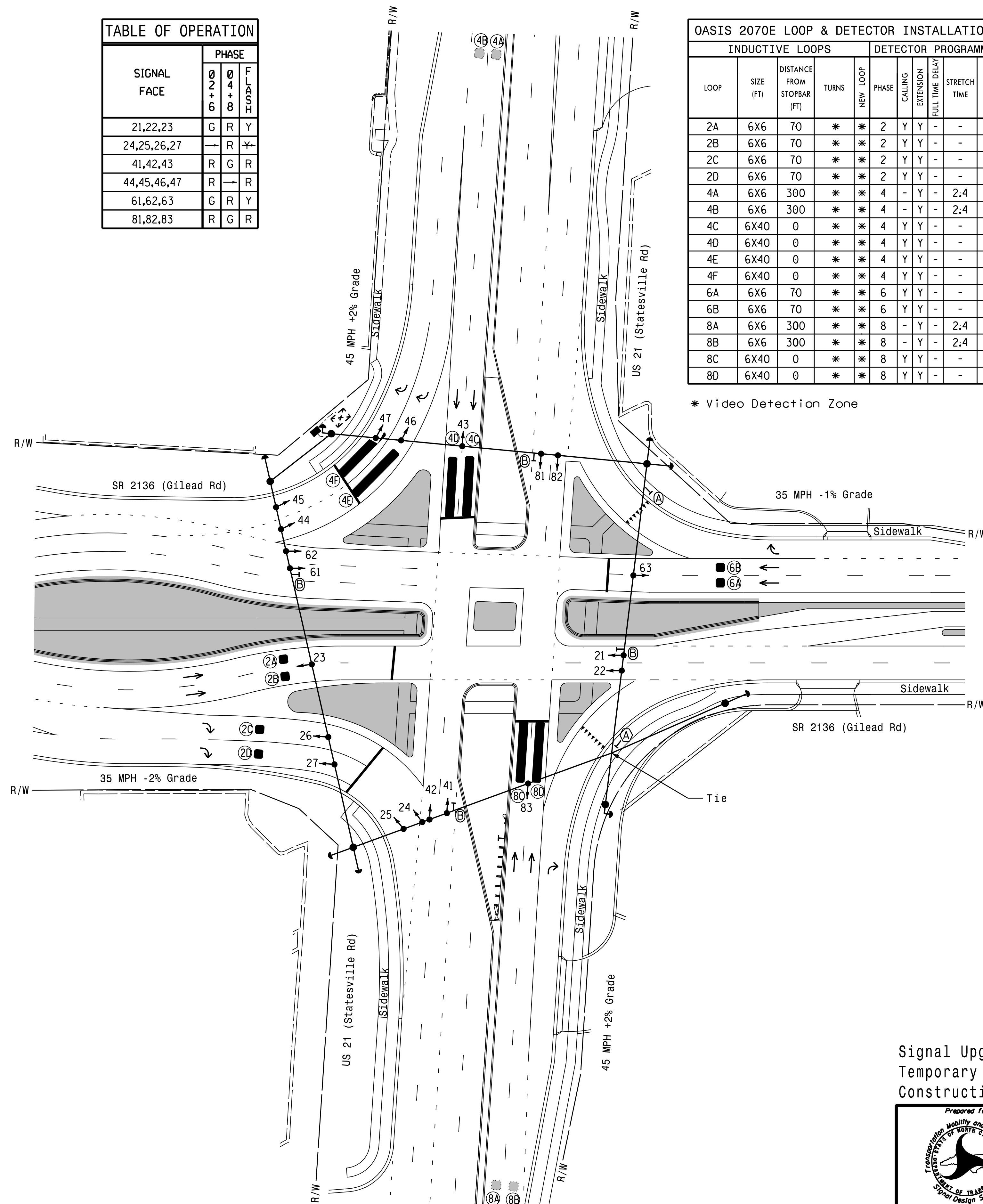

Signal Upgrade
Temporary Design 5
Construction Phases IIIB,IV,V

DOCUMENT NOT CONSIDERED FINAL UNLESS ALL SIGNATURES COMPLETED

<p>HNTB NORTH CAROLINA, P.C. 343 E. Six Forks Road, Suite 200 Raleigh, North Carolina 27609 NC License No: C-1554 (919) 546-8997</p>	<p>SR 2136 (Gilead Road) at US 21 (Statesville Road)</p> <p>Division 10 Mecklenburg Co., Huntersville PLAN DATE: December 2017 REVIEWED BY: A.D. Klinksiek PREPARED BY: J.T. Thibault REVIEWED BY: N.R. Simmons</p>	<p>SEAL</p> <p>NORTH CAROLINA PROFESSIONAL ENGINEER SEAL 031464 N. R. SIMMONS</p>
	<p>750 N. Greenfield Pkwy, Garner, NC 27529</p> <p>SCALE: 1" = 40'</p> <p>REVISIONS: _____</p> <p>INITIALS: _____ DATE: 4/23/2018</p> <p>SIGNATURE: _____ DATE: _____</p> <p>SIG. INVENTORY NO. 10-0617 TS</p>	<p>SEAL</p> <p>NORTH CAROLINA PROFESSIONAL ENGINEER SEAL 031464 N. R. SIMMONS</p>