

PAVEMENT SCHEDULE

		U	EXISTING PAVEMENT
C1	1½" ASPHALT CONCRETE SURFACE COURSE, TYPE S9.5C, AT AN AVERAGE RATE OF 168 LBS. PER SQ. YD.	V1	1½" MILLING
C2	2" ASPHALT CONCRETE SURFACE COURSE, TYPE S9.5C, AT AN AVERAGE RATE OF 224 LBS. PER SQ. YD.	V2	0-1½" MILLING (AS DIRECTED BY THE ENGINEER)
S	SHOULDER GRADING ASB REQUIRED	V3	0-½" MILLING (AS DIRECTED BY THE ENGINEER)

PROJECT REFERENCE NO.

2020CPT.05.01.10351.1

SHEET NO.

2

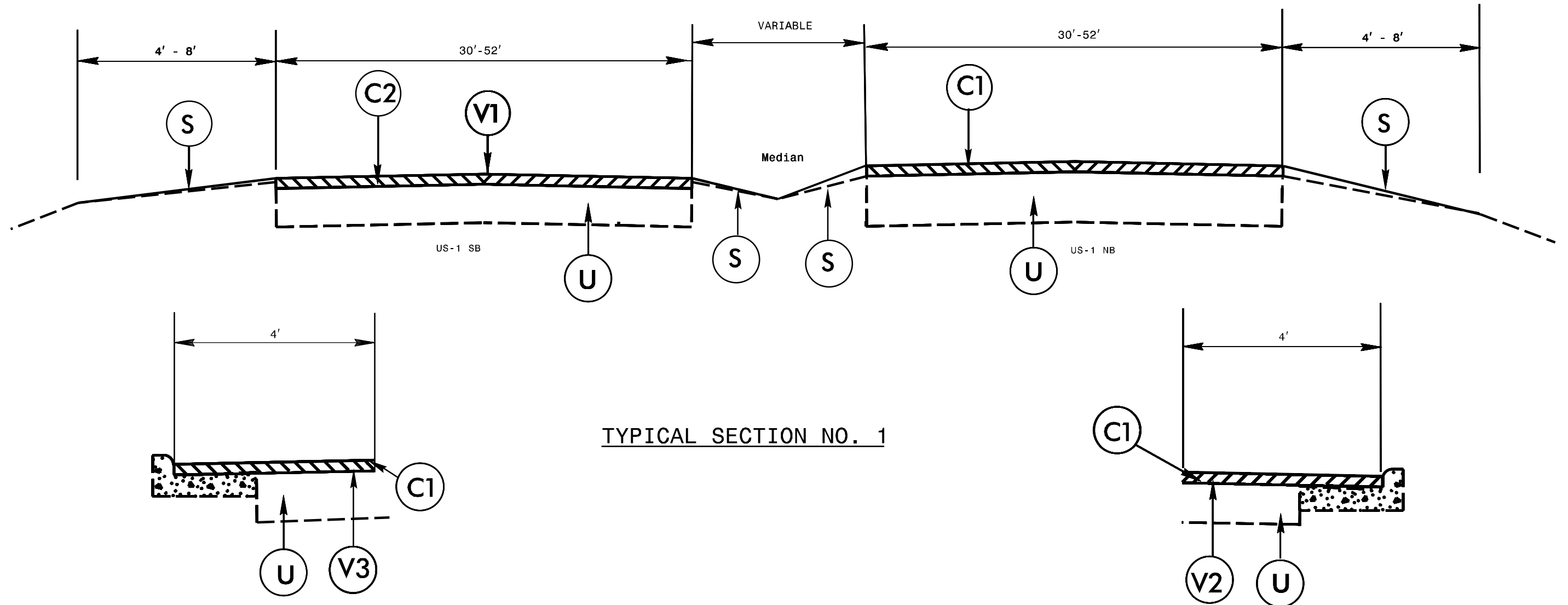

TYPICAL SECTION NO. 1

PAVEMENT SCHEDULE		U	EXISTING PAVEMENT
C1	1½" ASPHALT CONCRETE SURFACE COURSE, TYPE S9.5C, AT AN AVERAGE RATE OF 168 LBS. PER SQ. YD.	V1	1½" MILLING
C2	2" ASPHALT CONCRETE SURFACE COURSE, TYPE S9.5C, AT AN AVERAGE RATE OF 224 LBS. PER SQ. YD.	V2	0-1½" MILLING (AS DIRECTED BY THE ENGINEER)
S	SHOULDER GRADING ASB REQUIRED	V3	0-½" MILLING (AS DIRECTED BY THE ENGINEER)

PROJECT REFERENCE NO.	SHEET NO.
2020CPT.05.01.10351.1	3

NOTES

ALL UNPAVED S.R. ROADS TO BE RESURFACED 50' FROM EDGE OF PAVEMENT OF MAIN PROJECT
 ALL PAVED S.R. ROADS TO BE RESURFACED TO THE ENDS OF THE RADII, OR AS DIRECTED BY THE ENGINEER.
 EDGES, PAVEMENT WIDENING, INTERSECTIONS AND BRIDGE FLARES ARE INCLUDED IN THE TABLE OF QUANTITIES.
 BRIDGES TO BE RESURFACED AT LOCATIONS AND TO DEPTH AS DIRECTED BY THE ENGINEER.

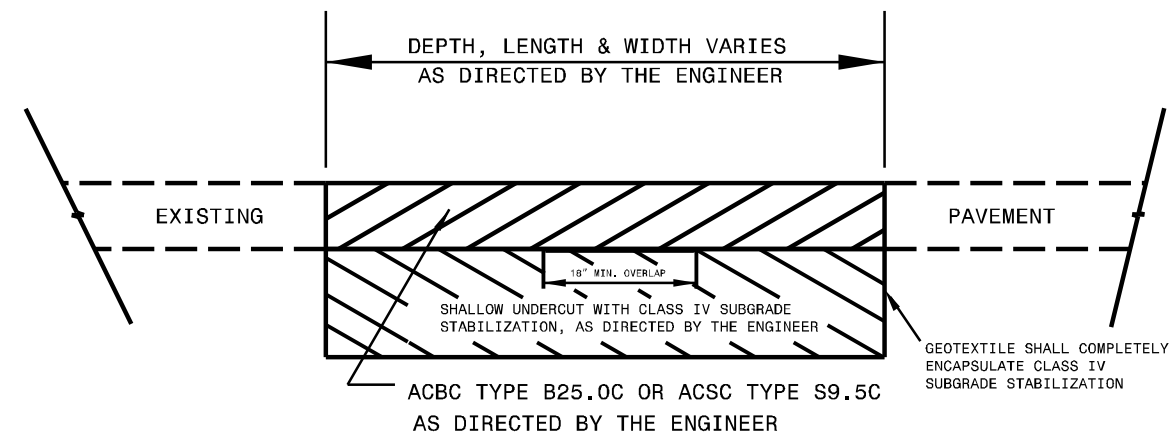
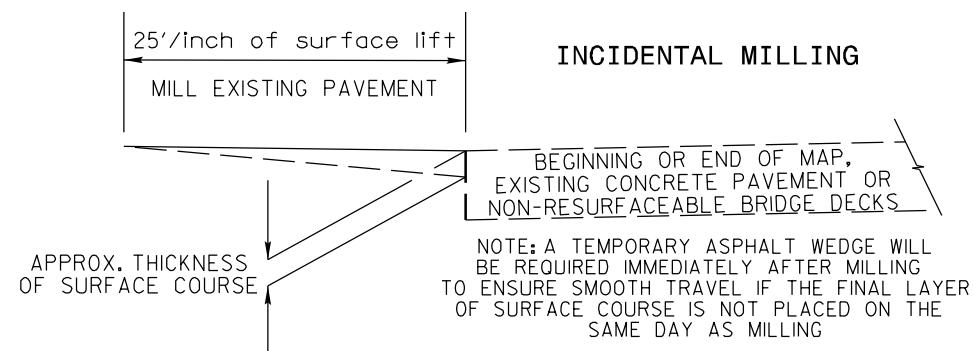

PATCHING EXISTING PAVEMENT

*MILLING TO BE PERFORMED PRIOR TO PATCHING
 *UNDERCUT REQUIRED ONLY IN AREAS AS DIRECTED BY THE ENGINEER

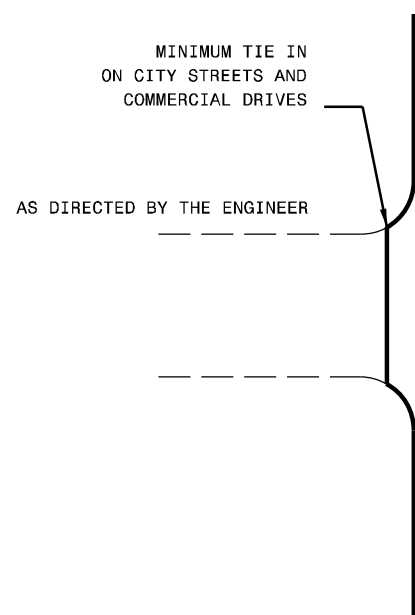

DETAIL OF PROJECT LIMITS AT SIGNALIZED Y LINES

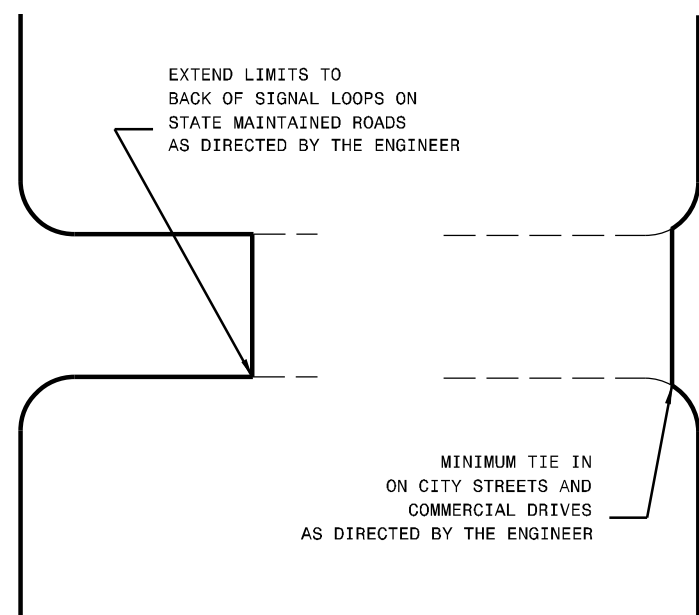

DETAIL OF PROJECT LIMITS AT UNSIGNALIZED Y LINES

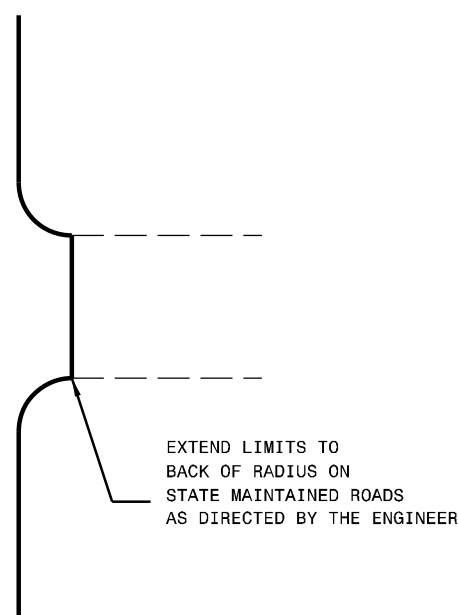
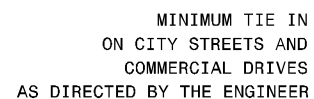

- NOTES:
- 1) DETAIL DOES NOT APPLY TO OGAFAC AND ULTRA-THIN BONDED WEARING COURSE.
 - 2) BACKFILL SHOULDER WITH APPROVED MATERIAL.
 - 3) THE SHOULDER WEDGE DEVICE MAY BE DISENGAGED AT PAVED DRIVEWAYS, SIDE STREETS, HIGH SHOULDERS, AND OTHER LOCATIONS NOT FEASIBLE TO CONSTRUCT AS APPROVED BY THE ENGINEER.

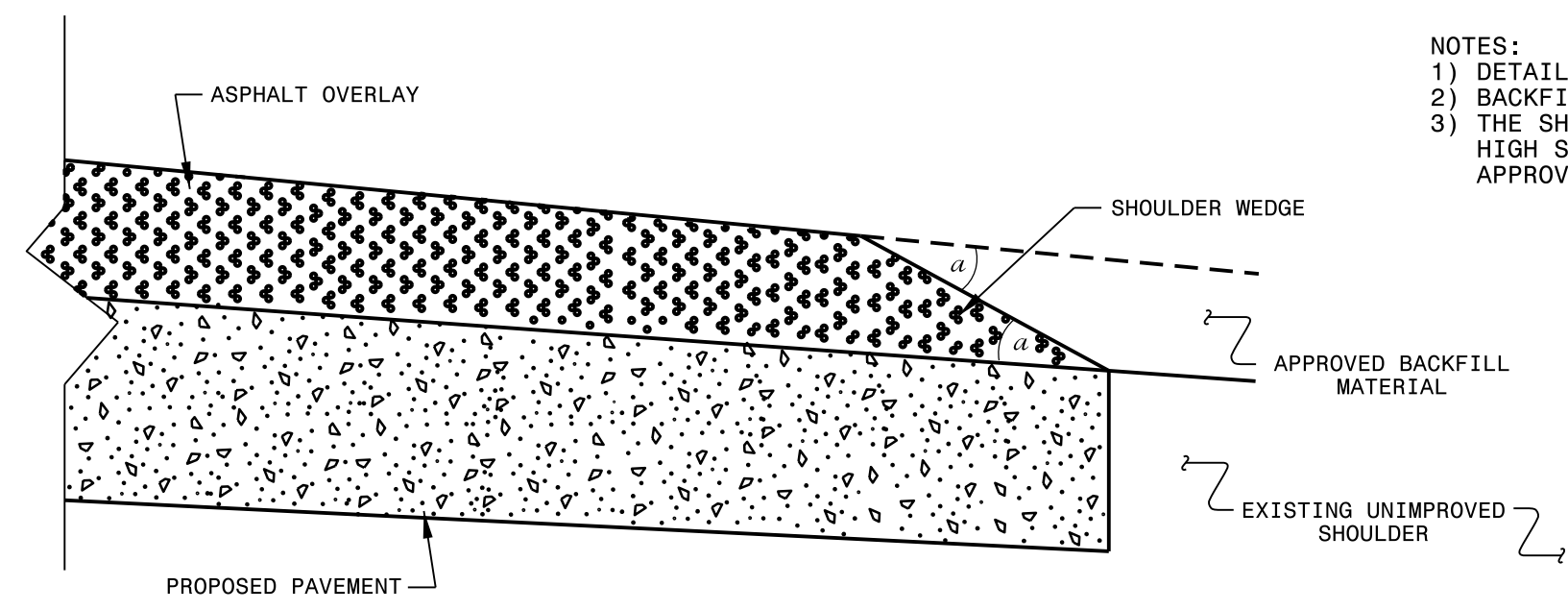

SHOULDER WEDGE DETAIL
 (Resurfacing Projects w/ Widening or
 with Existing Paved Shoulder having no dropoffs)

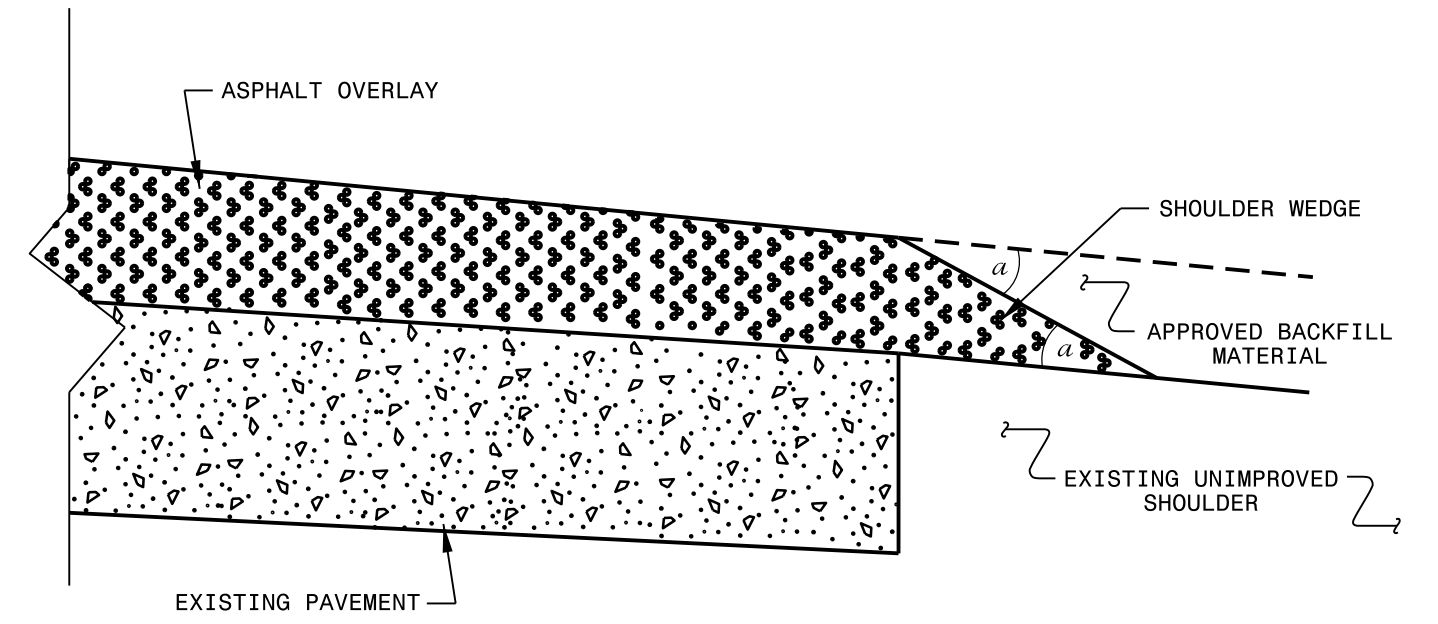

SHOULDER WEDGE DETAIL
 (Resurfacing Projects w/ NO Widening)

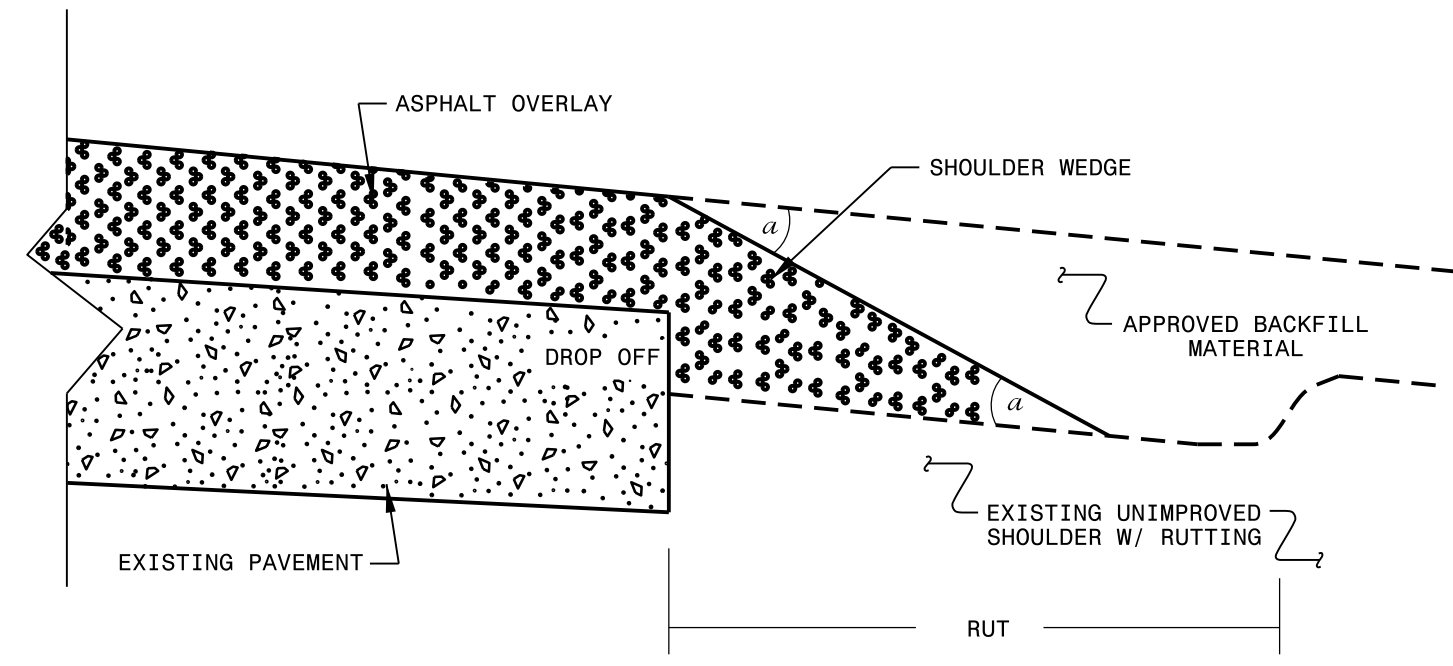

SHOULDER WEDGE DETAIL
 (Resurfacing Adjacent to
 Rutted Shoulder)

- SHOULDER WEDGE ANGLE = 30°

**CONTRACT STANDARDS
 AND DEVELOPMENT UNIT**
 Office 919-707-6950 FAX 919-250-4119

**SHOULDER WEDGE
 DETAILS**

ORIGINAL BY: T.SPELL DATE: 7-19-11
 MODIFIED BY: DATE: 2/2/16
 CHECKED BY: DATE:
 FILE SPEC.: s:usr/details/stand/shoulderwedgedetail.dgn

DOCUMENT NOT CONSIDERED FINAL
 UNLESS ALL SIGNATURES COMPLETED

\$\$\$\$\$SYTIME\$\$\$\$\$
 \$\$\$DONOR\$\$\$\$\$
 \$\$\$CUSTNAME\$\$\$\$\$
 \$\$\$\$\$\$\$\$

PROJECT NO.	SHEET NO.	TOTAL NO.
2020CPT.05.01.10351.1	5	

SUMMARY OF QUANTITIES

PROJECT NO	COUNTY	MAP NO	ROUTE	DESCRIPTION	TYP NO	LANES	FINAL SURFACE TESTING REQUIRED	WARM MIX ASPHALT REQUIRED	LENGTH	WIDTH	0196000000-E	0264000000-E	1099500000-E	1099700000-E	1220000000-E	1260000000-E	1297000000-E	1308000000-E	1330000000-E	1523000000-E	1575000000-E	1704000000-E	8150000000-E	2550000000-E	7444000000-E	
											GEOTEXTILE FOR SOIL STABILIZATION	SHOULDER GRADING	SHALLOW UNDERCUT	CLASS IV SUBGRADE STABILIZATION	INCIDENTAL STONE BASE	AGGREGATE SHOULDER BORROW	1 1/2" MILLING	0" TO .5" MILLING	0" TO 1.5" MILLING	INCIDENTAL MILLING	SURFACE COURSE, S9.5C	ASPHALT BINDER FOR PLANT MIX	PATCHING EXISTING PAVEMENT	ADJUST DROP INLET	PORTABLE LIGHTING	INDUCTIVE LOOP SAWCUT
											SY	SMI	CY	TON	TONS	TON	SY	SY	SY	SY	TONS	TON	TONS	EA	LS	LF
2020CPT.05.01.10351.1	Franklin	1	US HWY 1 SB	VANCE CO TO WAKE CO	1	2	NO	NO	11.82	30	1,200.00	23.57	400	800	589	732	234,341	369		7,850	28,588	1,715	447		*	986
2020CPT.05.01.10351.1	Franklin	2	US HWY 1 NB	WAKE CO TO VANCE CO	1	2	NO	NO	11.8	30		22.96			579	2,138			1,503	12,963	22,223	1,333	1,056	7	*	
TOTAL FOR PROJ NO. 2020CPT.05.01.10351.1									23.62		1,200.00	46.53	400	800	1,168	2,870	234,341	369	1,503	20,813	50,811	3,048	1,503	7	1	986
GRAND TOTAL									23.62		1,200.00	46.53	400	800	1,168	2,870	234,341	369	1,503	20,813	50,811	3,048	1,503	7	1	986

Refer to standard drawing 1205.06 for pavement marking lane drops.

THERMOPLASTIC AND PAINT QUANTITIES

PROJECT NO	COUNTY	MAP NO	ROUTE	DESCRIPTION	TYP NO	LANES	LENGTH	WIDTH	13000000-E	700000-E	4510000000-N	4685000000-E		4686000000-E	4695000000-E	4700000000-E	4705000000-E	71000000-E	7210000000-E	4725000000-E				4770000000-E		4810000000-E				82000000-E	85000000-E	4845000000-N				8500000000-E	9050000000-E
									WORK ZONE ADVANCE/GENERAL WARNING SIGNING	TEMPORARY TRAFFIC CONTROL	LAW ENFORCEMENT	4" X 90 M WHITE THERMO	4" X 90 M YELLOW THERMO	4" X 120 M WHITE THERMO	8" X 90 M WHITE THERMO	12" X 90 M WHITE THERMO	16" X 120 M WHITE THERMO	24" X 120 M WHITE THERMO	THERMO RXR 120 M	THERMO LT ARROW 90 M	THERMO RT ARROW 90 M	THERMO STR ARROW 90 M	THERMO STR & LT ARROW 90 M	4" YELLOW COLD APPLIED PLASTIC, TYPE II	4" WHITE COLD APPLIED PLASTIC, TYPE II	4" YELLOW PAINT	4" WHITE PAINT	8" WHITE PAINT	24" WHITE PAINT	PAINT LT ARROW	PAINT RT ARROW	PAINT STR ARROW	PAINT STR & LT ARROW	4" LINE REMOVAL	SNOW PLOWABLE MARKERS		
									SF	LS	HR	LF	LF	LF	LF	LF	LF	LF	EA	EA	EA	EA	EA	LF	LF	LF	LF	LF	LF	EA	EA	EA	EA	EA	EA	EA	EA
2020CPT.05.01.10351.1	Franklin	1	US HWY 1 SB	VANCE CO TO WAKE CO	1	2	11.82	30-52	1,324	0.49	120	62,576	61,194	29,142	2,602	320		667		95	23	28	2	327	411	61,194	91,718	2,602	667	95	23	28	2	738	1,126		
2020CPT.05.01.10351.1	Franklin	2	US HWY 1 NB	WAKE CO TO VANCE CO	1	2	11.8	30-52	1,322	0.51	120	63,484	61,194	31,035	2,294	721	50	588	2	89	47	24	2	334	415									749	1,130		
TOTAL FOR PROJ NO. 2020CPT.05.01.10351.1									23.62		240	126,060	122,388	60,177	4,896	1,041	50	1,255	2	184	70	52	4	661	826	61,194	91,718	2,602	667	95	23	28	2	1,487	2,256		
GRAND TOTAL									23.62		240	126,060	122,388	60,177	4,896	1,041	50	1,255	2	184	70	52	4	661	826	61,194	91,718	2,602	667	95	23	28	2	1,487	2,256		

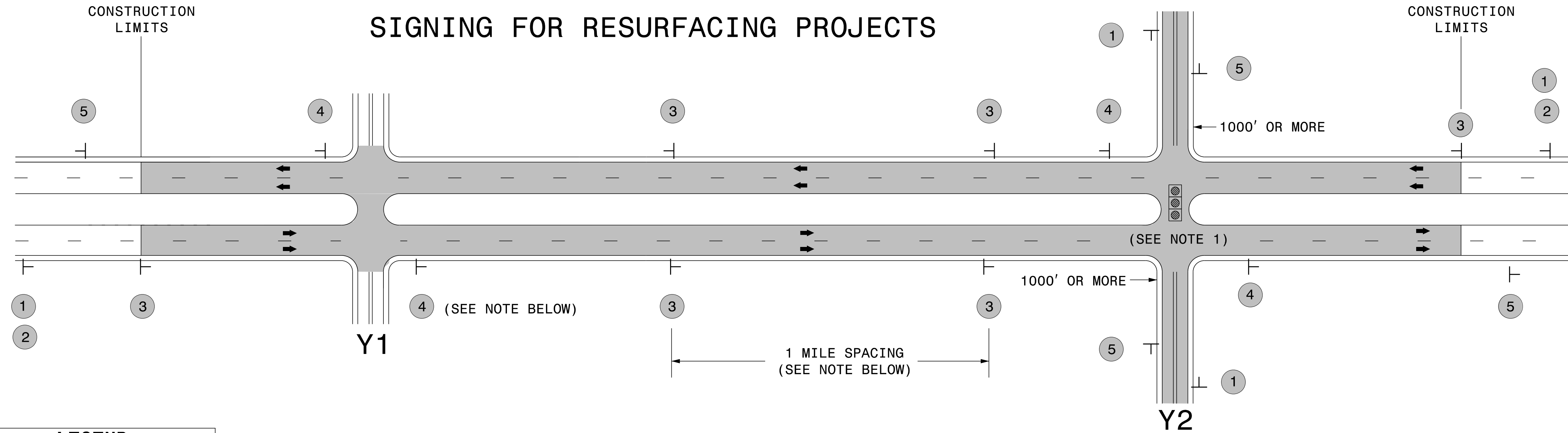

LEGEND	
┆	STATIONARY SIGN
←	DIRECTION OF TRAFFIC FLOW

MAINLINE (-L-) SIGNING

-Y- LINE SIGNING

SIGNING NOTES AND PLACEMENT PER DIRECTION	 	<p>PLACE 1000' PRIOR TO BEGINNING OF CONSTRUCTION LIMITS. ONLY USED ON -Y- LINES IF RESURFACING LIMITS EXTEND 1000' ALONG -Y- LINE.</p> <p>#2 SIGN ONLY USED WHEN RESURFACING LIMITS ARE 2 OR MORE MILES IN LENGTH. ROUND UP TO NEXT WHOLE NUMBER. (NO FRACTIONAL OR DECIMAL NUMBERS)</p>	<p>NO REQUIRED STATIONARY SIGNING FOR THE FOLLOWING -Y- LINE CONDITIONS:</p> <ol style="list-style-type: none"> 1) LESS THAN 1000' OF RESURFACING ALONG -Y- LINE 2) SUBDIVISION ROADS 3) DEAD END ROADS <p>WHEN PAVING/CONSTRUCTION ACTIVITIES PROCEED ACROSS AN UNSIGNED -Y- LINE, ADVANCE WARNING PORTABLE SIGNS SHALL BE USED ALONG THE -Y- LINE AS SHOWN BELOW. REMOVE UPON COMPLETION OF WORK.</p> <div style="display: flex; justify-content: space-around;"> <div style="text-align: center;"> <small>W20-1 48" X 48"</small> </div> <div style="text-align: center;"> <small>W20-7 A 48" X 48"</small> </div> </div> <p>PLACED 500' IN ADVANCE OF FLAGGER. PLACED 250' IN ADVANCE OF FLAGGER.</p> <p>NOTES:</p> <ol style="list-style-type: none"> 1) MAY USE LAW ENFORCEMENT TO CONTROL TRAFFIC AT SIGNALIZED INTERSECTIONS AS DIRECTED BY THE ENGINEER. PROVIDE PORTABLE "ROAD WORK AHEAD" (W20-1) SIGNS 500' IN ADVANCE ALONG BOTH APPROACHES FROM THE SIDE STREETS WHEN PAVING PROCEEDS THROUGH THE INTERSECTION.
		<p>PLACE INITIALLY AT THE CONSTRUCTION LIMITS AND SPACED 1 MILE APART THEREAFTER. IF NO -Y- LINES EXIST, PLACE 2ND SET 1/2 MILE FROM THE CONSTRUCTION LIMITS AND THEN SPACE 1 MILE THEREAFTER.</p>	
		<p>THESE ARE FOR -Y- LINES THAT ARE "THROUGH" ROADWAYS. DEAD END AND SUBDIVISION ROADS ARE NOT "THROUGH" ROADWAYS. INSTALL 500' +/- FROM EACH -Y- LINE APPROACH AS SHOWN ABOVE. FOR MULTIPLE -Y- LINES THAT ARE SEPARATED BY 0.25 MILES OR LESS, TREAT AS A SINGLE UNIT AND INSTALL WITHIN 500' OF EACH APPROACH. A MAXIMUM OF 2 SIGN SETS PER MILE. DO NOT INSTALL WHEN -Y- LINES ARE WITHIN 0.5 MILES FROM "END ROAD WORK" SIGN.</p>	
		<p>PLACE 500' FOLLOWING THE END OF CONSTRUCTION LIMITS.</p>	

3/23/2015
C:\Users\rmgarrrett\Downloads\Resurfacing_AdvWarn_Ltr-Su_Shldr.dgn
User:rmgarrrett

**RESURFACING
ADVANCE WARNING SIGNS
FOR RURAL AND SUBURBAN
MULTI-LANE ROADWAYS
W/ SHOULDER SECTIONS**

URBAN / SUBURBAN WORKZONES

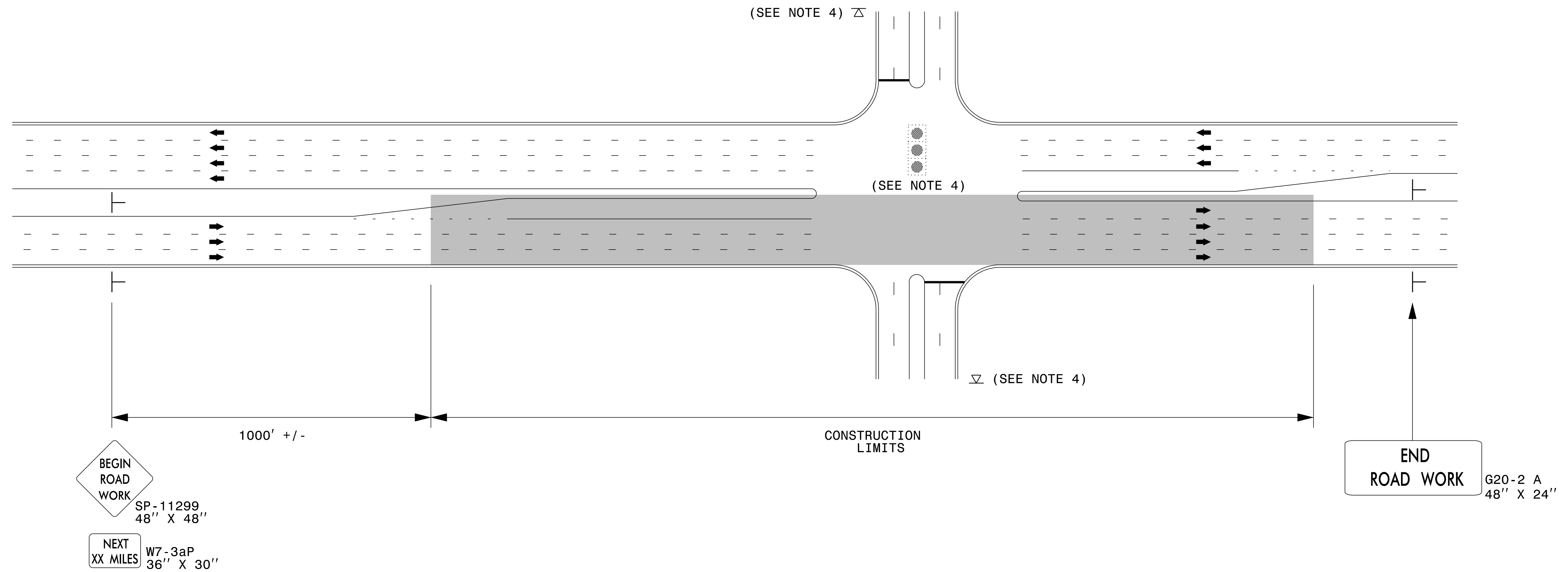

NOTES:

- 1) 48" x 48" SIZED SIGNS (SP- 11299) MAY BE REDUCED TO 36" X 36" ON ROADWAYS WITH SPEED LIMITS OF 40 MPH OR LESS.
- 2) MOUNT SIGNS THAT ARE LARGER THAN 10 SQUARE FEET IN AREA ON TWO OR MORE WOOD OR U-CHANNEL SUPPORTS. PERFORATED SQUARE TUBING SUPPORT SYSTEMS MAY SUPPORT LARGER AREAS ON A SINGLE SUPPORT. FOLLOW MANUFACTURER'S RECOMMENDATIONS. THESE SYSTEMS SHALL BE NCHRP 350 COMPLIANT AND NCDOT APPROVED.
- 3) ADVANCE WARNING SIGNS NOT REQUIRED ON NON-SIGNALIZED SIDE STREETS.
- 4) MAY USE LAW ENFORCEMENT TO CONTROL TRAFFIC AT SIGNALIZED INTERSECTIONS AS DIRECTED BY THE ENGINEER. PROVIDE PORTABLE "ROAD WORK AHEAD" (W20-1) SIGNS 500' IN ADVANCE ALONG BOTH APPROACHES FROM THE SIDE STREETS WHEN PAVING PROCEEDS THROUGH THE INTERSECTION.
- 5) LATERAL CLEARANCE AT ALL SIGN LOCATIONS SHALL BE 2' AS MEASURED FROM THE EDGE OF PAVEMENT OR THE FACE OF THE CURB. WHEN UNABLE TO OBTAIN THE LATERAL CLEARANCE WITHIN THE MEDIAN AREA USE SHOULDER MOUNTS ONLY.
- 6) SIGN MOUNT LOCATIONS SHALL NOT BLOCK SIDEWALKS OR DRIVEWAYS.
- 7) IF STATIONARY GENERAL WARNING SIGNS ARE USED, THEY WILL BE PAID FOR PER SECTION 104 OF THE NCDOT STANDARD SPECIFICATIONS AS EXTRA WORK.
- 8) IF MILLED AREAS ARE NOT PAVED BACK BY THE END OF THE WORK DAY, PORTABLE SIGNS SHALL BE USED TO WARN DRIVERS OF THE PRESENT CONDITIONS. THESE ARE TO INCLUDE, BUT NOT LIMITED TO "ROUGH ROAD" W8-8, "UNEVEN LANES" W8-11, "GROOVED PAVEMENT" W8-15 w/MOTORCYCLE PLAQUE MOUNTED BELOW. THESE ARE TO BE DOUBLE INDICATED ON MULTI-LANE ROADWAYS WITH SPEED LIMITS 45 MPH AND GREATER WHERE LATERAL CLEARANCE CAN BE OBTAINED WITHIN THE MEDIAN AREAS. THESE PORTABLE SIGNS ARE INCIDENTAL TO THE OTHER ITEMS OF WORK INCLUDED IN THE TEMPORARY TRAFFIC CONTROL (LUMP SUM) PAY ITEM.

LEGEND

- ├ STATIONARY SIGN
- ➔ DIRECTION OF TRAFFIC FLOW

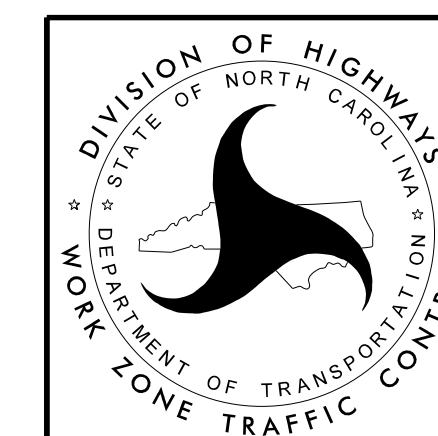

**RESURFACING ADVANCE
WARNING SIGNS FOR
URBAN / SUBURBAN
FACILITIES**

**DIVISION OF HIGHWAYS
STATE OF NORTH CAROLINA**

SOIL STABILIZATION TIMEFRAMES

<i>SITE DESCRIPTION</i>	<i>STABILIZATION TIME</i>	<i>TIMEFRAME EXCEPTIONS</i>
PERIMETER DIKES, SWALES, DITCHES AND SLOPES	7 DAYS	NONE
HIGH QUALITY WATER (HOW) ZONES	7 DAYS	NONE
SLOPES STEEPER THAN 3:1	7 DAYS	IF SLOPES ARE 10' OR LESS IN LENGTH AND ARE NOT STEEPER THAN 2:1, 14 DAYS ARE ALLOWED.
SLOPES 3:1 OR FLATTER	14 DAYS	7 DAYS FOR SLOPES GREATER THAN 50' IN LENGTH.
ALL OTHER AREAS WITH SLOPES FLATTER THAN 4:1	14 DAYS	NONE, EXCEPT FOR PERIMETERS AND HOW ZONES.

NOTES: Less than 5' - 10' undisturbed buffer from ROW, ditchline, water feature, or drainage inlet, add BMP.

BMP Options: Wattle, Silt Fence or Hardened Aggregate.

EROSION CONTROL DETAIL

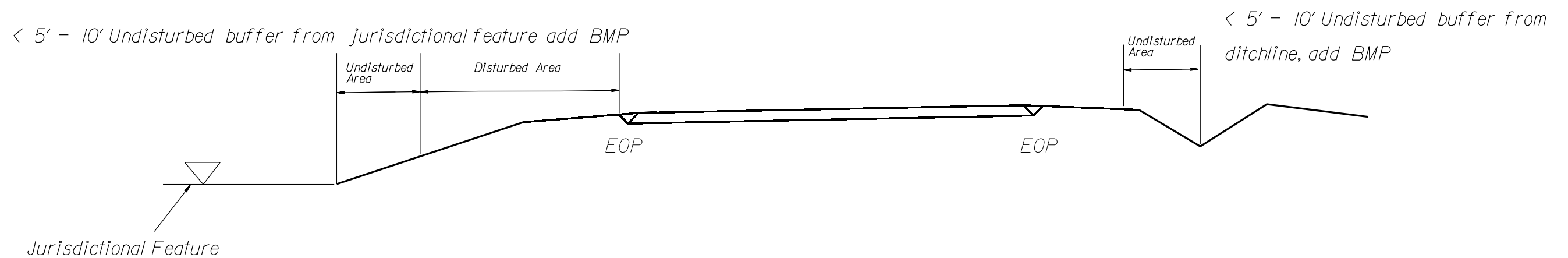
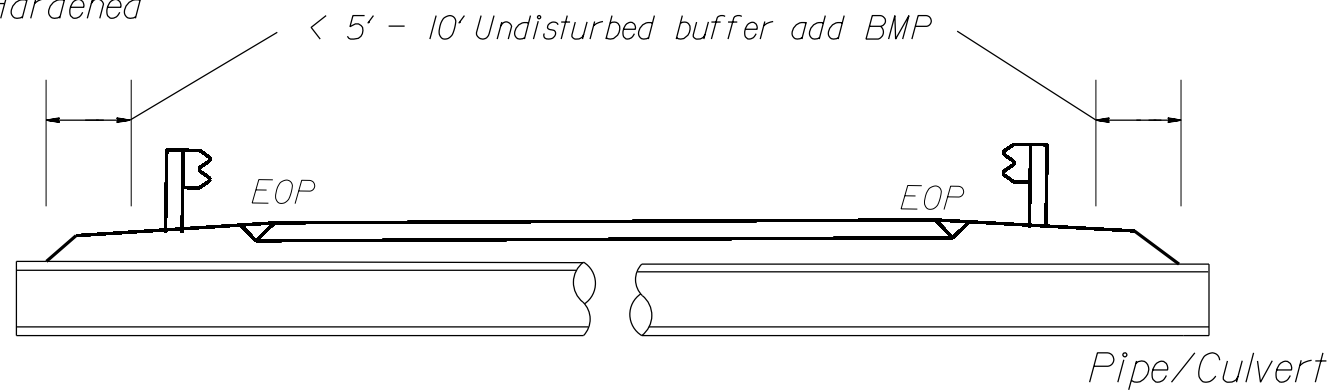

Use BMP's if shoulders and/or frontslopes and/or ditchline and/or backslopes are disturbed

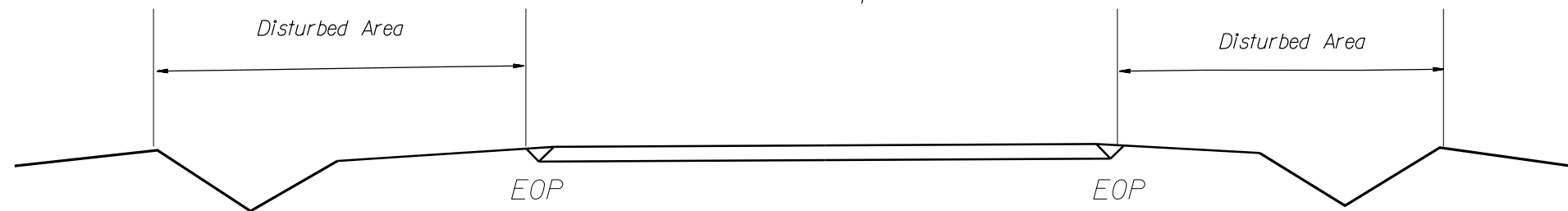

< 5' - 10' Undisturbed buffer from inlet, add wattle

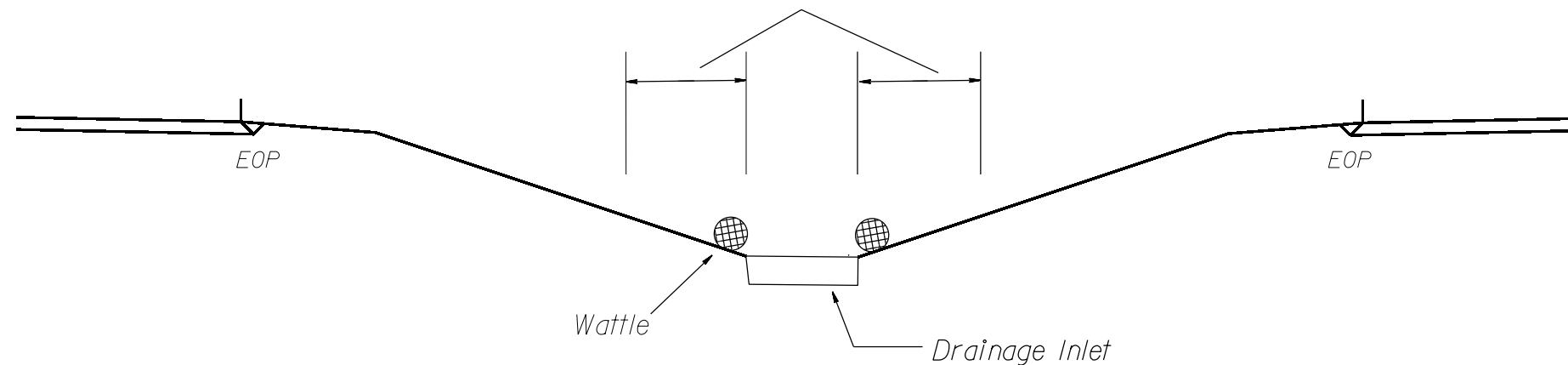

NOT TO SCALE

