

DUPLIN COUNTY

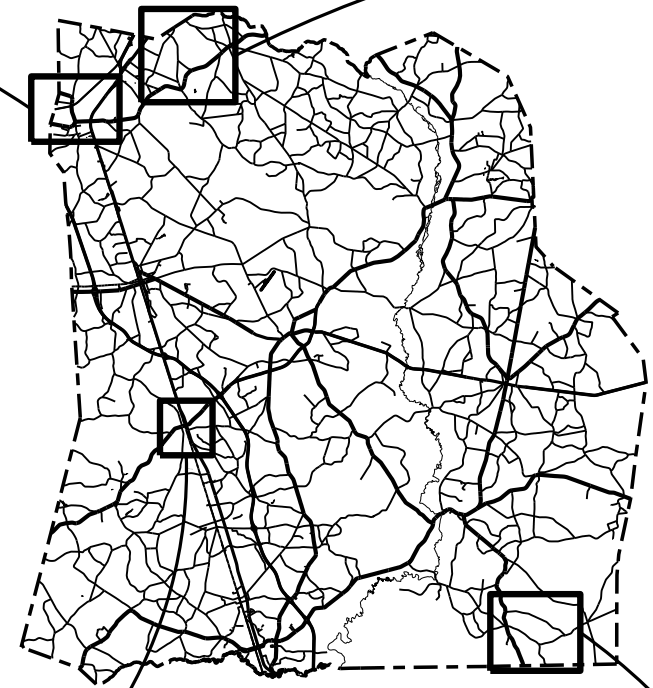
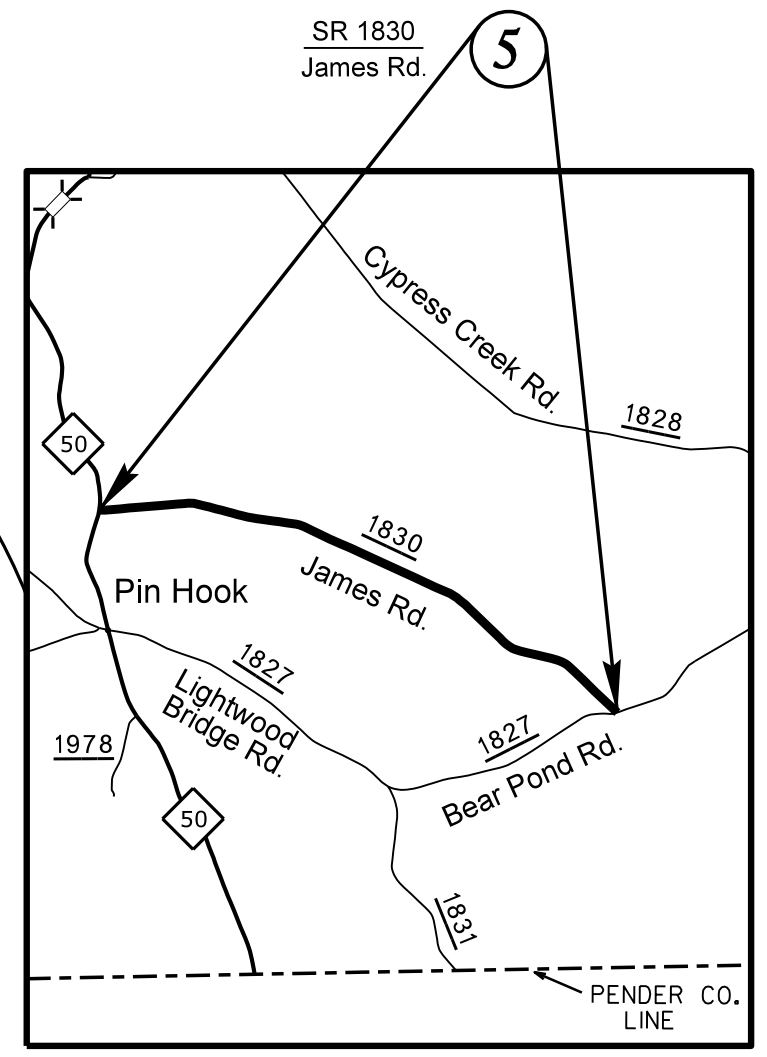
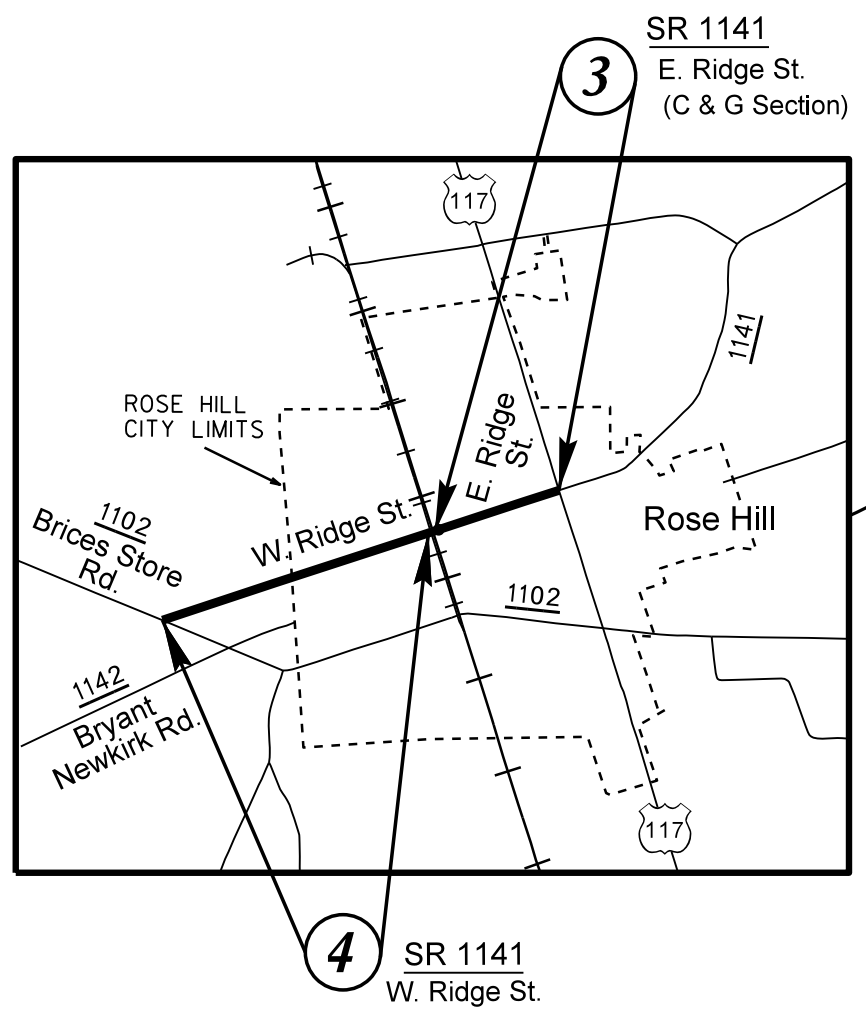
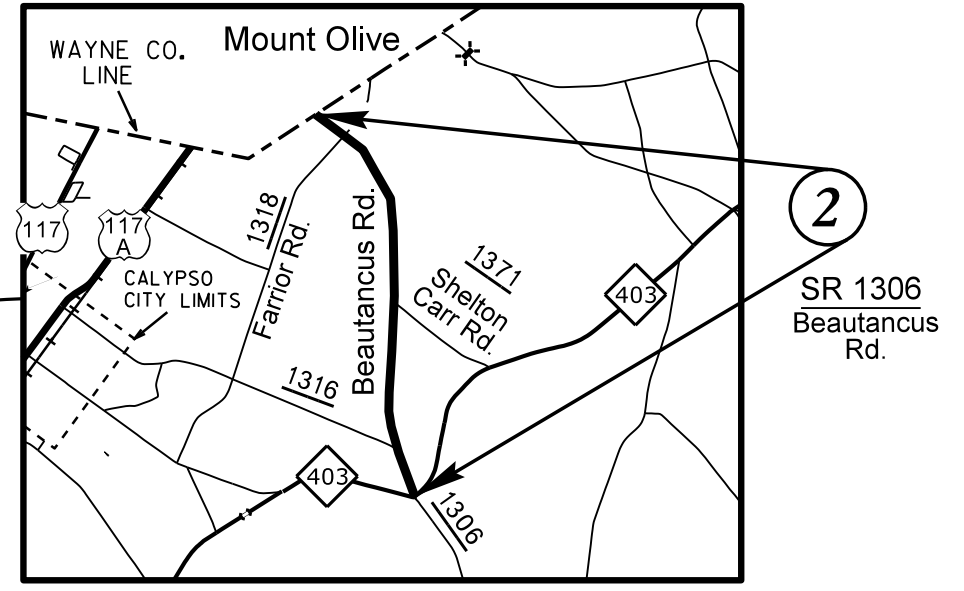
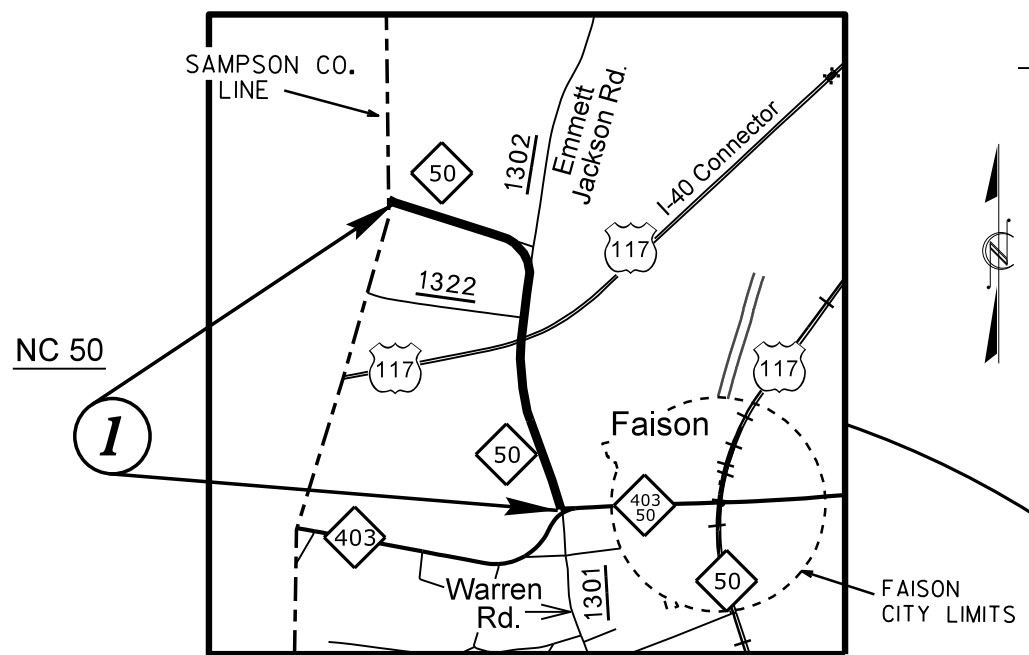

MAPS N.T.S.

REVISIONS

08-MAY-2018 07:48 S:\Division\Resurfacing\Resurfacing_Data\2019 - 2020 Resurfacing\Duplin\2019CPT.03.01.10311.ETC\2019CPT.03.01.10311.ETC_Rdy_Tsh.dgn

DUPLIN COUNTY - CONT.

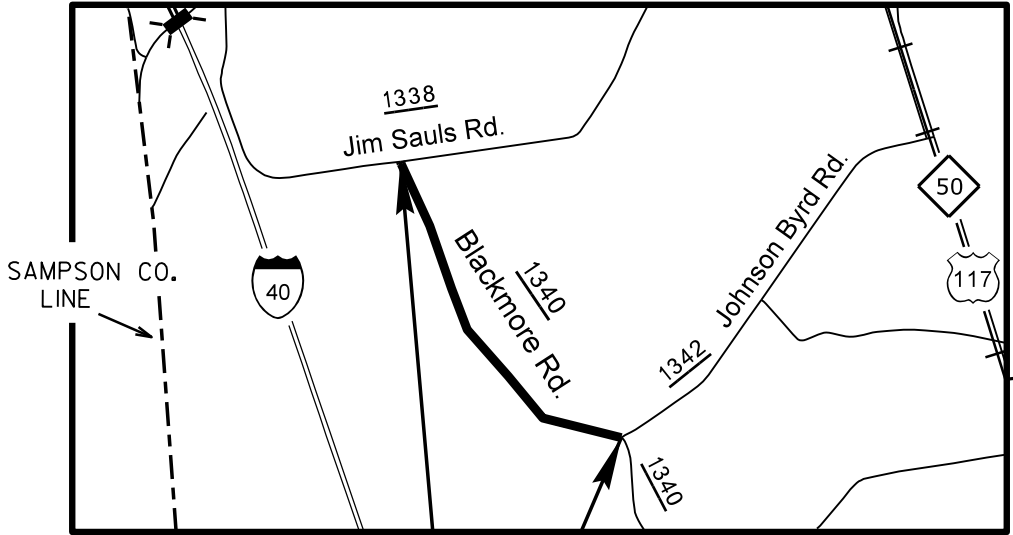

SR 1340
Blackmore Rd.

6

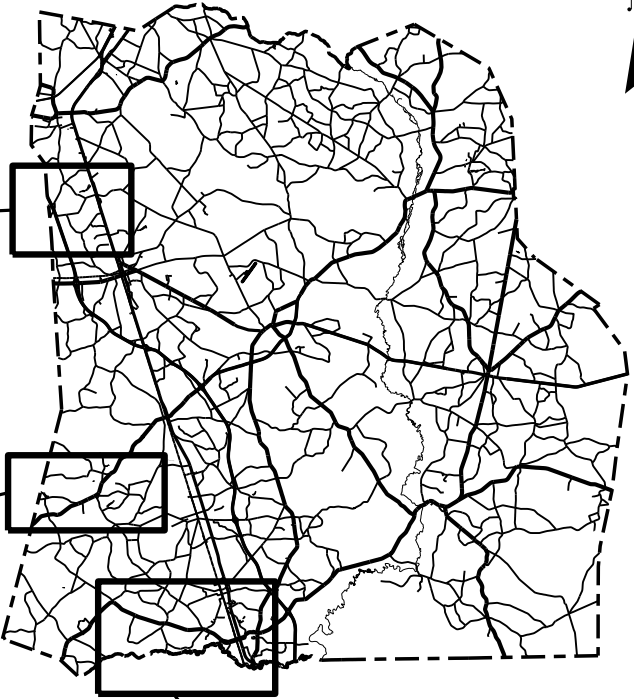

DUPLIN COUNTY

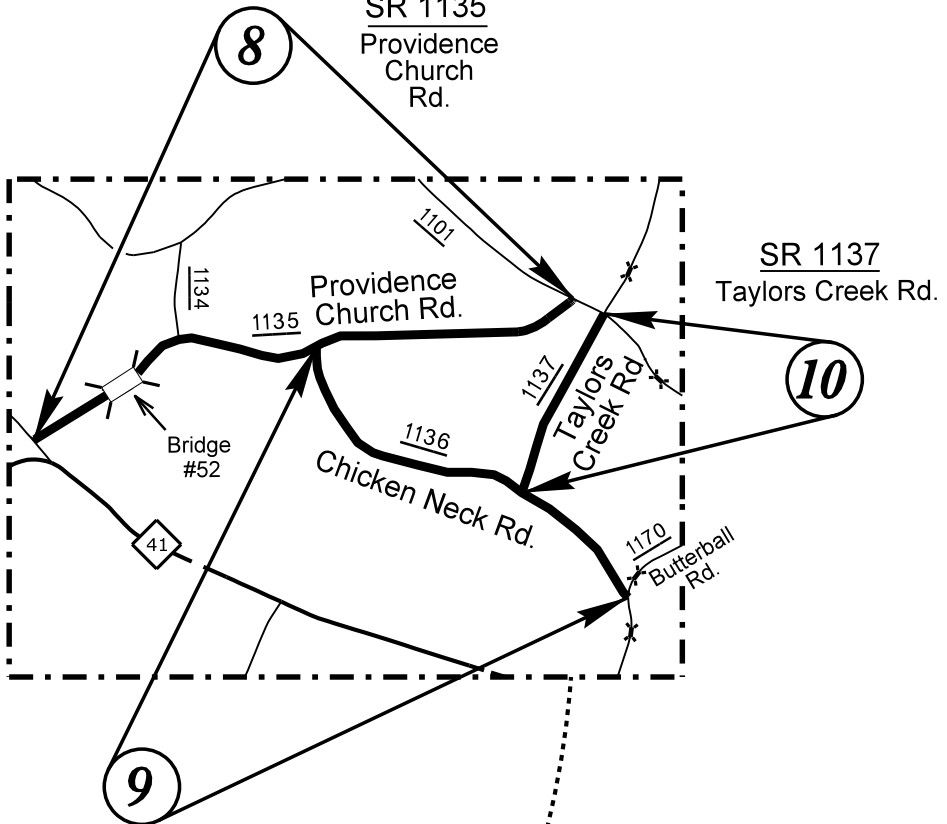

SR 1136
Chicken Neck Rd.

9

10

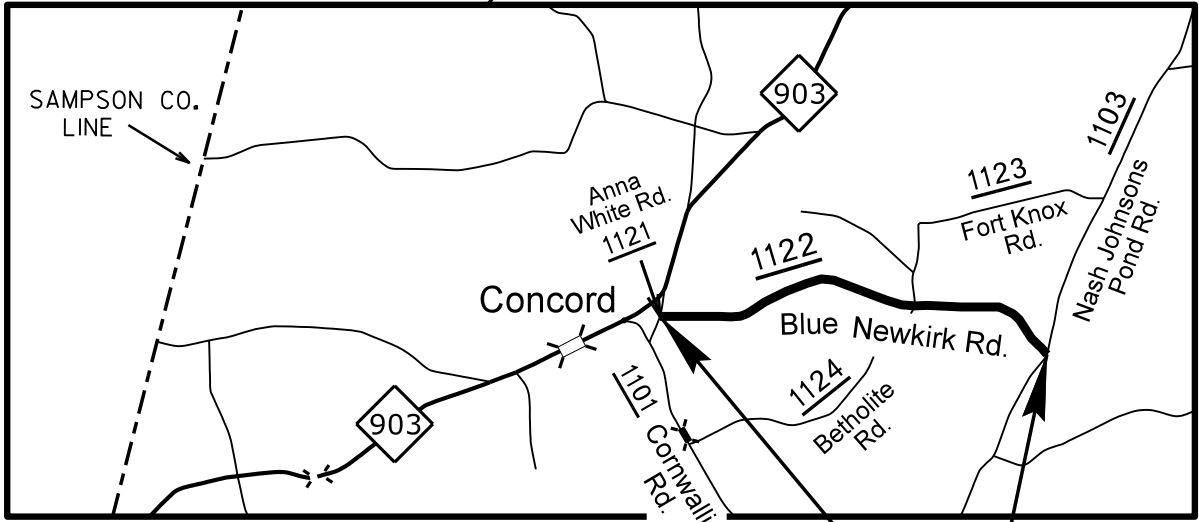

SR 1122
Blue Newkirk Rd.

7

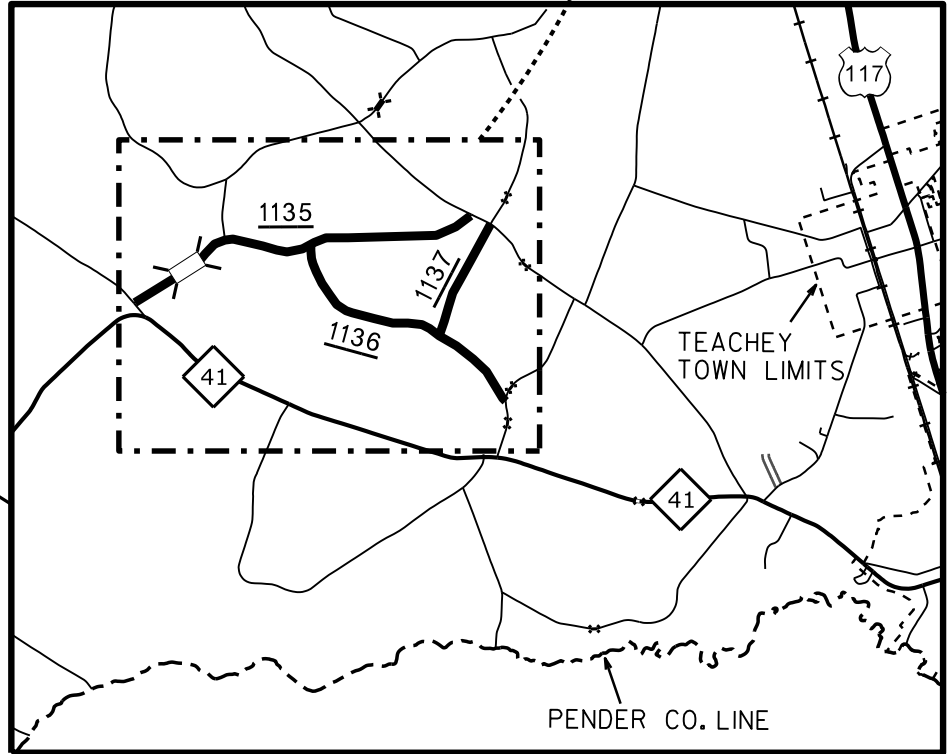

PENDER CO. LINE

MAPS N.T.S.

REVISIONS

08-MAY-2018 07:57 S:\Division\Resurfacing\Resurfacing Data\2019 - 2020 Resurfacing\Duplin\2019CPT.03.01.10311.ETC\2019CPT.03.01.10311.ETC_Red_Tsh.dgn

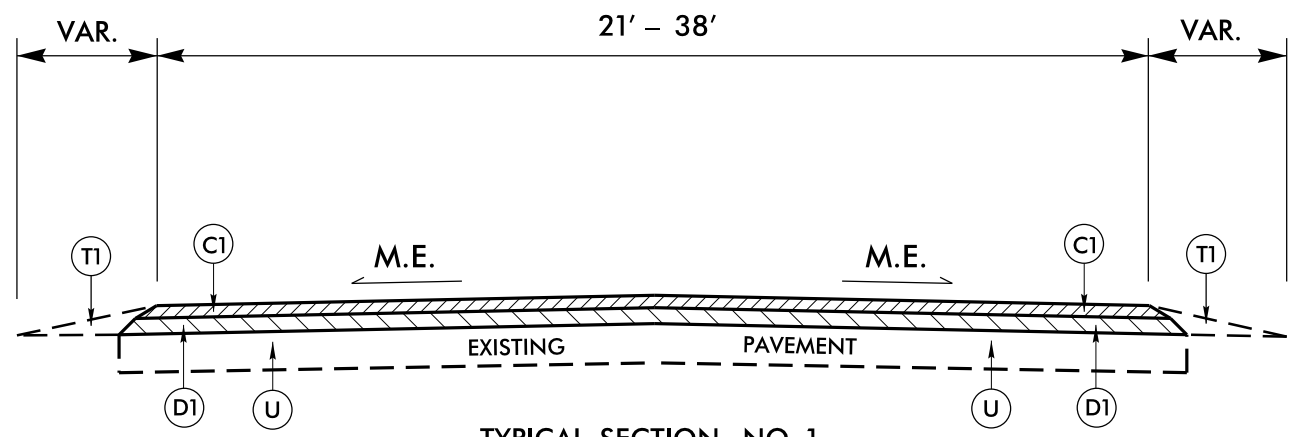

TYPICAL SECTION NO. 1

MAP NO. 1
NC 50
MP 40.24 - MP 41.04*

* NO PAVING MP 41.04 - MP 41.10
(US 117 INTERSECTION)

PAVEMENT SCHEDULE	
C1	PROP. APPROX. 1½" DEPTH ASPHALT CONCRETE SURFACE COURSE, TYPE S9.5B, AT AN AVERAGE RATE OF 165 LBS. PER SQ.YD.
C2	PROP. APPROX. 2" DEPTH ASPHALT CONCRETE SURFACE COURSE, TYPE S9.5B, AT AN AVERAGE RATE OF 220 LBS. PER SQ.YD.
C3	PROP. APPROX. 1" DEPTH ASPHALT CONCRETE SURFACE COURSE, TYPE S9.5B, AT AN AVERAGE RATE OF 110 LBS. PER SQ.YD.
D1	PROP. APPROX. 2½" DEPTH ASPHALT CONCRETE INTERMEDIATE COURSE, TYPE I19.0C, AT AN AVERAGE RATE OF 285 LBS. PER SQ.YD.
F1	ASPHALT SURFACE TREATMENT - MAT COAT #6 STONE (GRANITE)
R1	EXISTING CONCRETE 2'-6" CURB & GUTTER
R2	EXISTING CONCRETE BRIDGE RAIL
T1	EARTH MATERIAL (SHOULDER RECONSTRUCTION)
U	EXISTING PAVEMENT
V1	MILLING ASPHALT PAVEMENT, 1½" DEPTH
V2	MILLING ASPHALT PAVEMENT, 1" DEPTH

PAVEMENT EDGE SLOPES ARE 1:1, EXCEPT FINAL SURFACE COURSE. SEE SHOULDER WEDGE DETAIL.

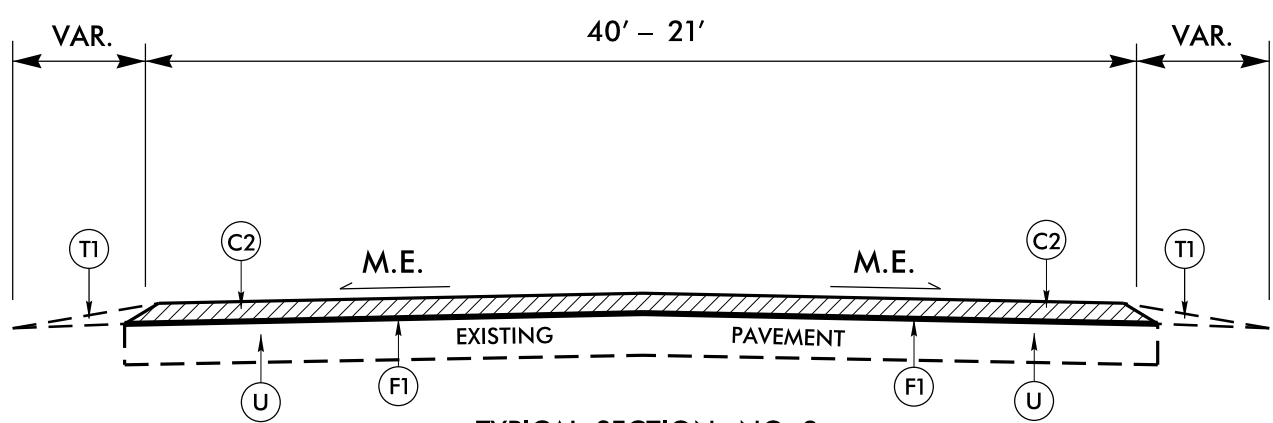

TYPICAL SECTION NO. 2

MAP NO. 1
NC 50
MP 41.10 - MP 42.17

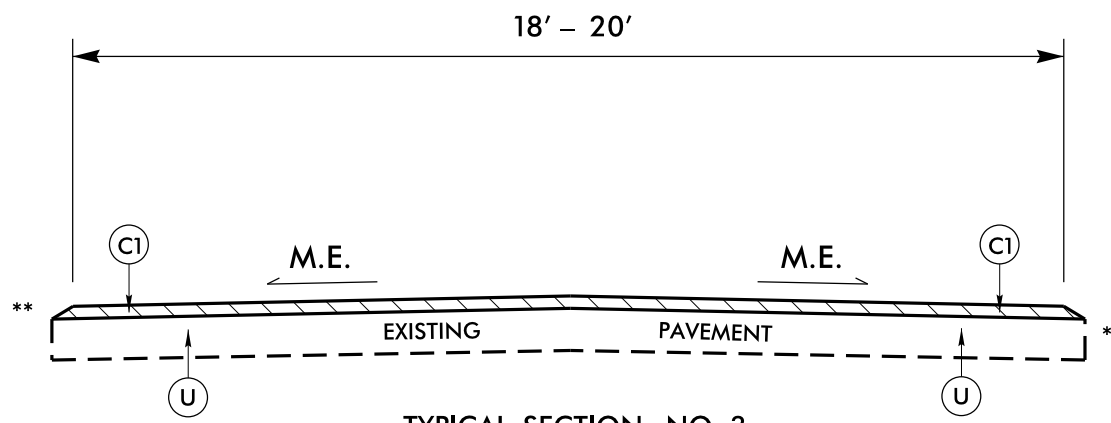

TYPICAL SECTION NO. 3

MAP NO. 2
SR 1306 (BEAUTANCUS RD.)
MP 0.00 - MP 3.07

MAP NO. 6
SR 1340 (BLACKMORE RD.)
MP 0.00 - MP 1.25

MAP NO. 5
SR 1830 (JAMES RD.)
MP 0.00 - MP 3.33

NOTE: ** SHOULDER WORK TO BE DONE BY STATE FORCES (MAP NO. 2, 5 & 6)

14-MAY-2018 13:10
 S:\Division\Resurfacing\Resurfacing Data\2019
 - 2020_Resurfacing\Duplin\2019CPT.03.01.10311_ETC\2019CPT.03.01.10311_ETC_Rdy_Tup.dgn
 \$\$\$SRNAME\$\$\$

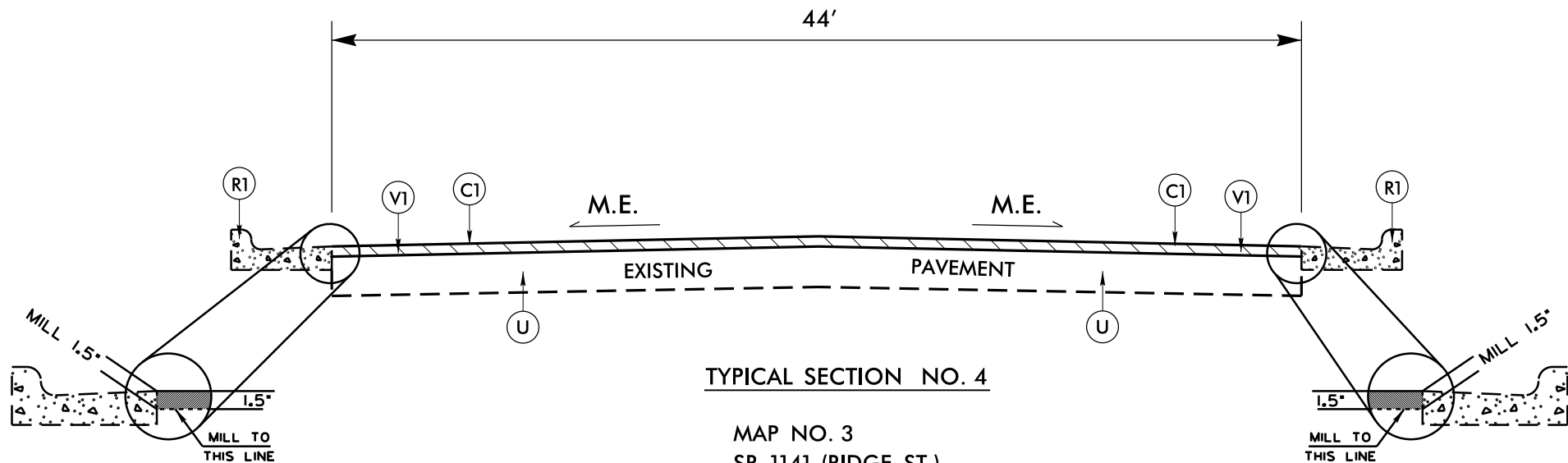

TYPICAL SECTION NO. 4

MAP NO. 3
SR 1141 (RIDGE ST.)
MP 9.01 – MP 9.41

NOTE: MILL A SINGLE LANE AND PAVE BACK BY THE END OF EACH WORK DAY.

PAVEMENT SCHEDULE	
C1	1 1/2" S9.5B
C3	1" S9.5B
R1	EXISTING 2'-6" CURB & GUTTER
R2	EXISTING CONCRETE BRIDGE RAIL
U	EXISTING PAVEMENT
V1	MILLING 1 1/2" DEPTH
V2	MILLING 1" DEPTH

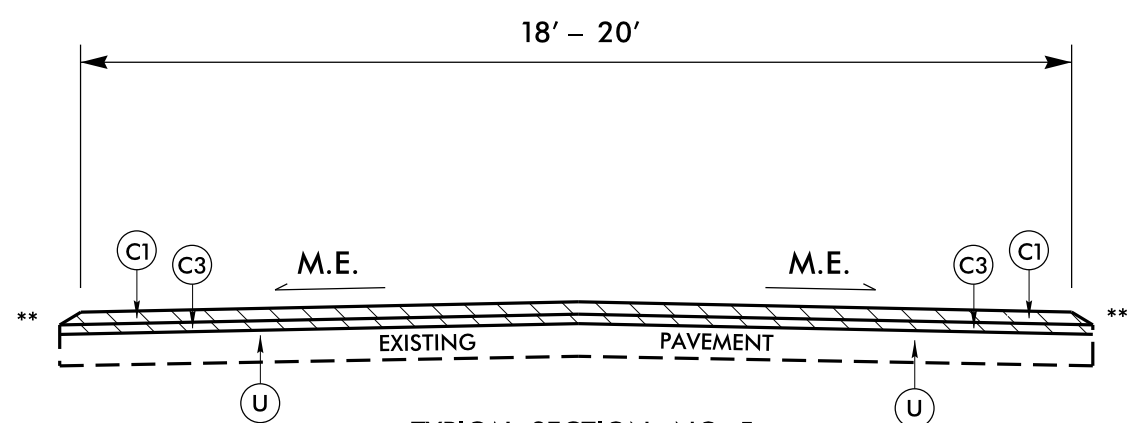

TYPICAL SECTION NO. 5

MAP NO. 4
SR 1141 (RIDGE ST.)
MP 9.41 – MP 10.27

MAP NO. 9
SR 1136 (CHICKEN NECK RD.)
MP 0.00 – MP 2.01

MAP NO. 7
SR 1122 (BLUE NEWKIRK RD.)
MP 0.00 – MP 2.48

MAP NO. 10
SR 1137 (TAYLORS CREEK RD.)
MP 0.00 – MP 0.91

MAP NO. 8
SR 1135 (PROVIDENCE CHURCH RD.)
MP 0.00 – MP 2.24
MP 2.26 – MP 2.73

NOTE: ** SHOULDER WORK TO BE DONE BY STATE FORCES (MAP NO. 4 & 7-10)

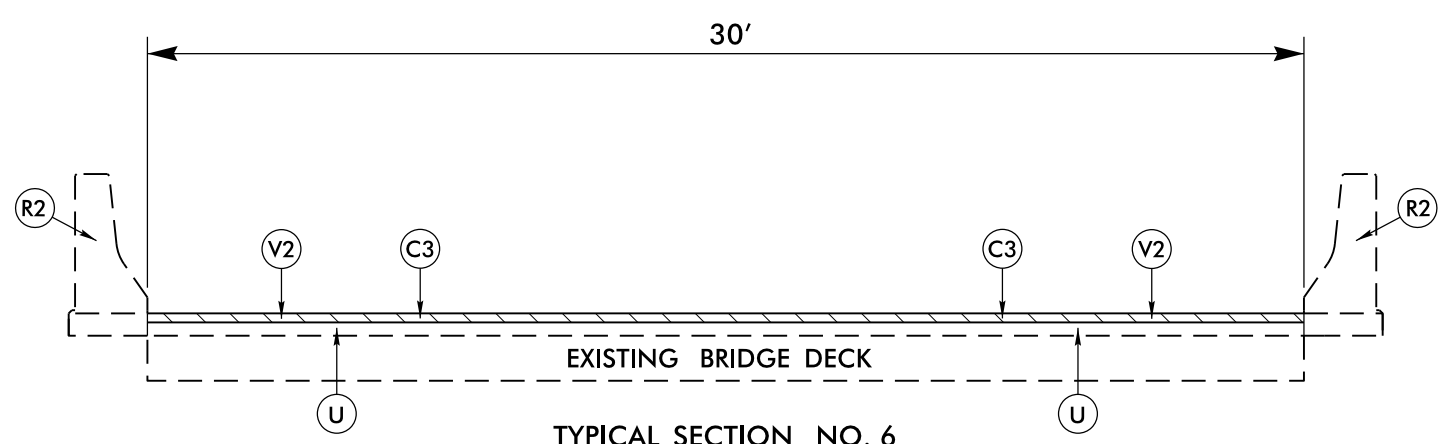

TYPICAL SECTION NO. 6

MAP NO. 8
SR 1135 (PROVIDENCE CHURCH RD.)
BRIDGE NO. 52
MP 2.24 – MP 2.26

NOTE: MILL A SINGLE LANE AND PAVE BACK BY THE END OF EACH WORK DAY.

I4-MAY-2018 13:21
 S:\Division_Resurfacing\Resurfacing Data\2019 - 2020_Resurfacing\Duplin\2019CPT.03.01.10311_ETC\2019CPT.03.01.10311_ETC_Rdy_Tup.dgn
 \$\$\$SERVERNAME\$\$\$

DETAILS OF REPAIRING EXISTING PAVEMENT PRIOR TO RESURFACING FOR FULL DEPTH AND MILLING

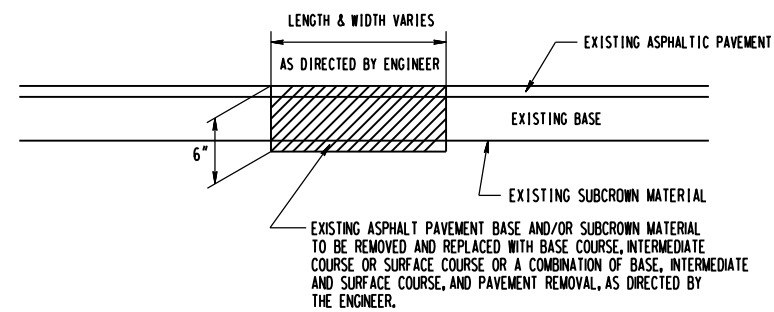

DETAIL NO. 1

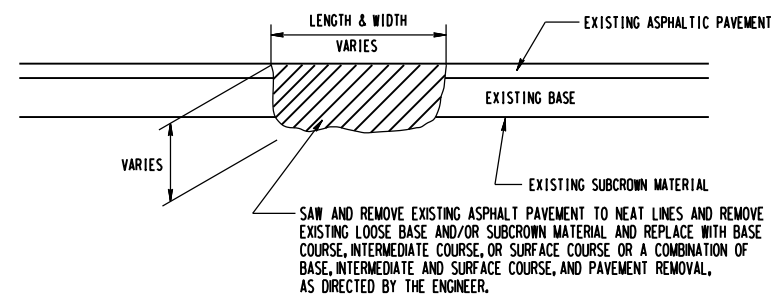

DETAIL NO. 2

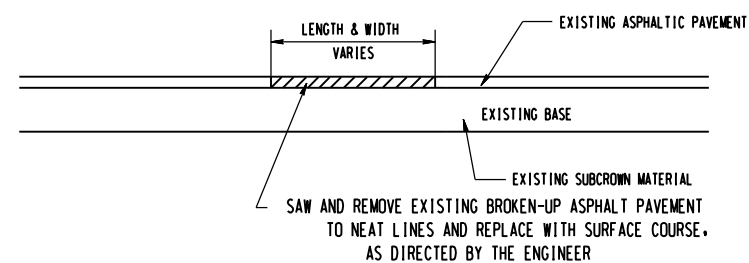

DETAIL NO. 3

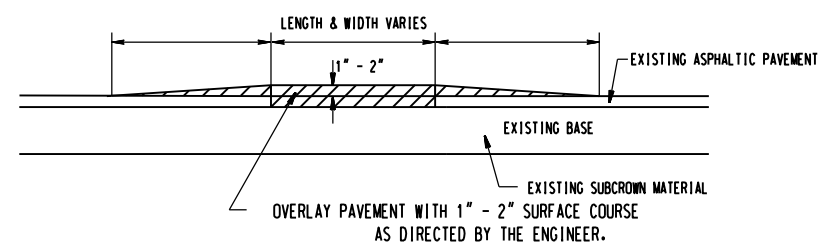

DETAIL NO. 4

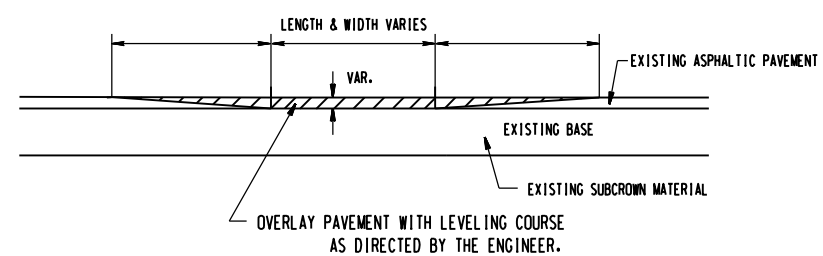

DETAIL NO. 5

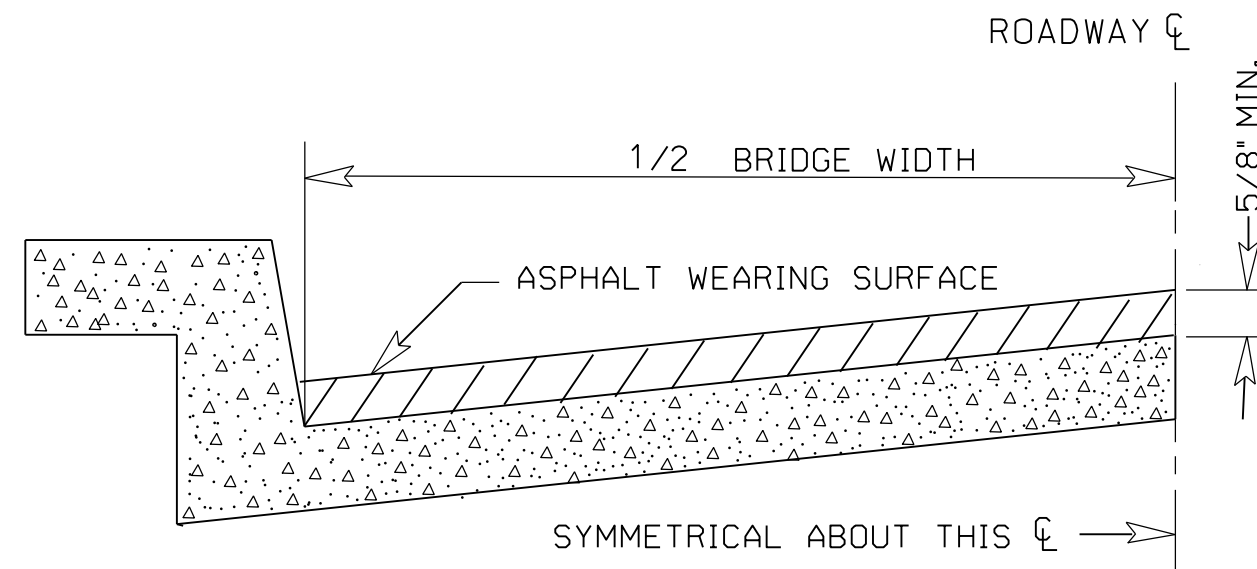
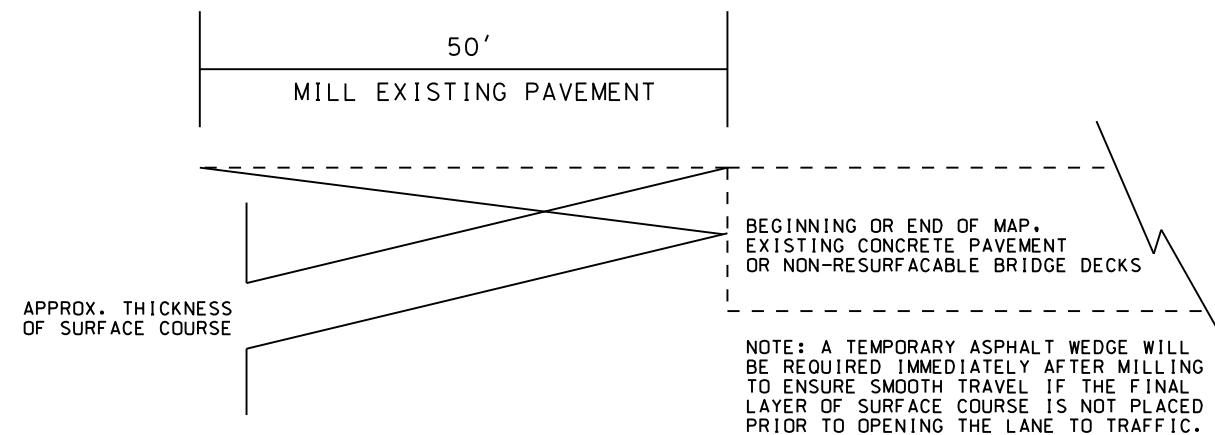

BRIDGE HALF TYPICAL SECTION

FOR BRIDGES WITH FLOOR DRAINS, CARE SHALL BE EXERCISED IN PLACING THE WEARING SURFACE AROUND FLOOR DRAINS SO AS NOT TO HINDER EFFECTIVE DRAINAGE. ALL DRAINS SHALL BE LEFT OPEN.

THE PROPOSED WEARING SURFACE SHALL VARY IN THICKNESS AS NECESSARY TO PROVIDE A SMOOTH RIDING SURFACE. A THICKNESS OF NOT LESS THAN 5/8" SHALL BE PROVIDED. THE MAXIMUM THICKNESS SHALL PREFERABLY BE 1-1/2" UNLESS IT IS IMPRACTICAL TO PROVIDE A SMOOTH RIDING SURFACE OTHERWISE.

REVISIONS

I:\FEB-2015 12:09 D:\Resurfacing\Plan Sheets\3CR\20711.173_Patch.dgn
 County\Plan Sheets\3CR\20711.173_Patch.dgn
 D:\Resurfacing\Plan Sheets\3CR\20711.173_Patch.dgn
 I:\FEB-2015 12:09 D:\Resurfacing\Plan Sheets\3CR\20711.173_Patch.dgn
 County\Plan Sheets\3CR\20711.173_Patch.dgn

STATE OF NORTH CAROLINA
DEPT. OF TRANSPORTATION
DIVISION OF HIGHWAYS
RALEIGH, N.C.

ENGLISH DETAIL DRAWING FOR
MANHOLE AND VALVE BOX ADJUSTMENTS

SHEET 1 OF 1
840D55

GENERAL NOTES:

1. USE RAPID SET GROUT, MORTAR, OR CONCRETE THAT WILL TAKE FULL SET AND BECOME LOAD BEARING WITHIN SIXTY MINUTES OF PLACEMENT WITH A MINIMUM COMPRESSIVE STRENGTH OF 4000 PSI.
2. REMOVE ALL FAULTY EXISTING BRICKWORK AND REPLACE WITH NEW BRICK MASONRY.
3. SHEER CUT EXCAVATION FOR THE ADJUSTMENT ON ALL SIDES.
4. FILL AREA BELOW 8" DEPTH WITH 78M OR NO. 57 CLEAN STONE.
5. MIX MORTAR TO NCDOT SPECIFICATIONS.
6. MORTAR JOINTS $\frac{1}{2}$ " +/- $\frac{1}{8}$ "
7. CONSTRUCT AN ASPHALT RAMP IN ACCORDANCE WITH SECTION 858-3 OF THE 2018 STANDARD SPECIFICATIONS.

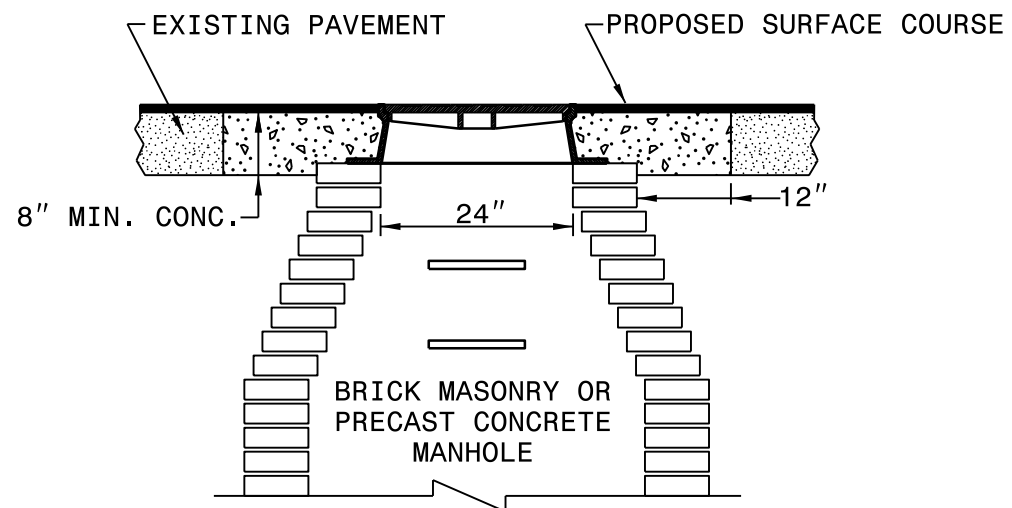

MANHOLE CONCRETE ENCASEMENT

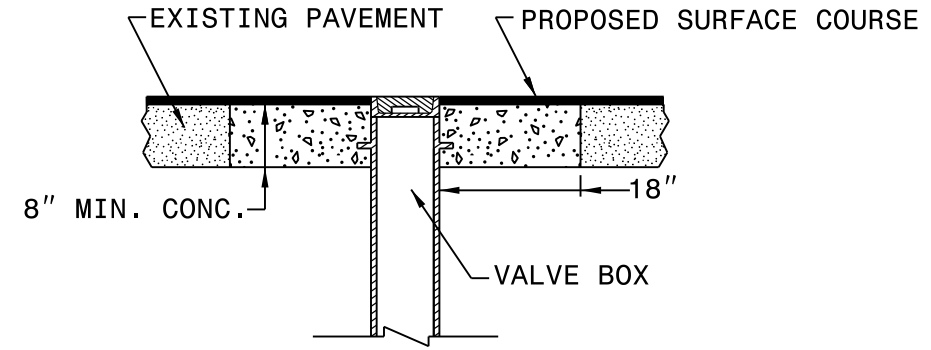

VALVE BOX CONCRETE ENCASEMENT

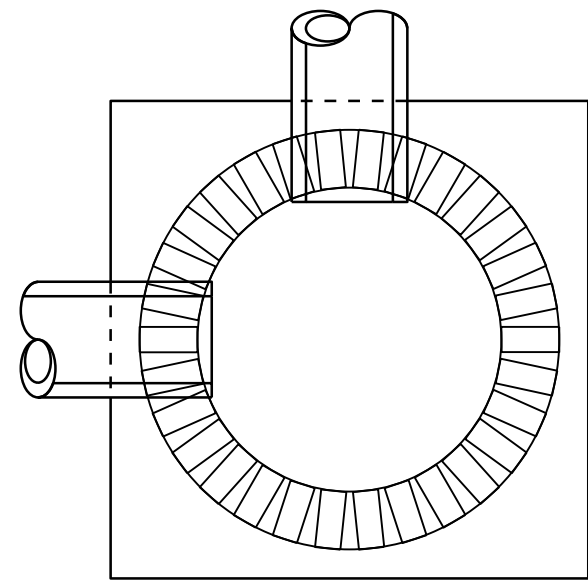

ELEVATION VIEW

PLACE BRICK ACCORDING TO ELEVATION VIEW

ENGLISH DETAIL DRAWING FOR
MANHOLE AND VALVE BOX ADJUSTMENTS

SHEET 1 OF 1
840D55

STATE OF NORTH CAROLINA
DEPT. OF TRANSPORTATION
DIVISION OF HIGHWAYS
RALEIGH, N.C.

REVISIONS

28-NOV-2017 10:49
 S:\Division Resurfacing\z Design Standards & Specifications\Drawings\Tutorials\Curb, Etc.rwdgn
 \$\$\$USERNAME\$\$\$

- NOTES:
- 1) DETAIL DOES NOT APPLY TO OGAFB AND ULTRA-THIN BONDED WEARING COURSE.
 - 2) BACKFILL SHOULDER WITH APPROVED MATERIAL.
 - 3) THE SHOULDER WEDGE DEVICE MAY BE DISENGAGED AT PAVED DRIVEWAYS, SIDE STREETS, HIGH SHOULDERS, AND OTHER LOCATIONS NOT FEASIBLE TO CONSTRUCT AS APPROVED BY THE ENGINEER.

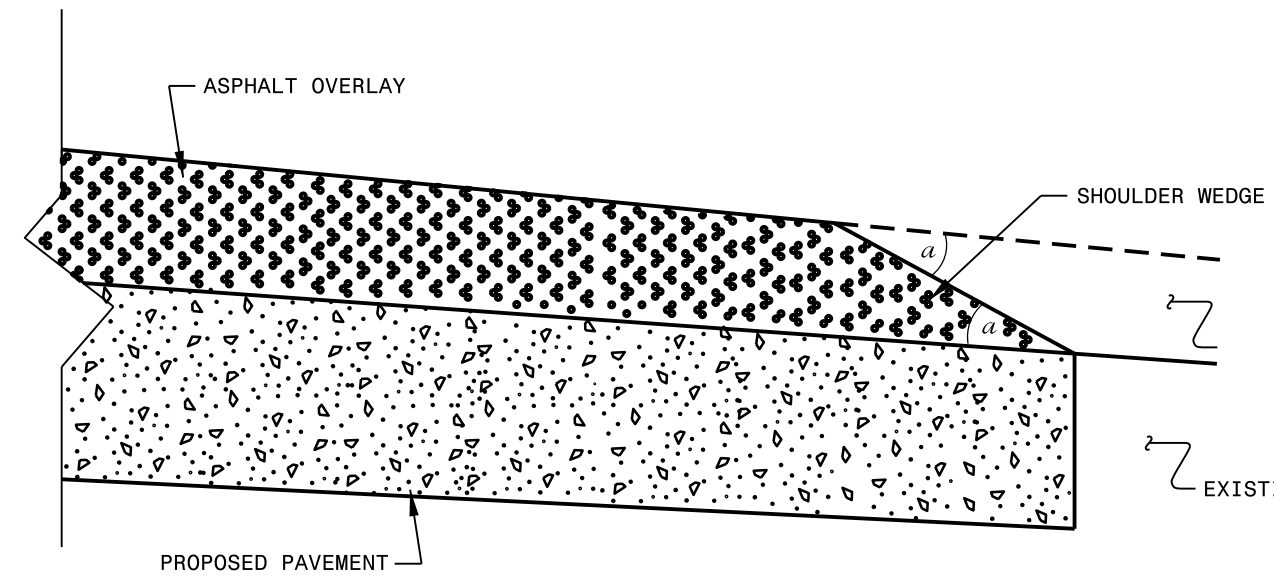

SHOULDER WEDGE DETAIL
 (Resurfacing Projects w/ Widening or
 with Existing Paved Shoulder having no dropoffs)

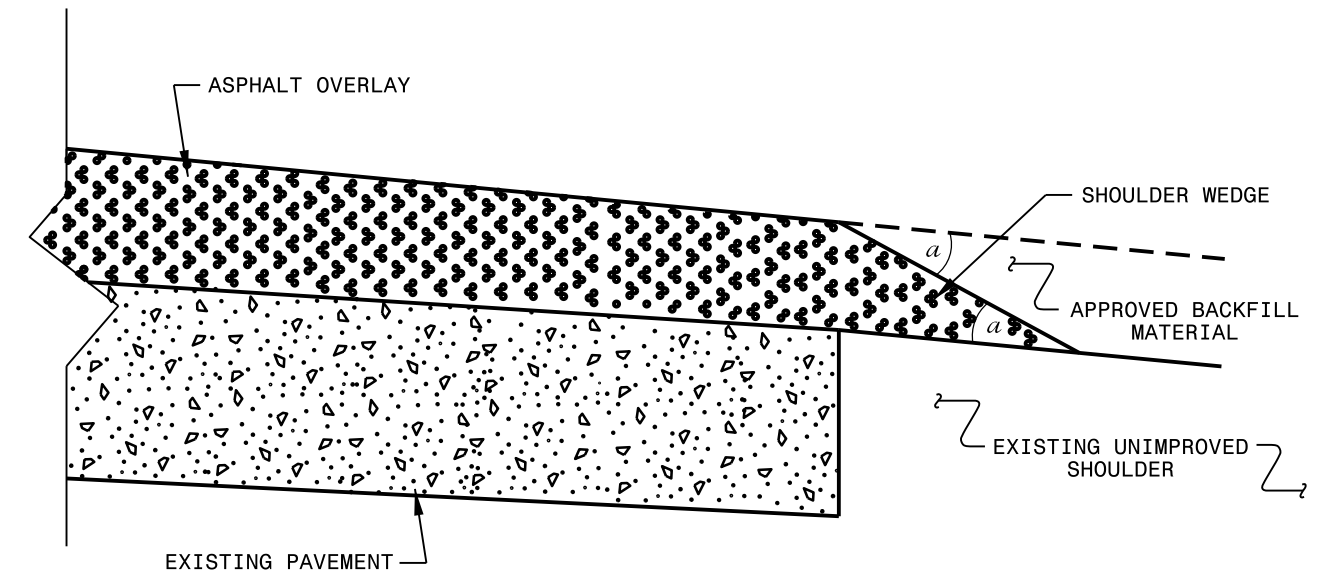

SHOULDER WEDGE DETAIL
 (Resurfacing Projects w/ NO Widening)

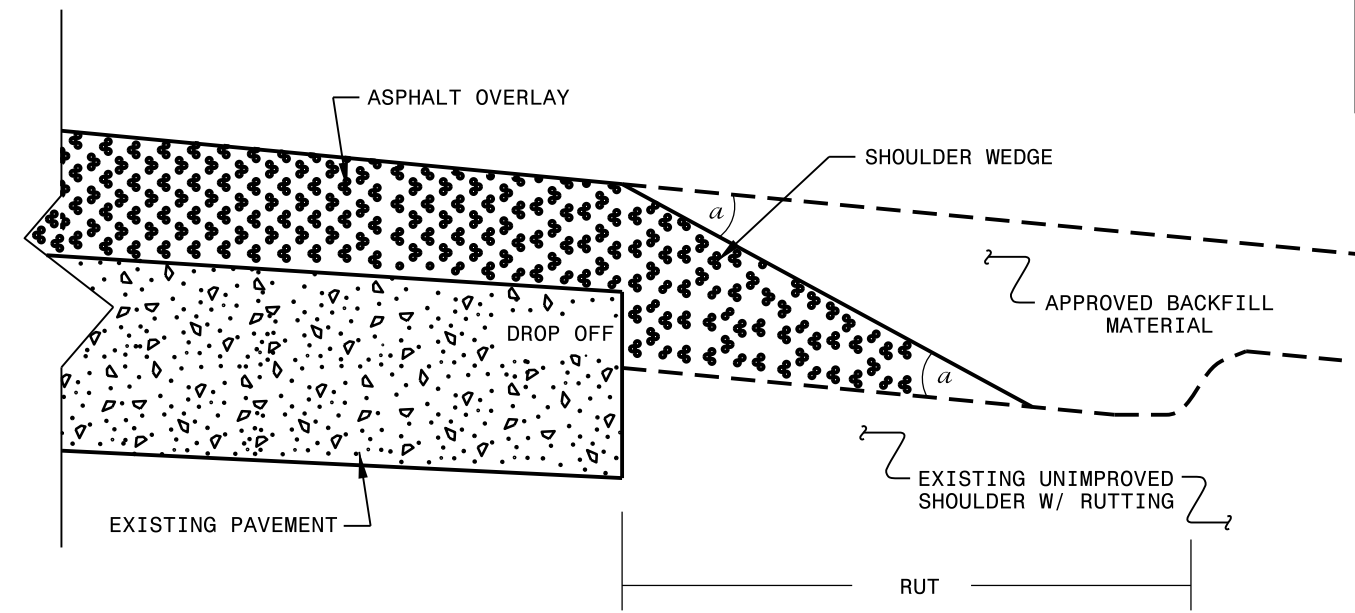

SHOULDER WEDGE DETAIL
 (Resurfacing Adjacent to
 Rutted Shoulder)

- SHOULDER WEDGE ANGLE = 30°

CONTRACT STANDARDS AND DEVELOPMENT UNIT			
Office 919-707-6950		FAX 919-250-4119	
SHOULDER WEDGE DETAILS			
ORIGINAL BY: T.SPELL	DATE: 7-19-11		
MODIFIED BY:	DATE: 2/2/16		
CHECKED BY:	DATE:		
FILE SPEC.: susr/details/stand/shoulderwedgedetail.dgn			

SYSTEMS DESIGN USER NAME

PROJECT NO.	SHEET NO.
2019CPT.03.01.10311, ETC.	8

SUMMARY OF QUANTITIES

PROJECT NO	COUNTY	MAP NO	ROUTE	DESCRIPTION	TYP NO	LANES	LANE TYPE	FINAL SURFACE TESTING REQUIRED	WARM MIX ASPHALT REQUIRED	LENGTH	WIDTH	0106000000-E	1220000000-E	1245000000-E	1297000000-E	1297000000-E	1330000000-E	1503000000-E	1519000000-E	1520000000-E	1575000000-E	1770000000-E	1838000000-E			
												BORROW EXCAVATION	INCIDENTAL STONE BASE	SHOULDER RECONST.	1" MILLING	1.5" MILLING	INCIDENTAL MILLING	INTERMEDIATE COURSE, I19.0C	SURFACE COURSE, S9.5B	LEVELING COURSE, S9.5B	ASPHALT BINDER FOR PLANT MIX	ASPHALT SURFACE TREATMENT MATCOAT #6 STONE (GRANITE)	EMULSION FOR ASPHALT SURFACE TREATMENT			
												MI	FT	CY	TON	SMI	SY	SY	SY	TON	TON	TON	TON	SY	GAL	
2019CPT.03.01.10311	Duplin	1	NC 50	FROM PVMT. SEAM NORTH OF NC 403 TO SAMPSON COUNTY (MP 40.25 - MP 42.16)	1 & 2	2	2WU	NO	NO	1.93	20	436	55	3.72				1,416	1,405	2,249		218	12,807	4,485		
TOTAL FOR MAP NO. 1												1.93		436	55	3.72			1,416	1,405	2,249		218	12,807	4,485	
TOTAL FOR PROJ NO. 2019CPT.03.01.10311												1.93		436	55	3.72			1,416	1,405	2,249		218	12,807	4,485	
2019CPT.03.01.20311	Duplin	2	SR 1306 (BEAUTANCUS RD.)	FROM WAYNE CO. TO NC 403 (MP 0.00 - 3.07)	3	2	2WU	NO	NO	3.07	18		210					600		2,828	150	199				
TOTAL FOR MAP NO. 2												3.07		210					600		2,828	150	199			
2019CPT.03.01.20311	Duplin	3	SR 1141 (E. RIDGE ST.)	FROM PVMT. SEAM BEFORE US 117 TO R/R (MP 9.01 - MP 9.41)	4	2	2WU	NO	NO	0.4	44								10,325		897		60			
TOTAL FOR MAP NO. 3												0.4								10,325		897		60		
2019CPT.03.01.20311	Duplin	4	SR 1141 (W. RIDGE ST.)	FROM R/R TO SR 1102 (BRICES STORE RD.) MP 9.41 - MP 10.27	5	2	2WU	NO	NO	0.86	18		90							200		1,326		89		
TOTAL FOR MAP NO. 4												0.86		90					200		1,326		89			
2019CPT.03.01.20311	Duplin	5	SR 1830 (JAMES RD.)	FROM NC 50 TO SR 1827 (BEAR POND RD.) MP 0.00 - MP 3.33	3	2	2WU	NO	NO	3.33	20		200							200		3,406	300	248		
TOTAL FOR MAP NO. 5												3.33		200					200		3,406	300	248			
2019CPT.03.01.20311	Duplin	6	SR 1340 (BLACKMORE RD.)	FROM SR 1338 (JIM SAULS RD.) TO SR 1342 (JOHNSON BYRD RD.) MP 0.00 - MP 1.25	3	2	2WU	NO	NO	1.25	18		60								200		1,151		77	
TOTAL FOR MAP NO. 6												1.25		60					200		1,151		77			
2019CPT.03.01.20311	Duplin	7	SR 1122 (BLUE NEWKIRK RD.)	FROM SR 1121 (ANNA WHITE RD.) TO SR 1103 (NASH JOHNSONS POND RD.) MP 0.00 - MP 2.48	5	2	2WU	NO	NO	2.48	20		200								400		4,245		284	
TOTAL FOR MAP NO. 7												2.48		200					400		4,245		284			
2019CPT.03.01.20311	Duplin	8	SR 1135 (PROVIDENCE CHURCH RD.)	FROM SR 1101 (CORNWALLIS RD.) TO SR 1100 (OLD CAMP RD.) MP 0.00 - MP 2.73	5 & 6	2	2WU	NO	NO	2.73	18		180		307						600		4,210		282	
TOTAL FOR MAP NO. 8												2.73		180		307			600		4,210		282			
2019CPT.03.01.20311	Duplin	9	SR 1136 (CHICKEN NECK RD.)	FROM SR 1135 (PROVIDENCE CHURCH RD.) TO SR 1170 (BUTTERBALL RD.) MP 0.00 - MP 2.01	5	2	2WU	NO	NO	2.01	18		200								100		2,998		201	
TOTAL FOR MAP NO. 9												2.01		200					100		2,998		201			
2019CPT.03.01.20311	Duplin	10	SR 1137 (TAYLORS CREEK RD.)	FROM SR 1136 (CHICKEN NECK RD.) TO SR 1101 (CORNWALLIS RD.) MP 0.00 - MP 0.91	5	2	2WU	NO	NO	0.91	20		75									100		1,558		104
TOTAL FOR MAP NO. 10												0.91		75					100		1,558		104			
TOTAL FOR PROJ NO. 2019CPT.03.01.20311												17.04		1,215		307	10,325		2,400		22,619	450	1,544			
GRAND TOTAL												18.97		436	1,270	3.72	307	10,325		3,816	1,405	24,868	450	1,762	12,807	4,485

PROJECT NO.	SHEET NO.
2019CPT.03.01.10311, ETC.	10

SUMMARY OF QUANTITIES

PROJECT NO	COUNTY	MAP NO	ROUTE	DESCRIPTION	TYP NO	LANES	LANE TYPE	FINAL SURFACE TESTING REQUIRED	WARM MIX ASPHALT REQUIRED	LENGTH	WIDTH	6036000000-E	6042000000-E	6071010000-E	6084000000-E	6090000000-E	6093000000-E	6117000000-N
										MI	FT	SY	LF	LF	AC	LB	TON	EA
2019CPT.03.01.10311	Duplin	1	NC 50	FROM PVMT. SEAM NORTH OF NC 403 TO SAMPSON COUNTY (MP 40.25 - MP 42.16)	1 & 2	2	2WU	NO	NO	1.93	20	20	95	30	1.84	95	0.48	2
TOTAL FOR MAP NO. 1										1.93		20	95	30	1.84	95	0.48	2
TOTAL FOR PROJ NO. 2019CPT.03.01.10311										1.93		20	95	30	1.84	95	0.48	2
2019CPT.03.01.20311	Duplin	2	SR 1306 (BEAUTANCUS RD.)	FROM WAYNE CO. TO NC 403 (MP 0.00 - 3.07)	3	2	2WU	NO	NO	3.07	18							
TOTAL FOR MAP NO. 2										3.07								
2019CPT.03.01.20311	Duplin	3	SR 1141 (E. RIDGE ST.)	FROM PVMT. SEAM BEFORE US 117 TO R/R (MP 9.01 - MP 9.41)	4	2	2WU	NO	NO	0.4	44							
TOTAL FOR MAP NO. 3										0.4								
2019CPT.03.01.20311	Duplin	4	SR 1141 (W. RIDGE ST.)	FROM R/R TO SR 1102 (BRICES STORE RD.) MP 9.41 - MP 10.27	5	2	2WU	NO	NO	0.86	18							
TOTAL FOR MAP NO. 4										0.86								
2019CPT.03.01.20311	Duplin	5	SR 1830 (JAMES RD.)	FROM NC 50 TO SR 1827 (BEAR POND RD.) MP 0.00 - MP 3.33	3	2	2WU	NO	NO	3.33	20							
TOTAL FOR MAP NO. 5										3.33								
2019CPT.03.01.20311	Duplin	6	SR 1340 (BLACKMORE RD.)	FROM SR 1338 (JIM SAULS RD.) TO SR 1342 (JOHNSON BYRD RD.) MP 0.00 - MP 1.25	3	2	2WU	NO	NO	1.25	18							
TOTAL FOR MAP NO. 6										1.25								
2019CPT.03.01.20311	Duplin	7	SR 1122 (BLUE NEWKIRK RD.)	FROM SR 1121 (ANNA WHITE RD.) TO SR 1103 (NASH JOHNSONS POND RD.) MP 0.00 - MP 2.48	5	2	2WU	NO	NO	2.48	20							
TOTAL FOR MAP NO. 7										2.48								
2019CPT.03.01.20311	Duplin	8	SR 1135 (PROVIDENCE CHURCH RD.)	FROM SR 1101 (CORNWALLIS RD.) TO SR 1100 (OLD CAMP RD.) MP 0.00 - MP 2.73	5 & 6	2	2WU	NO	NO	2.73	18							
TOTAL FOR MAP NO. 8										2.73								
2019CPT.03.01.20311	Duplin	9	SR 1136 (CHICKEN NECK RD.)	FROM SR 1135 (PROVIDENCE CHURCH RD.) TO SR 1170 (BUTTERBALL RD.) MP 0.00 - MP 2.01	5	2	2WU	NO	NO	2.01	18							
TOTAL FOR MAP NO. 9										2.01								
2019CPT.03.01.20311	Duplin	10	SR 1137 (TAYLORS CREEK RD.)	FROM SR 1136 (CHICKEN NECK RD.) TO SR 1101 (CORNWALLIS RD.) MP 0.00 - MP 0.91	5	2	2WU	NO	NO	0.91	20							
TOTAL FOR MAP NO. 10										0.91								
TOTAL FOR PROJ NO. 2019CPT.03.01.20311										17.04								
GRAND TOTAL										18.97		20	95	30	1.84	95	0.48	2

PROJECT NO.	SHEET NO.
2019CPT.03.01.10311, ETC.	11

THERMOPLASTIC AND PAINT QUANTITIES

PROJECT NO	COUNTY	MAP NO	ROUTE	DESCRIPTION	TYP NO	LANES	LANE TYPE	LENGTH		WORK ZONE ADVANCE/GENERAL WARNING SIGNING	TEMPORARY TRAFFIC CONTROL	4686000000-E			THERMO LT STR RT ARROW 90 M	4810000000-E		16" WHITE PAINT	24" WHITE PAINT	PAINT MSG RXR	PAINT LT STR RT ARROW	4900000000-N		
								MI	FT			4" X 90 M WHITE THERMO	4" X 120 M WHITE THERMO	4" X 120 M YELLOW THERMO		4" WHITE PAINT	4" YELLOW PAINT					YELLOW & YELLOW MARKERS	CRYSTAL & RED MARKERS	
												SF	LS	LF		LF	LF					EA	LF	LF
2019CPT.03.01.10311	Duplin	1	NC 50	FROM PVMT. SEA, M NORTH OF NC 403 TO SAMPSON COUNTY (MP 40.25 - MP 42.16)	1 & 2	2	2WU	1.93	20	224					2	8,448	5,787				1	123		
TOTAL FOR MAP NO. 1								1.93		224					2	8,448	5,787				1	123		
TOTAL FOR PROJ NO. 2019CPT.03.01.10311								1.93		224	1.00		19,642	114	14,348	2	8,448	5,787				1	123	
													14,462										123	
2019CPT.03.01.20311	Duplin	2	SR 1306 (BEAUTANCUS RD.)	FROM WAYNE CO. TO NC 403 (MP 0.00 - 3.07)	3	2	2WU	3.07	18	352						66,266	33,680					203		
TOTAL FOR MAP NO. 2								3.07		352						66,266	33,680					203		
2019CPT.03.01.20311	Duplin	3	SR 1141 (E. RIDGE ST.)	FROM PVMT. SEAM BEFORE US 117 TO R/R (MP 9.01 - MP 9.41)	4	2	2WU	0.4	44	48						40	7,200	100	150	4		27	2	
TOTAL FOR MAP NO. 3								0.4		48						40	7,200	100	150	4		27	2	
2019CPT.03.01.20311	Duplin	4	SR 1141 (W. RIDGE ST.)	FROM R/R TO SR 1102 (BRICES STORE RD.) MP 9.41 - MP 10.27	5	2	2WU	0.86	18	96						18,508	8,804	100	74	4		57		
TOTAL FOR MAP NO. 4								0.86		96						18,508	8,804	100	74	4		57		
2019CPT.03.01.20311	Duplin	5	SR 1830 (JAMES RD.)	FROM NC 50 TO SR 1827 (BEAR POND RD.) MP 0.00 - MP 3.33	3	2	2WU	3.33	20	384						71,662	43,956					220		
TOTAL FOR MAP NO. 5								3.33		384						71,662	43,956					220		
2019CPT.03.01.20311	Duplin	6	SR 1340 (BLACKMORE RD.)	FROM SR 1338 (JIM SAULS RD.) TO SR 1342 (JOHNSON BYRD RD.) MP 0.00 - MP 1.25	3	2	2WU	1.25	18	144						26,900	16,500					83		
TOTAL FOR MAP NO. 6								1.25		144						26,900	16,500					83		
2019CPT.03.01.20311	Duplin	7	SR 1122 (BLUE NEWKIRK RD.)	FROM SR 1121 (ANNA WHITE RD.) TO SR 1103 (NASH JOHNSONS POND RD.) MP 0.00 - MP 2.48	5	2	2WU	2.48	20	288						53,370	32,736					164		
TOTAL FOR MAP NO. 7								2.48		288						53,370	32,736					164		
2019CPT.03.01.20311	Duplin	8	SR 1135 (PROVIDENCE CHURCH RD.)	FROM SR 1101 (CORNWALLIS RD.) TO SR 1100 (OLD CAMP RD.) MP 0.00 - MP 2.73	5 & 6	2	2WU	2.73	18	320						58,750	36,036					180		
TOTAL FOR MAP NO. 8								2.73		320						58,750	36,036					180		
2019CPT.03.01.20311	Duplin	9	SR 1136 (CHICKEN NECK RD.)	FROM SR 1135 (PROVIDENCE CHURCH RD.) TO SR 1170 (BUTTERBALL RD.) MP 0.00 - MP 2.01	5	2	2WU	2.01	18	240						43,256	34,150					133		
TOTAL FOR MAP NO. 9								2.01		240						43,256	34,150					133		
2019CPT.03.01.20311	Duplin	10	SR 1137 (TAYLORS CREEK RD.)	FROM SR 1136 (CHICKEN NECK RD.) TO SR 1101 (CORNWALLIS RD.) MP 0.00 - MP 0.91	5	2	2WU	0.91	20	112						19,584	12,012					60		
TOTAL FOR MAP NO. 10								0.91		112						19,584	12,012					60		
TOTAL FOR PROJ NO. 2019CPT.03.01.20311								17.04		1,984	1.00					358,336	225,074	200	224	8		1,127	2	
															583,410							1,129		
GRAND TOTAL								18.97		2,208	1.00		19,642	114	14,348	2	366,784	230,861	200	224	8	1	1,250	2
																597,645						1,252		

SIGNING FOR RESURFACING PROJECTS

LEGEND

┆ STATIONARY SIGN

← DIRECTION OF TRAFFIC FLOW

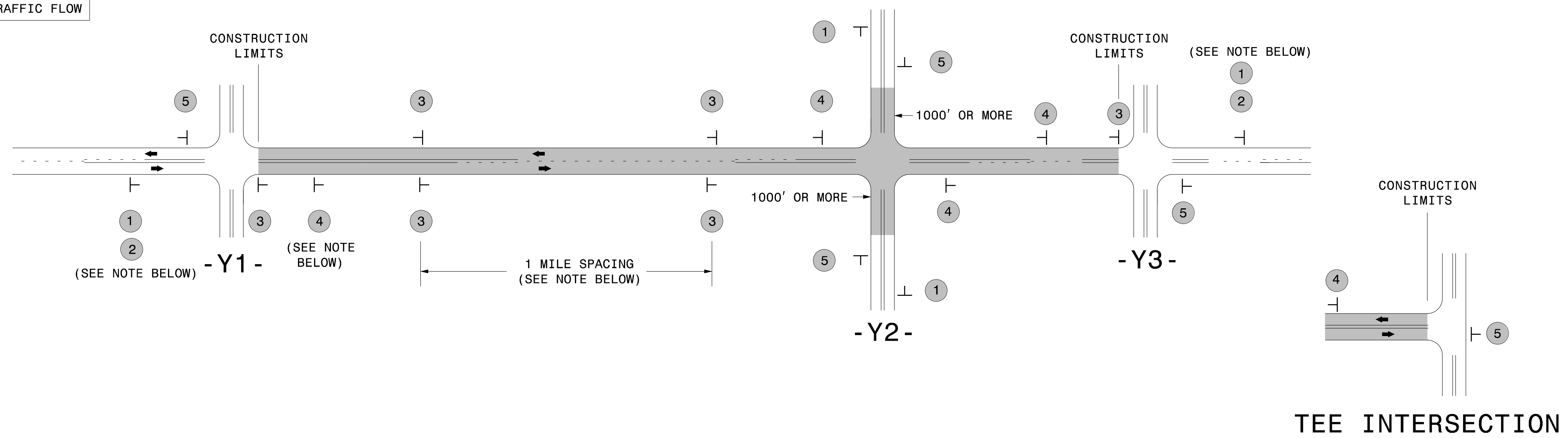

MAINLINE (-L-) SIGNING

-Y- LINE SIGNING

SIGNING NOTES AND PLACEMENT PER DIRECTION	1	 W20-1 48" X 48"	PLACE 1000' PRIOR TO BEGINNING OF CONSTRUCTION LIMITS. ONLY USED ON -Y- LINES IF RESURFACING LIMITS EXTEND 1000' ALONG -Y- LINE.	<p>NO REQUIRED STATIONARY SIGNING FOR THE FOLLOWING -Y- LINE CONDITIONS:</p> <ol style="list-style-type: none"> LESS THAN 1000' OF RESURFACING ALONG -Y- LINE SUBDIVISION ROADS DEAD END ROADS <p>WHEN PAVING/CONSTRUCTION ACTIVITIES PROCEED ACROSS AN UNSIGNED -Y- LINE, PORTABLE ADVANCE WARNING SIGNS SHALL BE USED ALONG THE -Y- LINE AS SHOWN BELOW. REMOVE UPON COMPLETION OF WORK.</p> <div style="display: flex; justify-content: space-around;"> <div style="text-align: center;"> W20-1 48" X 48" </div> <div style="text-align: center;"> W20-7 A 48" X 48" </div> </div> <p>PLACED 500' IN ADVANCE OF FLAGGER.</p> <p>PLACED 250' IN ADVANCE OF FLAGGER.</p>
	2	 W7-3aP 24" X 18"	#2 SIGN ONLY USED WHEN CONSTRUCTION LIMITS ARE 2 OR MORE MILES IN LENGTH. ROUND UP TO NEXT WHOLE NUMBER. (NO FRACTIONAL OR DECIMAL NUMBERS)	
	3	 SP 13107 48" X 48"	<ul style="list-style-type: none"> PLACE INITIALLY AT THE CONSTRUCTION LIMITS AND SPACE 1 MILE APART THEREAFTER. AT TEE INTERSECTIONS INSTALL INITIALLY 1/2 MILE FROM INTERSECTION AND SPACE 1 MILE APART THEREAFTER. 	
	4	 SP 13106 48" X 48"	<ul style="list-style-type: none"> THESE ARE FOR -Y- LINES THAT ARE "THROUGH" ROADWAYS. DEAD END AND SUBDIVISION ROADS ARE NOT "THROUGH" ROADWAYS. INSTALL 500' +/- FROM EACH -Y- LINE APPROACH AS SHOWN ABOVE. FOR MULTIPLE -Y- LINES THAT ARE SEPARATED BY 0.25 MILES OR LESS, TREAT AS A SINGLE UNIT AND INSTALL WITHIN 500' OF EACH APPROACH. A MAXIMUM OF 2 SIGN SETS PER MILE. DO NOT INSTALL WHEN -Y- LINES ARE WITHIN 0.5 MILES FROM "END ROAD WORK" SIGN. FOR TEE INTERSECTIONS, INSTALL WITHIN 500' +/- OF THE INTERSECTION ALONG -L- LINE. 	
	5	 G20-2 A 48" X 24"	PLACE 500' FOLLOWING THE END OF CONSTRUCTION LIMITS OR AS SHOWN WHEN WORK ENDS AT A 3-WAY TEE INTERSECTION.	

THE ABOVE SIGNS ARE ALL THAT ARE REQUIRED FOR A CONTRACTOR TO BEGIN A RESURFACING CONTRACT. ANY ADDITIONAL SIGNS REQUESTED BY NCDOT DIVISIONS SHALL BE INSTALLED WITHIN 7 BUSINESS DAYS OF THE START OF CONTRACT WORK.

MAPS LESS THAN 2 MILES

FOR RESURFACING MAPS WITH CONSTRUCTION LIMITS LESS THAN 2 MILES IN LENGTH, NO STATIONARY SIGNS ARE REQUIRED. USE PORTABLE "ROAD UNDER CONSTRUCTION" OR "ROAD WORK AHEAD" SIGNS IN LIEU OF STATIONARY ADVANCE WARNINGS SIGNS.

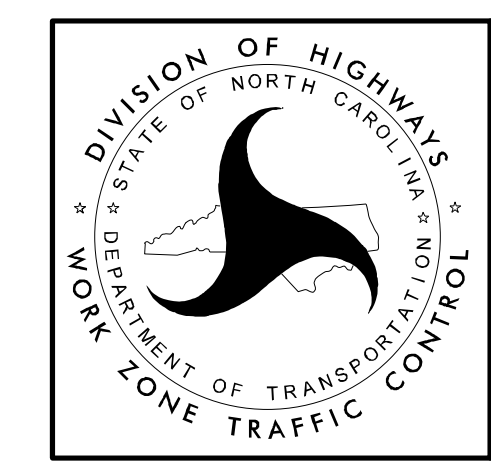

ADVANCE WARNING SIGNS FOR RURAL AND SUBURBAN 2-LANE ROADWAY RESURFACING

SIGNING FOR ASPHALT SURFACE TREATMENT

LEGEND

- PORTABLE SIGN
- STATIONARY SIGN
- DIRECTION OF TRAFFIC FLOW

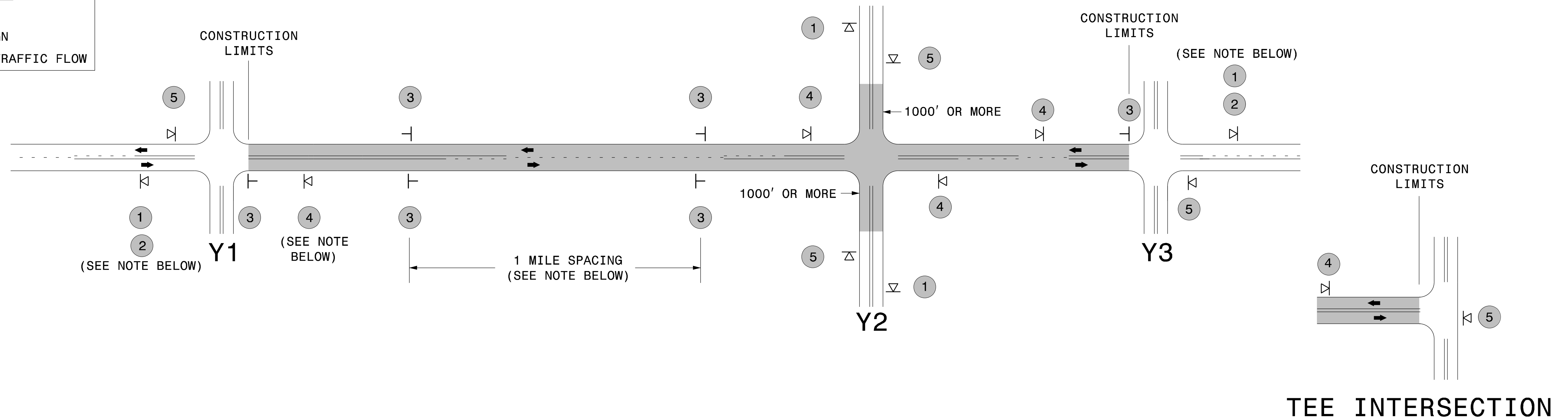

MAINLINE (-L-) SIGNING

-Y- LINE SIGNING

SIGNING NOTES AND PLACEMENT PER DIRECTION	1	 	<ul style="list-style-type: none"> - PLACE 1000' PRIOR TO BEGINNING OF CONSTRUCTION LIMITS. ONLY USED ON -Y- LINES IF RESURFACING LIMITS EXTEND 1000' ALONG -Y- LINE. - SIGN #2 ONLY USED WHEN RESURFACING LIMITS ARE 2 OR MORE MILES IN LENGTH. ROUND UP TO THE NEAREST WHOLE NUMBER. DO NOT USE FRACTIONAL OR DECIMAL NUMBERS. 	<p>STATIONARY SIGNING NOT REQUIRED FOR THE FOLLOWING -Y- LINE CONDITIONS:</p> <ol style="list-style-type: none"> 1) LESS THAN 1000' OF RESURFACING ALONG -Y- LINE 2) SUBDIVISION ROADS 3) DEAD END ROADS <p>WHEN PAVING/CONSTRUCTION ACTIVITIES PROCEED ACROSS AN UNSIGNED -Y- LINE, PORTABLE ADVANCE WARNING SIGNS SHALL BE USED ALONG THE -Y- LINE AS SHOWN BELOW. REMOVE UPON COMPLETION OF WORK.</p> <div style="display: flex; justify-content: space-around; align-items: center;"> <div style="text-align: center;"> <small>W20-1 48" X 48"</small> PLACED 500' IN ADVANCE OF FLAGGER. </div> <div style="text-align: center;"> <small>W20-7 A 48" X 48"</small> PLACED 250' IN ADVANCE OF FLAGGER. </div> </div>
	3	 	<ul style="list-style-type: none"> - ALTERNATE THE FOLLOWING TWO SIGNS: - STARTING WITH "LOOSE GRAVEL" (W8-7) FOLLOWED BY "UNMARKED PAVEMENT". - PLACE INITIALLY AT THE CONSTRUCTION LIMITS AND SPACED 1 MILE APART THEREAFTER. - AT TEE INTERSECTIONS INSTALL INITIALLY 0.5 MILE FROM INTERSECTION AND SPACE 1 MILE APART THEREAFTER. 	
	4		<ul style="list-style-type: none"> - THESE ARE FOR -Y- LINES THAT ARE "THROUGH" ROADWAYS. DEAD END AND SUBDIVISION ROADS ARE NOT "THROUGH" ROADWAYS. - INSTALL 500' +/- FROM EACH -Y- LINE APPROACH AS SHOWN ABOVE. - FOR MULTIPLE -Y- LINES THAT ARE SEPARATED BY 0.25 MILES OR LESS, TREAT AS A SINGLE UNIT AND INSTALL WITHIN 500' OF EACH APPROACH. - A MAXIMUM OF 2 SIGN SETS PER MILE. DO NOT INSTALL WHEN -Y- LINES ARE WITHIN 0.5 MILES FROM "END ROAD WORK" SIGN. 	
	5		<ul style="list-style-type: none"> PLACE 500' FOLLOWING THE END OF CONSTRUCTION LIMITS OR AS SHOWN WHEN WORK ENDS AT A 3-WAY TEE INTERSECTION. 	
	<p>THE ABOVE SIGNS ARE ALL THAT ARE REQUIRED FOR A CONTRACTOR TO BEGIN A RESURFACING CONTRACT. ANY ADDITIONAL SIGNS REQUESTED BY NCDOT DIVISIONS SHALL BE INSTALLED WITHIN 7 BUSINESS DAYS OF THE START OF CONTRACT WORK.</p>			

MAPS LESS THAN 2 MILES

FOR AST RESURFACING MAPS WITH CONSTRUCTION LIMITS LESS THAN 2 MILES IN LENGTH, USE A STATIONARY "LOOSE GRAVEL" SIGN AT THE BEGINNING CONSTRUCTION LIMIT FOLLOWED BY AN "UNMARKED PAVEMENT" SIGN MIDWAY THROUGH AND AN "END ROAD WORK" SIGN AT THE END CONSTRUCTION LIMIT.

ADVANCE WARNING SIGNS FOR 2-LANE ROADWAY ASPHALT SURFACE TREATMENT

5/12/2017 S:\TUXWZTC\Resurfacing\2L2W & AST Resurfacing Details\Resurfacing_AdvWarn_2Ln - AST.dgn User:kadais

DIVISION OF HIGHWAYS
STATE OF NORTH CAROLINA

SOIL STABILIZATION TIMEFRAMES

<i>SITE DESCRIPTION</i>	<i>STABILIZATION TIME</i>	<i>TIMEFRAME EXCEPTIONS</i>
PERIMETER DIKES, SWALES, DITCHES AND SLOPES	7 DAYS	NONE
HIGH QUALITY WATER (HQW) ZONES	7 DAYS	NONE
SLOPES STEEPER THAN 3:1	7 DAYS	IF SLOPES ARE 10' OR LESS IN LENGTH AND ARE NOT STEEPER THAN 2:1, 14 DAYS ARE ALLOWED.
SLOPES 3:1 OR FLATTER	14 DAYS	7 DAYS FOR SLOPES GREATER THAN 50' IN LENGTH.
ALL OTHER AREAS WITH SLOPES FLATTER THAN 4:1	14 DAYS	NONE, EXCEPT FOR PERIMETERS AND HQW ZONES.

NOTES: Less than 5' - 10' undisturbed buffer from ROW, ditchline, water feature, or drainage inlet, add BMP.

BMP Options: Wattle or Silt Fence

EROSION CONTROL DETAIL

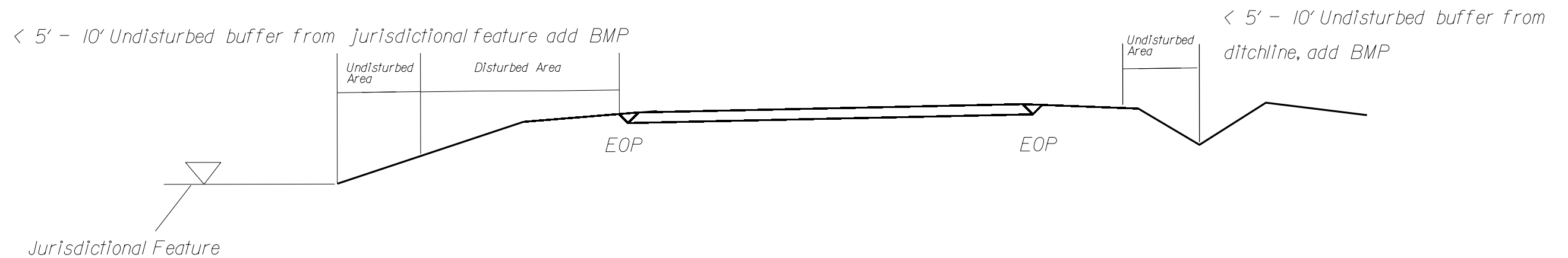
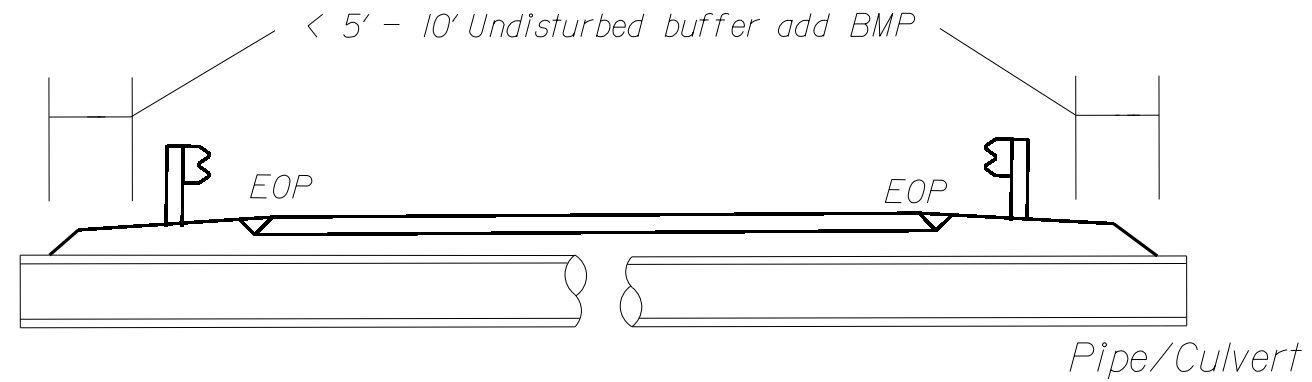

Use BMP's if shoulders and/or frontslopes and/or ditchline and/or backslopes are disturbed



< 5' - 10' Undisturbed buffer from inlet, add wattle

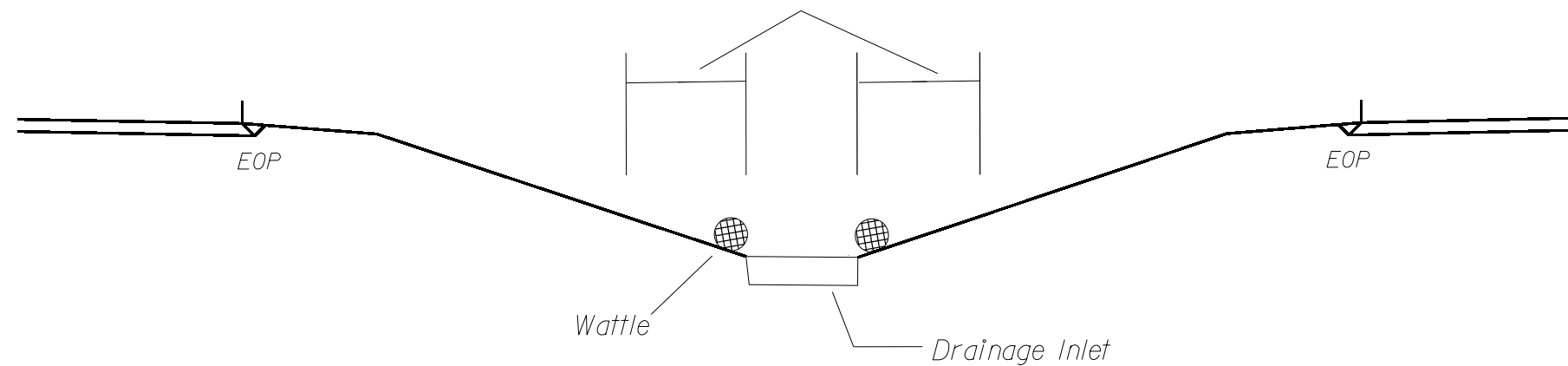

NOT TO SCALE

WATTLE DETAIL

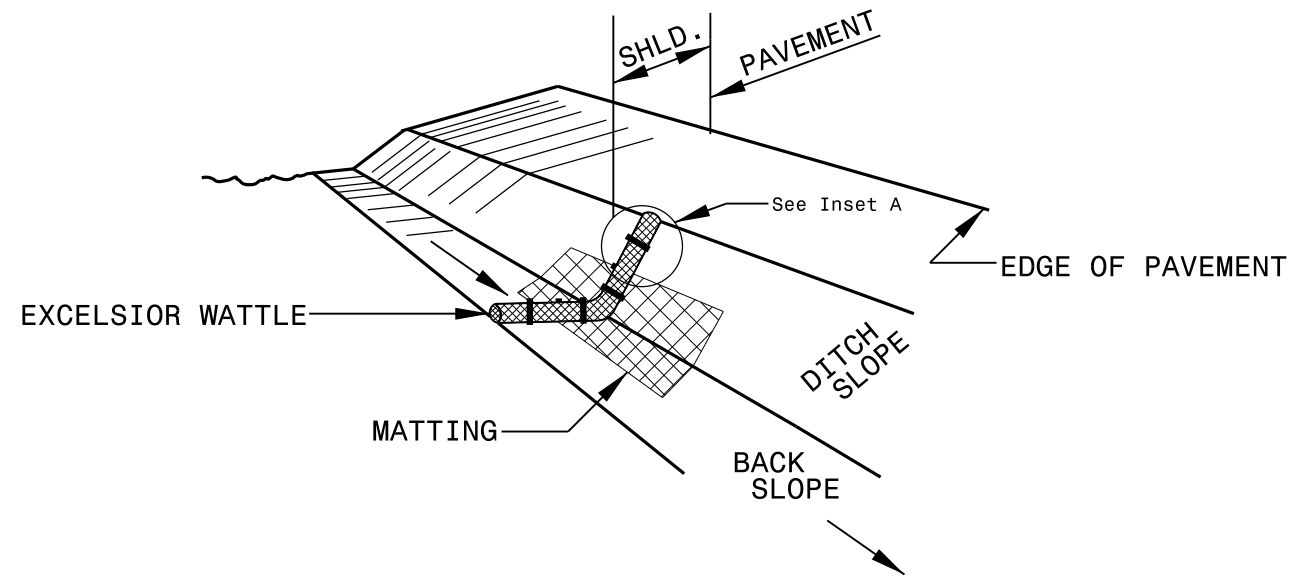

ISOMETRIC VIEW

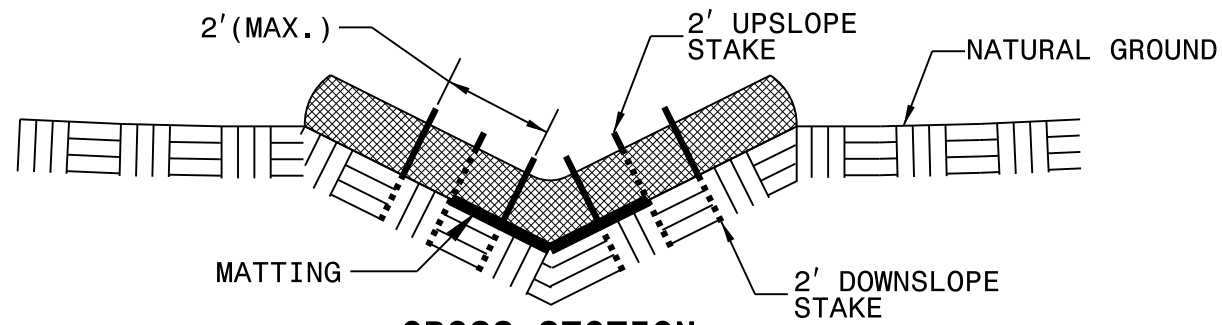

**CROSS SECTION
VEE DITCH**

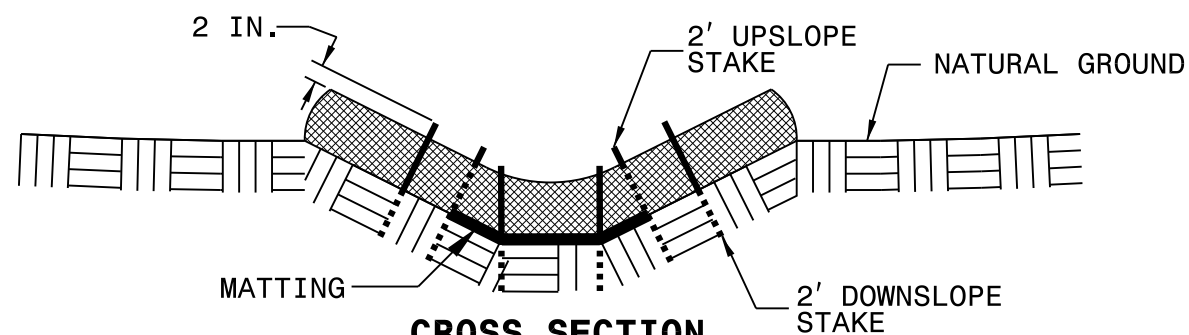

**CROSS SECTION
TRAPEZOIDAL DITCH**

NOTES:

USE MINIMUM 12 IN. DIAMETER EXCELSIOR WATTLE.

USE 2 FT. WOODEN STAKES WITH A 2 IN. BY 2 IN. NOMINAL CROSS SECTION.

ONLY INSTALL WATTLE(S) TO A HEIGHT IN DITCH SO FLOW WILL NOT WASH AROUND WATTLE AND SCOUR DITCH SLOPES AND AS DIRECTED.

INSTALL A MINIMUM OF 2 UPSLOPE STAKES AND 4 DOWNSLOPE STAKES AT AN ANGLE TO WEDGE WATTLE TO BOTTOM OF DITCH.

PROVIDE STAPLES MADE OF 0.125 IN. DIAMETER STEEL WIRE FORMED INTO A U SHAPE NOT LESS THAN 12" IN LENGTH.

INSTALL STAPLES APPROXIMATELY EVERY 1 LINEAR FOOT ON BOTH SIDES OF WATTLE AND AT EACH END TO SECURE IT TO THE SOIL.

INSTALL MATTING IN ACCORDANCE WITH SECTION 1631 OF THE STANDARD SPECIFICATIONS.

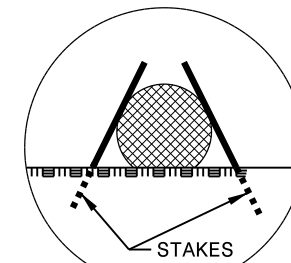

INSET A

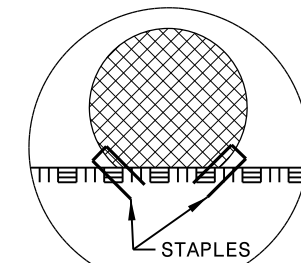

INSET B

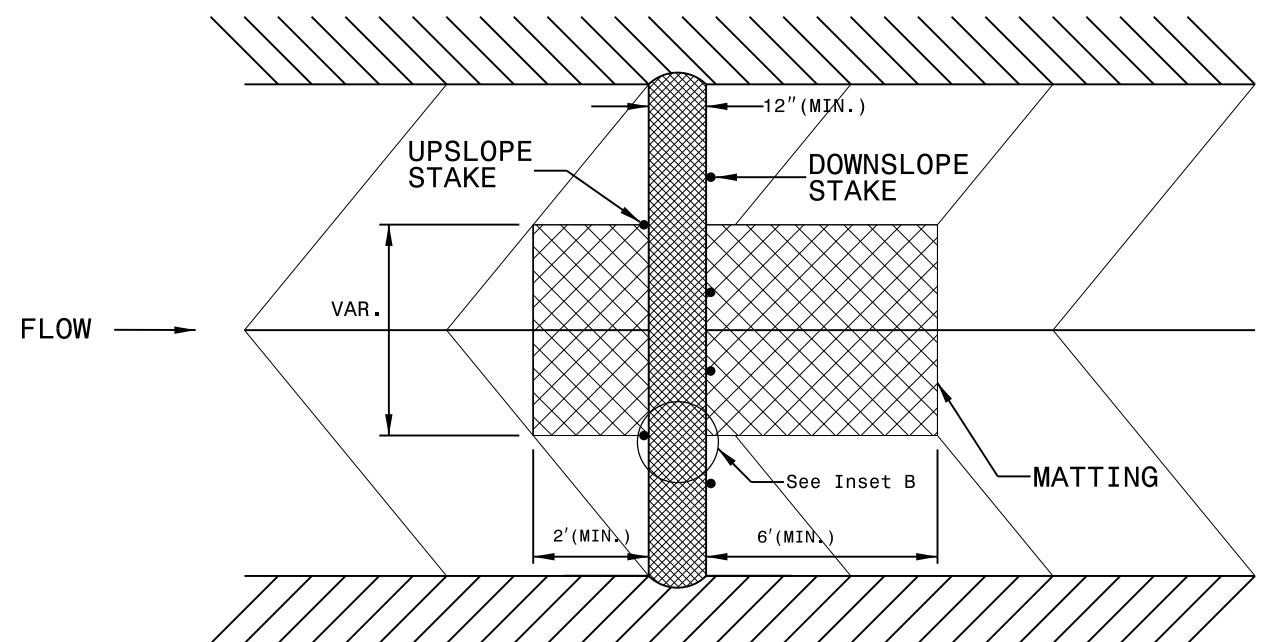

TOP VIEW

I:\FEB-2015 Iir41
 D:\Resurfacing\2015\Resurfacing\Pender County\Plan Sheets\3CR.20711.173. EC RESURF. 2015.dgn
 11/11/2015 10:52:44 AM