

SURVEY CONTROL SHEET B-4982

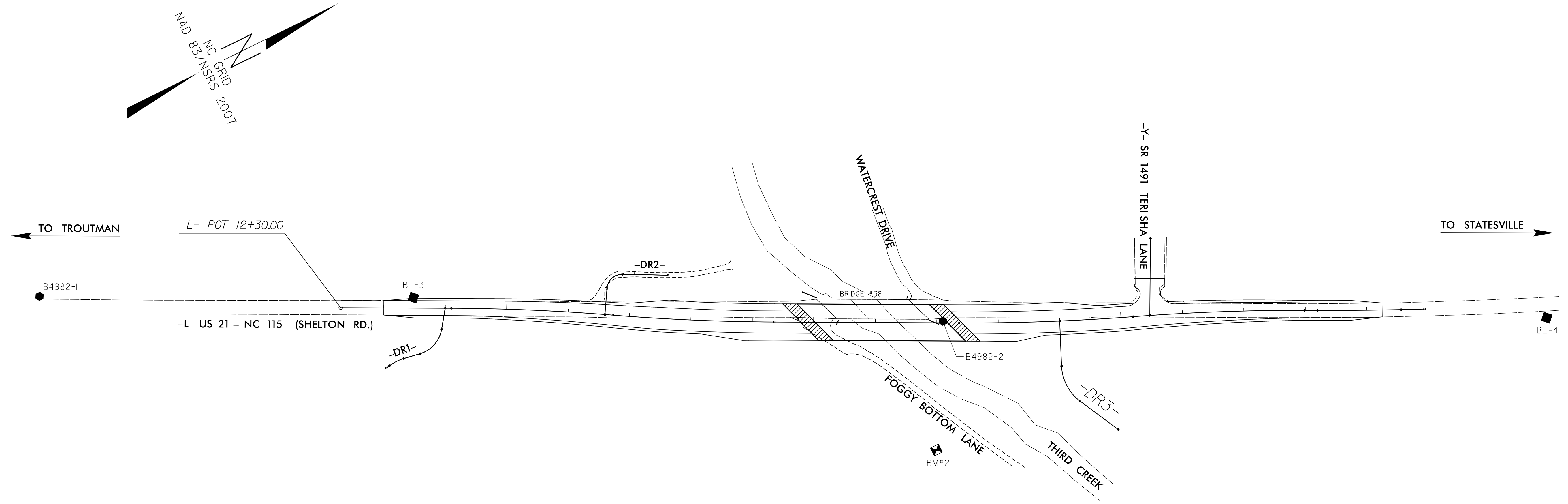

BL	POINT	DESC.	NORTH	EAST	ELEVATION	L STATION	OFFSET
1	B4982-1		732634.0570	1438341.5830	791.93	OUTSIDE PROJECT LIMITS	
3	BL-3		733177.9928	1438613.3462	792.13	13+48.09	16.90 LT
2	B4982-2		733932.7570	1439029.7980	793.82	22+09.96	2.78 LT
4	BL-4		734815.3503	1439460.7762	830.62	OUTSIDE PROJECT LIMITS	

.....
 BM2 ELEVATION = 782.82
 N 733830 E 1439213
 L STATION 22+00.00 207 RIGHT
 R/R SPIKE SET IN BASE OF 24' OAK ONSOUTHEAST
 SIDE OF THIRD CREEK, 33' FROMCENTERLINE OF
 FOGGY BOTTOM RD.

DATUM DESCRIPTION
 THE LOCALIZED COORDINATE SYSTEM DEVELOPED FOR THIS PROJECT IS BASED ON THE STATE PLANE COORDINATES ESTABLISHED BY NCDOT FOR MONUMENT "B4982-1" WITH NAD 83/NSRS 2007 STATE PLANE GRID COORDINATES OF NORTHING: 732634.057(ft) EASTING: 1438341.583(ft) ELEVATION: 791.93(ft)
 THE AVERAGE COMBINED GRID FACTOR USED ON THIS PROJECT (GROUND TO GRID) IS: 0.99987725
 THE N.C. LAMBERT GRID BEARING AND LOCALIZED HORIZONTAL GROUND DISTANCE FROM "B4982-1" TO -L- STATION 12+30.00 IS N 28°30'16.08" E 490.21'
 ALL LINEAR DIMENSIONS ARE LOCALIZED HORIZONTAL DISTANCES
 VERTICAL DATUM USED IS NAVD 88

NOTE: DRAWING NOT TO SCALE

NOTES:

- THE CONTROL DATA FOR THIS PROJECT CAN BE FOUND ELECTRONICALLY BY SELECTING PROJECT CONTROL DATA AT:
[HTTPS://CONNECT.NCDOT.GOV/RESOURCES/LOCATION](https://connect.ncdot.gov/resources/location)
 THE FILES TO BE FOUND ARE AS FOLLOWS:
 B4982_LS_CONTROL.TXT
 B4982_LS_LOCAL.TXT
 SITE CALIBRATION INFORMATION HAS NOT BEEN PROVIDED FOR THIS PROJECT. IF FURTHER INFORMATION IS NEEDED, PLEASE CONTACT THE LOCATION AND SURVEYS UNIT.
- INDICATES GEODETIC CONTROL MONUMENTS USED OR SET FOR HORIZONTAL PROJECT CONTROL BY THE NCDOT LOCATION AND SURVEYS UNIT.
- INDICATES CONTROL MONUMENTS SET FOR HORIZONTAL PROJECT CONTROL BY THE NCDOT LOCATION AND SURVEYS UNIT.
- INDICATES BENCHMARKS USED OR SET FOR VERTICAL PROJECT CONTROL BY THE NCDOT LOCATION AND SURVEYS UNIT.
 PROJECT CONTROL ESTABLISHED USING GLOBAL POSITIONING SYSTEM.
 NETWORK ESTABLISHED FROM NGS ONLINE POSITIONING SERVICE (OPUS)