

# 6TH ST. ROADWAY PLAN SHEET

**HNTB** HNTB NORTH CAROLINA, P.C.  
 343 E. Six Forks Road, Suite 200  
 Raleigh, North Carolina 27609  
 NC License No: C-1554

PROJECT REFERENCE NO. P-5705BA  
 SHEET NO. 13

DATE: MARCH 16, 2018

PROJECT REFERENCE NO. P-5705BA  
 SHEET NO. 13

R/W SHEET NO.

ROADWAY DESIGN ENGINEER

**ERIC W. SECKINGER**  
 NORTH CAROLINA PROFESSIONAL ENGINEER  
 SEAL 035826  
 3/15/2018

**Y4 ROADWAY CURVE DATA**

PI Sta 14+30.23	PI Sta 15+00.66
$\Delta = 13^{\circ}17'11.8''$ (LT)	$\Delta = 15^{\circ}12'11.7''$ (LT)
$D = 18^{\circ}19'15.9''$	$D = 22^{\circ}16'15.9''$
$L = 72.52'$	$L = 68.26'$
$T = 36.42'$	$T = 34.33'$
$R = 312.73'$	$R = 257.27'$
$e = \text{EXISTING}$	$e = \text{EXISTING}$

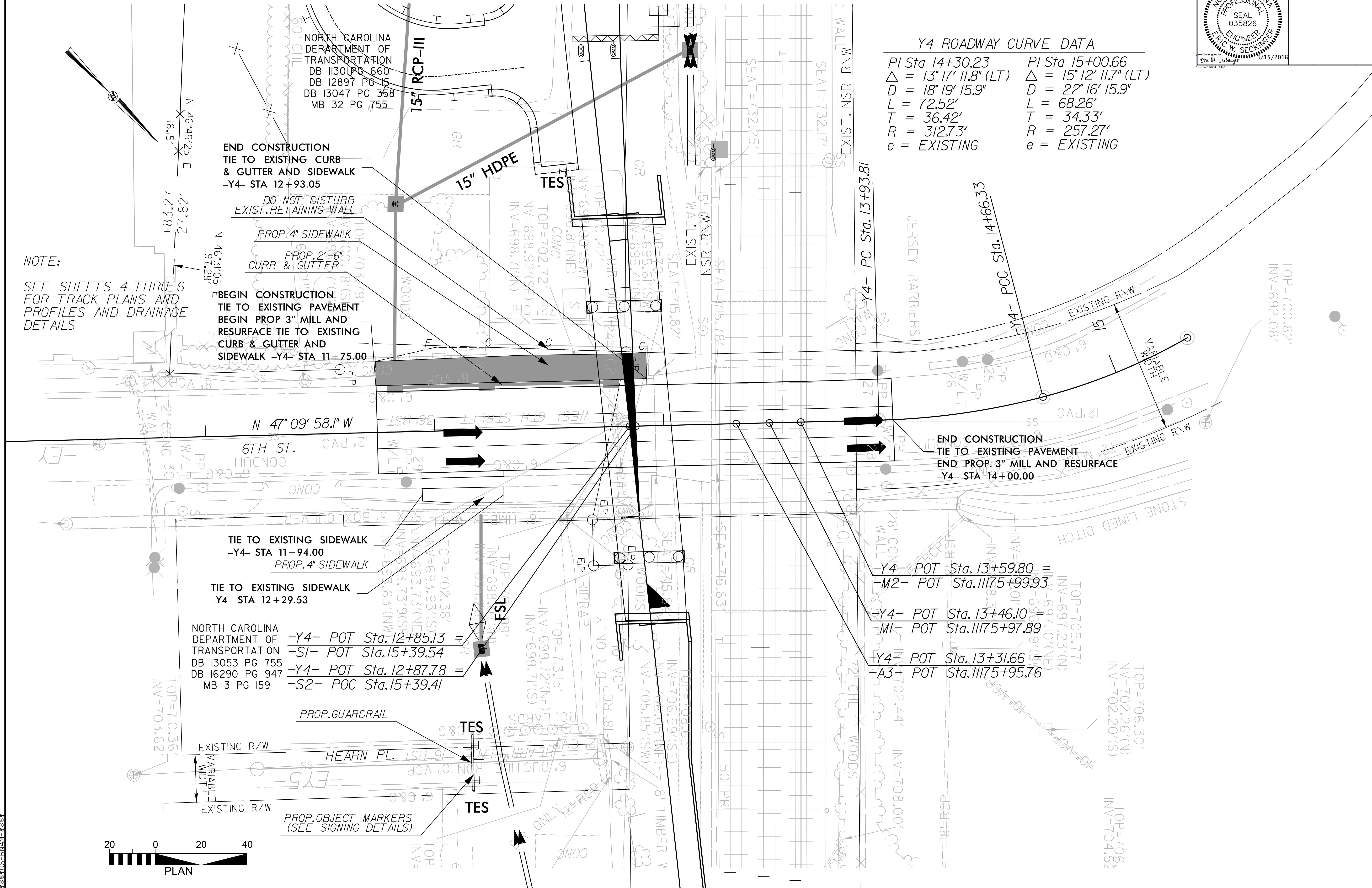

**NOTE:**  
 SEE SHEETS 4 THRU 6  
 FOR TRACK PLANS AND  
 PROFILES AND DRAINAGE  
 DETAILS

END CONSTRUCTION  
 TIE TO EXISTING CURB  
 & GUTTER AND SIDEWALK  
 -Y4- STA 12+93.05

DO NOT DISTURB  
 EXIST. RETAINING WALL

PROP. 4" SIDEWALK  
 PROP. 2'-6" CURB & GUTTER

BEGIN CONSTRUCTION  
 TIE TO EXISTING PAVEMENT  
 BEGIN PROP 3" MILL AND  
 RESURFACE TIE TO EXISTING  
 CURB & GUTTER AND  
 SIDEWALK -Y4- STA 11+75.00

END CONSTRUCTION  
 TIE TO EXISTING PAVEMENT  
 END PROP. 3" MILL AND RESURFACE  
 -Y4- STA 14+00.00

TIE TO EXISTING SIDEWALK  
 -Y4- STA 11+94.00  
 PROP. 4" SIDEWALK

TIE TO EXISTING SIDEWALK  
 -Y4- STA 12+29.53

NORTH CAROLINA  
 DEPARTMENT OF  
 TRANSPORTATION  
 DB 13053 PG 755  
 DB 16290 PG 947  
 MB 3 PG 159

-Y4- POT Sta. 12+85.13 =  
 -S1- POT Sta. 15+39.54  
 -Y4- POT Sta. 12+87.78 =  
 -S2- POC Sta. 15+39.41

-Y4- POT Sta. 13+59.80 =  
 -M2- POT Sta. 11175+99.93  
 -Y4- POT Sta. 13+46.10 =  
 -M1- POT Sta. 11175+97.89  
 -Y4- POT Sta. 13+31.66 =  
 -A3- POT Sta. 11175+95.76

