

**TYPICAL SECTION #11**

-S1- STA. 40+50 TO STA. 41+95 (+/- BEGIN BRIDGE)  
(-A1- STA. 40+50 TO STA. 41+93 (+/- BEGIN BRIDGE))

- NOTES:
1. THE TYPICAL SECTIONS TAKE PRECEDENCE OVER THE CROSS SECTIONS. CROSS SECTIONS ARE PROVIDED FOR REFERENCE ONLY.
  2. DIMENSION SHOWN IS FOR BIDDING PURPOSES ONLY AND MUST BE COORDINATED WITH THE NORFOLK SOUTHERN REPRESENTATIVE PRIOR TO CONSTRUCTION. SEE 'EXCAVATION ADJACENT TO ACTIVE TRACK DETAIL' FOR REQUIREMENTS.

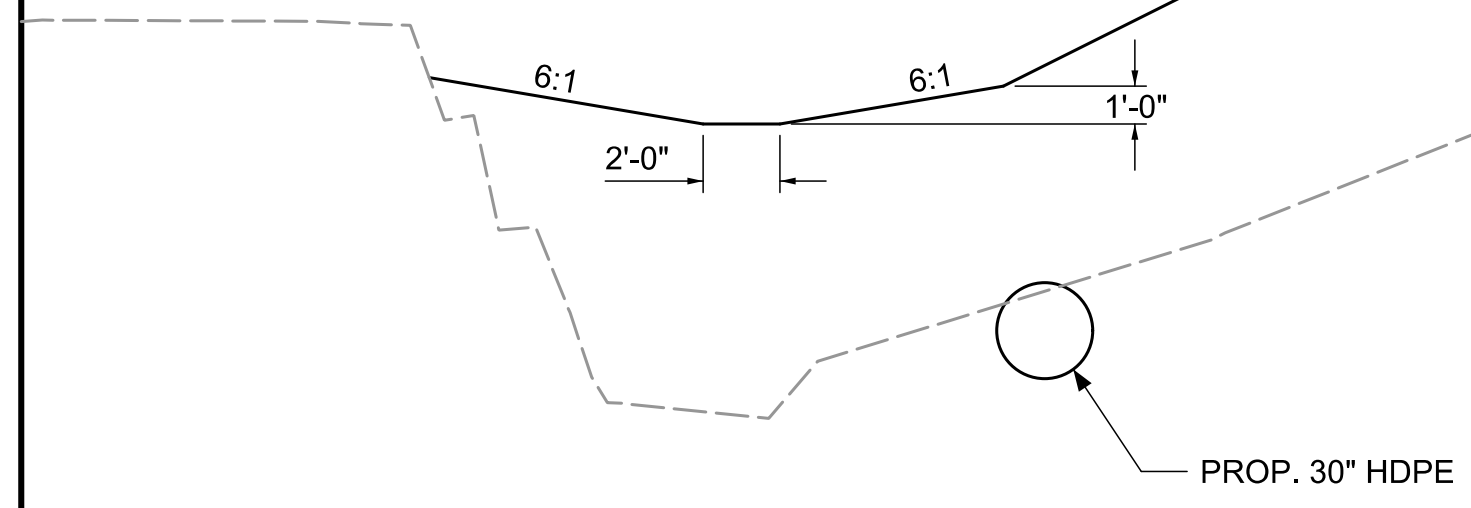

PROP. 30" HDPE

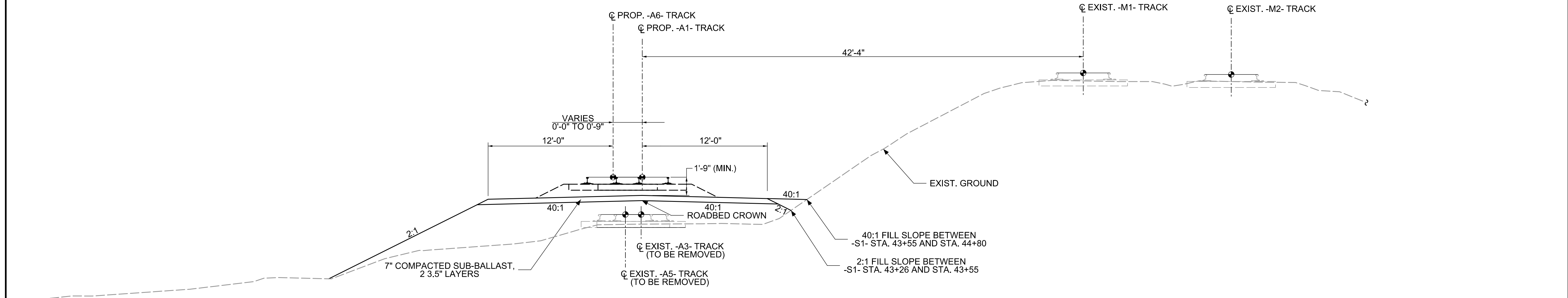

**TYPICAL SECTION #12**

-S1- STA. 43+26 (+/- END BRIDGE) TO STA. 44+80  
(-A1- STA. 43+24 (+/- END BRIDGE) TO STA. 44+79)