

**This electronic collection of documents is provided  
for the convenience of the user  
and is Not a Certified Document –**

**The documents contained herein were originally issued  
and sealed by the individuals whose names and license  
numbers appear on each page, on the dates appearing  
with their signature on that page.**

**This file or an individual page  
shall not be considered a certified document.**

# CROSS SECTION INDEX

## PROJECT NO. B-5161

ALIGNMENT		SHEET NUMBER
-L-	.....	X-1 TO X-7
-Y-	.....	X-8
-DRI-	.....	X-9
-GWY-	.....	X-10

Note: Approximate quantities only. Unclassified Excavation, Fine Grading, Clearing and Grubbing, Breaking of Existing Pavement, and Removal of Existing Pavement will be paid for at the contract lump sum price for "Grading."

5/14/99  
c:\pwworking\2/20/2016 07:31:24\B5161.RDY\_INDEX.dgn

## STATE OF NORTH CAROLINA DIVISION OF HIGHWAYS

### CROSS-SECTION SUMMARY

NOTE: EMBANKMENT COLUMN DOES NOT INCLUDE BACKFILL FOR UNDERCUT

Station	Uncl. Exc.	Embt	Station	Uncl. Exc.	Embt
L	(cu. yd.)	(cu. yd.)	GWY	(cu. yd.)	(cu. yd.)
10+00.00	0	0	10+76.00	0	0
10+50.00	6	0	10+76.43	0	0
11+00.00	19	6	11+00.00	11	0
11+50.00	19	11	11+15.00	21	0
12+00.00	11	28	11+16.00	1	0
12+50.00	11	129			
13+00.00	12	360			
13+50.00	28	621			
14+00.00	22	777			
14+32.81	0	538			
15+95.19	0	0			
16+00.00	0	118			
16+50.00	0	1247			
17+00.00	0	1321			
17+50.00	0	1148			
18+00.00	0	1147			
18+50.00	0	1319			
19+00.00	24	1060			
19+50.00	61	744			
20+00.00	56	581			
20+50.00	30	447			
21+00.00	19	300			
21+50.00	26	175			
22+00.00	46	89			
22+50.00	46	70			
23+00.00	19	40			
Station	Uncl. Exc.	Embt	Station	Uncl. Exc.	Embt
Y	(cu. yd.)	(cu. yd.)	GWY	(cu. yd.)	(cu. yd.)
10+17.23	0	0	11+89.00	0	0
10+25.00	1	5	11+90.00	1	0
10+50.00	2	14	12+00.00	13	0
10+75.00	5	9	12+15.94	11	0
10+90.00	3	2	12+16.00	0	0
Station	Uncl. Exc.	Embt	Station	Uncl. Exc.	Embt
DR1	(cu. yd.)	(cu. yd.)	GWY	(cu. yd.)	(cu. yd.)
10+25.00	0	0			
10+50.00	0	241			
10+75.00	0	107			
11+00.00	2	13			

Approximate quantities only. Unclassified excavation, fine grading, clearing and grubbing, breaking of existing pavement and removal of existing pavement will be paid for at the lump sum price for "Grading".

REVISIONS

6/21/08  
2/10/2018 Cherri's Desktop\B5161\B5161\_RDY\_XSC\_Summary.dgn

6/23/16



PROJ. REFERENCE NO.  
B-5161

SHEET NO.  
X-1

75 70 65 60 55 50 45 40 35 30 25 20 15 10 5 0 5 10 15 20 25 30 35 40 45 50 55 60 65 70 75

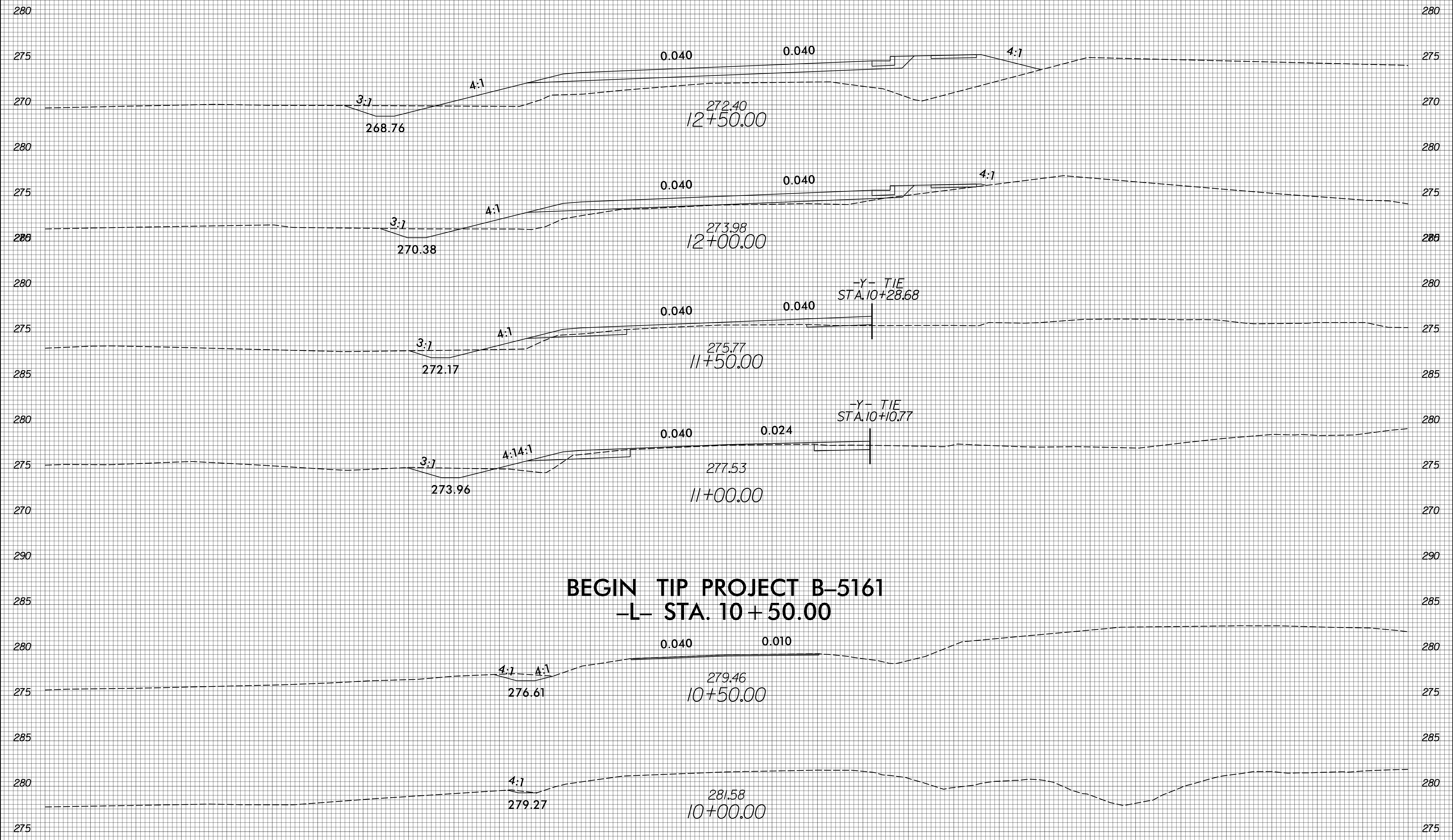

**BEGIN TIP PROJECT B-5161**  
**-L- STA. 10+50.00**

75 70 65 60 55 50 45 40 35 30 25 20 15 10 5 0 5 10 15 20 25 30 35 40 45 50 55 60 65 70 75

2/20/2018  
S:\Projects\B5161\Topo\0731424\B5161\_RDY\_XPL\_L.dgn





6/23/16



PROJ. REFERENCE NO.  
B-5161

SHEET NO.  
X-3

75 70 65 60 55 50 45 40 35 30 25 20 15 10 5 0 5 10 15 20 25 30 35 40 45 50 55 60 65 70 75

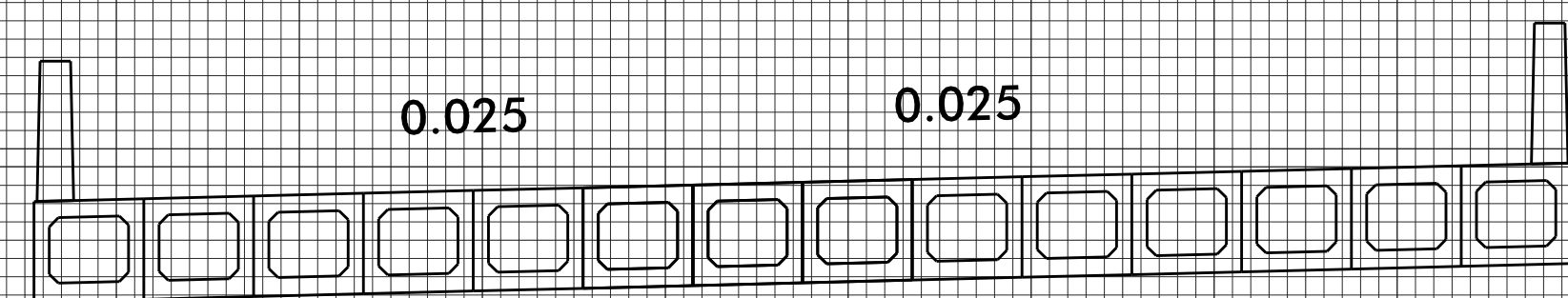

267.43

15+50.00

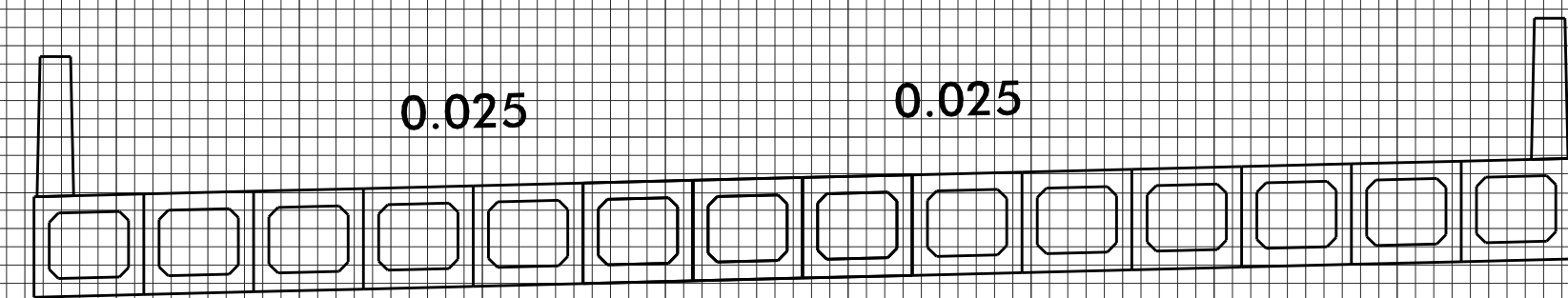

256.38

15+00.00

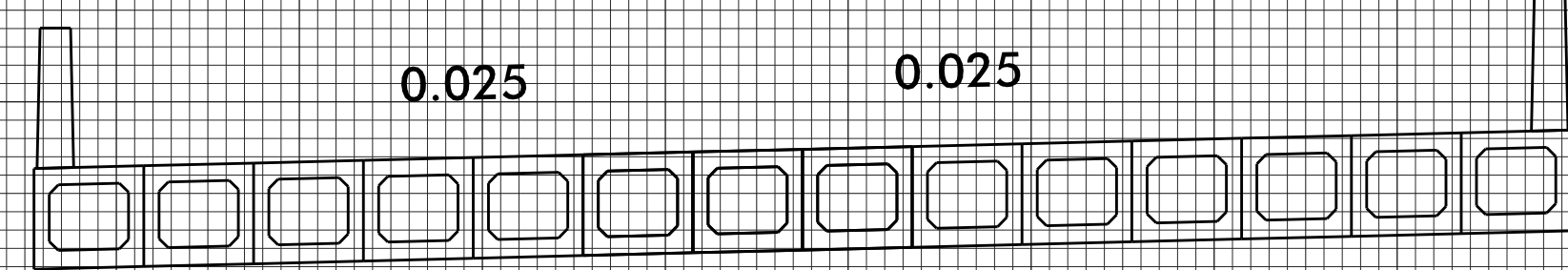

268.05

14+50.00

259.04

3:1

3:1

-L-

75 70 65 60 55 50 45 40 35 30 25 20 15 10 5 0 5 10 15 20 25 30 35 40 45 50 55 60 65 70 75

2/20/2018  
S:\38899\B\19\g\topo\0731424\B5161\RDY\_XPL.L.dgn



6/23/16

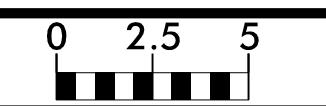

PROJ. REFERENCE NO.	SHEET NO.
B-5161	X-5

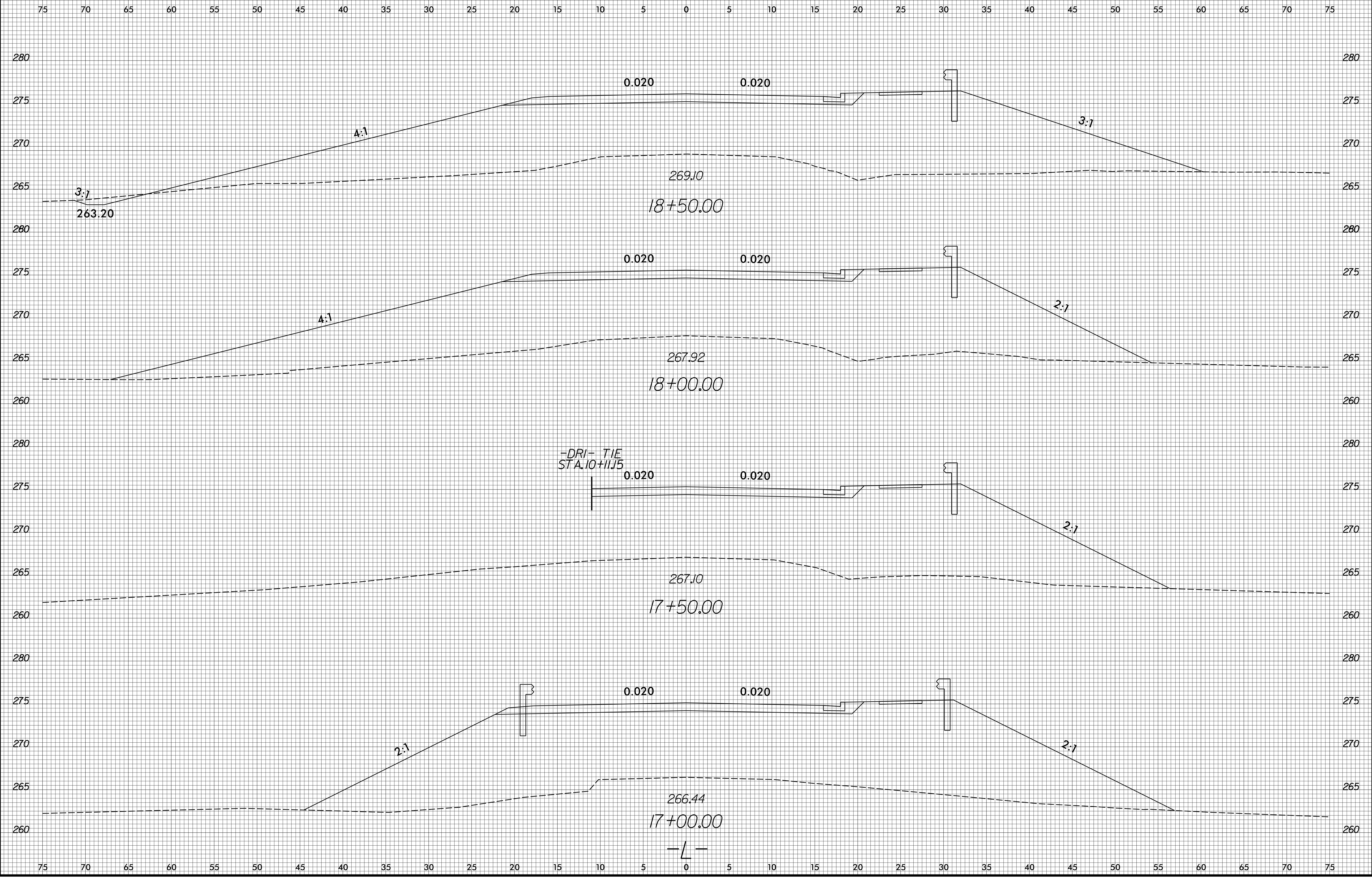

2/20/2018  
S:\38859\Projects\1709\topo\0731424\B5161\_RDY\_XPL\_L.dgn



6/23/16  
2/20/2018  
S:\38899\5119\topo\0731424\B5161\RDY\_XPL\_L.dgn

0 2.5 5	PROJ. REFERENCE NO. B-5161	SHEET NO. X-6
---------	-------------------------------	------------------

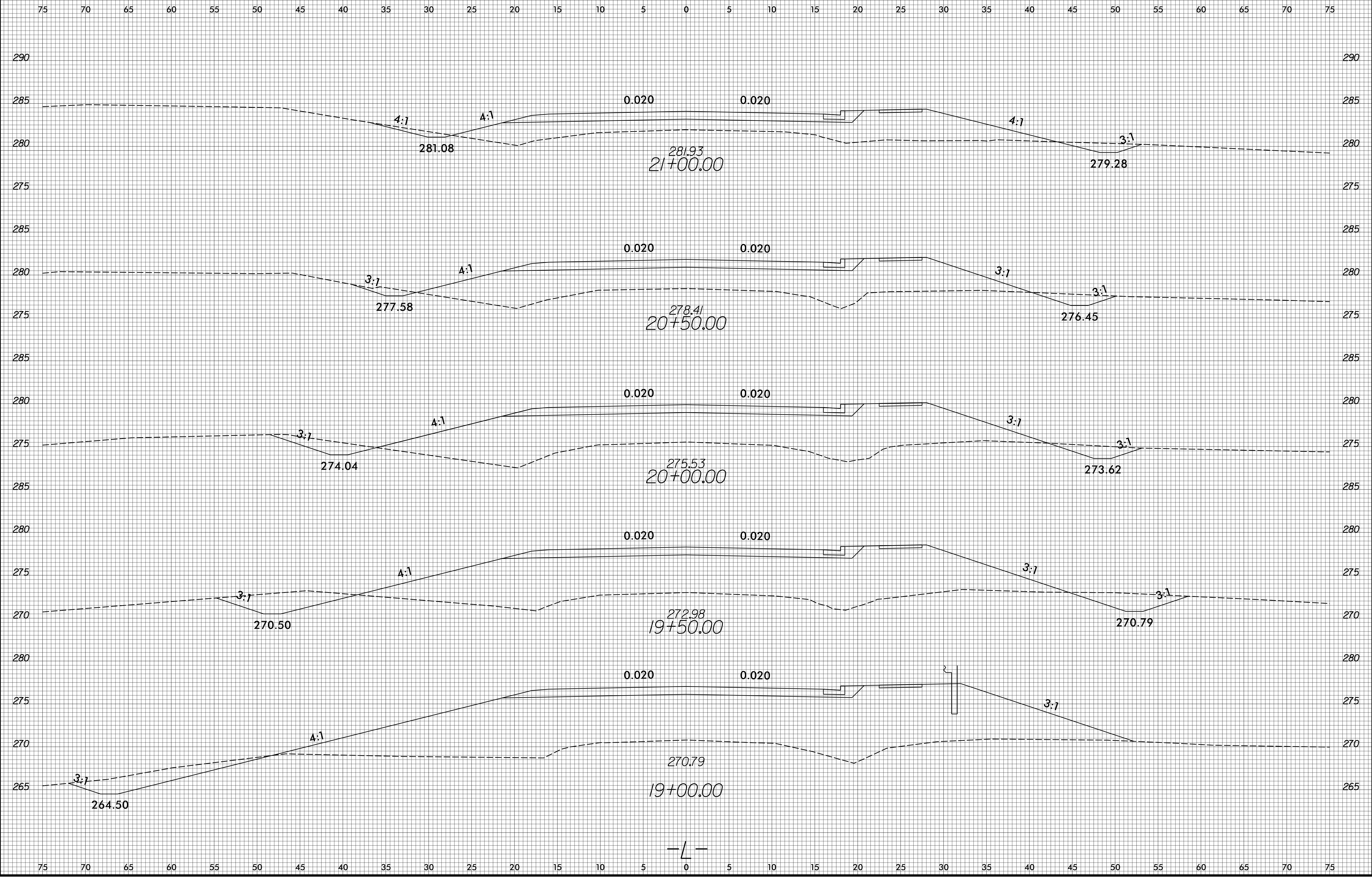

6/23/16



PROJ. REFERENCE NO.  
B-5161

SHEET NO.  
X-7

75 70 65 60 55 50 45 40 35 30 25 20 15 10 5 0 5 10 15 20 25 30 35 40 45 50 55 60 65 70 75

### END TIP PROJECT B-5161 -L- STA. 23+00.00

300.45  
23+50.00

296.61  
23+00.00

292.87  
22+50.00

289.27  
22+00.00

285.65  
21+50.00

-L-

0.030 0.020

0.020 0.020

0.020 0.020

0.020 0.020

3:1 4:1

4:1 4:1

4:1 4:1

4:1 3:1

4:1 3:1

4:1 3:1

291.49

288.02

284.55

290.50

286.76

283.02

2/20/2018  
S:\38899\B5161\topo\0731424\B5161.RDY.XPL.L.dgn

6/23/16

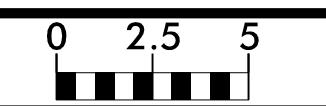

PROJ. REFERENCE NO.	SHEET NO.
B-5161	X-8

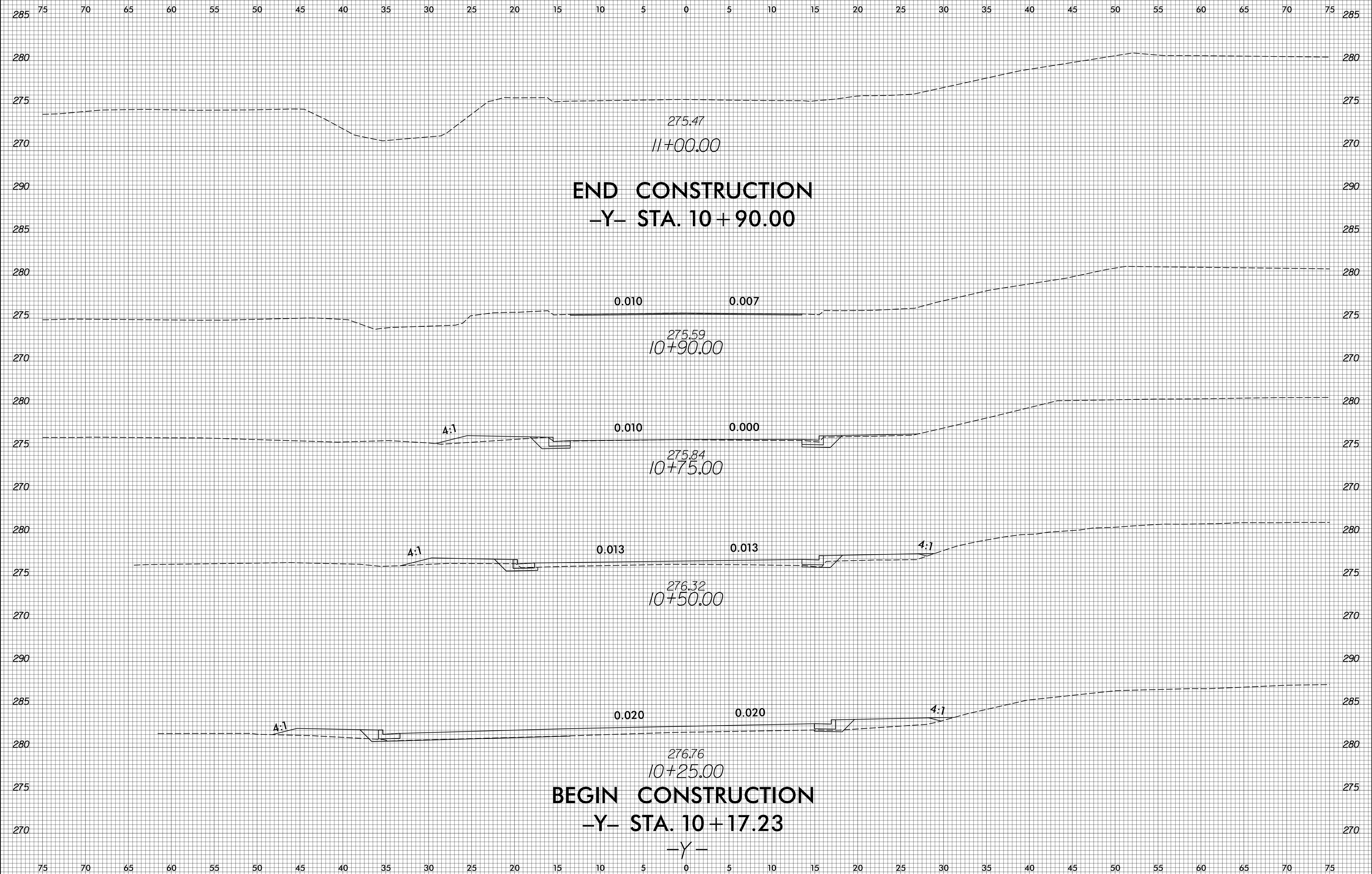

2/20/2018 8:28:59 AM S:\Projects\161119\161119.dwg

6/23/16



PROJ. REFERENCE NO.	SHEET NO.
B-5161	X-9

PROJ. REFERENCE NO.	SHEET NO.
B-5161	X-9

75 70 65 60 55 50 45 40 35 30 25 20 15 10 5 0 5 10 15 20 25 30 35 40 45 50 55 60 65 70 75

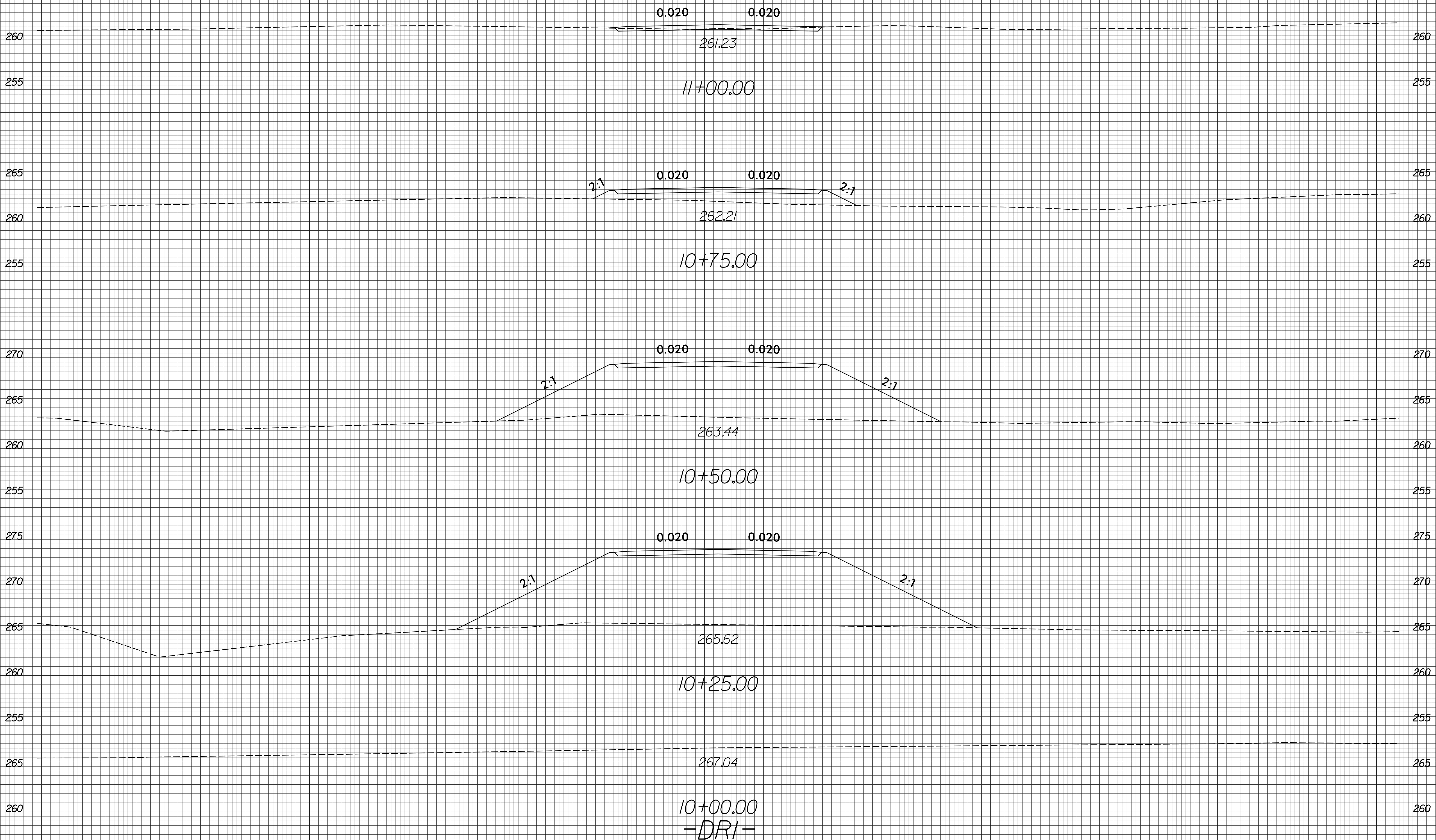

75 70 65 60 55 50 45 40 35 30 25 20 15 10 5 0 5 10 15 20 25 30 35 40 45 50 55 60 65 70 75

2/20/2018  
 S:\BROWNE\proj\topo\0731424\B5161\RDY\_XPL\_DRI.dgn

