

65/88/56

TIP PROJECT: B-5161

STATE OF NORTH CAROLINA  
DIVISION OF HIGHWAYS

RIGHT OF WAY, EASEMENTS  
AND PROPERTY TIES

WAKE COUNTY

STATE	STATE PROJECT REFERENCE NO.	SHEET NO.	TOTAL SHEETS
N.C.	B-5161	RW-1	

LOCATION: BRIDGE NO. 362 OVER BEAVER CREEK ON SR 1162  
TYPE OF WORK: GRADING, DRAINAGE, PAVING, AND STRUCTURE

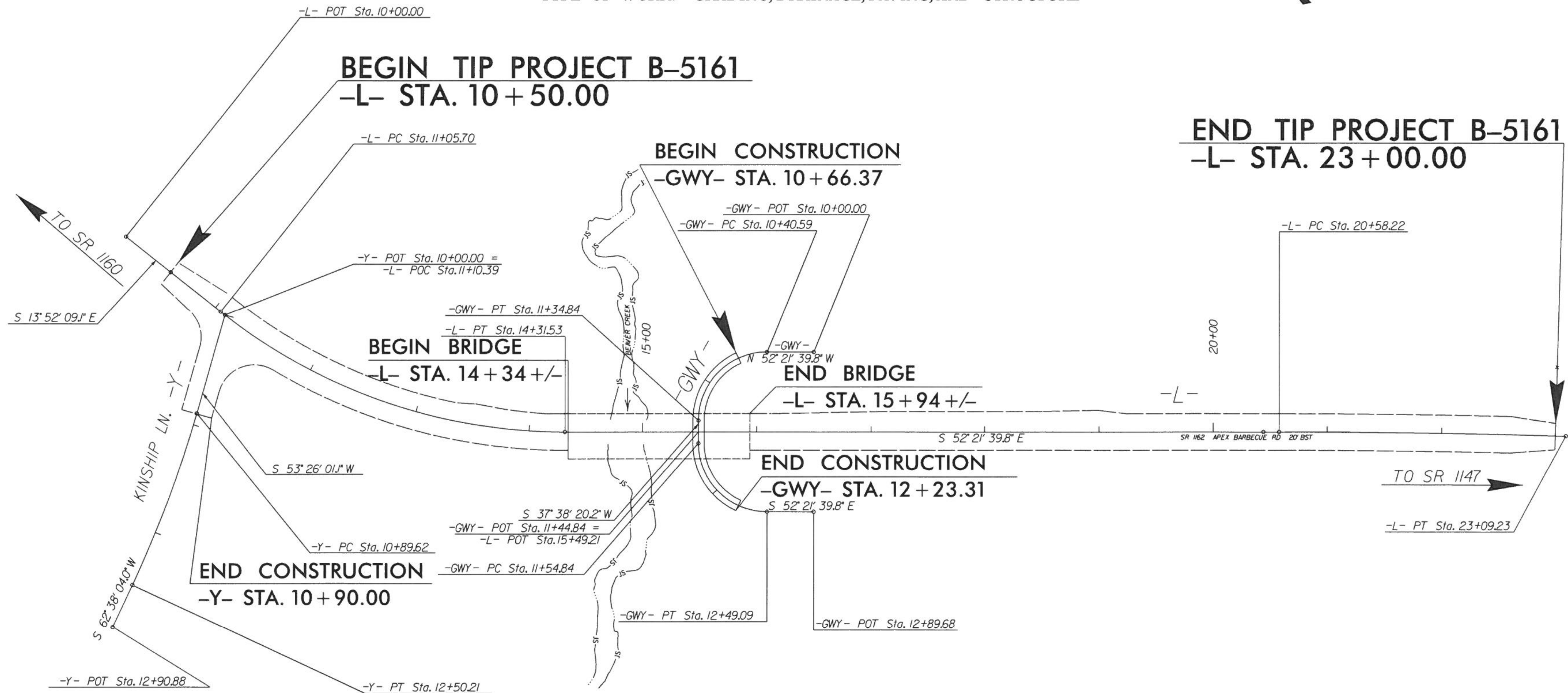

GRAPHIC SCALES



LENGTH ROADWAY TIP PROJECT B-5161 = 0.207 MILES  
 LENGTH STRUCTURES TIP PROJECT B-5161 = 0.030 MILES  
 TOTAL LENGTH TIP PROJECT B-5161 = 0.237 MILES

Prepared in the Office of SEPI Engineering for  
DIVISION OF HIGHWAYS

1000 Birch Ridge Dr., Raleigh NC, 27610

2017 STANDARD SPECIFICATIONS

RIGHT OF WAY DATE:  
OCTOBER 16, 2017

LETTING DATE:  
MAY 15, 2018

DAVID STUTTS, P.E.  
NCDOT CONTACT

PROFESSIONAL LAND  
SURVEYOR

*Jeffrey S. Coats*  
SIGNATURE

