

# SURVEY CONTROL SHEET B-5161

○ B5161-1  
 N= 720346.233  
 E= 2027907.296

○ B5161-2

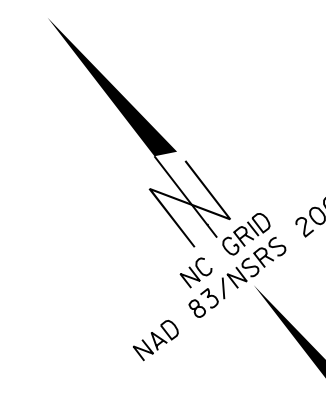

ROW MARKER CONCRETE OR GRANITE -E-

ALIGN	STATION	OFFSET	NORTH	EAST
L	11+28.42	-54.85	718661.56700	2028159.81600
L	11+38.88	-30.38	718645.22888	2028139.26041
L	12+00.00	-60.00	718604.44568	2028186.99043
L	14+31.53	-60.00	718447.57274	2028312.60229
L	14+31.53	60.00	718352.54776	2028239.32028
L	20+58.22	-60.00	718064.86386	2028808.86197
L	20+58.22	60.00	717969.83887	2028735.57996
L	23+00.00	60.00	717820.63527	2028923.77040
L	23+00.00	30.00	717843.89449	2028942.72540
L	23+00.00	-30.00	717890.40564	2028980.62944
L	23+00.00	-60.00	717913.65752	2028999.57846

ROW MARKER CONCRETE OR GRANITE -E-

ALIGN	STATION	OFFSET	NORTH	EAST
Y	10+76.76	-29.62	718593.80145	2028058.42427
Y	10+76.76	-40.10	718585.37987	2028064.67102

○ B5161-4  
 N=717379.308  
 E=2031271.069

○ B5161-3  
 N=717454.133  
 E=2029677.853

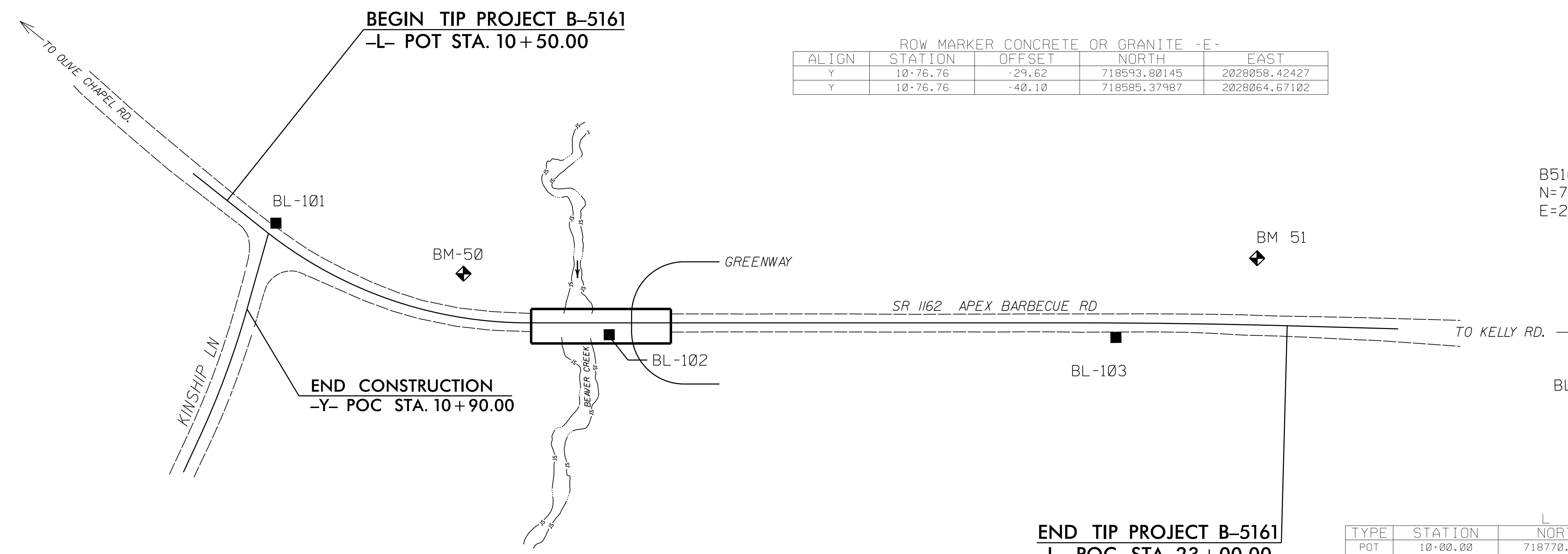

**END TIP PROJECT B-5161**  
 -L- POC STA. 23+00.00

L

TYPE	STATION	NORTH	EAST
POT	10+00.00	718770.4829	2028075.9451
PC	11+05.70	718667.8621	2028101.2827
PT	14+31.53	718400.0603	2028275.9613
PC	20+58.22	718017.3514	2028772.2210
PT	23+09.23	717861.3108	2028968.8276
POT	25+91.99	717682.4582	2029187.8343

Y

TYPE	STATION	NORTH	EAST
POT	10+00.00	718663.3159	2028102.4285
PC	10+89.62	718609.9217	2028030.4449
PT	12+50.21	718524.9971	2027894.3573
POT	12+90.88	718506.3016	2027858.2369

BL POINT	DESC.	NORTH	EAST	ELEVATION	L STATION	OFFSET
GPS2	B5161-2	719261.3480	2027983.2720	303.53	OUTSIDE PROJECT LIMITS	
101	BL-101	718667.3330	2028116.3070	276.38	11+09.94	14.44 LT
102	BL-102	718333.0970	2028340.5750	267.09	15+23.59	13.57 RT
103	BL-103	717976.2380	2028798.1800	281.21	21+03.97	16.59 RT
104	BL-104	717595.6030	2029231.3470	326.37	OUTSIDE PROJECT LIMITS	

.....	.....
50	51
ELEVATION + 267.81	ELEVATION + 296.56
N 718490	N 717949
E 2028251	E 2028982
L STATION 13+48.00 50 LEFT	L STATION 22+64.00 76 LEFT
RRS IN 24" GUM	RRS IN 16" PINE
.....	.....

**DATUM DESCRIPTION**

THE LOCALIZED COORDINATE SYSTEM DEVELOPED FOR THIS PROJECT IS BASED ON THE STATE PLANE COORDINATES ESTABLISHED BY NCDOT FOR MONUMENT "B5161-2" WITH NAD 83/NSRS 2007 STATE PLANE GRID COORDINATES OF NORTHING: 719,261.348(ft) EASTING: 2,027,983.272(ft) ELEVATION: 303.53(ft)

THE AVERAGE COMBINED GRID FACTOR USED ON THIS PROJECT (GROUND TO GRID) IS: 0.99989559

THE N.C. LAMBERT GRID BEARING AND LOCALIZED HORIZONTAL GROUND DISTANCE FROM "B5161-2" TO -L- STATION 10+50 IS S 10°58'49.3" E 549.47'

ALL LINEAR DIMENSIONS ARE LOCALIZED HORIZONTAL DISTANCES VERTICAL DATUM USED IS NAVD 88

**GEOID G03NC**  
**NOTE: DRAWING NOT TO SCALE**

**NOTES:**  
 ○ INDICATES GEODETIC CONTROL MONUMENTS USED OR SET FOR HORIZONTAL AND VERTICAL PROJECT CONTROL BY THE NCDOT LOCATION AND SURVEYS UNIT. SITE CALIBRATION INFORMATION HAS NOT BEEN PROVIDED FOR THIS PROJECT. IF FURTHER INFORMATION IS NEEDED, PLEASE CONTACT THE LOCATION AND SURVEYS UNIT.

5/15/17  
 2/7/2018  
 2:15:56 PM  
 1:17:017