

STATE	PROJECT NO.	SHEET NO.	TOTAL SHEETS
N.C.	I-5825	5	
WBS NO.		50468.3.1	

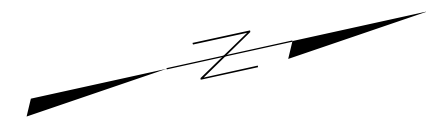
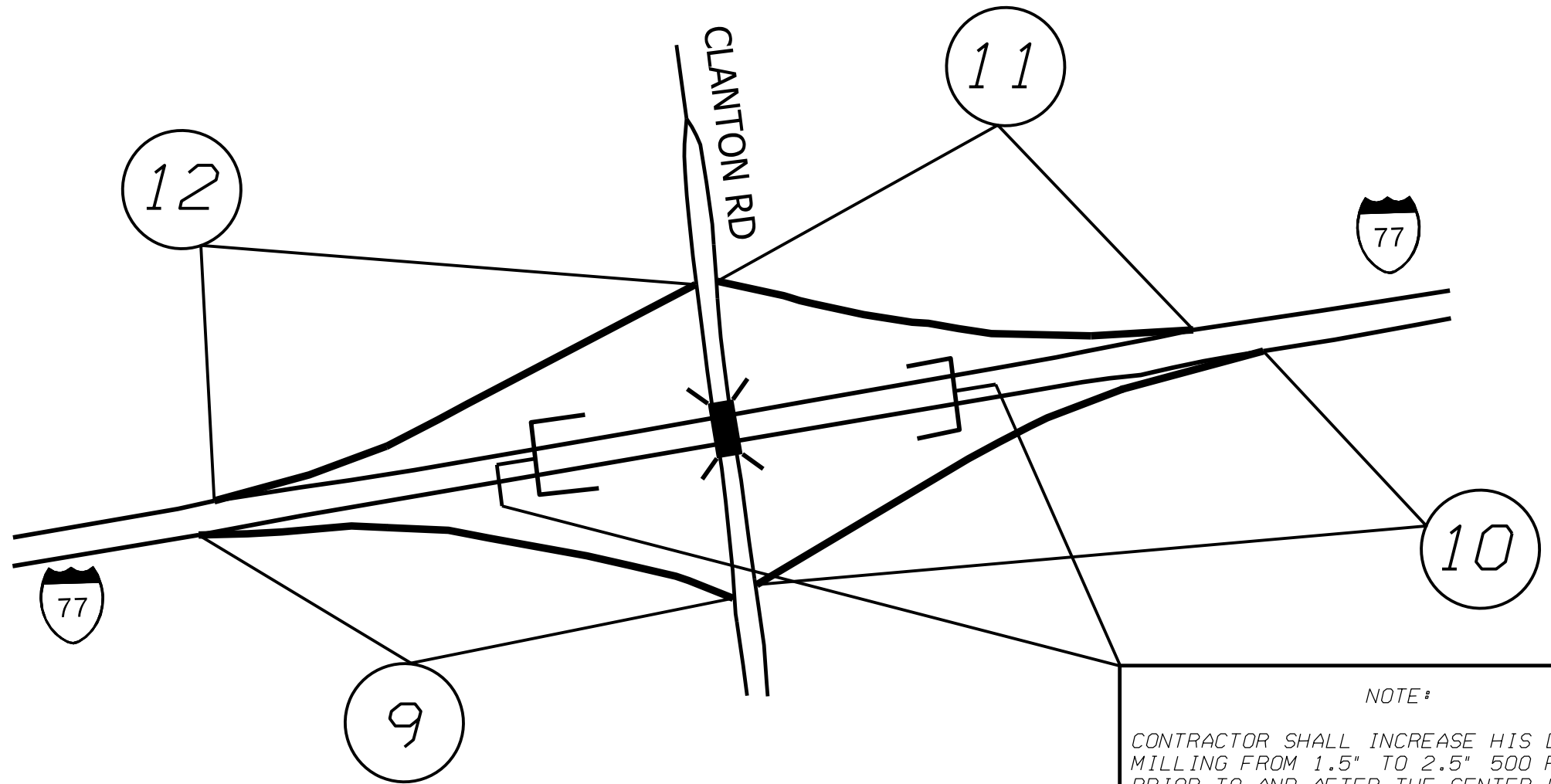

NOTE:
 CONTRACTOR SHALL INCREASE HIS DEPTH OF MILLING FROM 1.5" TO 2.5" 500 FEET PRIOR TO AND AFTER THE CENTER LINE OF EACH OVERHEAD BRIDGE AS DIRECTED BY THE ENGINEER.

WORK AREA	DESCRIPTION
# 9 I-77 NB OFF RAMP	FROM PHYSICAL GORE TO CLANTON RD. (SEE TYPICAL # 16)
# 10 I-77 NB ON RAMP	FROM CLANTON RD. TO PHYSICAL GORE REPAIR CONCRETE PAVEMENT AND ASPHALT SHOULDER. SEE (TYPICAL # 14)
# 11 I-77 SB OFF RAMP	FROM PHYSICAL GORE TO CLANTON RD. (SEE (TYPICAL # 16)
# 12 I-77 SB ON RAMP	FROM CLANTON ROAD TO PHYSICAL GORE SEE (TYPICAL # 16)

I-5825
I-77 PAVEMENT PRESERVATION

SCALE	-NA-		REVISIONS
DATE	9/17		2/13/18
DWG. BY	JHE		
DESIGN BY	JHE		
APPROVED			