

PROJECT REFERENCE NO.	SHEET NO.
R-2501 C	EC-36/CONST J7
RW SHEET NO.	
ROADWAY DESIGN ENGINEER	HYDRAULICS ENGINEER

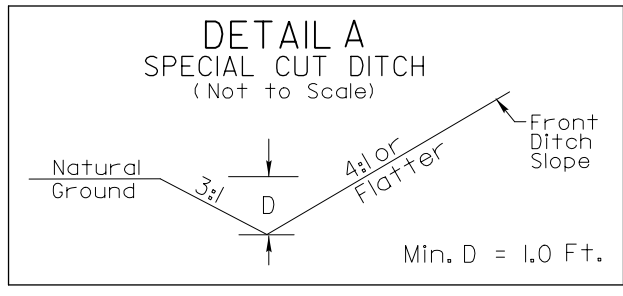

-L- STA. 1314+50 TO 1317+50 LT

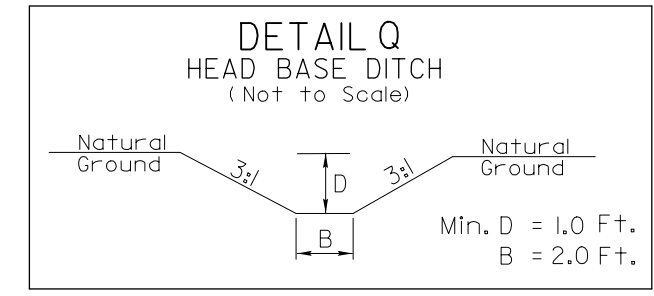

-L- STA. 1315+98 (107' LT) TO 1315+89 (68' LT)

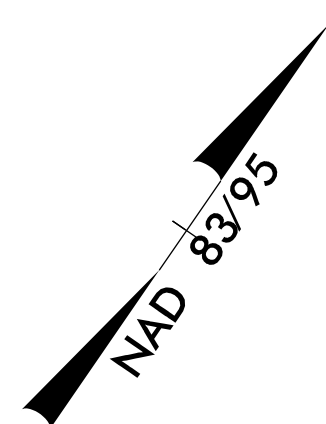

MATCHLINE -L- STA 1307+50.00 SEE SHEET No. 16

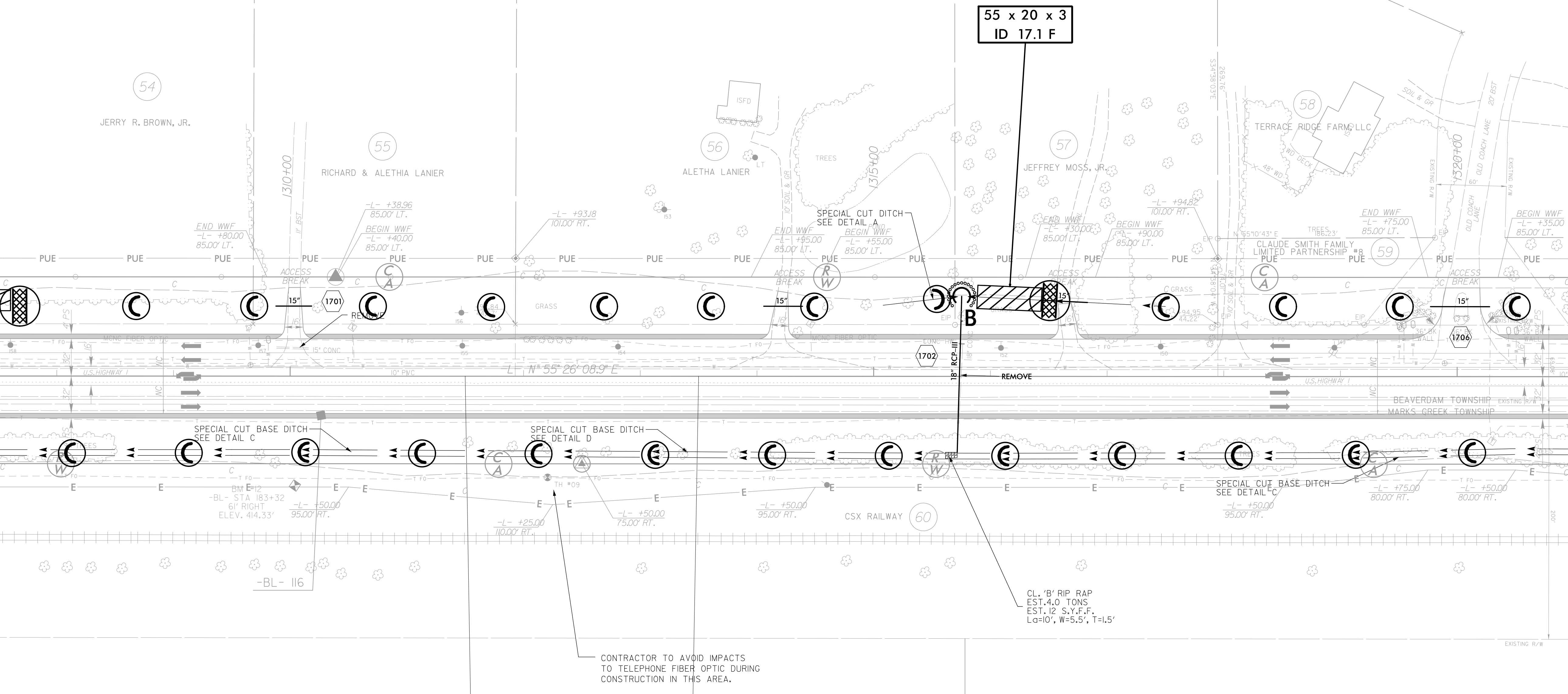

MATCHLINE -L- STA 1321+00.00 SEE SHEET No. 18

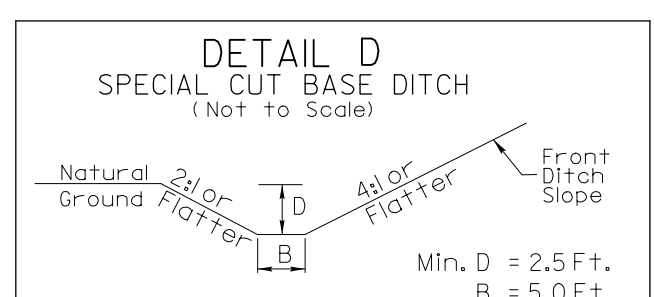

-L- STA. 1311+50 RT TO 1313+50 RT

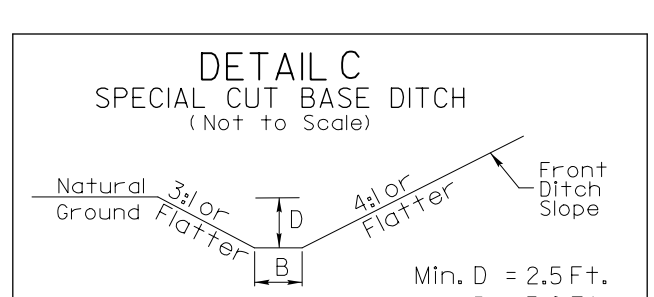

-L- STA. 1301+00 RT TO 1311+50 RT
-L- STA. 1313+50 RT TO 1325+29 RT

NOTE: FROM 1319+00 TO 1320+75 THE 2.5' MINIMUM DITCH DEPTH REQUIREMENT CANNOT BE ATTAINED THEREFORE THE PROPOSED DITCH GRADES ON THE PROFILE SHOULD BE MAINTAINED. ANY DITCH OVERFLOW WILL HAVE NO ADVERSE IMPACT TO THE ROADWAY OR THE RAILROAD PROPERTY.

For Slopes Excavated Greater Than 10 feet
Install Matting for Erosion Control on
Entire Slope as Work Allows.

N C WILDLIFE RESOURCES COMMISSION

AMERICAN TIMBERLAND ILLC