

PROJECT REFERENCE NO.	SHEET NO.
R-2501 C	EC-18/CONST.JT
RW SHEET NO.	
ROADWAY DESIGN ENGINEER	HYDRAULICS ENGINEER

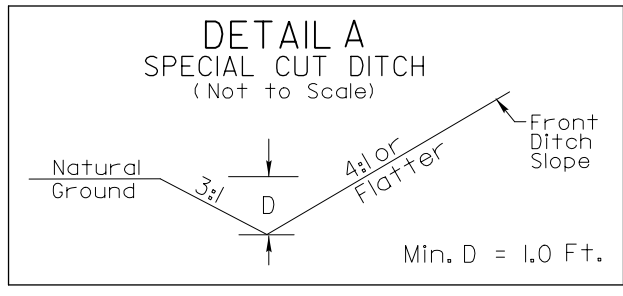

-L- STA. 1314+50 TO 1317+50 LT

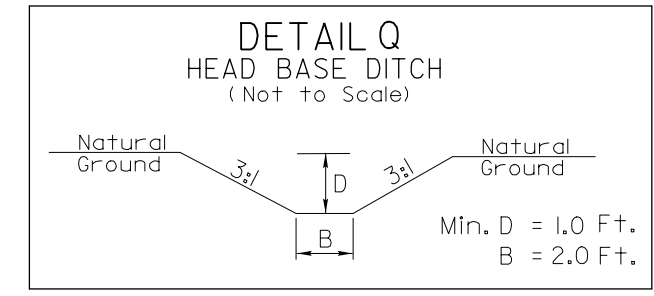

-L- STA. 1315+98 (107' LT) TO 1315+89 (68' LT)

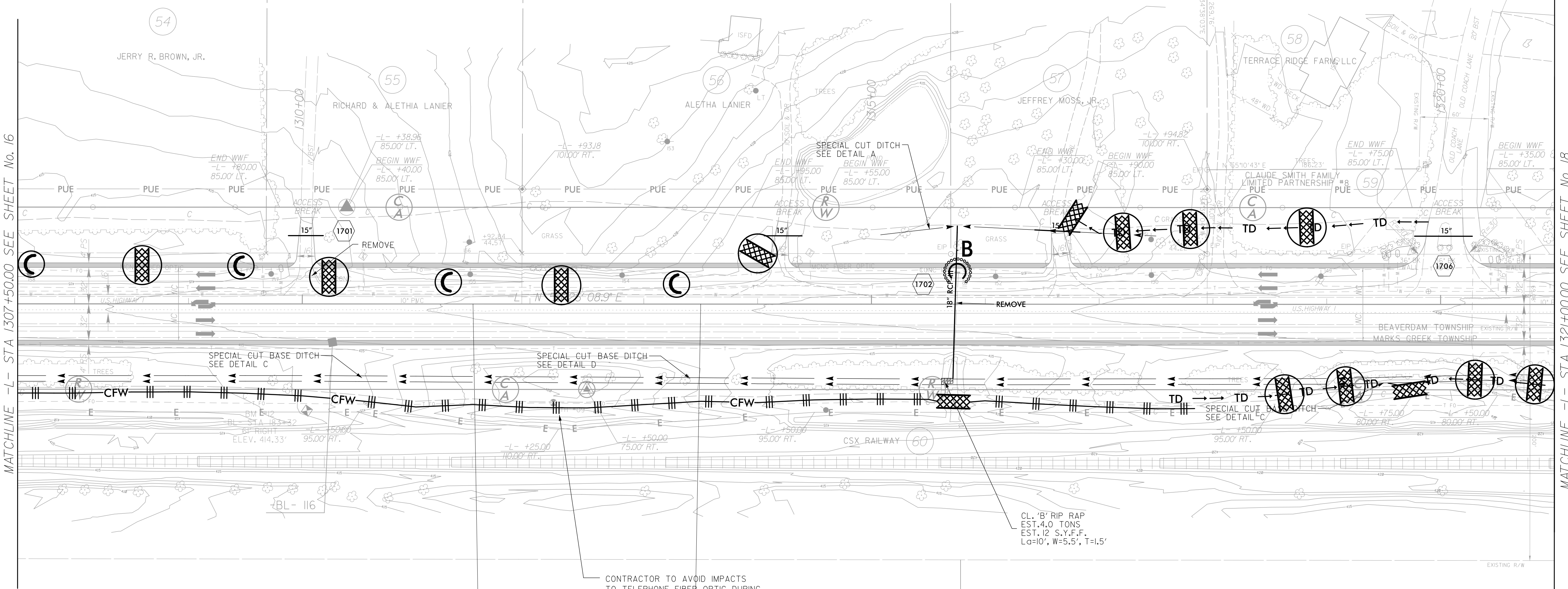
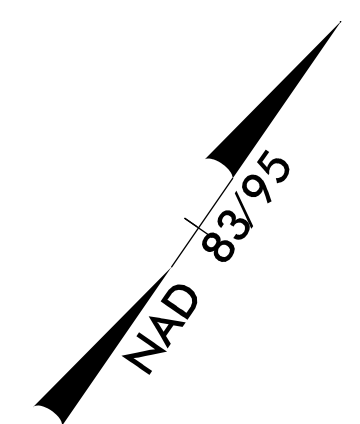

MATCHLINE -L- STA 1307+50.00 SEE SHEET No. 16

MATCHLINE -L- STA 1321+00.00 SEE SHEET No. 18

CONTRACTOR TO AVOID IMPACTS TO TELEPHONE FIBER OPTIC DURING CONSTRUCTION IN THIS AREA.

N C WILDLIFE RESOURCES COMMISSION

AMERICAN TIMBERLAND ILLC

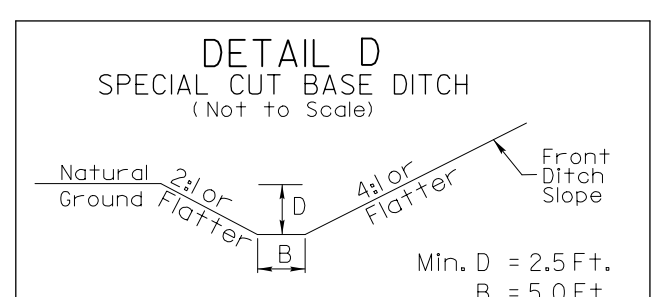

-L- STA. 1311+50 RT TO 1313+50 RT

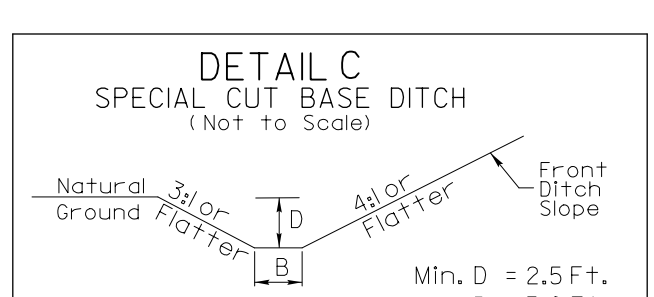

-L- STA. 1301+00 RT TO 1311+50 RT
-L- STA. 1313+50 RT TO 1325+29 RT

NOTE: FROM 1319+00 TO 1320+75 THE 2.5' MINIMUM DITCH DEPTH REQUIREMENT CANNOT BE ATTAINED THEREFORE THE PROPOSED DITCH GRADES ON THE PROFILE SHOULD BE MAINTAINED. ANY DITCH OVERFLOW WILL HAVE NO ADVERSE IMPACT TO THE ROADWAY OR THE RAILROAD PROPERTY.

CLEARING AND GRUBBING EROSION CONTROL FOR CONSTRUCTION SHEET 17

NOTE: PLACE TEMPORARY ROCK SEDIMENT DAMS TYPE - B AND TEMPORARY ROCK SILT CHECKS TYPE - A AT DRAINAGE OUTLETS.