

# PROJECT TYPICAL DETAILS

**CH ENGINEERING**  
 3220 GLEN ROYAL RD. RALEIGH, NC 27617  
 TELE 919.788.0224 FAX 919.788.0232  
 NC LICENSE #P-0189

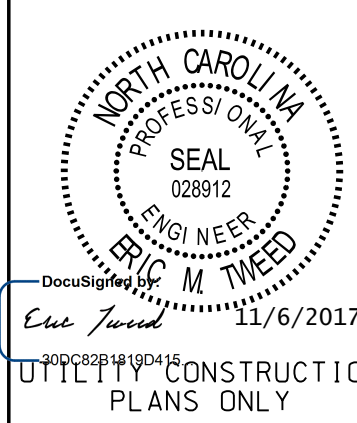

## UTILITY CONSTRUCTION

**DOCUMENT NOT CONSIDERED FINAL  
 UNTIL ALL SIGNATURES ARE COMPLETED**

-- FH NOTE: FH SHALL BE PROVIDED WITH STORZ CONNECTION--

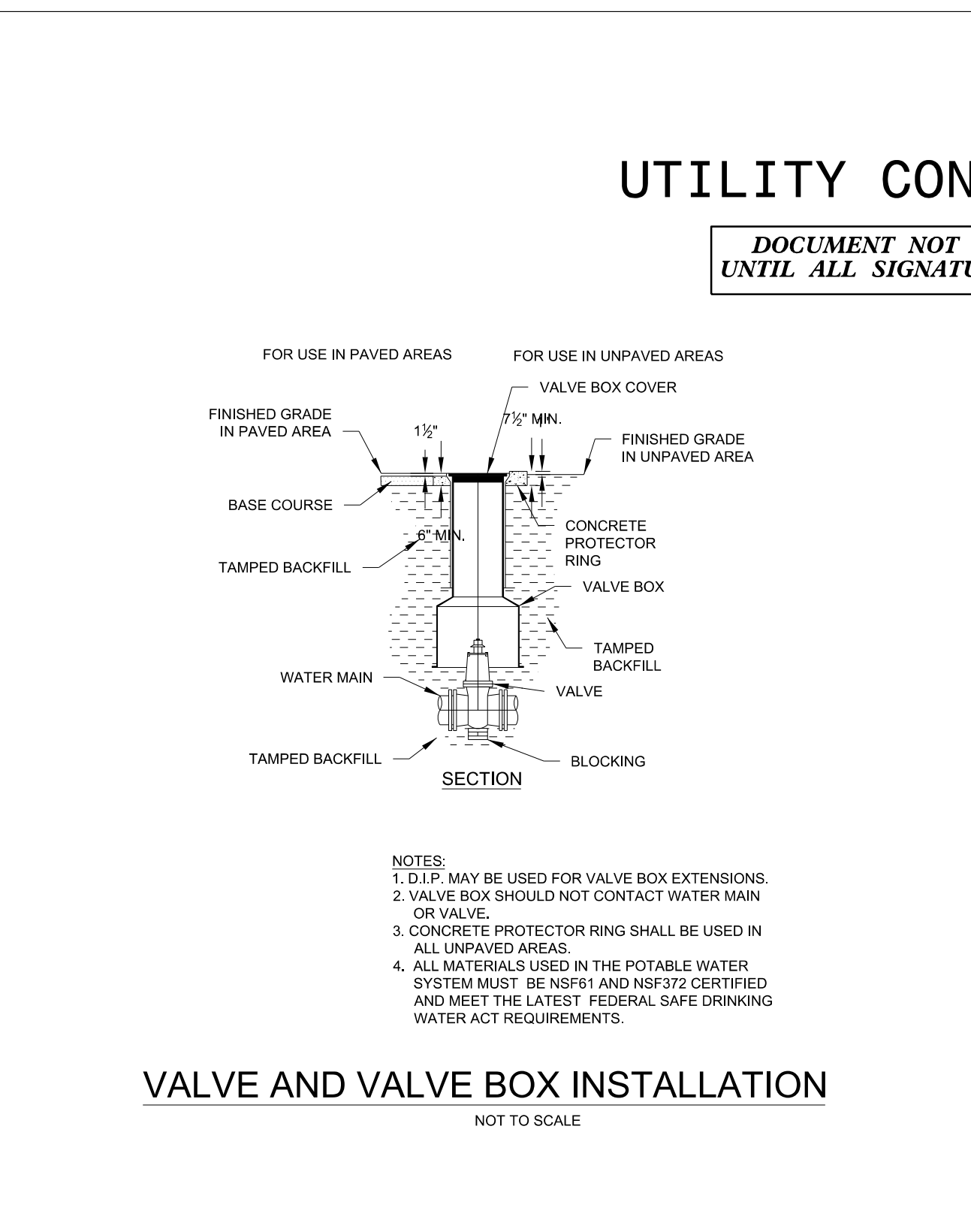
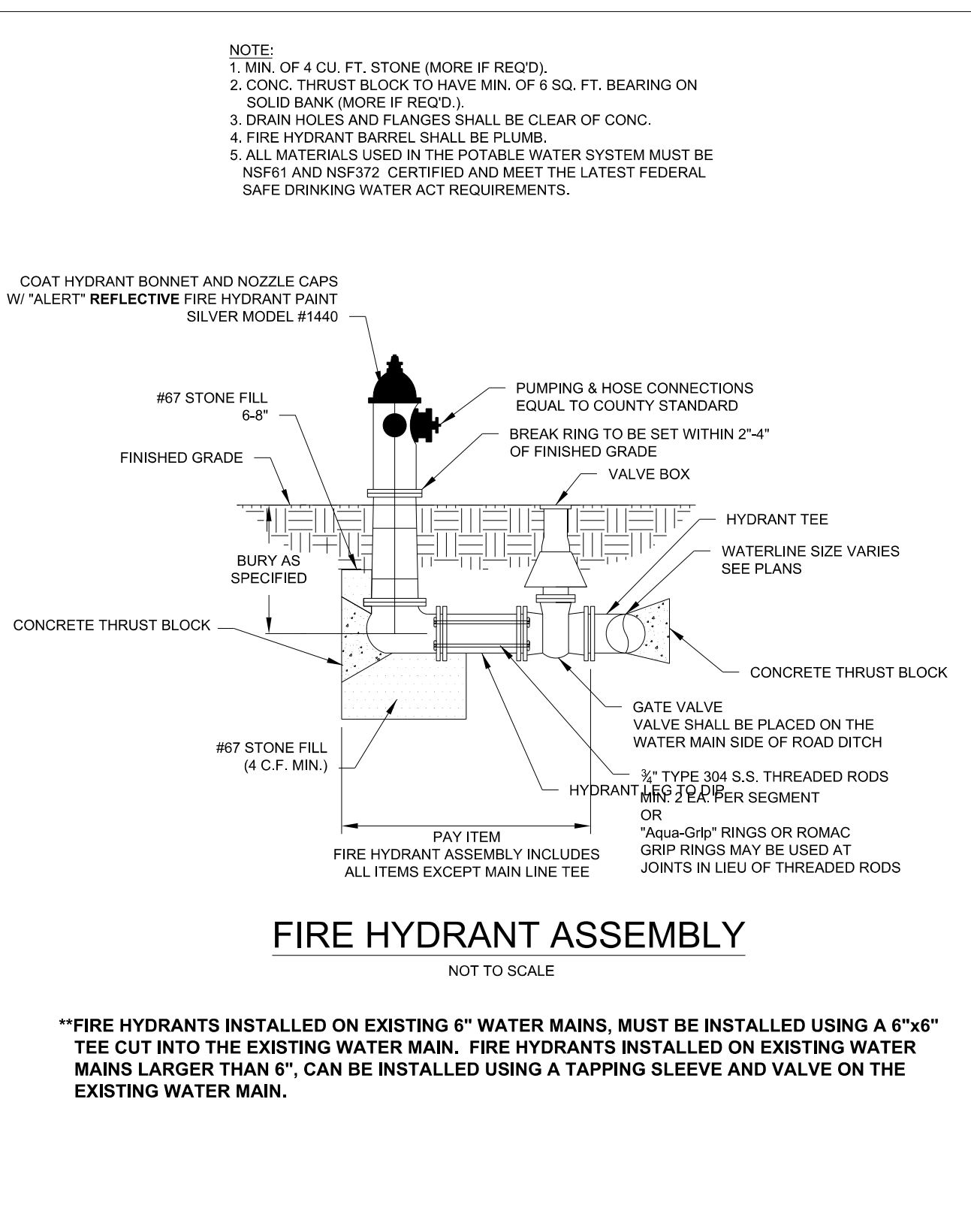
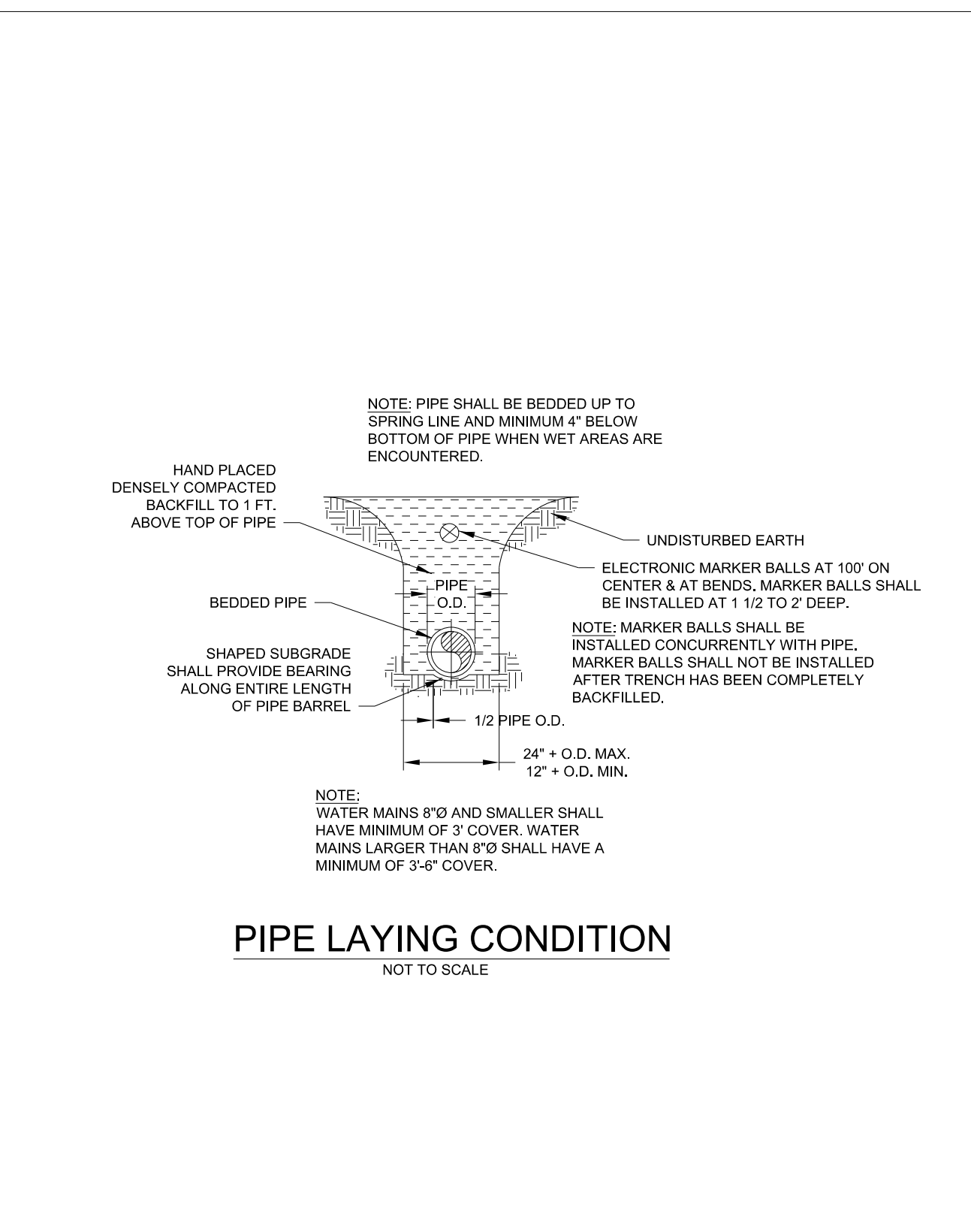
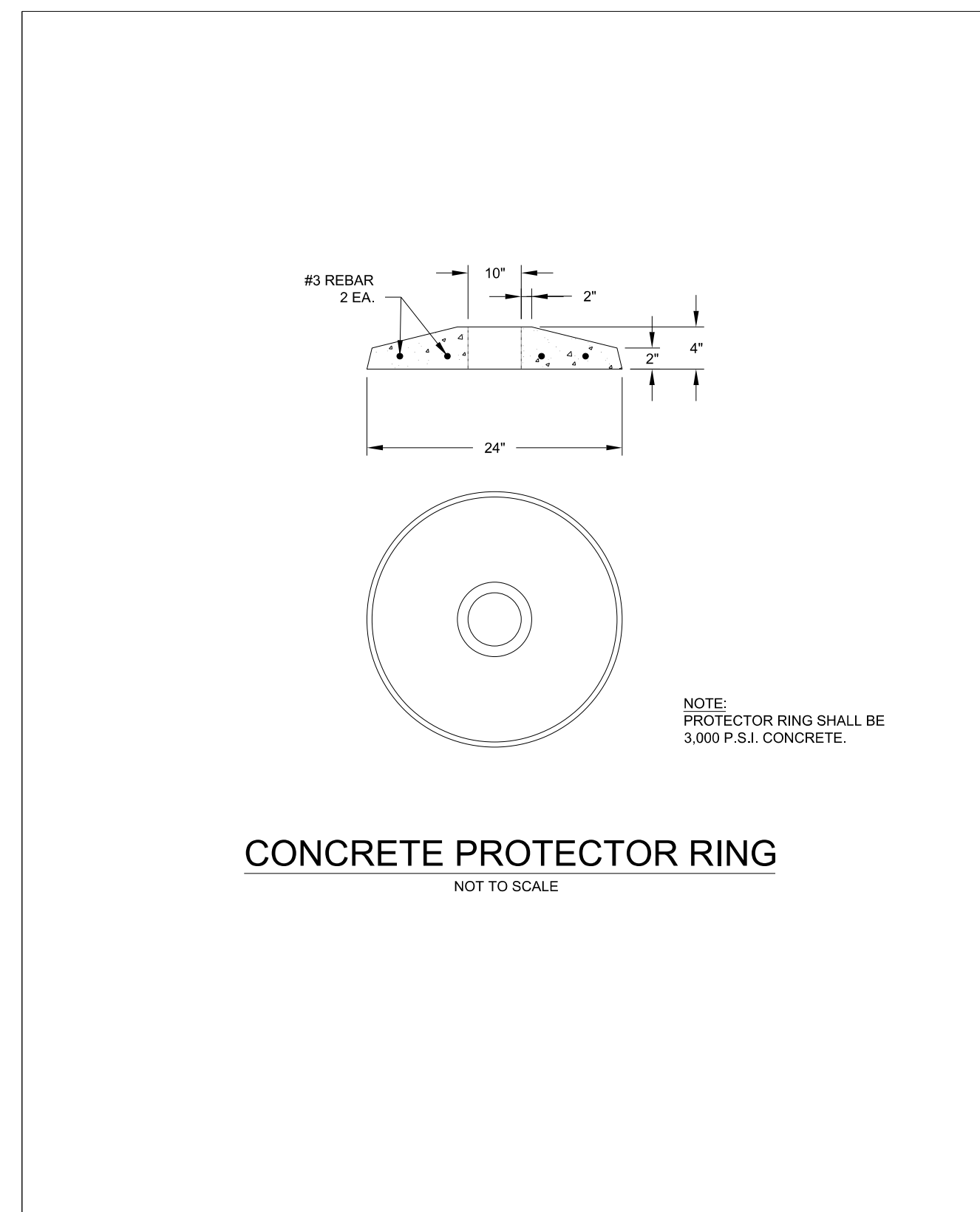

Drawn By:	Name	Date	
Checked By:			
Approved By:			
Scale:			
Rev.	Description	Date	Init.

**JOHNSTON COUNTY**  
 Department of Public Utilities  
 P.O. Box 2263  
 Smithfield, NC 27577

**WATER STANDARD DETAIL**  
**Concrete Protector Ring**

PAGE **14**

Drawn By:	Name	Date	
Checked By:			
Approved By:			
Scale:			
Rev.	Description	Date	Init.

**JOHNSTON COUNTY**  
 Department of Public Utilities  
 P.O. Box 2263  
 Smithfield, NC 27577

**WATER STANDARD DETAIL**  
**Pipe Laying Condition**

PAGE **17**

Drawn By:	Name	Date	
Checked By:			
Approved By:			
Scale:			
Rev.	Description	Date	Init.

**JOHNSTON COUNTY**  
 Department of Public Utilities  
 P.O. Box 2263  
 Smithfield, NC 27577

**WATER STANDARD DETAIL**  
**Fire Hydrant Assembly**

PAGE **4**

Drawn By:	Name	Date	
Checked By:			
Approved By:			
Scale:			
Rev.	Description	Date	Init.

**JOHNSTON COUNTY**  
 Department of Public Utilities  
 P.O. Box 2263  
 Smithfield, NC 27577

**WATER STANDARD DETAIL**  
**Valve and Valve Box Installation**

PAGE **13**

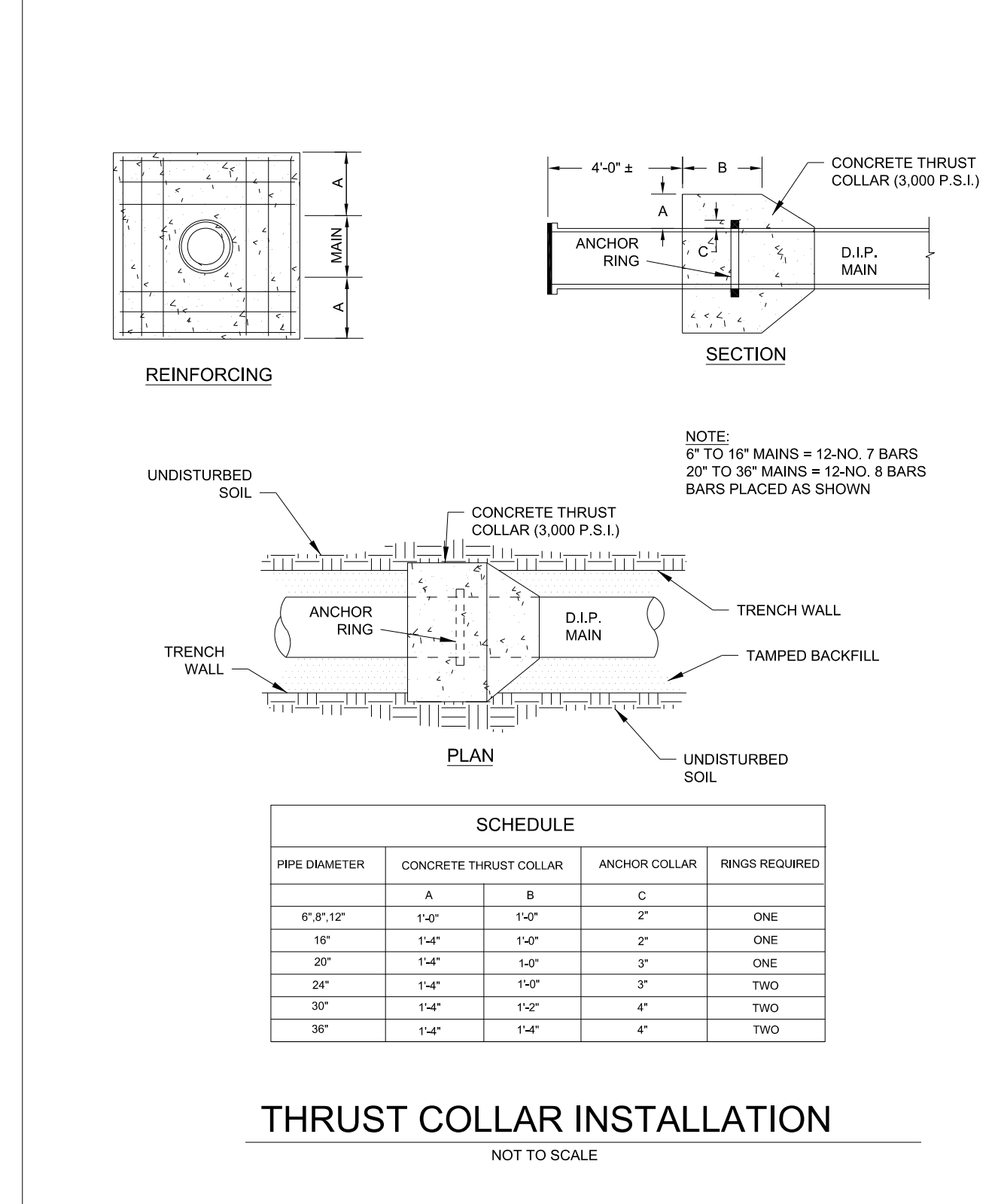

Drawn By:	Name	Date	
Checked By:			
Approved By:			
Scale:			
Rev.	Description	Date	Init.

**JOHNSTON COUNTY**  
 Department of Public Utilities  
 P.O. Box 2263  
 Smithfield, NC 27577

**WATER STANDARD DETAIL**  
**Thrust Collar Installation**

PAGE **9**

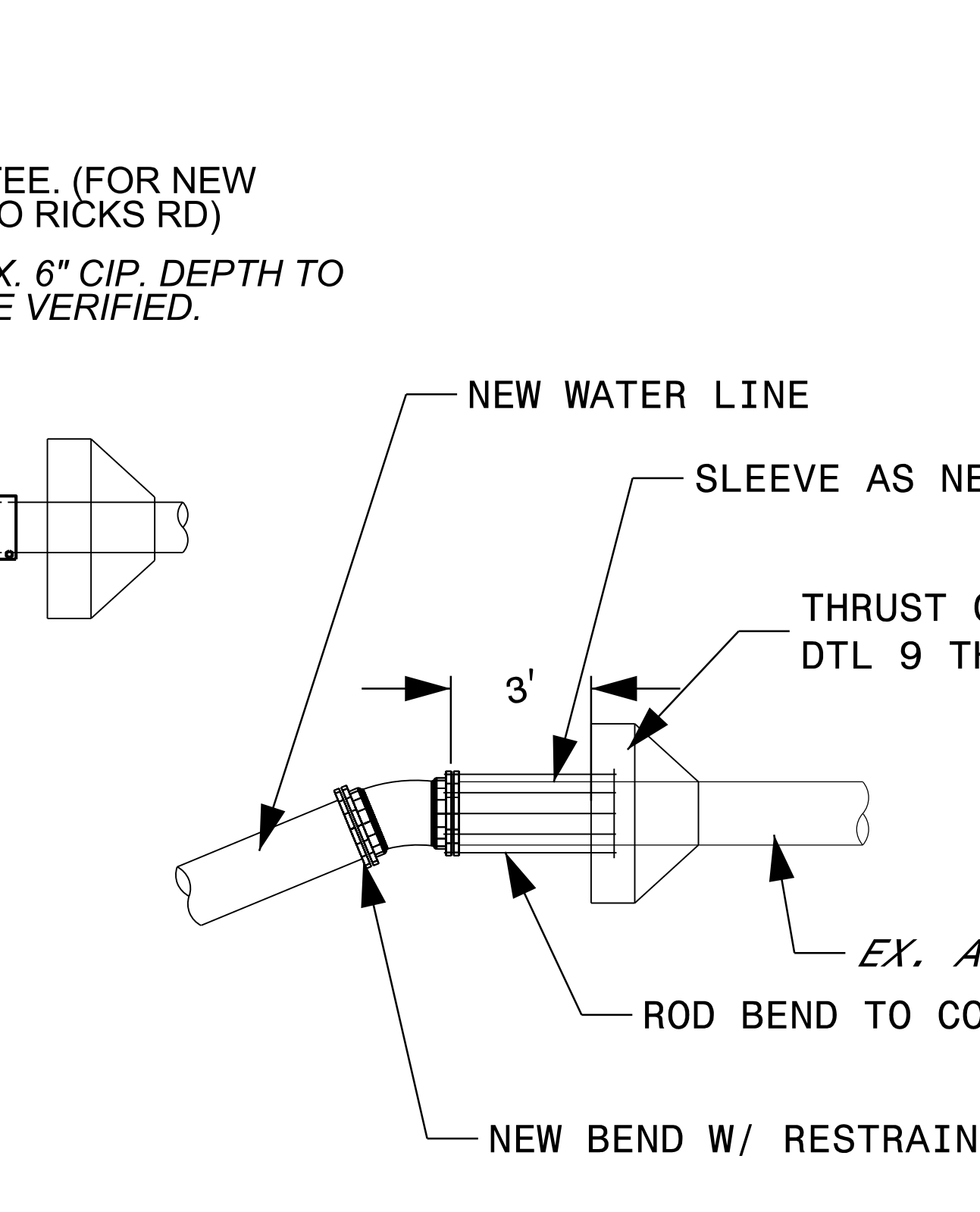
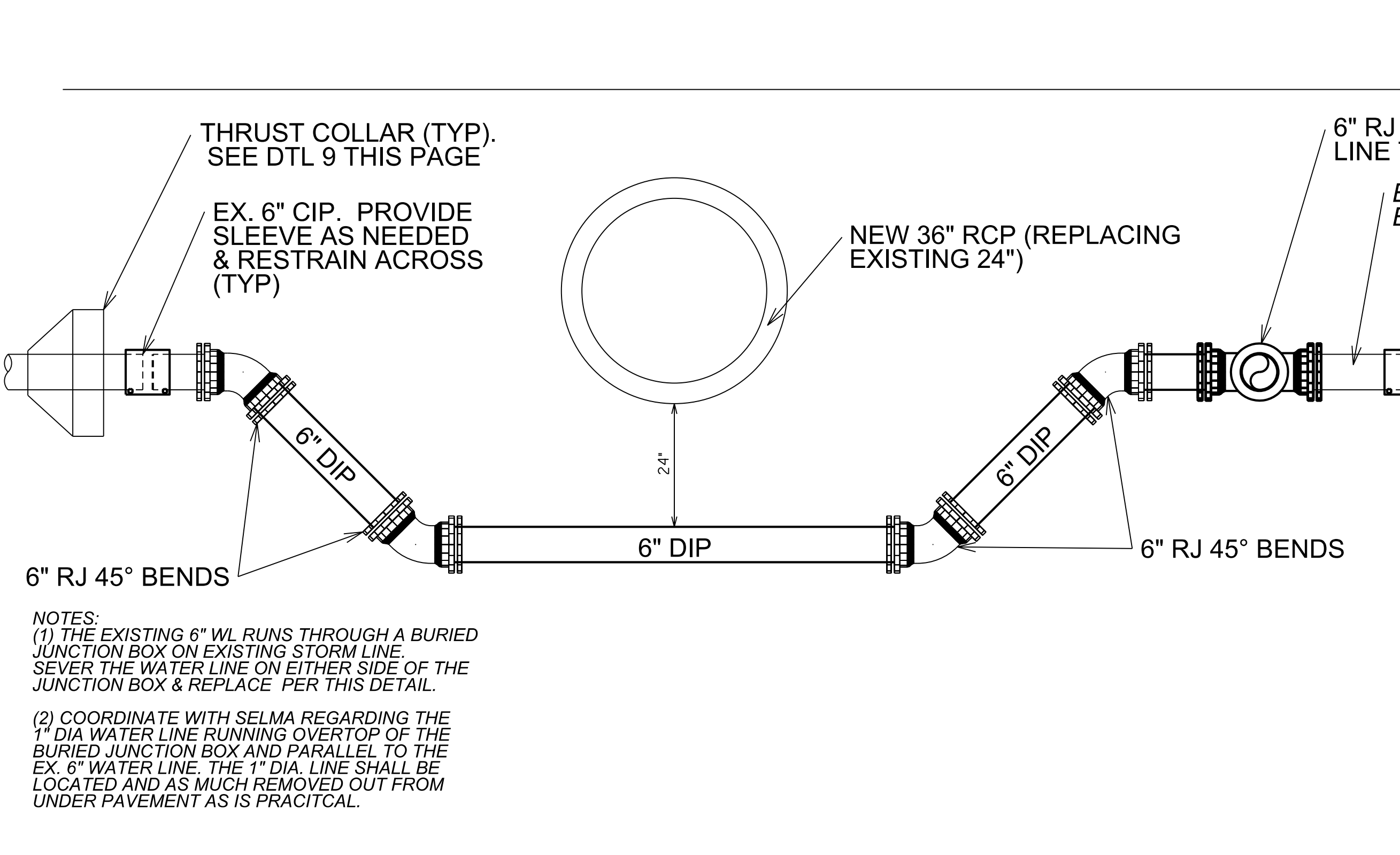

5/14/199  
 11/6/2017  
 I:\projects\Engineering\UC\ProJ\U5795-ut.dtl\UC03.psh.dgn