

PHASING DIAGRAM

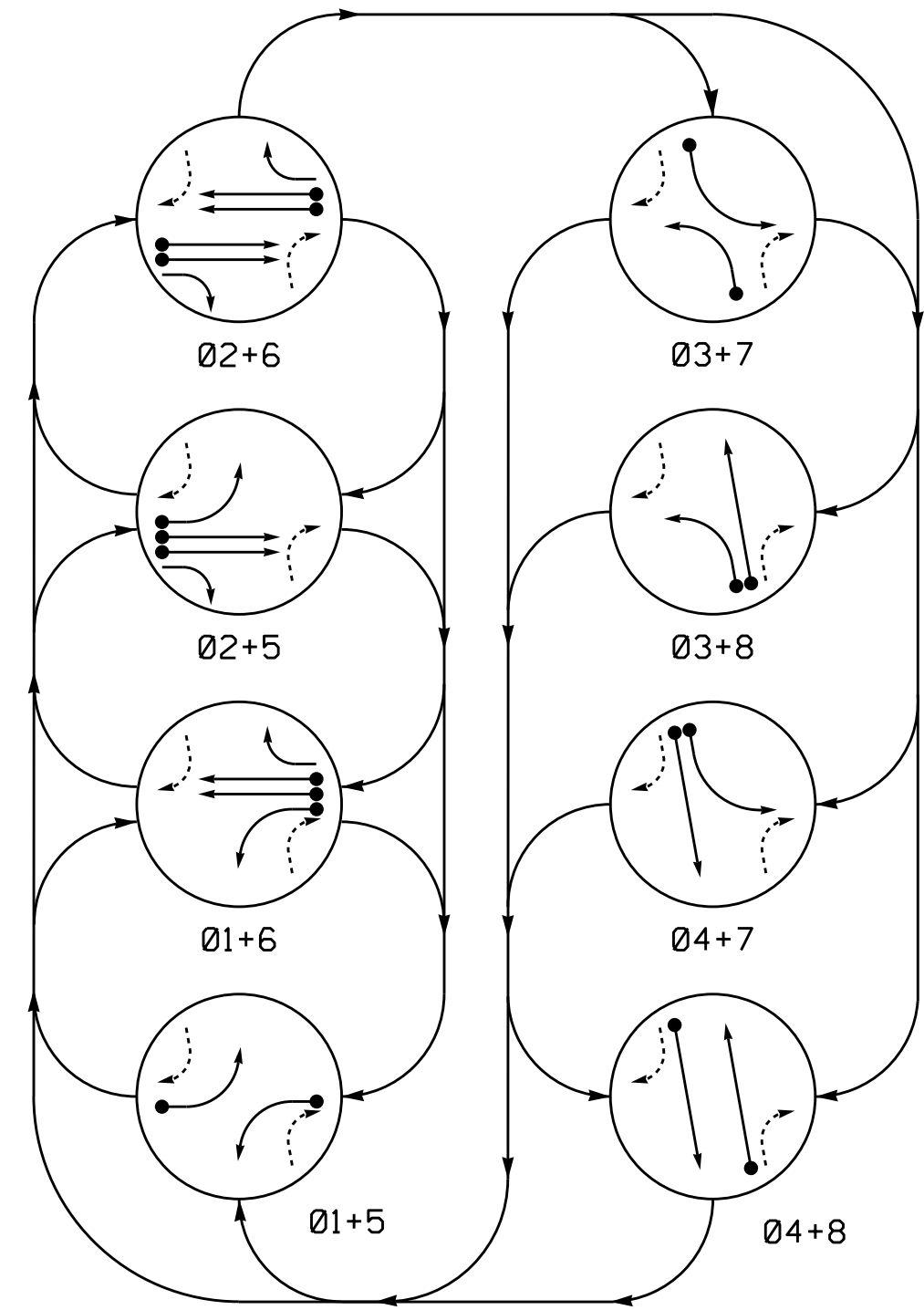

PHASING DIAGRAM DETECTION LEGEND

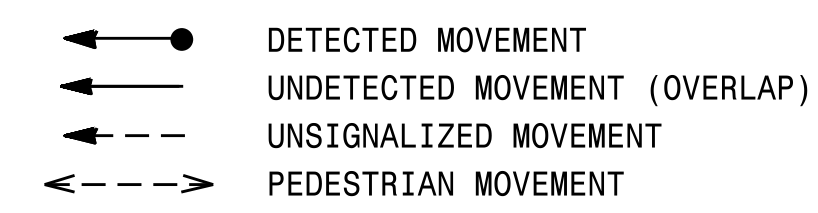

SIGNAL FACE I.D.

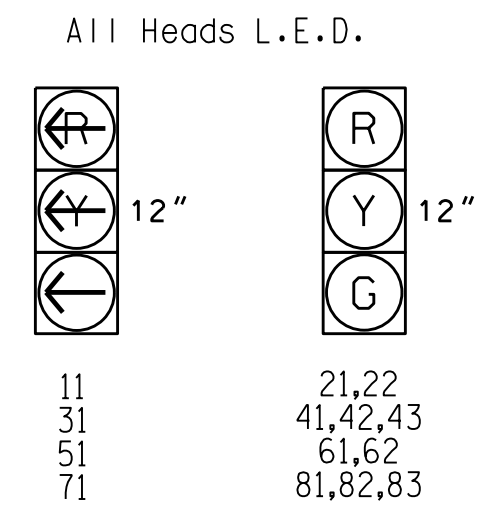

TABLE OF OPERATION

SIGNAL FACE	PHASE								FLASH
	Ø 1+5	Ø 1+6	Ø 2+5	Ø 2+6	Ø 3+7	Ø 3+8	Ø 4+7	Ø 4+8	
11	-	-	-R	-R	-R	-R	-R	-R	-
21,22	R	R	G	G	R	R	R	R	Y
31	-R	-R	-R	-R	-	-	-R	-R	-
41,42,43	R	R	R	R	R	R	G	G	R
51	-R	-R	-R	-R	-R	-R	-R	-R	-
61,62	R	G	R	G	R	R	R	R	Y
71	-R	-R	-R	-R	-R	-R	-R	-R	-
81,82,83	R	R	R	R	R	G	R	G	R

OASIS 2070 LOOP & DETECTOR INSTALLATION CHART

LOOP	SIZE (FT)	DISTANCE FROM STOPBAR (FT)	TURNS	NEW LOOP	DETECTOR PROGRAMMING				STRETCH TIME	DELAY TIME	SYSTEM LOOP	NEW CARD
					PHASE	CALLING	EXTENSION	FULL TIME DELAY				
1A	6X60	0	*	*	1	Y	Y	-	-	3	-	-
2A	6X6	300	*	*	2	Y	Y	-	-	-	-	-
2B	6X6	300	*	*	2	Y	Y	-	-	-	-	-
2C	6X60	0	*	*	2	Y	Y	Y	2.0	5	-	-
2D	6X60	0	*	*	2	Y	Y	Y	2.0	5	-	-
3A	6X40	0	2-4-2	-	3	Y	Y	-	-	-	-	-
4A	6X60	0	*	*	4	Y	Y	-	-	-	-	-
5A	6X60	0	*	*	5	Y	Y	-	-	3	-	-
6A	6X6	300	*	*	6	Y	Y	-	-	-	-	-
6B	6X6	300	*	*	6	Y	Y	-	-	-	-	-
6C	6X60	0	*	*	6	Y	Y	Y	2.0	5	-	-
6D	6X60	0	*	*	6	Y	Y	Y	2.0	5	-	-
7A	6X60	0	*	*	7	Y	Y	-	-	-	-	-
8A	6X40	0	2-4-2	-	8	Y	Y	-	-	-	-	-

\* Video Detection Zone

8 Phase Fully Actuated US 70 (Selma) CLS

NOTES

- Refer to "Roadway Standard Drawings NCDOT" dated January 2018 and "Standard Specifications for Roads and Structures" dated January 2018.
- Do not program signal for late night flashing operation unless otherwise directed by the Engineer.
- Phase 1 and/or phase 5 may be lagged.
- Phase 3 and/or phase 7 may be lagged.
- Set all detector units to presence mode.
- Locate new cabinet so as not to obstruct sight distance of vehicles turning right on red.
- Maximum times shown in timing chart are for free-run operation only. Coordinated signal system timing values supersede these values.
- Closed loop system data: Master Asset #, Controller Asset #0383.

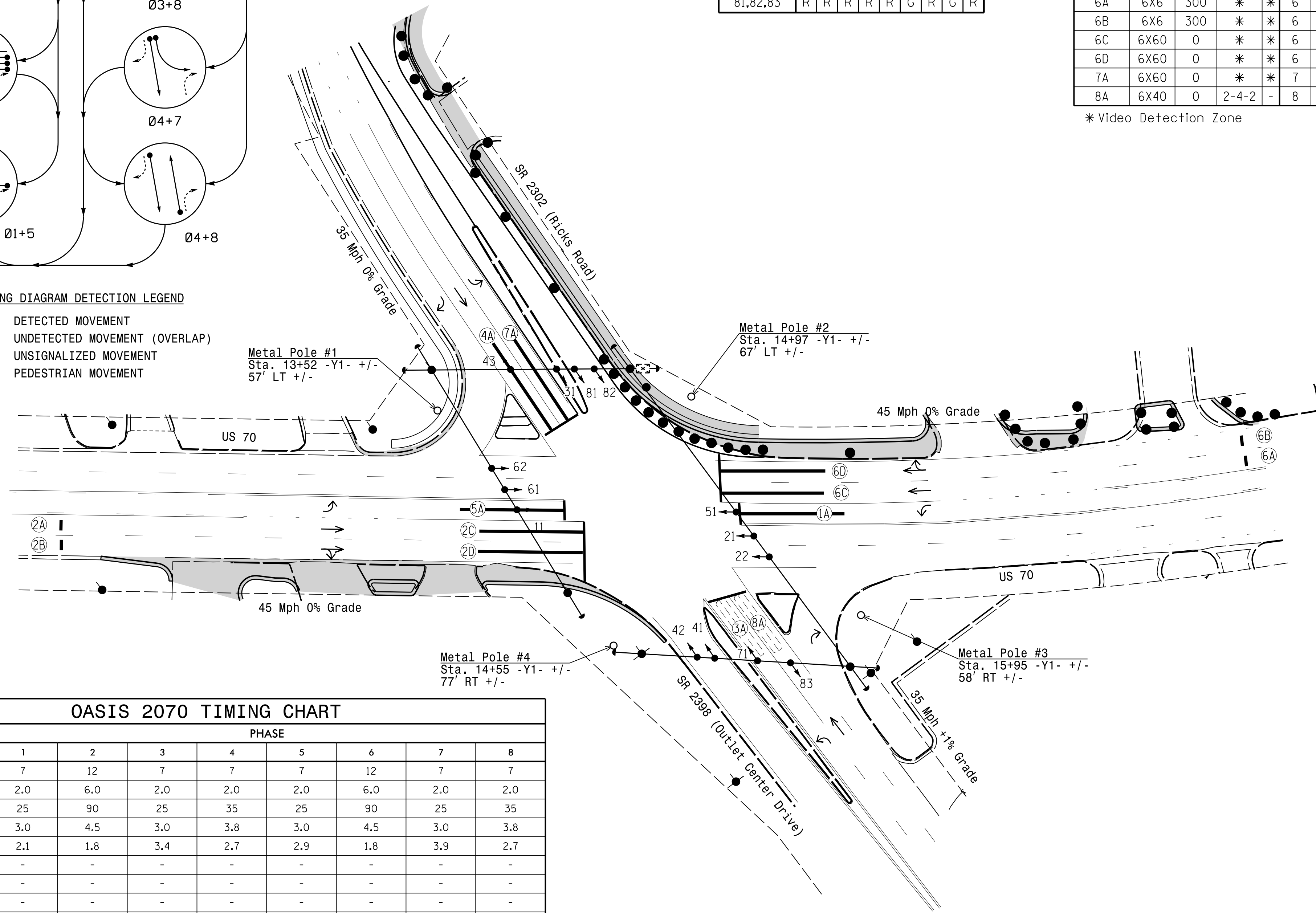

OASIS 2070 TIMING CHART

FEATURE	PHASE							
	1	2	3	4	5	6	7	8
Min Green 1 *	7	12	7	7	7	12	7	7
Extension 1 *	2.0	6.0	2.0	2.0	2.0	6.0	2.0	2.0
Max Green 1 *	25	90	25	35	25	90	25	35
Yellow Clearance	3.0	4.5	3.0	3.8	3.0	4.5	3.0	3.8
Red Clearance	2.1	1.8	3.4	2.7	2.9	1.8	3.9	2.7
Walk 1 *	-	-	-	-	-	-	-	-
Don't Walk 1	-	-	-	-	-	-	-	-
Seconds Per Actuation *	-	-	-	-	-	-	-	-
Max Variable Initial *	-	-	-	-	-	-	-	-
Time Before Reduction *	-	15	-	-	-	15	-	-
Time To Reduce *	-	45	-	-	-	45	-	-
Minimum Gap	-	3.0	-	-	-	3.0	-	-
Recall Mode	-	MIN RECALL	-	-	-	MIN RECALL	-	-
Vehicle Call Memory	-	YELLOW	-	-	-	YELLOW	-	-
Dual Entry	-	-	-	-	-	-	-	-
Simultaneous Gap	ON	ON	ON	ON	ON	ON	ON	ON

\* These values may be field adjusted. Do not adjust Min Green and Extension times for phases 2 and 6 lower than what is shown. Min Green for all other phases should not be lower than 4 seconds.

LEGEND

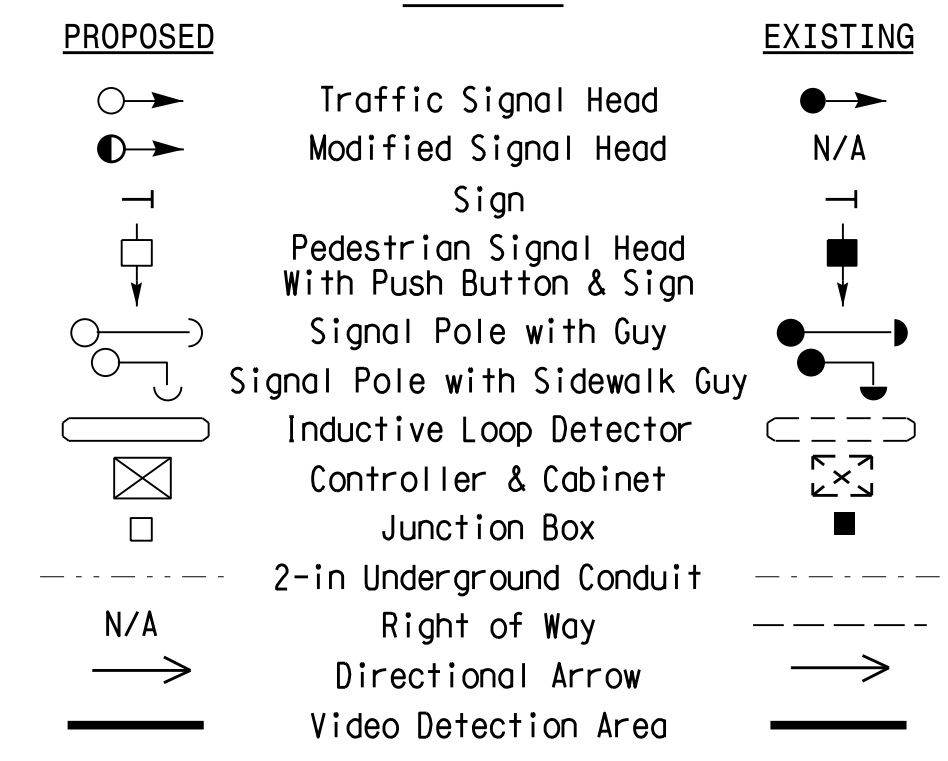

Signal Upgrade - TCP Phase II

Prepared in the Offices of:

750 N. Greenfield Pkwy, Garner, NC 27529

US 70  
at  
SR 2302 (Ricks Road)/  
SR 2398 (Outlet Center Drive)

Division 4 Johnston County Selma

PLAN DATE: August 2017 REVIEWED BY: JPG

PREPARED BY: JPG REVIEWED BY:

DOCUMENT NOT CONSIDERED FINAL UNLESS ALL SIGNATURES COMPLETED

SEAL

DATE: 9/13/2017

SIG. INVENTORY NO. 04-0383T2

REVISIONS	INIT.	DATE

13-SEP-2017 13:34 R:\Projects\040383T2\040383T2.dgn U:\Users\jgallaway\My Documents\040383T2.dgn