

SURVEY CONTROL SHEET U-5795

BL POINT	DESC.	NORTH	EAST	ELEVATION	L STATION	OFFSET
1	U5795-1	644270.4410	2210122.0390	168.68	OUTSIDE PROJECT LIMITS	
2	U5795-2	645102.4200	2210302.8420	175.12	OUTSIDE PROJECT LIMITS	
60	BL-1	645450.3127	2210229.6234	175.92	11+64.12	43.82 LT
61	BL-2	645781.3406	2210331.1008	172.95	14+98.92	23.21 LT
64	BL-3	646081.2457	2210526.1046	170.62	18+53.72	19.51 LT
65	BL-4	646336.6984	2210762.2883	171.31	21+97.35	34.92 RT
67	BL-5	646685.0383	2210929.5800	174.84	25+74.95	27.91 RT
68	BL-6	647075.2320	2210886.2619	172.62	29+60.64	25.39 LT
69	BL-7	647463.4369	2210932.9045	175.67	33+49.07	19.38 RT
70	BL-8	647762.6167	2210939.1047	174.07	36+48.27	24.13 RT
72	BL-9	648029.9772	2210933.0090	173.71	39+15.60	16.74 RT
3	U5795-3	648284.6520	2210954.8890	174.21	41+70.38	37.38 RT

BY1 POINT	DESC.	NORTH	EAST	ELEVATION	Y1 STATION	OFFSET
51	BY1-1	645507.3656	2210043.0235	176.48	11+58.55	41.05 LT
2	U5795-2	645102.4200	2210302.8420	175.12	16+06.56	123.20 RT
56	BY1-3	645066.6800	2210692.3490	177.76	19+55.00	36.93 LT

BY2 POINT	DESC.	NORTH	EAST	ELEVATION	Y2 STATION	OFFSET
60	BL-1	645450.3127	2210229.6234	175.92	11+64.12	43.82 LT
83	BY2-2	645635.6816	2210510.0425	173.17	12+13.18	21.22 LT
82	BY2-3	645592.0417	2210744.6160	173.74	14+48.30	19.38 RT

BY7 POINT	DESC.	NORTH	EAST	ELEVATION	Y7 STATION	OFFSET
77	BY7-1	648092.6395	2210490.8661	176.11	10+15.28	35.22 LT
3	U5795-3	648284.6520	2210954.8890	174.21	15+09.87	51.78 RT
4	U5795-4	648741.4200	2211480.9080	174.23	OUTSIDE PROJECT LIMITS	

TBM#1 ELEVATION = 177.06
 N 645588 E 2210331
 L STATION 13+14.00 40 RIGHT
 TOP OF BONNET BOLT WITH "X" MARK
 ON FIRE HYDRANT

TBM#3 ELEVATION = 176.89
 N 647724 E 2210939
 L STATION 36+09.00 24 RIGHT
 TOP OF BONNET BOLT WITH "X" MARK
 ON FIRE HYDRANT

TBM#2 ELEVATION = 171.48
 N 646260 E 2210706
 L STATION 21+03.00 31 RIGHT
 TOP OF BONNET BOLT WITH "X" MARK
 ON FIRE HYDRANT

TBM#4 ELEVATION = 177.08
 N 648502 E 2210848
 TOP OF BONNET BOLT WITH "X" MARK
 ON FIRE HYDRANT (DO NOT USE DAMAGED)
 OUT OF LIMITS

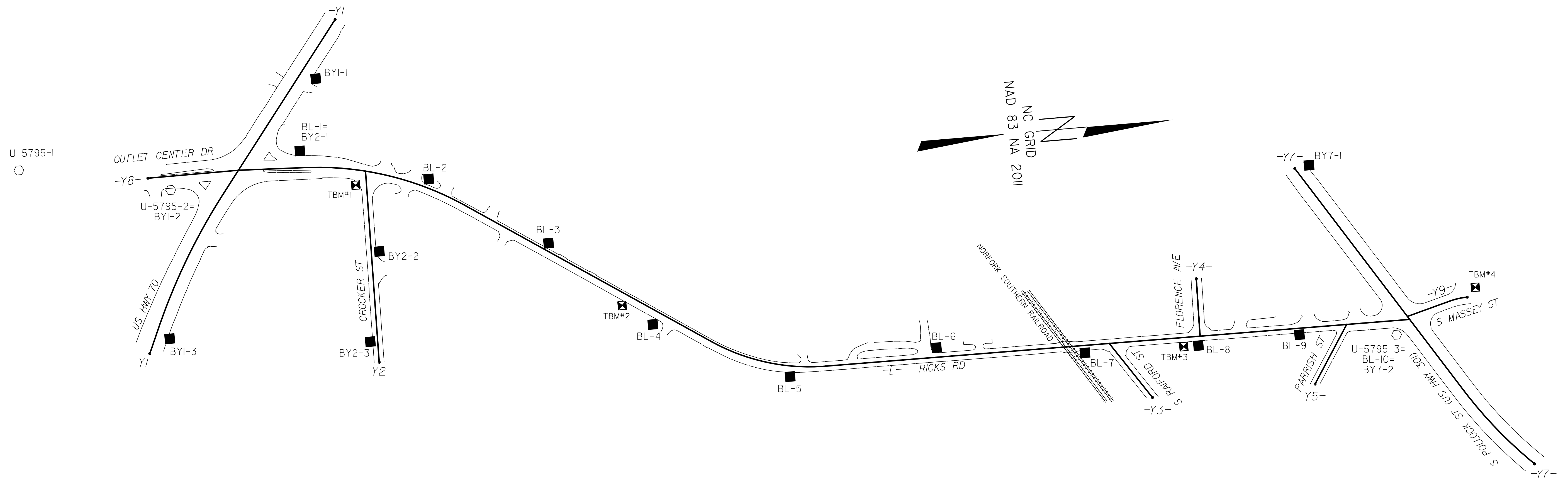

U-5795-1
 N. 648741.4200
 E. 2211480.9080
 ELEV. 174.2295'

DATUM DESCRIPTION

THE LOCALIZED COORDINATE SYSTEM DEVELOPED FOR THIS PROJECT IS BASED ON THE STATE PLANE COORDINATES ESTABLISHED BY NCDOT FOR MONUMENT "U5795GPS2"

WITH NAD 83/NA 2011 STATE PLANE GRID COORDINATES OF
 NORTHING: 645102.420(ft) EASTING: 2210302.842(ft)
 ELEVATION: 175.115(ft)

THE AVERAGE COMBINED GRID FACTOR USED ON THIS PROJECT (GROUND TO GRID) IS: 0.999881005

THE N.C. LAMBERT GRID BEARING AND LOCALIZED HORIZONTAL GROUND DISTANCE FROM "U5795GPS2" TO -L- STATION 10+00 IS
 N11°26'04.68"W 185.66

ALL LINEAR DIMENSIONS ARE LOCALIZED HORIZONTAL DISTANCES
 VERTICAL DATUM USED IS NAVD 88

NOTES:

1. THE CONTROL DATA FOR THIS PROJECT CAN BE FOUND ELECTRONICALLY BY SELECTING PROJECT CONTROL DATA AT:
[HTTPS://CONNECT.NCDOT.GOV/RESOURCES/LOCATION/](https://connect.ncdot.gov/resources/location/)

THE FILES TO BE FOUND ARE AS FOLLOWS:
 U5795_LS_CONTROL.TXT

SITE CALIBRATION INFORMATION HAS NOT BEEN PROVIDED FOR THIS PROJECT. IF FURTHER INFORMATION IS NEEDED, PLEASE CONTACT THE LOCATION AND SURVEYS UNIT.

○ INDICATES GEODETIC CONTROL MONUMENTS USED OR SET FOR HORIZONTAL PROJECT CONTROL BY THE NCDOT LOCATION AND SURVEYS UNIT.
 PROJECT CONTROL ESTABLISHED USING GLOBAL POSITIONING SYSTEM.

NOTE: DRAWING NOT TO SCALE

6/27/99 9/5/2017 165961s_1C-1.dgn localiser