

**This electronic collection of documents is provided
for the convenience of the user
and is Not a Certified Document –**

**The documents contained herein were originally issued
and sealed by the individuals whose names and license
numbers appear on each page, on the dates appearing
with their signature on that page.**

**This file or an individual page
shall not be considered a certified document.**

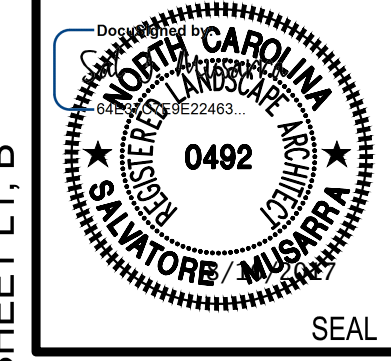

NO.	DATE	REVISIONS

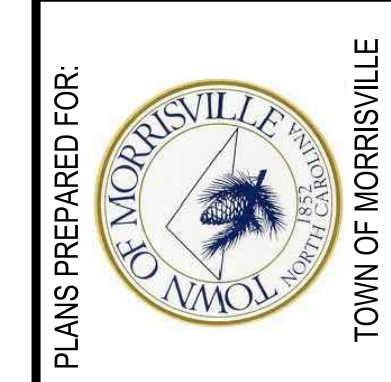

PROJECT:
U-5828
SR-3127 (MCCRIMMON PKWY)
MORRISVILLE, NC

TITLE:
LANDSCAPE PLAN

KHA PROJECT:
012108004-PHASE 2
DATE:
08-15-2017

100% PLANS

L1

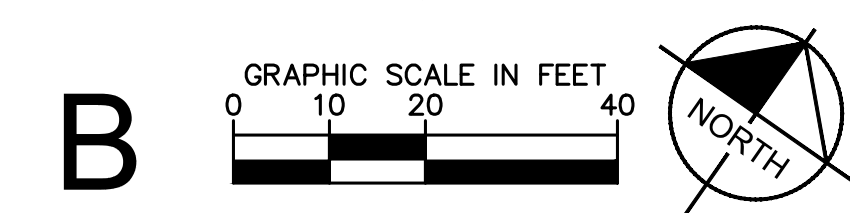
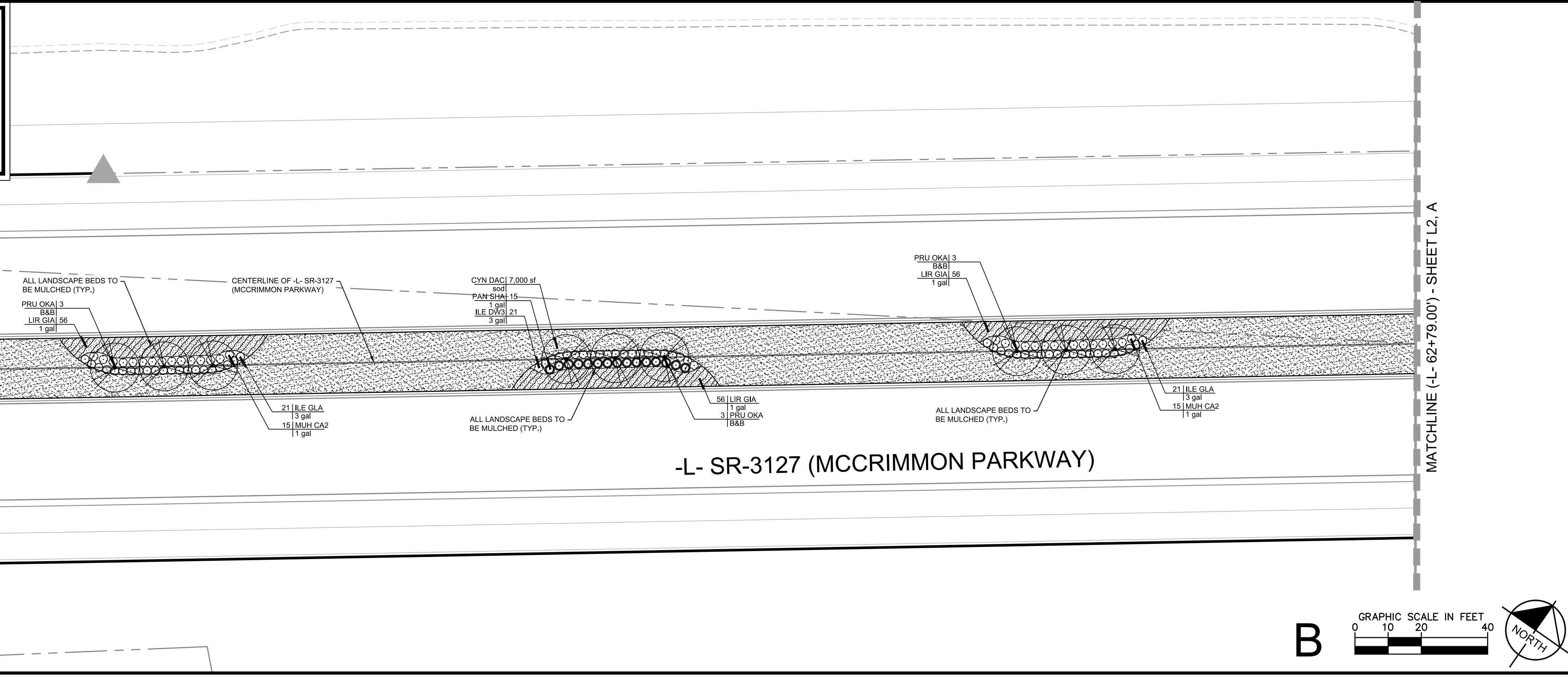
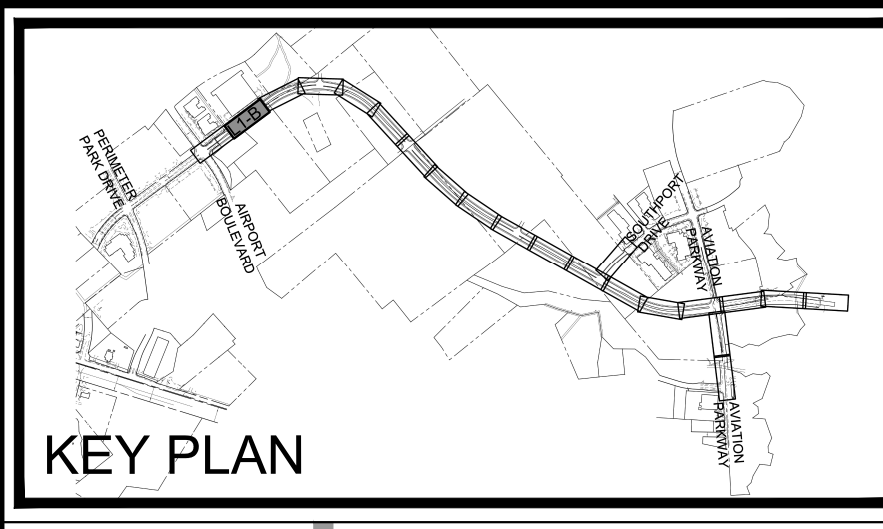
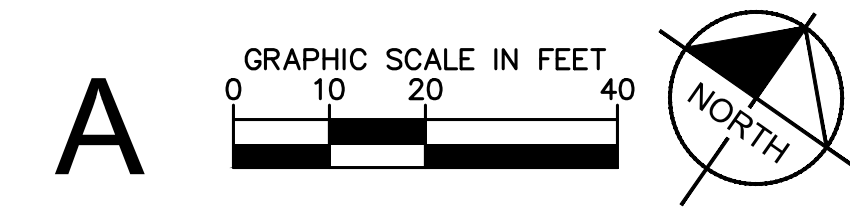
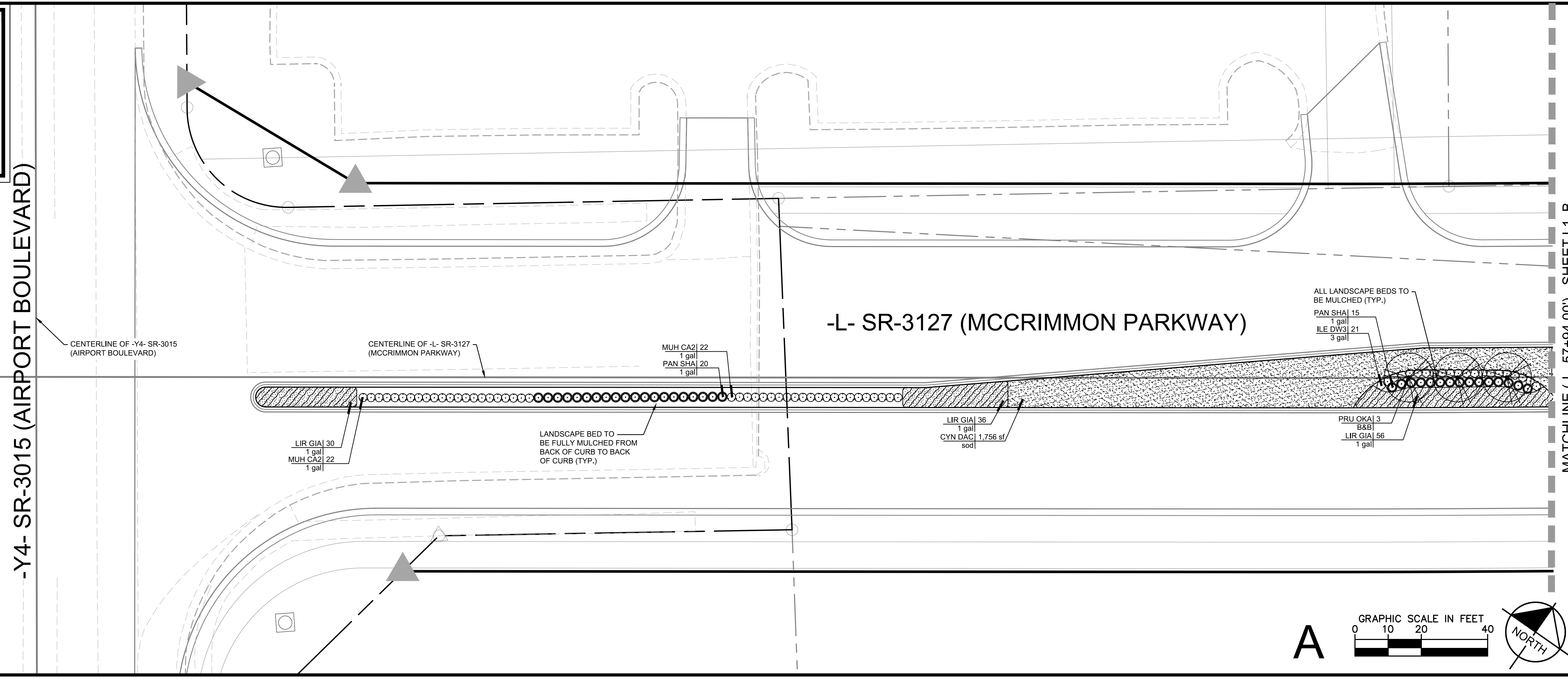
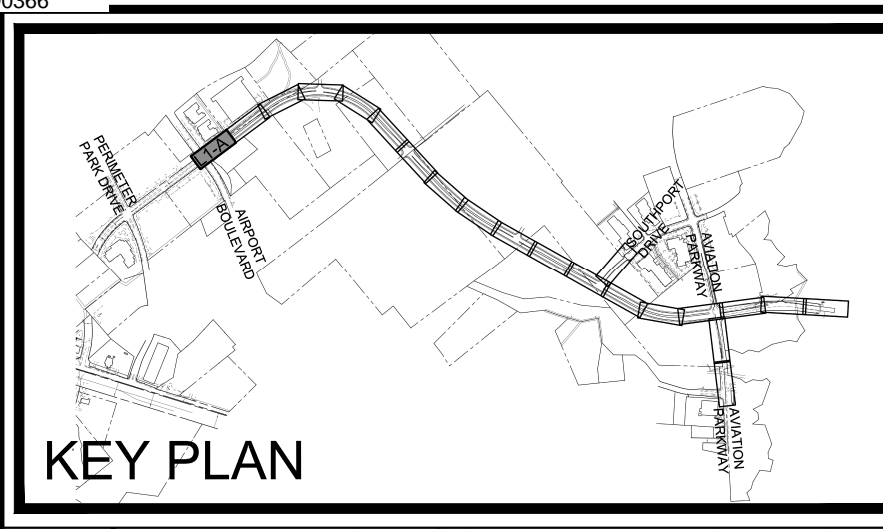

K:\RDT_LDEV\012108004_McCrImmon Prkwy_mdt_west\Planning Phase\PI5_CAD Files\Plans\Sheets 08/15/2017

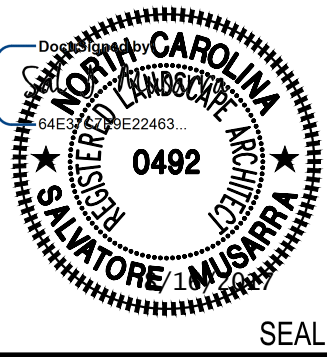

NO.	DATE	REVISIONS



PLANS PREPARED FOR:

 PROJECT:
 U-5828
 SR-3127 (MCCRIMMON PKWY)
 MORRISVILLE, NC

TITLE:
 LANDSCAPE PLAN

KHA PROJECT:
 012108004-PHASE 2
 DATE:
 08-15-2017

100% PLANS

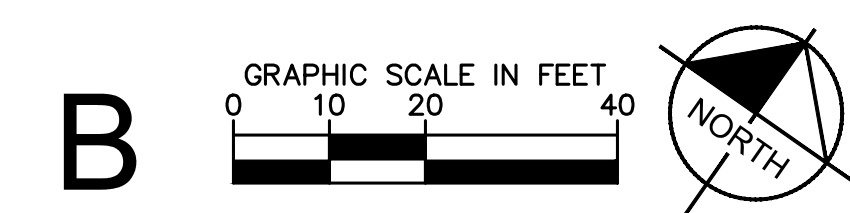
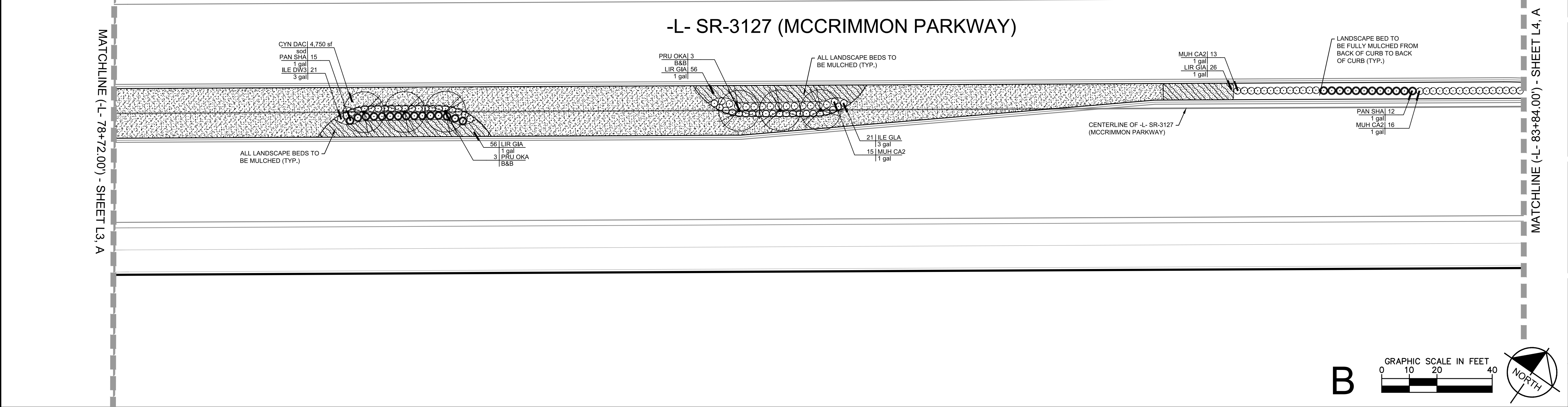
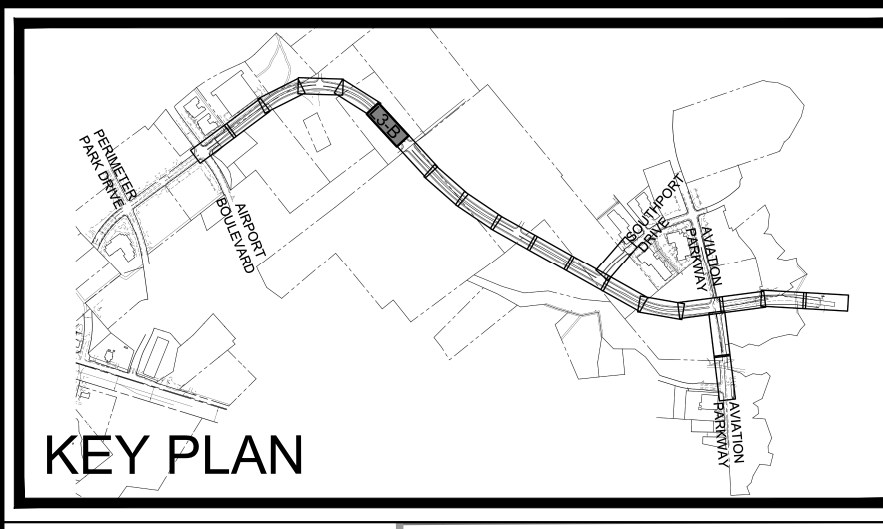
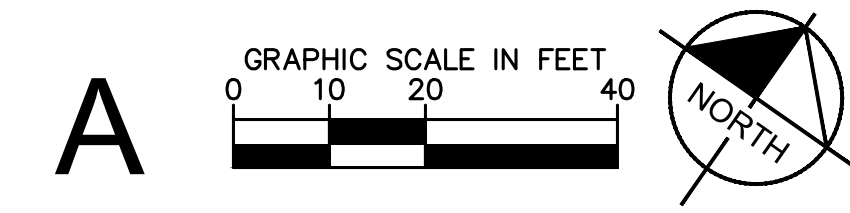
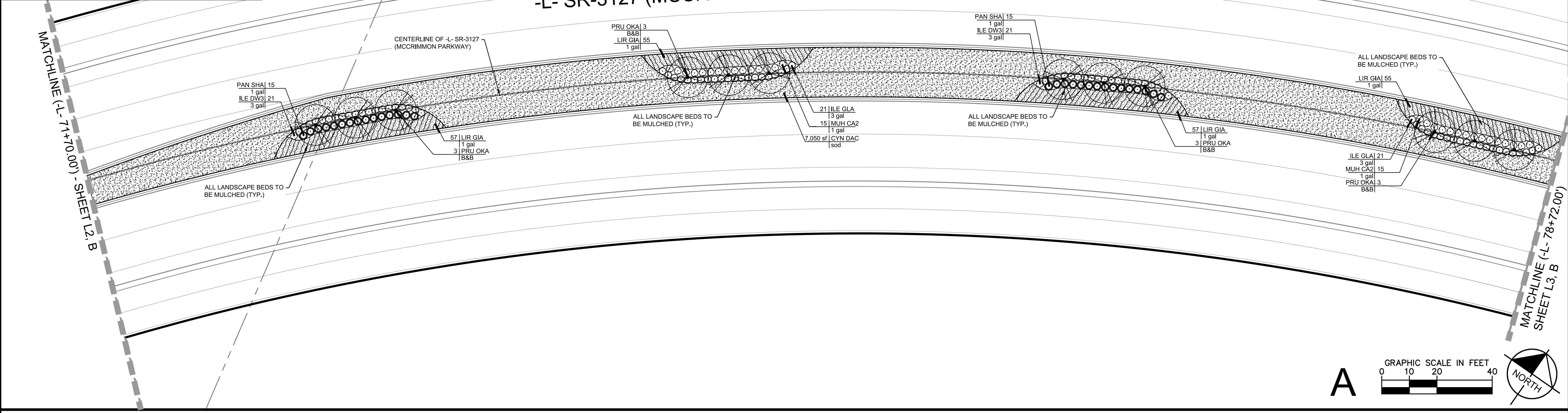
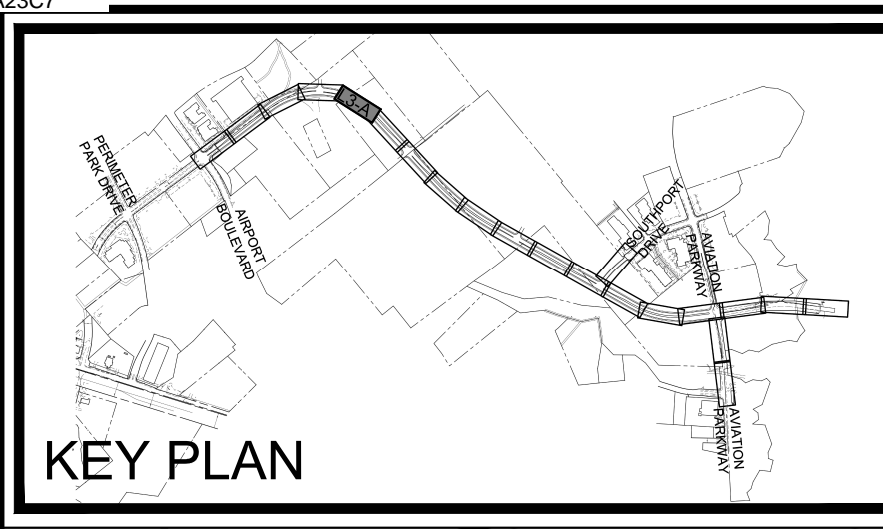
L3



K:\RDT_LDEV\012108004_McCrinmon Prkwy_matt_west\Planning_Phase\P15_CAD_Files\Plans\Sheets
 08/15/2017

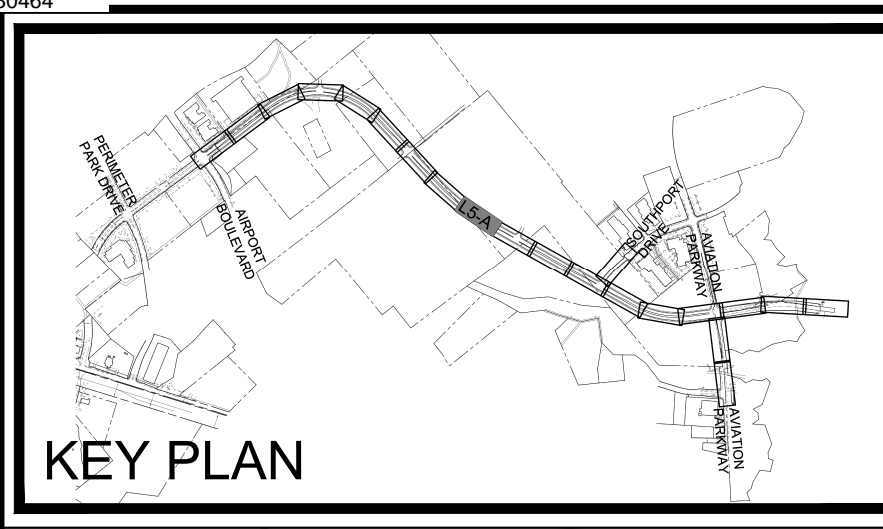

KEY PLAN

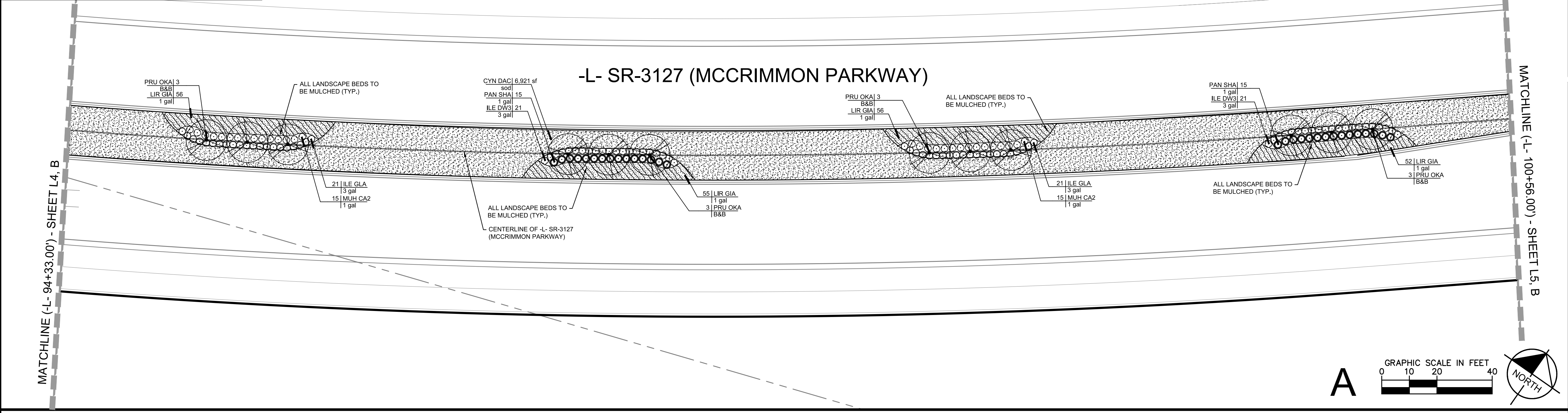

-L- SR-3127 (MCCRIMMON PARKWAY)

MATCHLINE (-L- 94+33.00') - SHEET L4, B

MATCHLINE (-L- 100+56.00') - SHEET L5, B

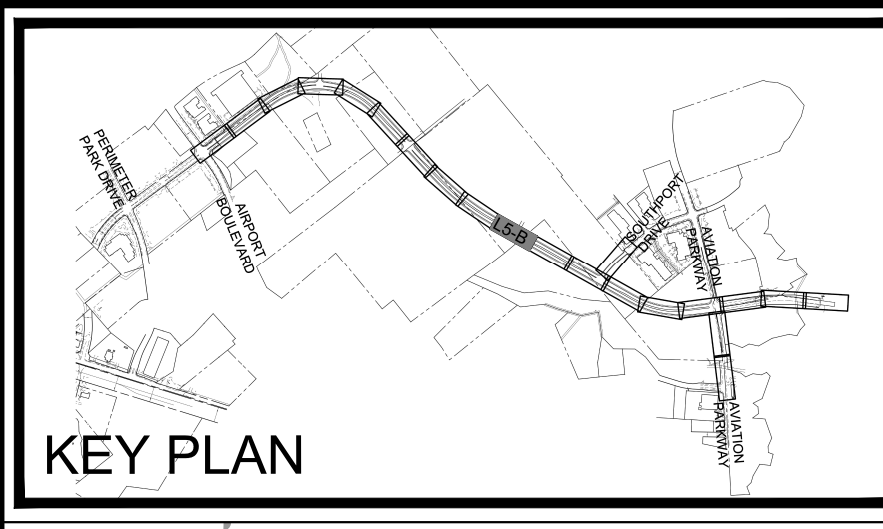
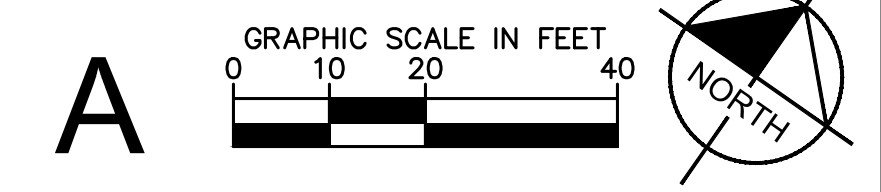

KEY PLAN

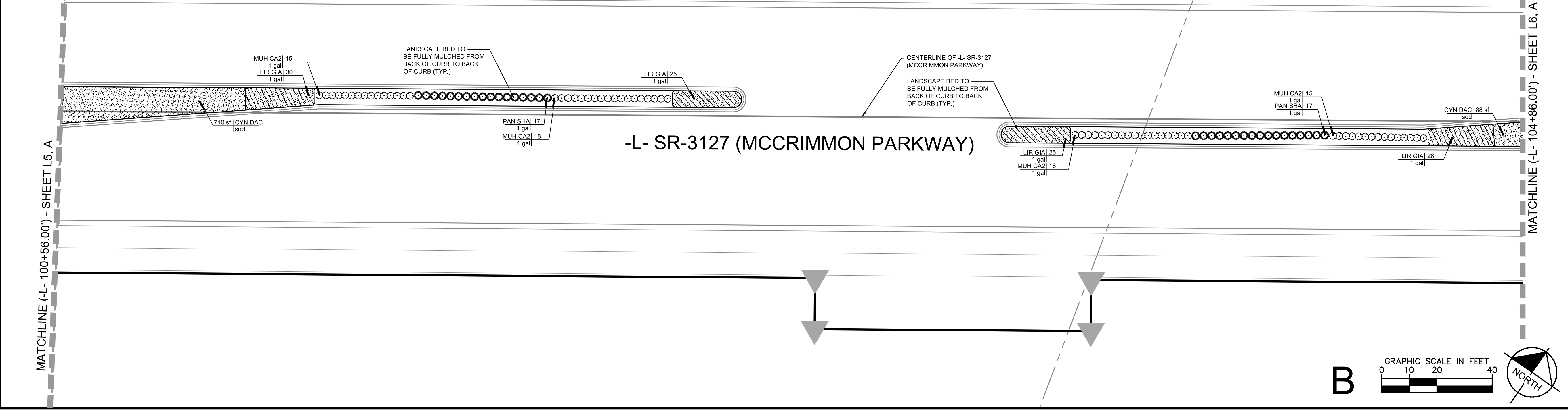

-L- SR-3127 (MCCRIMMON PARKWAY)

MATCHLINE (-L- 100+56.00') - SHEET L5, A

MATCHLINE (-L- 104+86.00') - SHEET L6, A

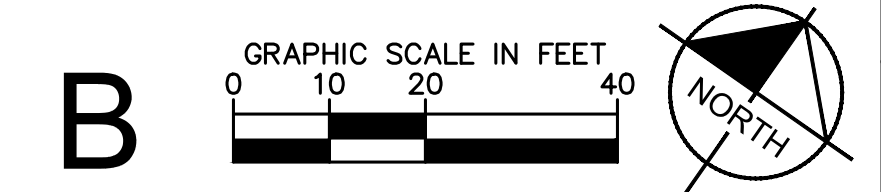

PLANS PREPARED BY:

Kimley»Horn

PO BOX 33068
RALEIGH, NC 27636-3068
PHONE: (919) 677-2000
FAX: (919) 677-2050
NC LICENSE #E-002
© 2016

SEAL

NO.	DATE	REVISIONS

PLANS PREPARED FOR:

TOWN OF MORRISVILLE

PROJECT:

U-5828
SR-3127 (MCCRIMMON PKWY)
MORRISVILLE, NC

TITLE:

LANDSCAPE PLAN

KHA PROJECT:

012108004-PHASE 2

DATE:

08-15-2017

100% PLANS

L5

08/15/2017 K:\RDT_LDEV\012108004_McCrimmon Prkwy_mdt_west\Planning Phase\P15_CAD Files\Plans\Sheets

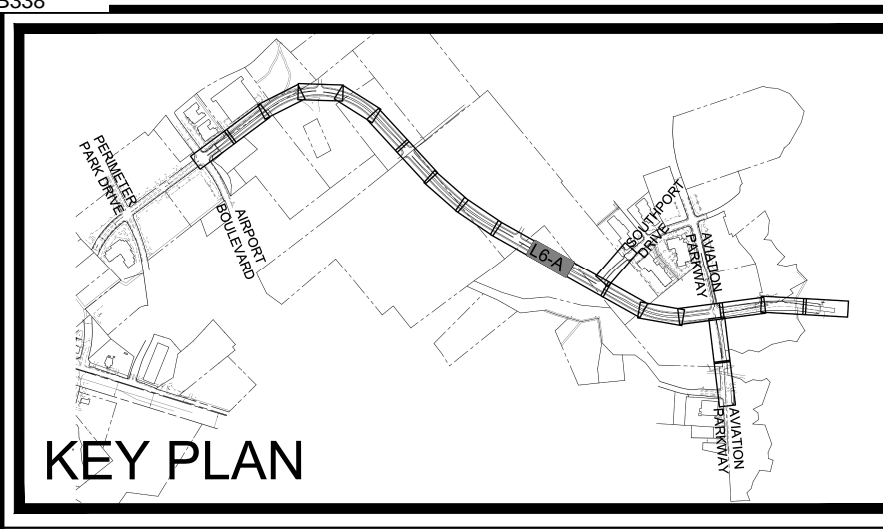
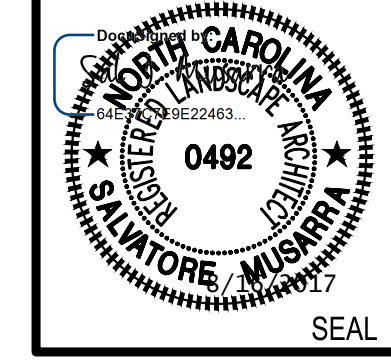

KEY PLAN

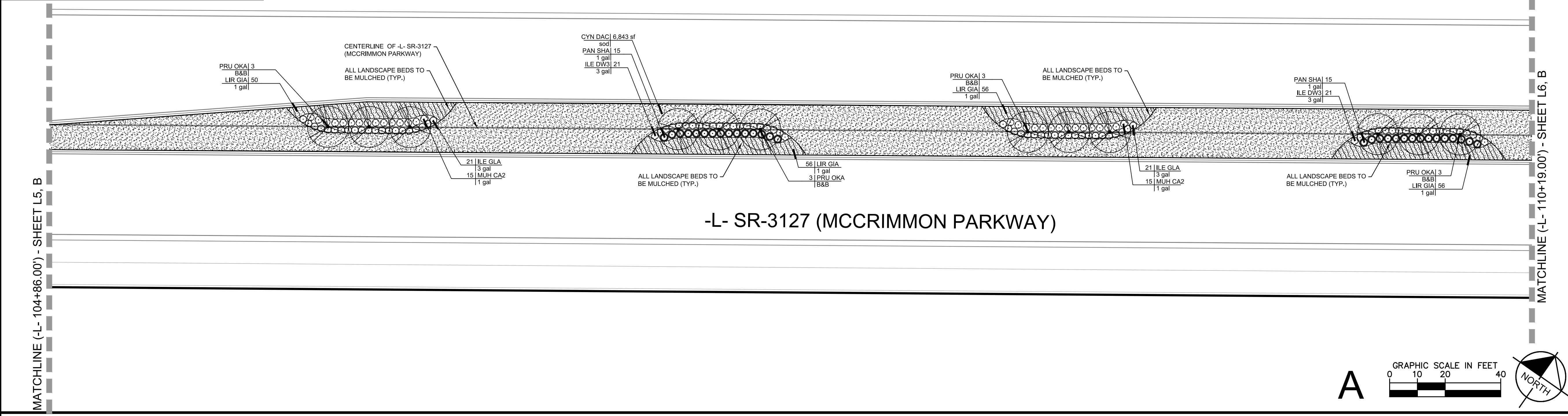

-L- SR-3127 (MCCRIMMON PARKWAY)

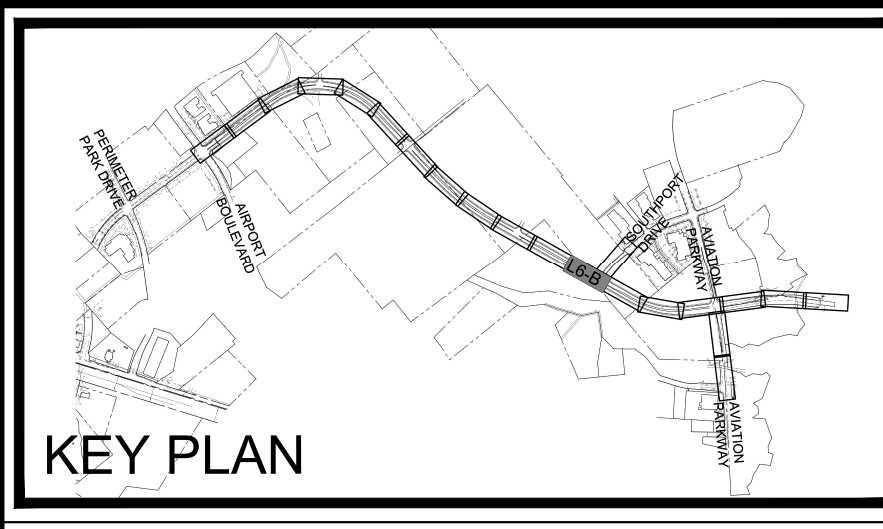
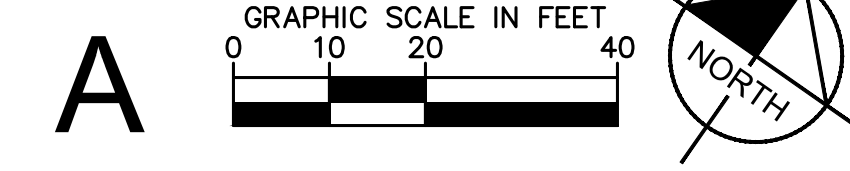

KEY PLAN

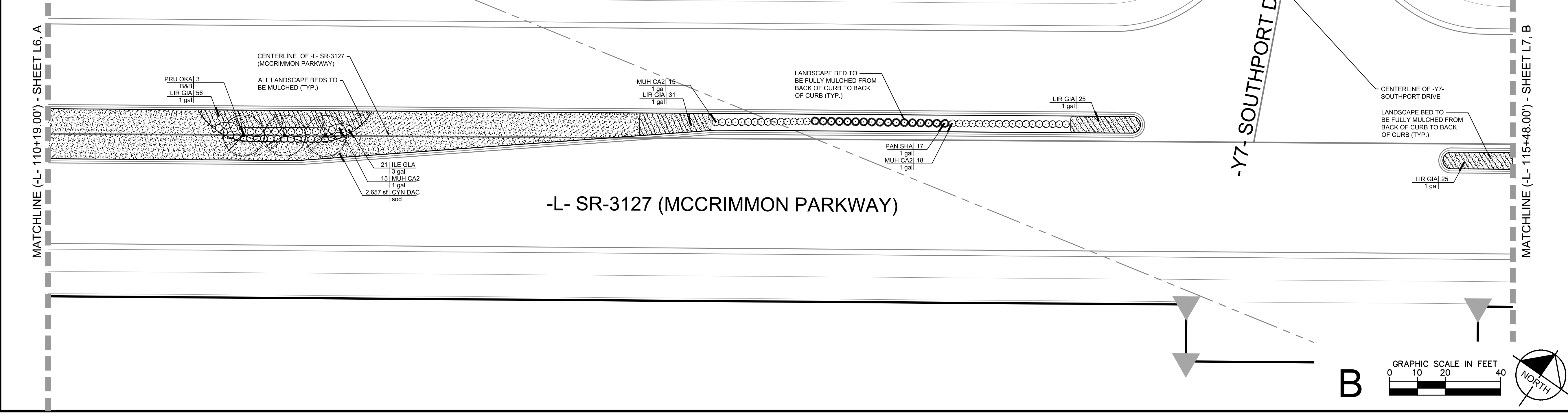

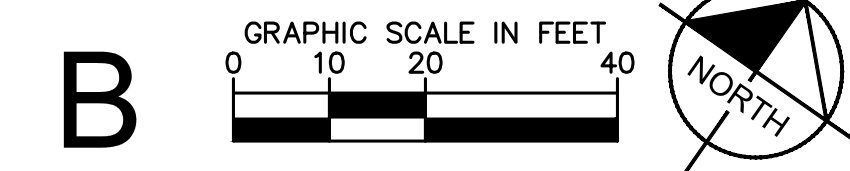

-L- SR-3127 (MCCRIMMON PARKWAY)

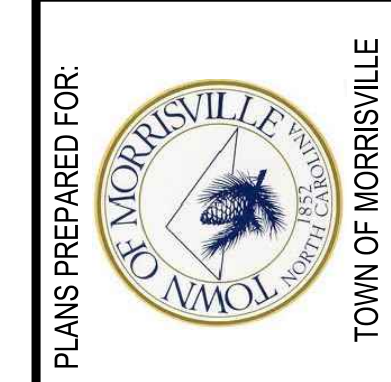

K:\RDT_DEV\012108004_McCrimmon Prkwy_mdt_west\Planning Phase\PI5_CAD Files\Plans\Sheet5 08/15/2017

NO.	DATE	REVISIONS



PLANS PREPARED FOR:

 TOWN OF MORRISVILLE

PROJECT:
 U-5828
 SR-3127 (MCCRIMMON PKWY)
 MORRISVILLE, NC

TITLE:
 LANDSCAPE PLAN

KHA PROJECT:
 012108004-PHASE 2
 DATE:
 08-15-2017

100% PLANS

L6

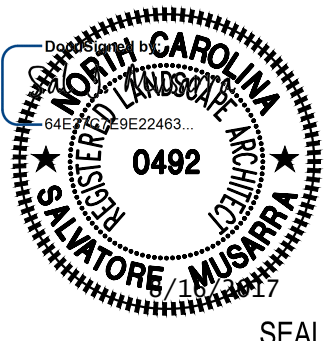

SEAL

NO.	DATE	REVISIONS



PLANS PREPARED FOR:
TOWN OF MORRISVILLE

PROJECT:
U-5828
SR-3127 (MCCRIMMON PKWY)
MORRISVILLE, NC

TITLE:
LANDSCAPE PLAN

KHA PROJECT:
012108004-PHASE 2
DATE:
08-15-2017

100% PLANS

L7

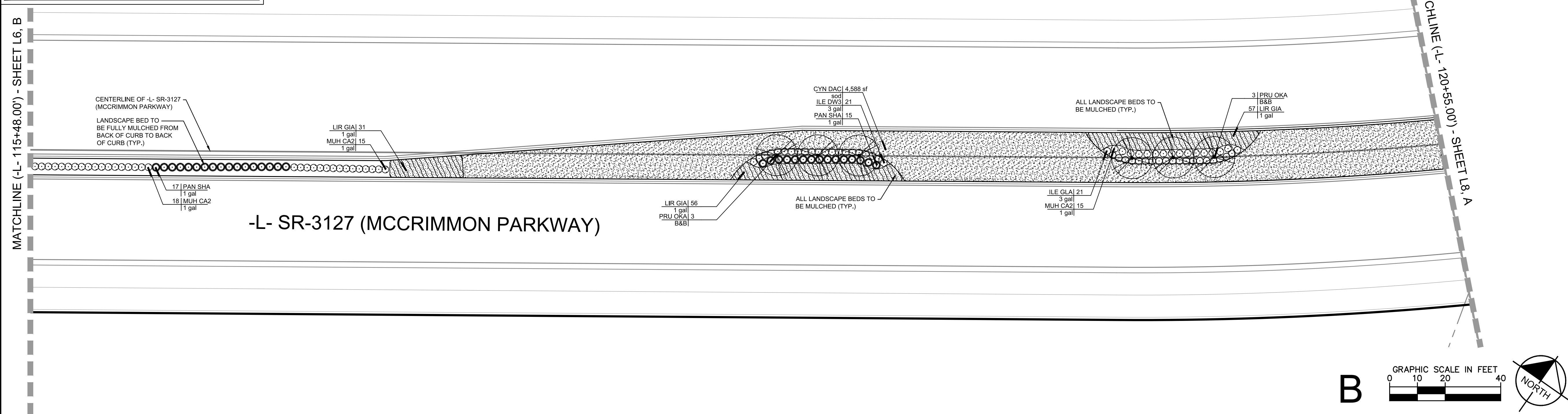
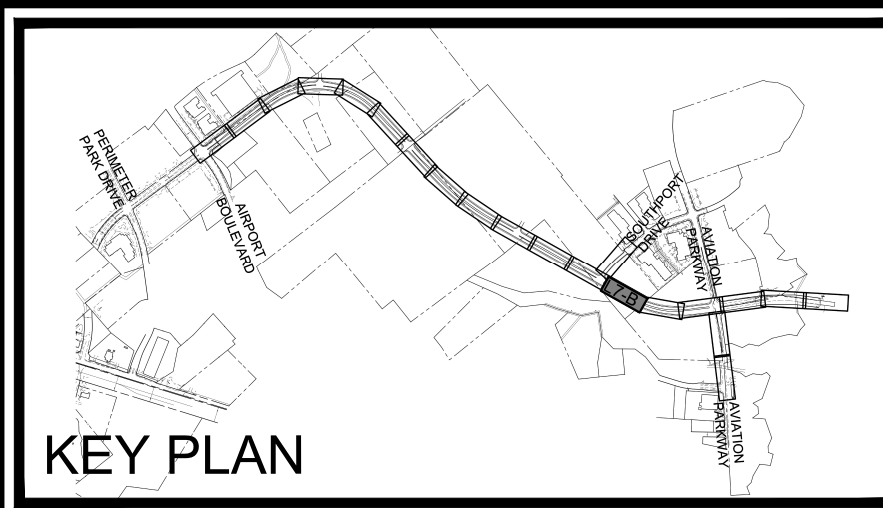
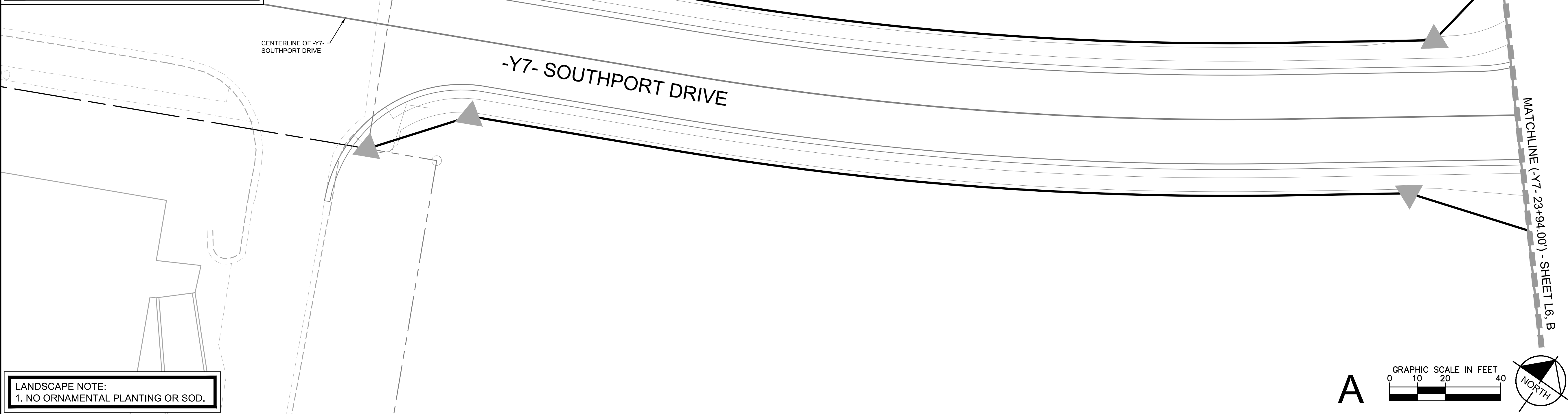
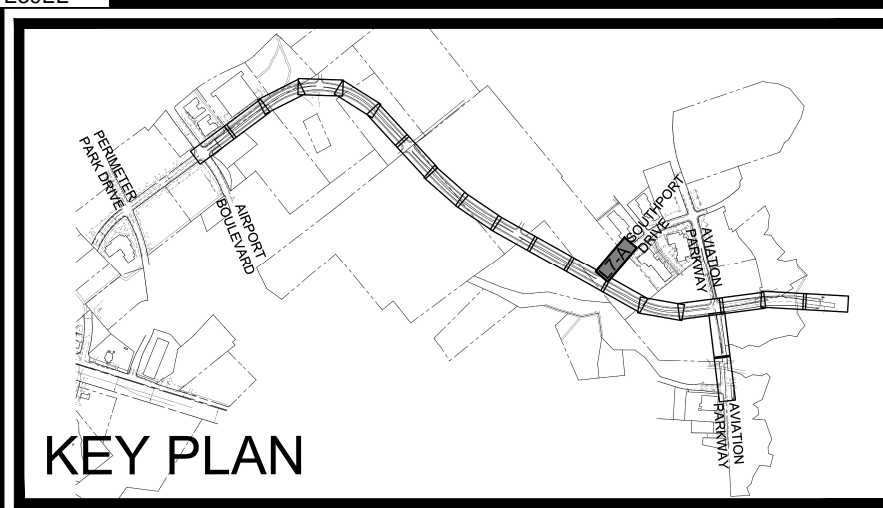

K:\RDT_DEV\012108004_McCrinmon Prkwy.mxd west\Planning Phase\PI5_CAD Files\Plans\Sheets 08/15/2017

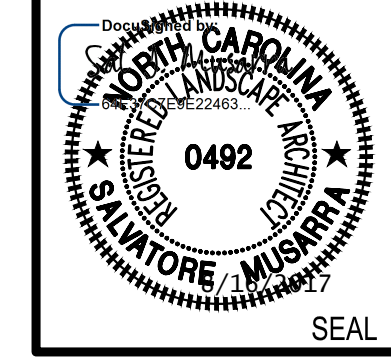

NO.	DATE	REVISIONS

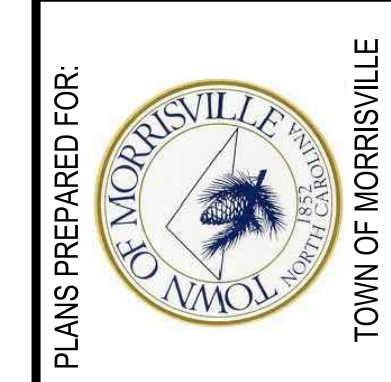

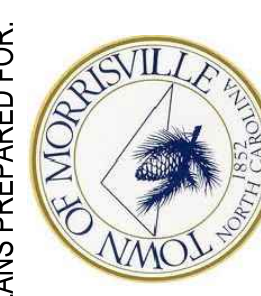
PLANS PREPARED FOR:
 TOWN OF MORRISVILLE

PROJECT:
 U-5828
 SR-3127 (MCCRIMMON PKWY)
 MORRISVILLE, NC

TITLE:
 LANDSCAPE PLAN

KHA PROJECT:
 012108004-PHASE 2
 DATE:
 08-15-2017

100% PLANS

L8

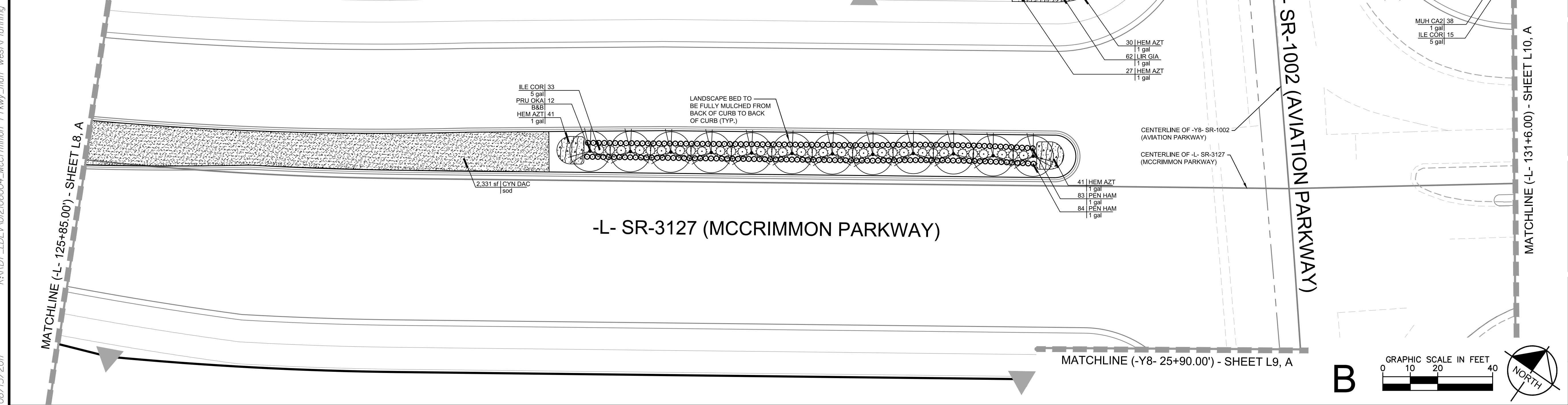
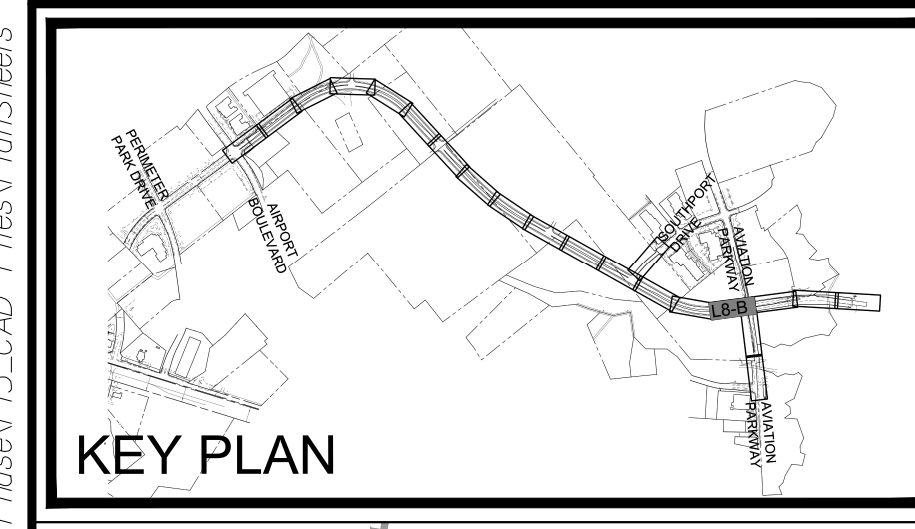
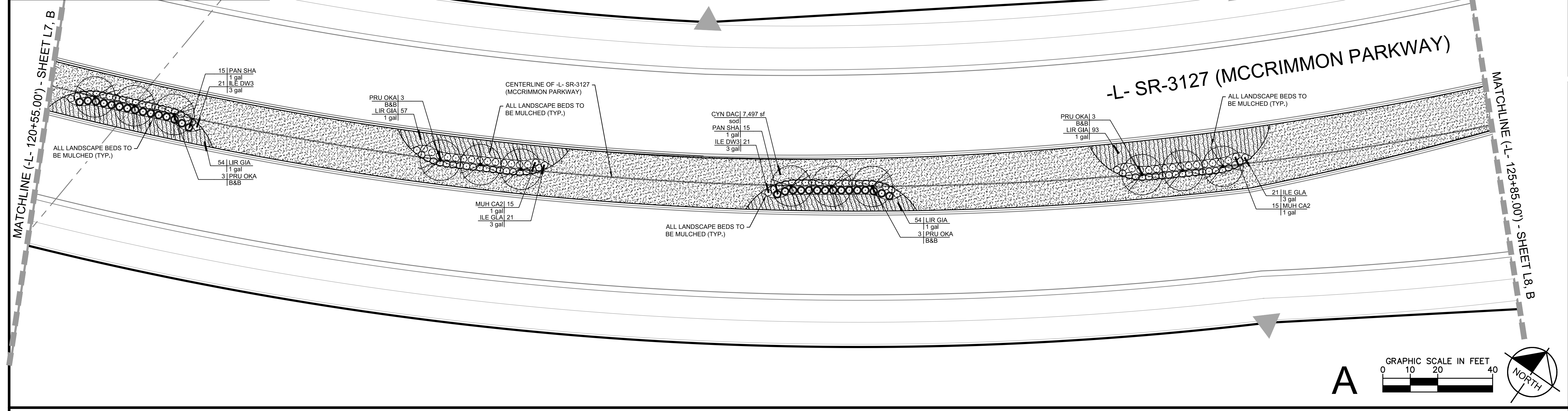
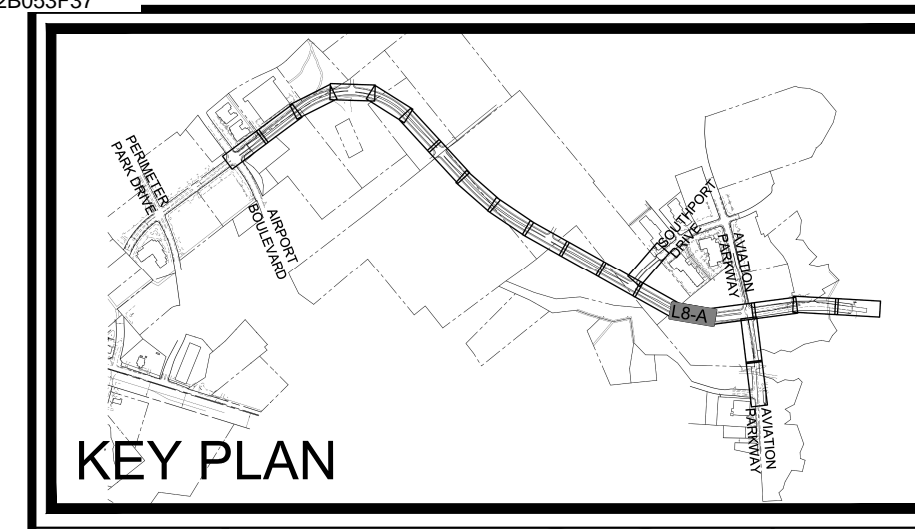

08/15/2017 K:\RDT_LDEV\012108004_McCrImmon Prkwy_matt_west\Planning_Phase\15_CAD_Files\Plans\Sheets

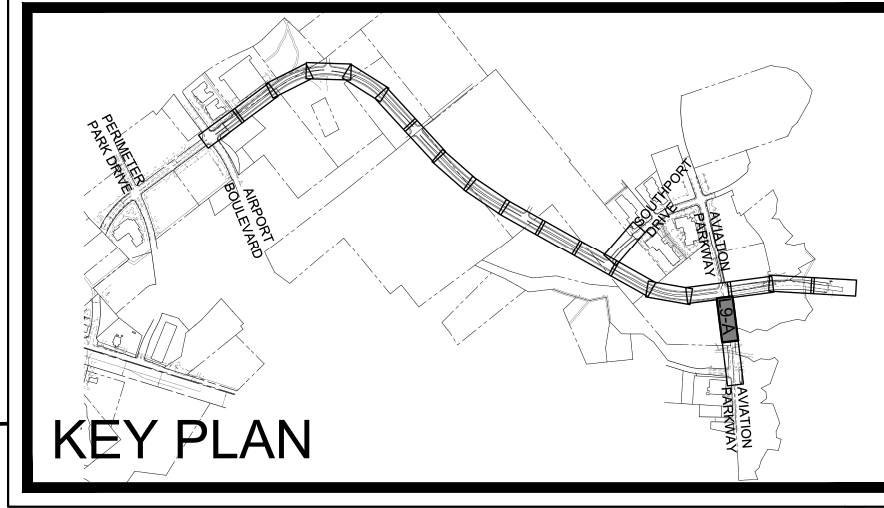
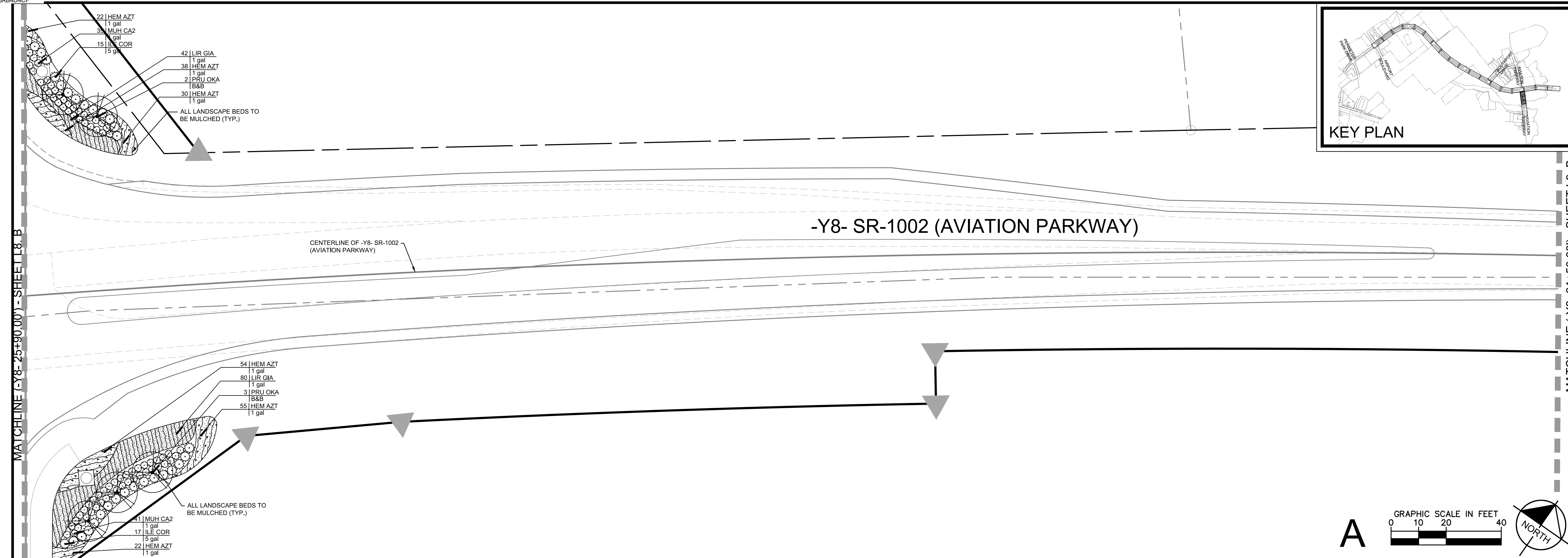

PLANS PREPARED BY:
Kimley»Horn
 P.O. BOX 33068
 RALEIGH, NC 27636-3068
 PHONE: (919) 677-2000
 FAX: (919) 677-2050
 NC LICENSE #E-002
 © 2016

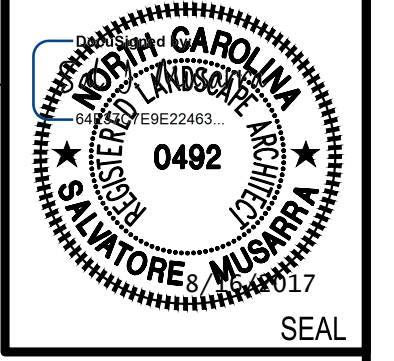

NO.	DATE	REVISIONS

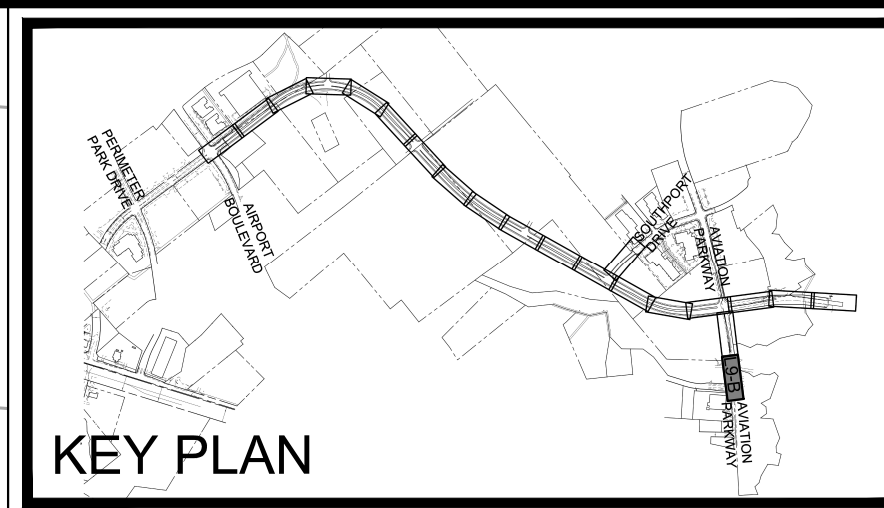
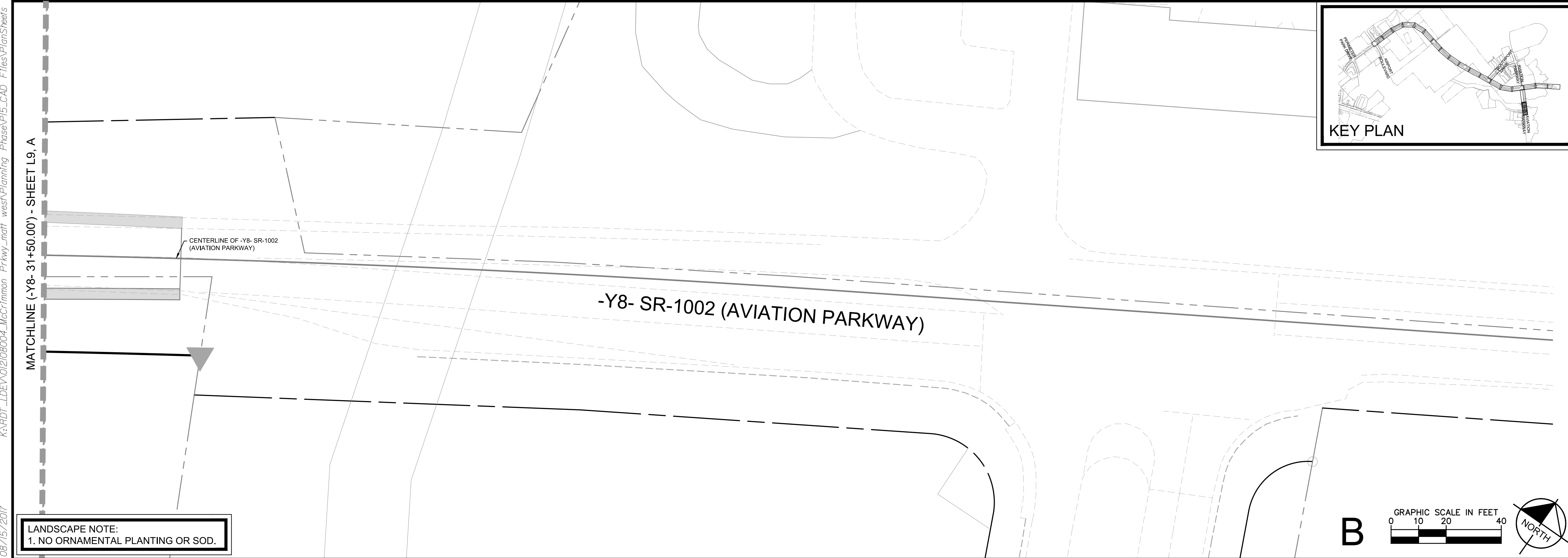
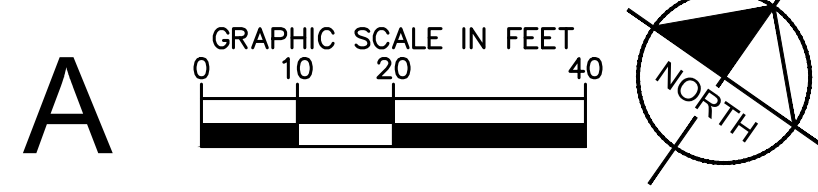

PLANS PREPARED FOR:

 TOWN OF MORRISVILLE

PROJECT:
 U-5828
 SR-3127 (MCCRIMMON PKWY)
 MORRISVILLE, NC

TITLE:
 LANDSCAPE PLAN

KHA PROJECT:
 012108004-PHASE 2
 DATE:
 08-15-2017

100% PLANS

L9

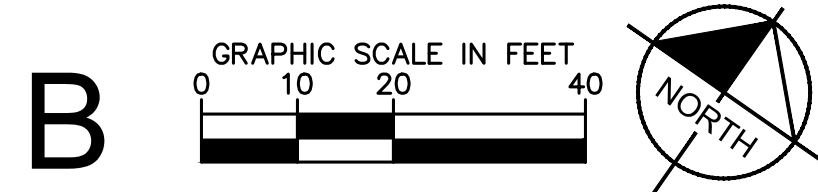

LANDSCAPE NOTE:
 1. NO ORNAMENTAL PLANTING OR SOD.

K:\VDT_LDEV\012108004_McCrinmon Prkwy_mdt_west\Planning_Phase\PI5_CAD_Files\Plans\Sheets
 08/15/2017

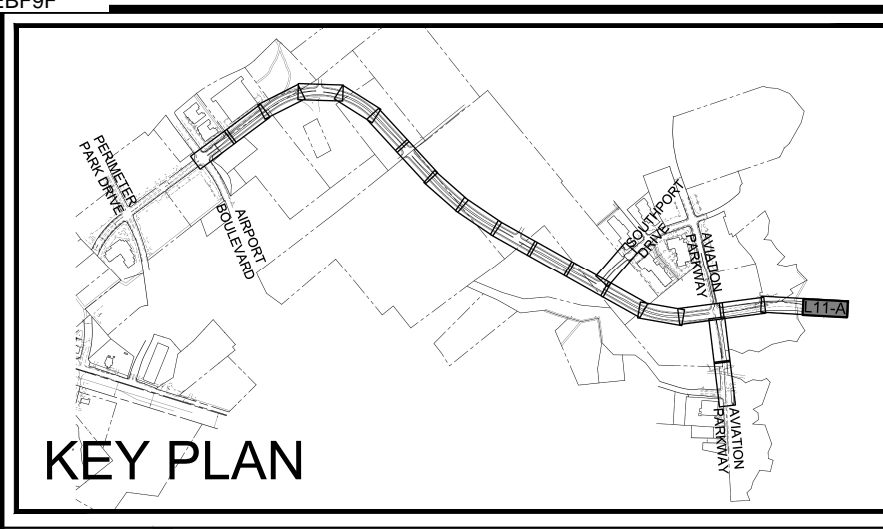

LANDSCAPE NOTE:
1. NO ORNAMENTAL PLANTING OR SOD.

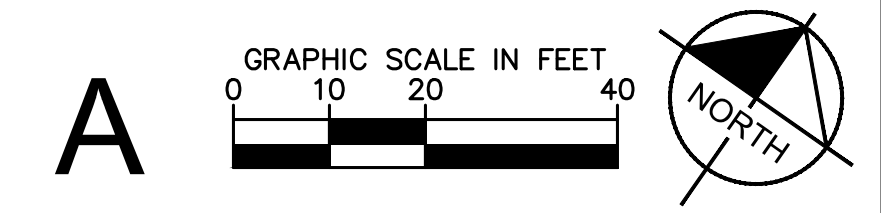

PLANS PREPARED BY:

Kimley»Horn

PO BOX 33068
RALEIGH, NC 27636-3068
PHONE: (919) 677-2000
FAX: (919) 677-2050
NC LICENSE #E-002
© 2016

SEAL

NO.	DATE	REVISIONS

PLANS PREPARED FOR:

TOWN OF MORRISVILLE

PROJECT:
U-5828
SR-3127 (MCCRIMMON PKWY)
MORRISVILLE, NC

TITLE:
LANDSCAPE PLAN

KHA PROJECT:
012108004-PHASE 2
DATE:
08-15-2017

100% PLANS

L11

08/15/2017 K:\RDT_LDEV\012108004_McCrimmon_Pkwy_mtl west\Planning_Phase\P15_CAD_Files\Plans\Sheets

PLANT SCHEDULE

TREES	QTY	BOTANICAL NAME	COMMON NAME	CONT	CAL	SIZE	HT.	REMARKS
PRU OKA	125	Prunus x okame	Okame Cherry	B&B	2.5" Cal	8'-10"		Strong central leader
SHRUBS	QTY	BOTANICAL NAME	COMMON NAME	SIZE	WIDTH	HEIGHT	SPACING	REMARKS
ILE COR	92	Ilex cornuta 'Carissa'	Carissa Holly	5 gal	24"	24"	48" o.c.	
ILE DW3	357	Ilex vomitoria 'Schillings Dwarf'	Dwarf Schillings Holly	3 gal	18"	18"	30" o.c.	
ILE GLA	357	Ilex glabra 'Compacta'	Compact Inkberry Holly	3 gal	18"	18"	30" o.c.	
MUH CA2	760	Muhlenbergia capillaris	Pink Muhly	1 gal	24"	24"	30" o.c.	
PAN SHA	457	Panicum virgatum 'Shenendoah'	Burgundy Switch Grass	1 gal	24"	24"	36" o.c.	
PEN HAM	167	Pennisetum alopecuroides 'Hameln'	Hameln Dwarf Fountain Grass	1 gal	18"	18"	24" o.c.	
GROUND COVERS	QTY	BOTANICAL NAME	COMMON NAME	CONT	WIDTH	HEIGHT	SPACING	REMARKS
CYN DAC	68,909 sf*	Cynodon dactylon 'TifGrand'	TifGrand Bermuda Grass	sod				
HEM AZT	472	Hemerocallis x 'Aztec Gold'	Dwarf Evergreen Day Lily	1 gal			18" o.c.	
LIR GIA	2,755	Liriope muscari 'Evergreen Giant'	Evergreen Giant Border Grass	1 gal			30" o.c.	

*Quantity of Cynodon dactylon (Bermuda Grass) converted to square yards: 7,656.56 square yards

GENERAL LANDSCAPE NOTES:

ALL PLANTS MUST BE HEALTHY, VIGOROUS MATERIAL, FREE OF PESTS AND DISEASE.
 ALL PLANTS MUST BE CONTAINER GROWN OR BALLED AND BURLAPPED AS INDICATED IN THE PLANT SCHEDULE.
 ALL TREES MUST HAVE A STRAIGHT TRUNK AND FULL HEADED AND MEET ALL REQUIREMENTS SPECIFIED.
 ALL PLANTS ARE SUBJECT TO THE APPROVAL OF THE LANDSCAPE ARCHITECT BEFORE, DURING, AND AFTER INSTALLATION.
 ALL TREES MUST BE GUYED OR STAKED AS SHOWN IN THE DETAILS.
 ALL SHADE TREES LOCATED WITHIN VEHICLE SIGHT TRIANGLES SHALL BE BRANCHED MIN. 8' (MEASURED FROM ADJACENT PROJECTED CURB LINE ELEVATION) PER ANSI Z60.1 STANDARDS FOR HEIGHT OF BRANCHING - STREET TREES.
 ALL PLANTING AREAS MUST BE COMPLETELY MULCHED AS SPECIFIED.
 PRIOR TO CONSTRUCTION, THE CONTRACTOR SHALL BE RESPONSIBLE FOR LOCATING ALL UNDERGROUND UTILITIES AND SHALL AVOID DAMAGE TO ALL UTILITIES AND SHALL AVOID DAMAGE TO ALL UTILITIES DURING THE COURSE OF THE WORK. THE CONTRACTOR IS RESPONSIBLE FOR REPAIRING ANY AND ALL DAMAGE TO UTILITIES, STRUCTURES, SITE APPURTENANCES, ETC. WHICH OCCURS AS A RESULT OF THE LANDSCAPE CONSTRUCTION.
 THE CONTRACTOR IS RESPONSIBLE FOR VERIFYING ALL QUANTITIES SHOWN ON THESE PLANS BEFORE PRICING THE WORK. ANY DISCREPANCIES BETWEEN QUANTITIES ON PLAN AND PLANT LIST SHALL BE BROUGHT TO THE ATTENTION OF CITY OF RALEIGH INSPECTOR AND ANY FIELD ADJUSTMENTS OR QUANTITY ADJUSTMENTS MUST BE AUTHORIZED PRIOR TO PLANTING.
 THE CONTRACTOR IS RESPONSIBLE FOR FULLY MAINTAINING ALL PLANTING (INCLUDING BUT NOT LIMITED TO: WATERING, SPRAYING, MULCHING, FERTILIZING, ETC.) OF THE PLANTING AREAS AND LAWN UNTIL SUBSTANTIAL COMPLETION.
 THE CONTRACTOR SHALL COMPLETELY GUARANTEE ALL PLANT MATERIAL FOR A PERIOD OF TWO (2) YEAR BEGINNING ON THE DATE OF SUBSTANTIAL COMPLETION. THE CONTRACTOR SHALL PROMPTLY MAKE ALL REPLACEMENTS BEFORE OR AT THE END OF THE GUARANTEE PERIOD.
 THE LANDSCAPE ARCHITECT SHALL APPROVE THE STAKING LOCATION OF ALL PLANT MATERIAL PRIOR TO INSTALLATION.
 AFTER BEING DUG AT THE NURSERY SOURCE, ALL TREES IN LEAF SHALL BE ACCLIMATED FOR TWO (2) WEEKS UNDER A MIST SYSTEM PRIOR TO INSTALLATION.
 ANY PLANT MATERIAL WHICH DIES, TURNS BROWN, OR DEFOLIATES (PRIOR TO SUBSTANTIAL COMPLETION OF THE WORK) SHALL BE PROMPTLY REMOVED FROM THE SITE AND REPLACED WITH MATERIAL OF THE SAME SPECIES, QUANTITY, AND SIZE AND MEETING ALL PLANT SCHEDULE SPECIFICATIONS.
 STANDARDS SET FORTH IN "AMERICAN STANDARD FOR NURSERY STOCK" REPRESENT GUIDELINE SPECIFICATIONS ONLY AND SHALL CONSTITUTE MINIMUM QUALITY REQUIREMENTS FOR PLANT MATERIAL.
 ALL SHRUB, GROUND COVER AND SEASONAL COLOR ANNUAL PLANTING BEDS ARE TO BE COMPLETELY COVERED WITH DOUBLE SHREDDED HARDWOOD MULCH OR CURRENT TOWN OF MORRISVILLE STANDARD TO A DEPTH OF THREE (3) INCHES.
 LOCATIONS OF EXISTING BURIED UTILITY LINES SHOWN ON THE PLANS ARE BASED UPON BEST AVAILABLE INFORMATION AND ARE TO BE CONSIDERED APPROXIMATE. IT SHALL BE THE RESPONSIBILITY OF THE CONTRACTOR TO VERIFY THE LOCATIONS OF UTILITY LINES AND ADJACENT TO THE WORK AREA. THE CONTRACTOR IS RESPONSIBLE FOR THE PROTECTION OF ALL UTILITY LINES DURING THE CONSTRUCTION PERIOD.
 SAFE, CLEARLY MARKED PEDESTRIAN AND VEHICULAR ACCESS TO ALL ADJACENT PROPERTIES MUST BE MAINTAINED THROUGHOUT THE CONSTRUCTION PROCESS.
 ALL PLANT MATERIAL QUANTITIES SHOWN ARE APPROXIMATE. CONTRACTOR SHALL BE RESPONSIBLE FOR COMPLETE COVERAGE OF ALL PLANTING BEDS AT SPACING SHOWN.
 ALL ROOT COLLARS SHALL BE EXPOSE, VISIBLE, AND PLANTED AT THE FINISHED GRADE
 ALL DEAD, BROKEN, OR CIRCLING ROOTS MUST BE CUT CLEANLY BEFORE BACKFILLING, SO THAT ALL ROOTS ARE HEALTHY AND GROWING DIRECTLY INTO THE SURROUNDING BACKFILL.
 ALL STRAPPING AND TOP 2/3 OF WIRE BASKET MUST BE CUT AWAY AND REMOVED FROM ROOT BALL PRIOR TO BACKFILLING PLANTING PIT. REMOVE TOP 1/3 OF THE BURLAP FROM ROOT BALL.
 FOR NEW PLANTING AREAS, REMOVE ALL PAVEMENT, GRAVEL SUB-BASE AND CONSTRUCTION DEBRIS; REMOVE COMPACTED SOIL AND ADD 24" NEW TOPSOIL OR UNCOMPACT AND AMEND THE TOP 24" OF EXISTING SOIL TO MEET TOPSOIL PLANTING MIX STANDARDS FOR TREES. SEE DETAILS THIS SHEET.
 THE CONTRACTOR SHALL BE RESPONSIBLE FOR INSTALLING TREES AND SHRUBS THAT WILL MEET BOTH MINIMUM SIZE AND SPACING FOR TREE AND ZONING ORDINANCE COMPLIANCE. FAILURE TO INSTALL PLANT MATERIAL PER THIS PLAN WILL JEOPARDIZE ISSUANCE OF FINAL CERTIFICATE OF OCCUPANCY. CONTRACTOR SHALL BE RESPONSIBLE FOR SCHEDULING INSPECTIONS OF PLANT MATERIAL.
 CONTRACTOR SHALL COMPLY WITH ALL APPLICABLE CODES & ORDINANCES REGARDING LANDSCAPING. GENERAL CONTRACTOR IS TO CLEAN THE ENTIRE SITE OF ALL CONSTRUCTION DEBRIS AND TO RAKE ENTIRE SITE.

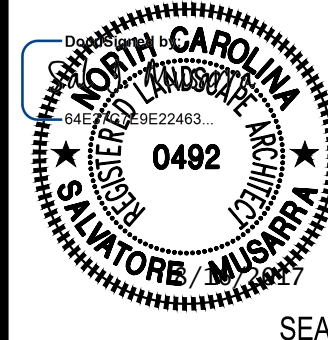
PLANS PREPARED BY:
Kimley»Horn
 P.O. BOX 33068
 RALEIGH, NC 27634-3068
 PHONE: (919) 677-2000
 FAX: (919) 677-2050
 NC LICENSE #E-002
 © 2016

NO.	DATE	REVISIONS

PLANS PREPARED FOR:

 TOWN OF MORRISVILLE

PROJECT:
 U-5828
 SR-3127 (MCCRIMMON PKWY)
 MORRISVILLE, NC

TITLE:
 LANDSCAPE DETAILS

KHA PROJECT:
 012108004-PHASE 2
 DATE:
 08-15-2017

100% PLANS

L12

K:\RDT_LDEV\012108004_McCrinmon Prkwy_mdt_west\Planning Phase\PI5_CAD Files\Plans\Sheets 08/15/2017

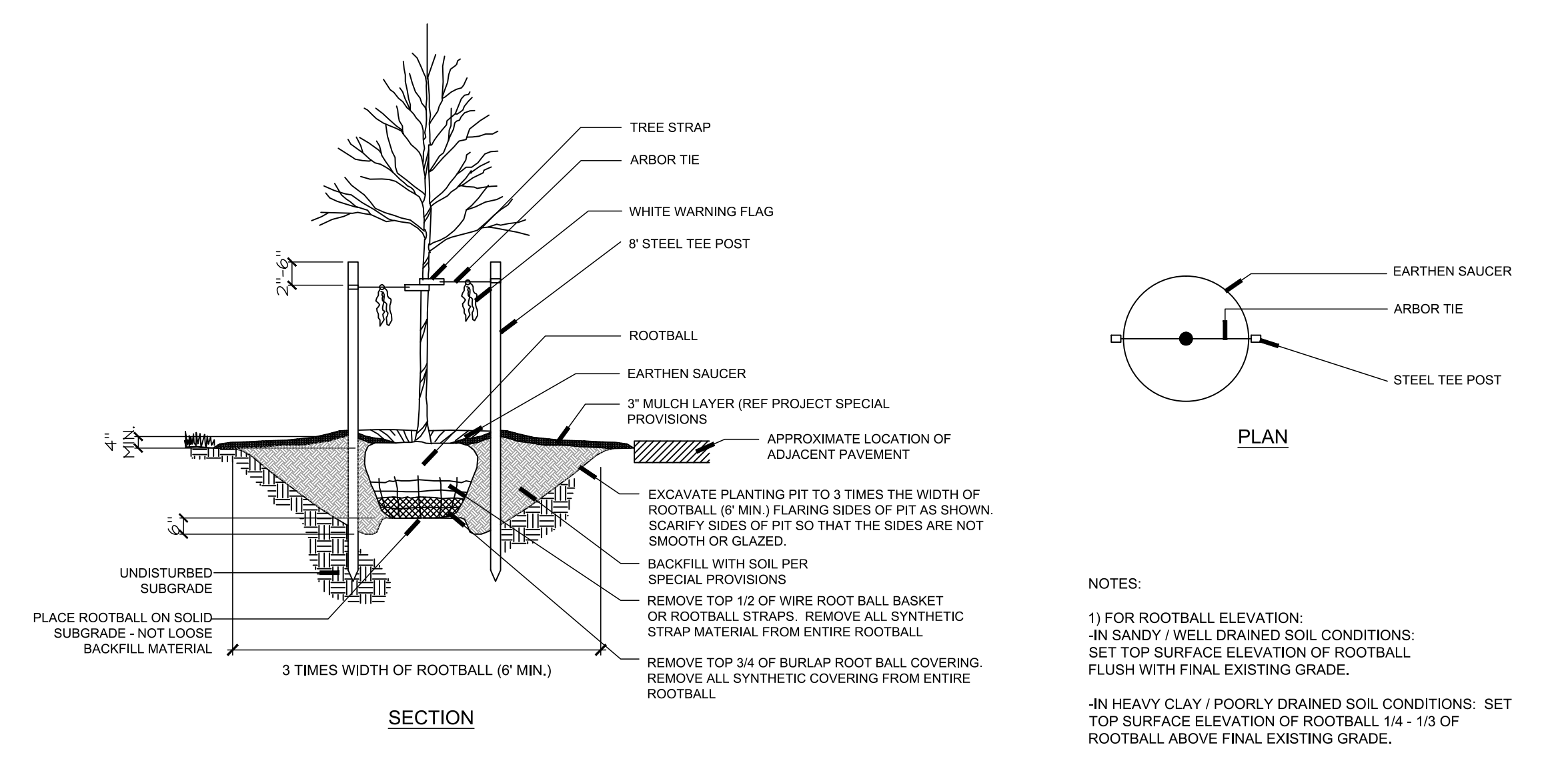
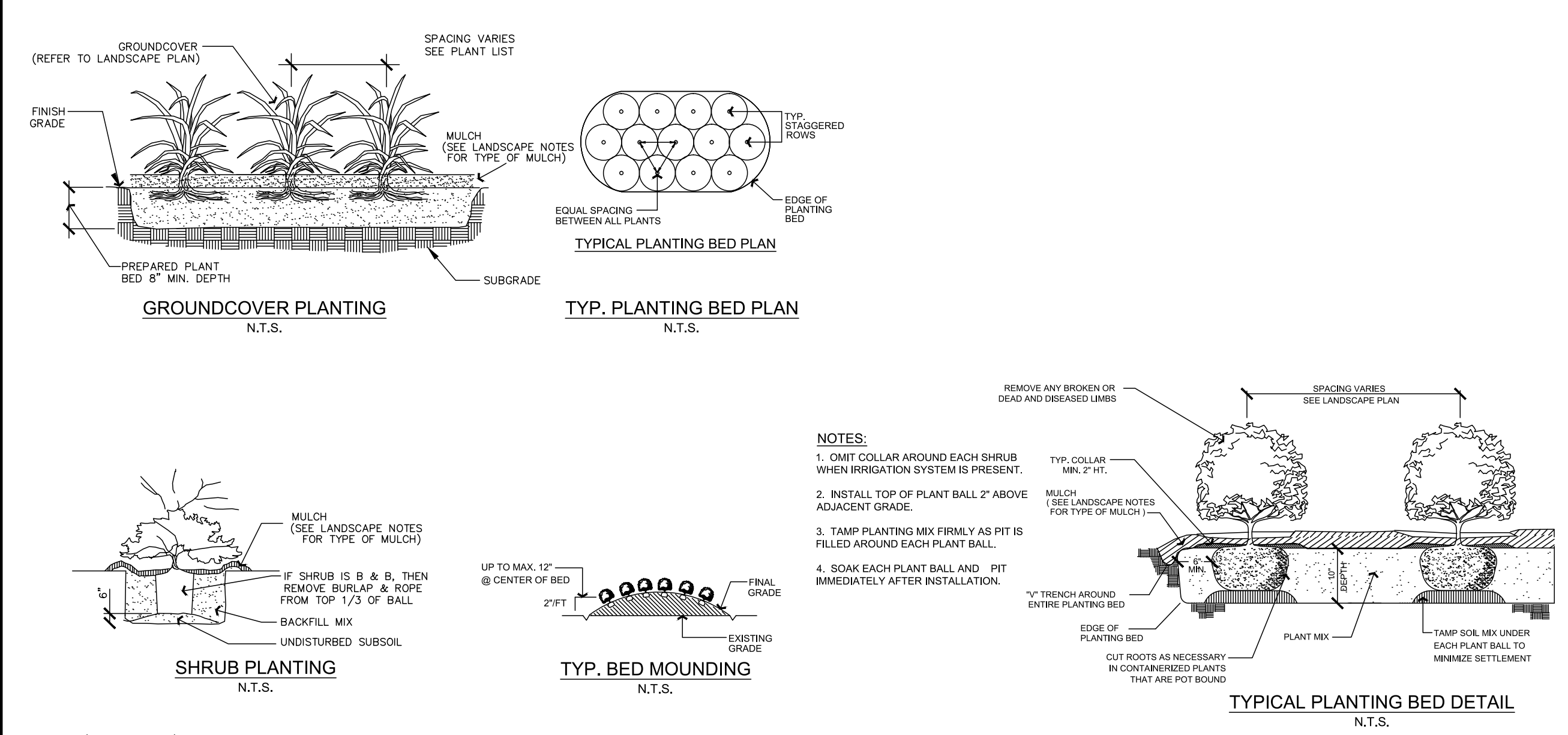

1
L12
TYPICAL PLANTING DETAILS
 SCALE: NTS

2
L12
TYPICAL TREE PLANTING / STAKING DETAIL (FOR 6'-12' TREE HEIGHTS AT PLANTING)
 SCALE: NTS