

PROJECT REFERENCE NO. <i>U-5828</i>	SHEET NO. <i>UC-11</i>
R/W SHEET NO.	
UTILITY CONSTRUCTION ENGINEER	
2/1/2018	

ALL RECLAIMED WATER DISTRIBUTION MAINS IN THE TOWN OF CARY WATER SYSTEM SHALL BE RESTRAINED. THE RECLAIMED WATER DISTRIBUTION SPECIFICATION IS BASED ON MECHANICAL RESTRAINING METHODS PROVIDED AT ALL JOINTS, REGARDLESS OF PIPE MATERIAL. TYPICAL CONCRETE BLOCKING AND RODDING SHALL NOT BE UTILIZED FOR THE RECLAIMED WATER SYSTEM UNLESS OTHERWISE APPROVED BY THE DIRECTOR OF ENGINEERING.

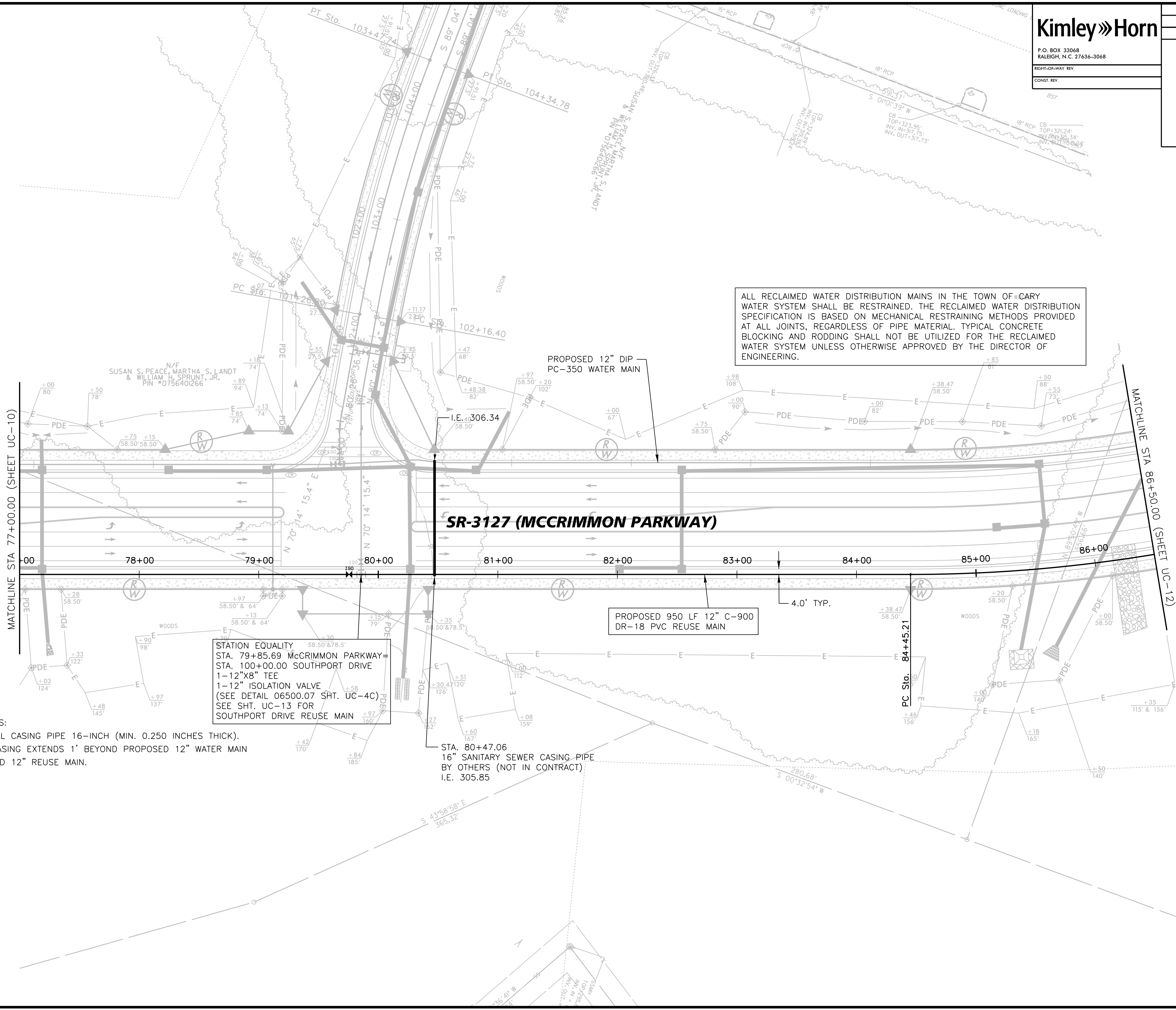

STATION EQUALITY
STA. 79+85.69 McCRIMMON PARKWAY=
STA. 100+00.00 SOUTHPORT DRIVE
1-12"X8" TEE
1-12" ISOLATION VALVE
(SEE DETAIL 06500.07 SHT. UC-4C)
SEE SHT. UC-13 FOR
SOUTHPORT DRIVE REUSE MAIN

PROPOSED 950 LF 12" C-900
DR-18 PVC REUSE MAIN

PROPOSED 12" DIP
PC-350 WATER MAIN

- NOTES:
1. ALL CASING PIPE 16-INCH (MIN. 0.250 INCHES THICK).
 2. CASING EXTENDS 1' BEYOND PROPOSED 12" WATER MAIN AND 12" REUSE MAIN.

STA. 80+47.06
16" SANITARY SEWER CASING PIPE
BY OTHERS (NOT IN CONTRACT)
I.E. 305.85

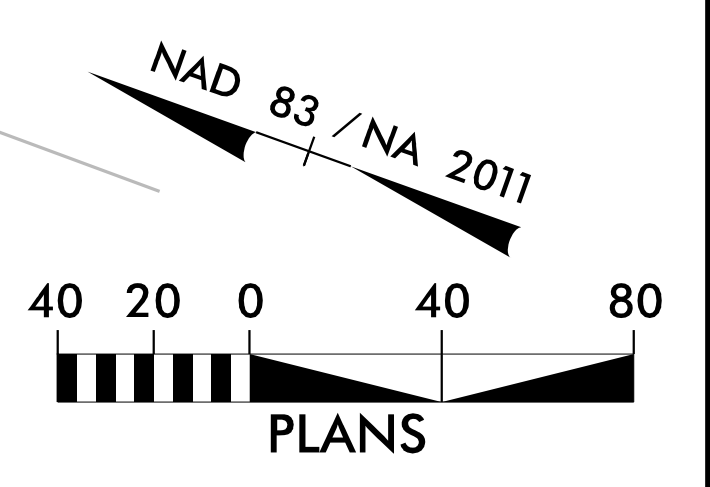

K:\RAL_Roadway\012108004 - McCrimmon Parkway\Phase I\Plan\Utility Construction\Phase2_012108004_ut_rdy13_ucl_pshdgn 1/31/2018