

CLEARING AND GRUBBING  
EROSION CONTROL FOR  
CONSTRUCTION SHEET 16

**Kimley»Horn**

P.O. BOX 33068  
RALEIGH, N.C. 27636-3068  
RIGHT-OF-WAY REV.  
CONST. REV.

|                       |           |
|-----------------------|-----------|
| PROJECT REFERENCE NO. | SHEET NO. |
| U-5828                | EC-14     |
| R/W SHEET NO. 16      |           |

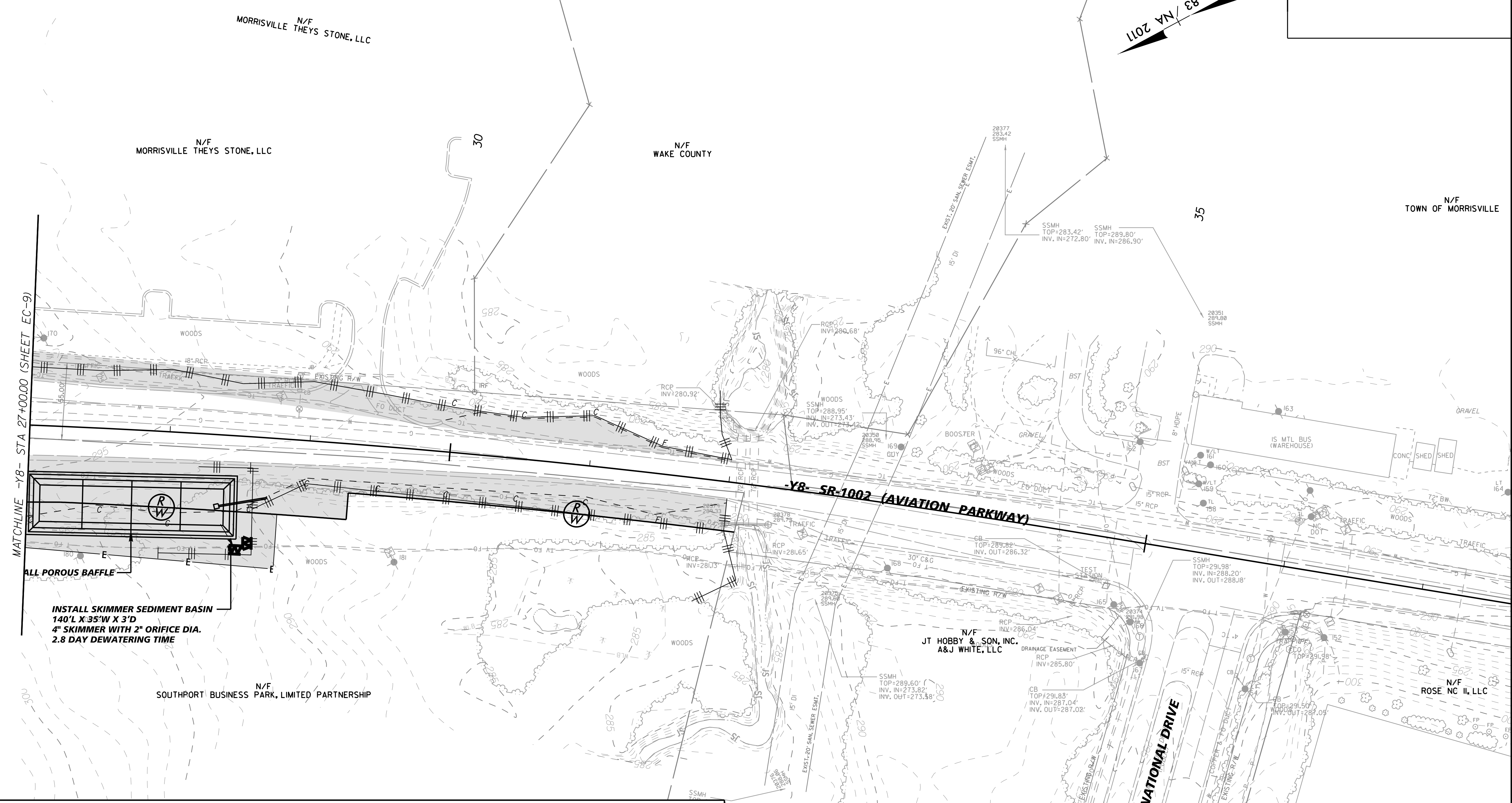

| Std. #  | Description  | Symbol | Description                            | Symbol |
|---------|--|--------|--|--------|
| 1605.01 | Temporary Silt Fence   |        | Skimmer Basin                          |        |
| 1606.01 | Special Sediment Control Fence   |        | Tree Protection Fence                  |        |
| 1630.05 | Temporary Diversion  |        | Sediment Basin Emergency Spillway      |        |
| 1630.06 | Special Stilling Basin   |        | Concrete Washout Structure             |        |
| 1632.03 | Rock Inlet Sediment Trap Type C  |        | Temporary Gravel Construction Entrance |        |
| 1633.01 | Temporary Rock Silt Check Type-A                                       |        | Coffer Dam / Impervious Dike           |        |
|         | Temporary Rock Silt Check Type-A with Matting and Polyacrylamide (PAM) |        | Clean Water Diversion                  |        |
| 1633.02 | Temporary Rock Silt Check Type-B                                       |        | Construction Limit                     |        |
|         |  |        | Limits of Disturbance (Shaded)         |        |

ENVIRONMENTALLY SENSITIVE AREA  
SEE PROJECT SPECIAL PROVISIONS

K:\RAL\_Roadway\01208004 - McCrimmon Parkway\Phase I\Plan\Plan Sheets\U5828\_rdy\_psh\_EC14.dgn 1/31/2018