

FIBER INSTALLATION SHOWN ON THIS SHEET IS FOR THE FIRST PHASE FIBER CONNECTIONS TO KEEP CONNECTIVITY THROUGH CONSTRUCTION. SEE SHEET SCP-07 FOR FINAL CABLE INSTALLATIONS ONCE THE SIGNAL MAST ARMS ARE INSTALLED.

NOTES:

1. FOR THE EXISTING CCTV CAMERA LOCATION, AND THE FIBER DROP FROM THE CALLABRIDGE CT. INTERSECTION, THE CONTRACTOR SHALL INSTALL THE TEMPORARY CABLE CONNECTION FOR BOTH TO THE TEMPORARY SIGNAL POLE AND LASH TO THE SIGNAL SPAN WIRE ACROSS BROOKSHIRE BLVD. AND THEN MT. HOLLY-HUNTERSVILLE RD. TO SPLICE #3, AS SHOWN. THE CONTRACTOR SHALL KEEP THE CCTV CAMERA OPERATIONAL FOR LONG AS POSSIBLE, INSTALL NEW CCTV CAMERA WHEN SIGNAL MAST ARM IS IN PLACE - SEE SIGNAL PLANS AND SCP-07. THE CONTRACTOR SHALL THEN REMOVE THE EXISTING CCTV CAMERA INSTALLATION (INCLUDING CABINET, METAL POLE AND FOUNDATION), AND RETURN THE CAMERA, CABINET AND METAL POLE TO THE CITY OF FAYETTEVILLE.

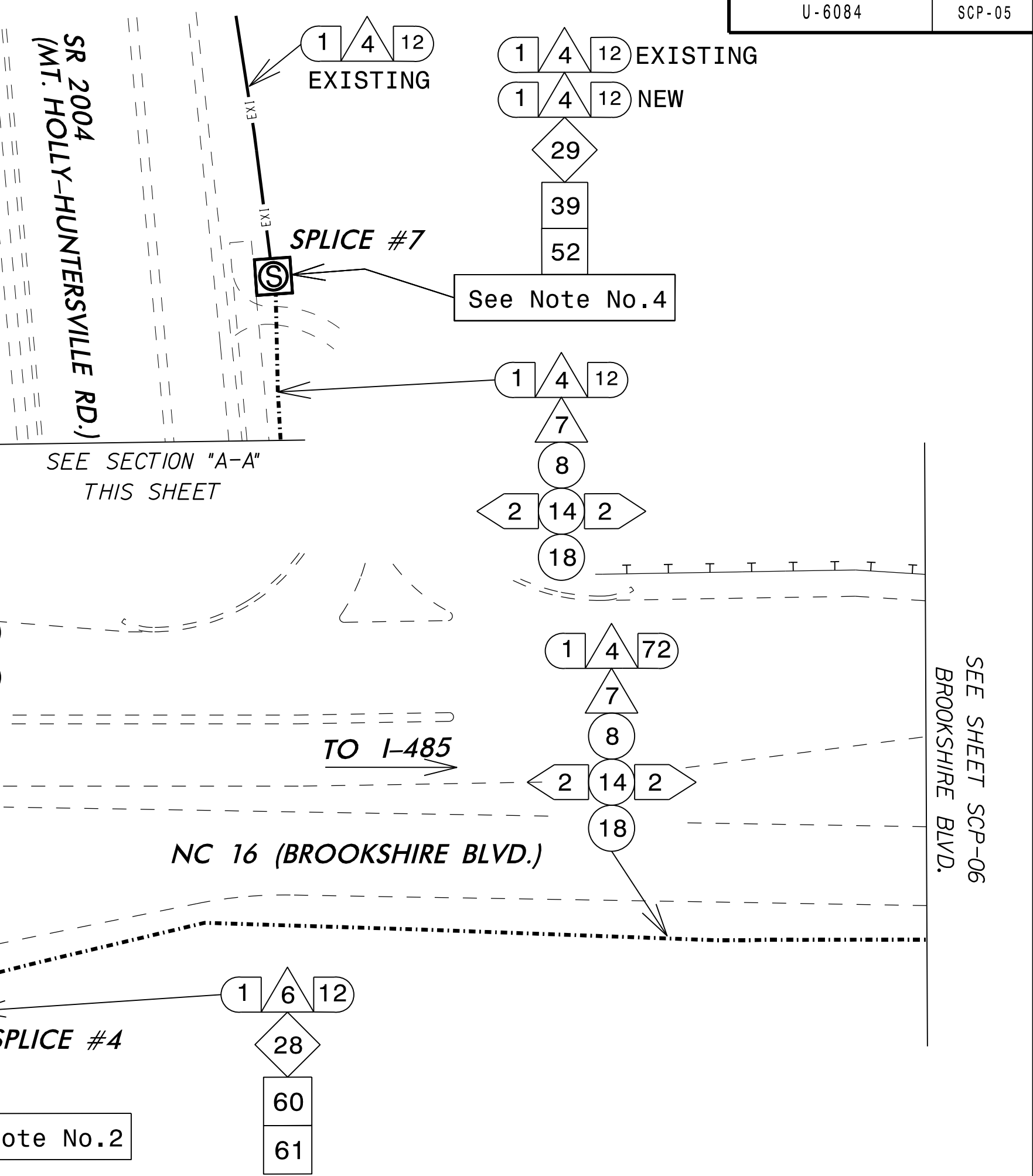

SEE SHEET SCP-04 BROOKSHIRE BLVD.

SEE SHEET SCP-06 BROOKSHIRE BLVD.

NOTES:

- 2. FOR SPLICE #4, THE CONTRACTOR SHALL SPLICE THE 12F DROP CABLE FOR THE SIGNAL AT THE EAST CROSSOVER TO THE 72F BACKBONE CABLE
3. FOR SPLICE #6, THE CONTRACTOR SHALL LOCATE THE EXISTING 12F TRUNK CABLE OUTSIDE THE CONSTRUCTION ZONE, THAT INTERCONNECTS WITH THE ROZZELLES FERRY INTERSECTION AND SPLICE TO THE NEW 12F TRUNK CABLE. ABANDON THE EXISTING CONDUIT WITHIN THE CONSTRUCTION ZONE. CONTINUE NEW CONDUIT AND FIBER INSTALLATION ALONG MT. HOLLY-HUNTERSVILLE RD. TO JB-2, AS SHOWN.
4. FOR SPLICE #7, THE CONTRACTOR SHALL LOCATE THE EXISTING 12F TRUNK CABLE OUTSIDE THE CONSTRUCTION ZONE, THAT INTERCONNECTS WITH THE CALLABRIDGE CT. INTERSECTION AND SPLICE TO THE NEW 12F TRUNK CABLE. ABANDON THE EXISTING CONDUIT WITHIN THE CONSTRUCTION ZONE. CONTINUE CONDUIT AND FIBER INSTALLATION ALONG MT. HOLLY-HUNTERSVILLE RD. TO JB-3, AS SHOWN.
5. THE CONTRACTOR WILL NEED TO ACCOUNT FOR ADDITIONAL FIBER CABLE MAINTENANCE LOOPS FOR THE AERIAL CABLES, OR PULL BACK THIS CABLE FOR THE FINAL BUILD-OUT BURIED CONDUIT.

Legend table with 64 items detailing cable types, conduit, junction boxes, and camera assemblies. Includes symbols for proposed and existing conduits, fiber optic cables, and various hardware components.

Stantec logo and contact information: Stantec Consulting Services Inc., 801 Jones Franklin Road, Suite 300, Raleigh, NC 27606.

TMP Phase I

Project title block: TMP PHASE I - TEMPORARY AERIAL CABLE ROUTING PLANS. Includes plan date (2017), reviewed by (D. HARRIS), and signature of Betty L. Watson dated 1/23/2018.