

SURVEY CONTROL SHEET U-6084

PROJECT REFERENCE NO. U-6084	SHEET NO. IC-2
Location and Surveys	

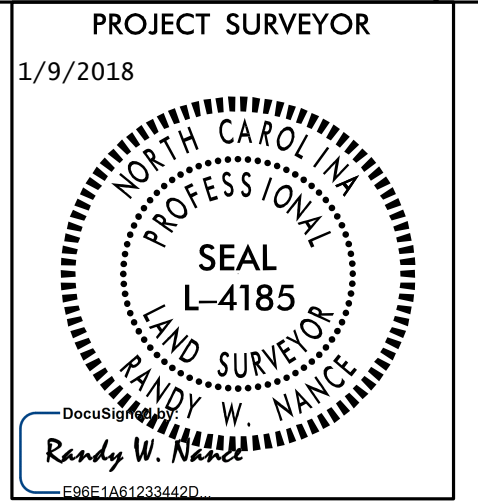

-L-

PI Sta 22+54.02
 $\Delta = 6^{\circ} 48' 36.0''$ (RT)
 $D = 0^{\circ} 29' 44.3''$
 $L = 1,373.98'$
 $T = 687.80'$
 $R = 11,560.00'$
 $SE = EXIST$

BEGIN TIP PROJECT U-6084
-L- Sta. 16 + 35.00
BROOKSHIRE BLVD.

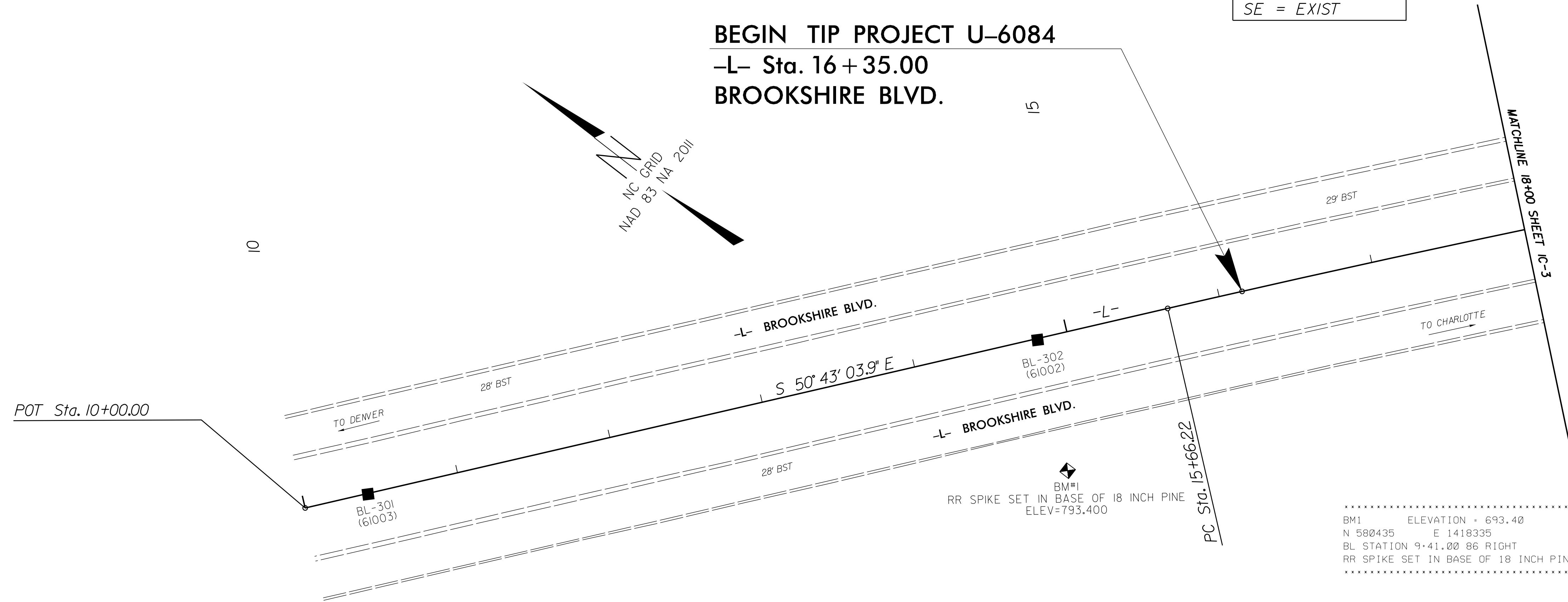

.....
 BM1 ELEVATION = 693.40
 N 580435 E 1418335
 BL STATION 9+41.00 86 RIGHT
 RR SPIKE SET IN BASE OF 18 INCH PINE

TYPE	STATION	NORTH	EAST
POT	10+00.00	580806.3753	1418017.4362
PC	15+66.22	580447.8784	1418455.7110
PT	29+40.20	579516.8712	1419465.0850
POT	50+66.24	577985.1563	1420939.4874

DATUM DESCRIPTION

THE LOCALIZED COORDINATE SYSTEM DEVELOPED FOR THIS PROJECT IS BASED ON THE STATE PLANE COORDINATES ESTABLISHED BY NCGS FOR MONUMENT "M 030" WITH NAD 83/NA 2011 STATE PLANE GRID COORDINATES OF NORTHING: 579273.29(ft) EASTING: 1419723.98(ft) ELEVATION: 732.03(ft)

THE AVERAGE COMBINED GRID FACTOR USED ON THIS PROJECT (GROUND TO GRID) IS: 0.999843326

THE N.C. LAMBERT GRID BEARING AND LOCALIZED HORIZONTAL GROUND DISTANCE FROM "M 030" TO -L- STATION 16+15.00 IS N 47°05'50.9" W 1679.939'

ALL LINEAR DIMENSIONS ARE LOCALIZED HORIZONTAL DISTANCES VERTICAL DATUM USED IS NAVD 88

NOTE: PROJECT COORDINATES ARE BASED ON SURVEY BY THE ISAACS GROUP IN APRIL, 2016. SEE FILE #15023-RW-050817 FOR MORE DETAILS.

NOTES:

1. ORIGINAL SURVEY CONTROL FOR THIS PROJECT WAS SURVEYED BY THE ISAACS GROUP IN MAY, 2017 (FILE 15023-RW-050817). SIX OF THEIR CONTROL POINTS WERE HELD AND A CONTROL TRAVERSE AND LEVELS WERE PERFORMED TO NCDOT L&S STANDARDS.

2. GPS DATA WAS NOT PROVIDED BY THE ISAACS GROUP.

- INDICATES BASELINE MONUMENTS FOR HORIZONTAL PROJECT CONTROL
- ❖ INDICATES BENCHMARKS FOR VERTICAL CONTROL

BL	POINT	DESC.	NORTH	EAST	ELEVATION	L STATION	OFFSET
	301	61003	580779.9370	1418048.9480	708.32	10+41.13	0.51 RT
	302	61002	580501.3940	1418388.8440	695.41	14+80.58	0.91 RT
	303	61001	580178.5450	1418772.4540	694.98	19+82.02	0.45 RT
	304	61000	579842.1370	1419140.9180	708.57	24+80.98	1.14 LT
	305	20001	579491.2750	1419491.7190	725.30	29+77.12	1.44 LT
	306	20000	579268.7950	1419848.7020	735.50	33+84.97	104.34 LT
	307	20003	578895.3710	1419931.3310	735.26	37+11.31	95.10 RT
	308	4000	578683.1990	1420254.5140	729.39	40+88.30	9.40 RT
	309	4002	578193.4930	1420729.3570	712.96	47+70.41	6.91 RT

NOTE: DRAWING NOT TO SCALE