

FOUNDATION NOTES:

THE SPREAD FOOTINGS AT END BENT NO.1 AND END BENT NO.2 ARE DESIGNED FOR A FACTORED RESISTANCE OF 3.5 TSF. CHECK FIELD CONDITIONS FOR THE REQUIRED RESISTANCE OF 8 TSF JUST BEFORE PLACING CONCRETE.

SEE ROADWAY PLANS AND SPECIAL PROVISIONS FOR THE SETTLEMENT GAUGES REQUIRED AT END BENT NO.1 AND END BENT NO.2.

OBSERVE A ONE MONTH WAITING PERIOD AFTER CONSTRUCTING THE END BENT RETAINING WALL UP TO THE BOTTOM OF FOOTING ELEVATION BEFORE BEGINNING CONSTRUCTION OF THE FOOTING AND CAP AT END BENT NO.1 AND END BENT NO.2. FOR BRIDGE WAITING PERIODS, SEE ROADWAY PLANS AND SPECIAL PROVISIONS.

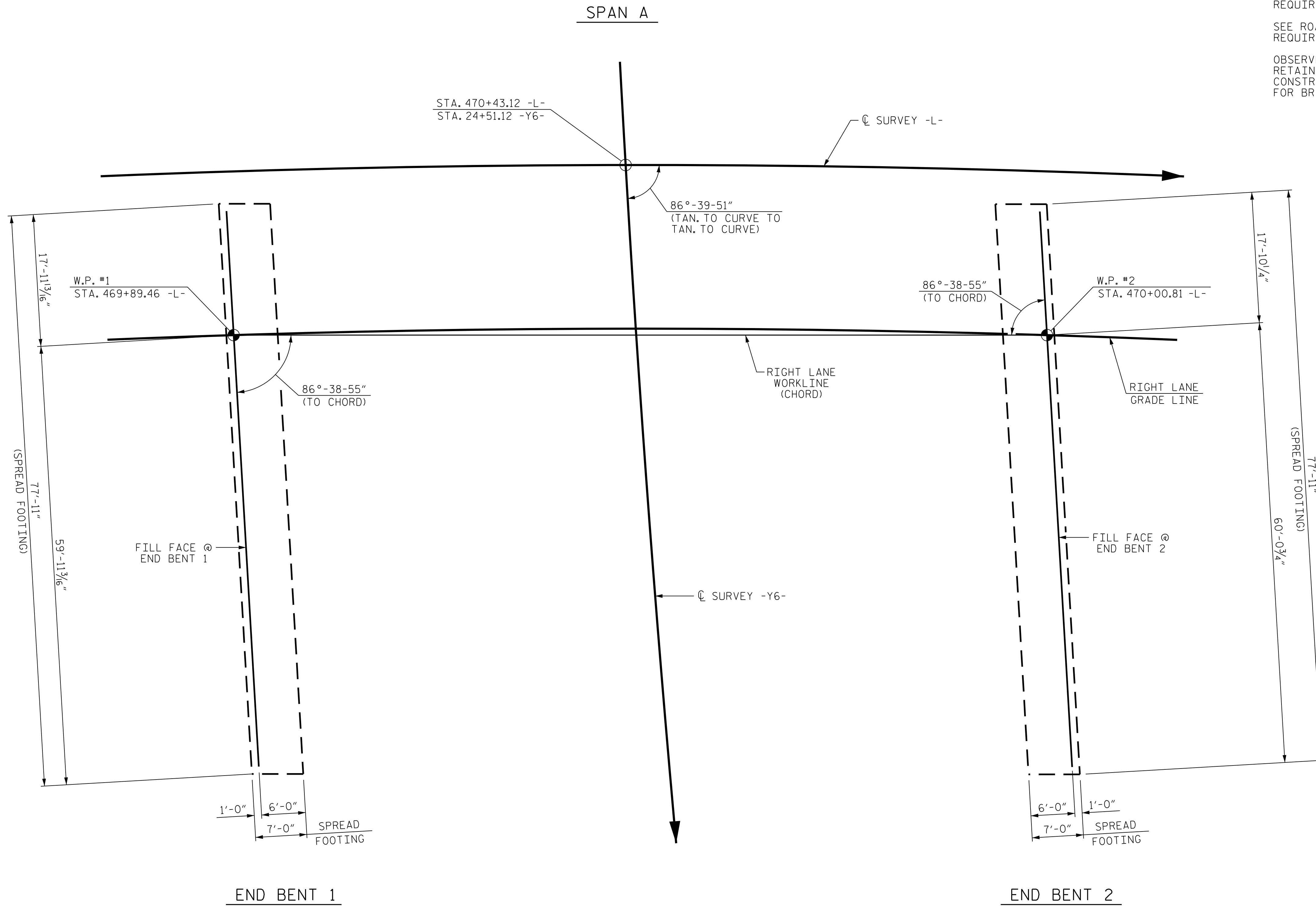

FOUNDATION LAYOUT

PROJECT NO. U-2525C
GUILFORD COUNTY
 STATION: 470+43.12 -L-
24+51.12 -Y6-
 SHEET 2 OF 5

STATE OF NORTH CAROLINA
 DEPARTMENT OF TRANSPORTATION
 RALEIGH

GENERAL DRAWING
 FOR BRIDGE ON I-85 BYPASS
 OVER NORTH ELM STREET
 BETWEEN SR 2523 AND US 220

RIGHT LANE

| REVISIONS | | | | | | SHEET NO. |
|-----------|-----|-------|-----|-----|-------|--------------|
| NO. | BY: | DATE: | NO. | BY: | DATE: | S9-2 |
| 1 | | | 3 | | | TOTAL SHEETS |
| 2 | | | 4 | | | 32 |

PLANS PREPARED BY:
SEALEY & ASSOCIATES
 5640 Dillard Drive
 Suite 200
 Cary, NC 27518
 (919) 852-0468
 (919) 852-0538 (Fax)
 www.simpsonengr.com
 LICENSURE NO. C-2521



**DOCUMENT NOT CONSIDERED FINAL
 UNLESS ALL SIGNATURES COMPLETED**

\$DATE\$ \$TIME\$ \$FILE\$

DRAWN BY: R. SEALEY DATE: 8-17
 CHECKED BY: M.A. AVERETTE DATE: 8-17
 DESIGN ENGINEER OF RECORD: M.A. AVERETTE DATE: 8-17