

PLAN OF WING 1

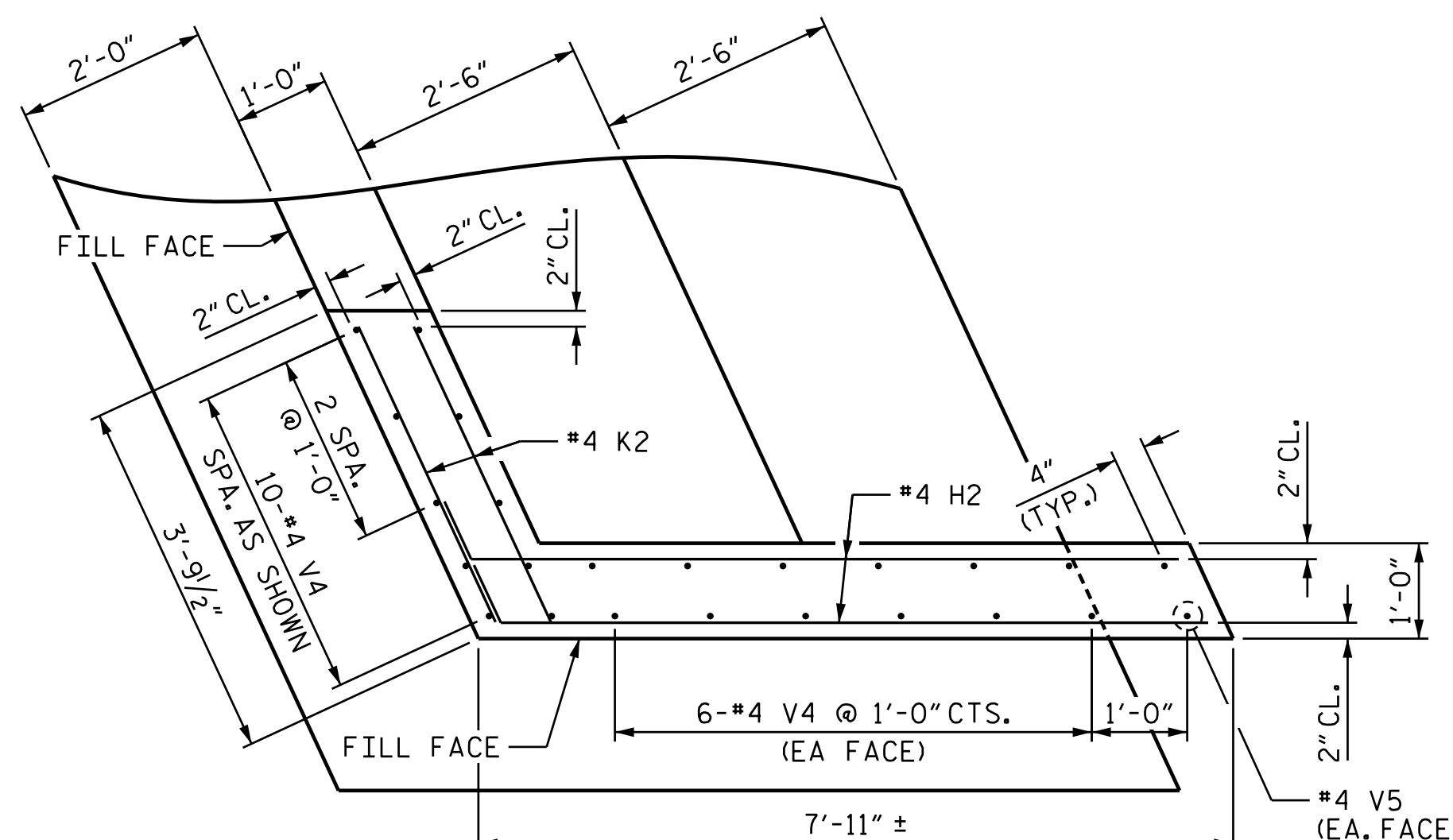

PLAN OF WING 2

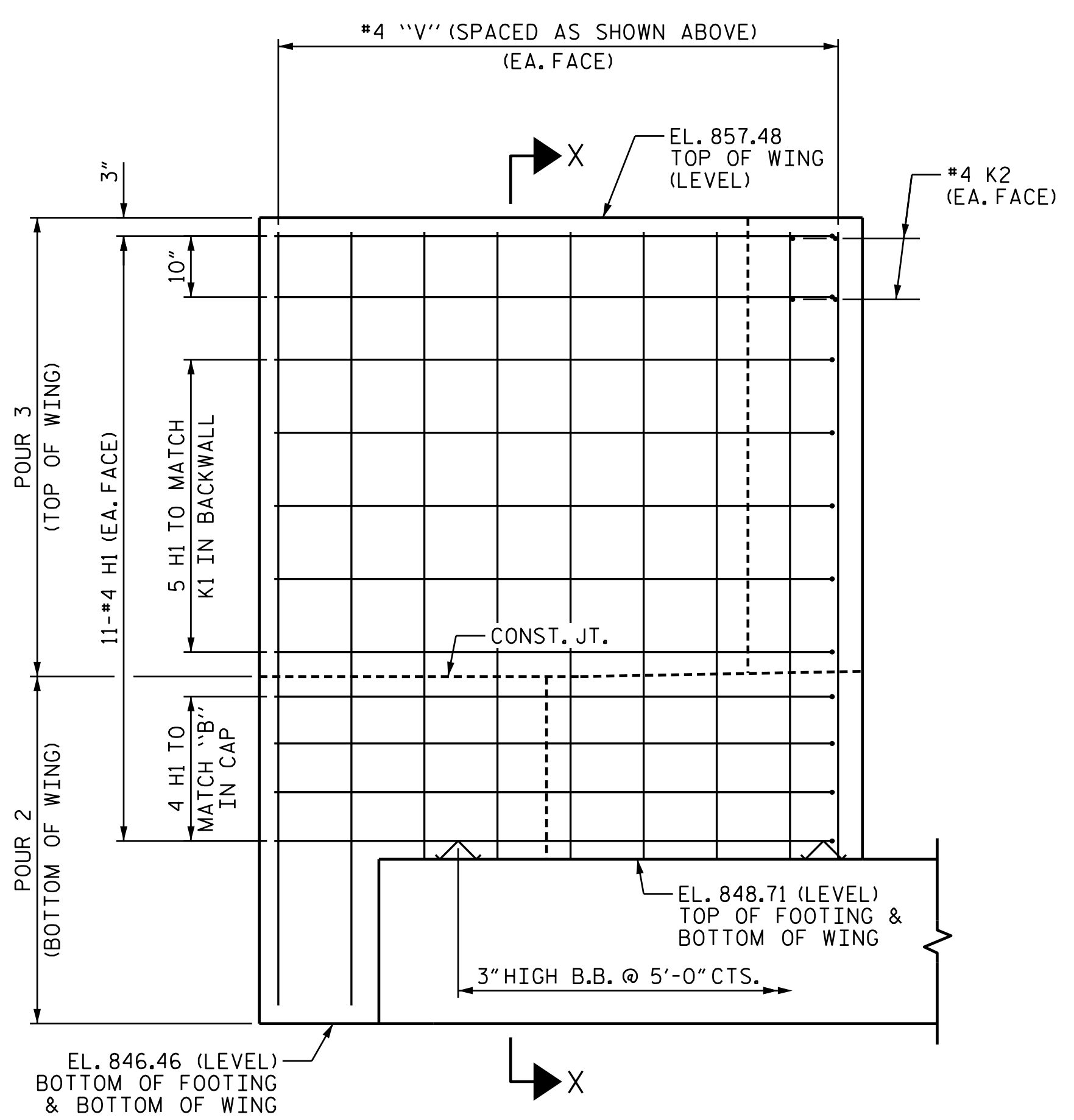

ELEVATION OF WING 1

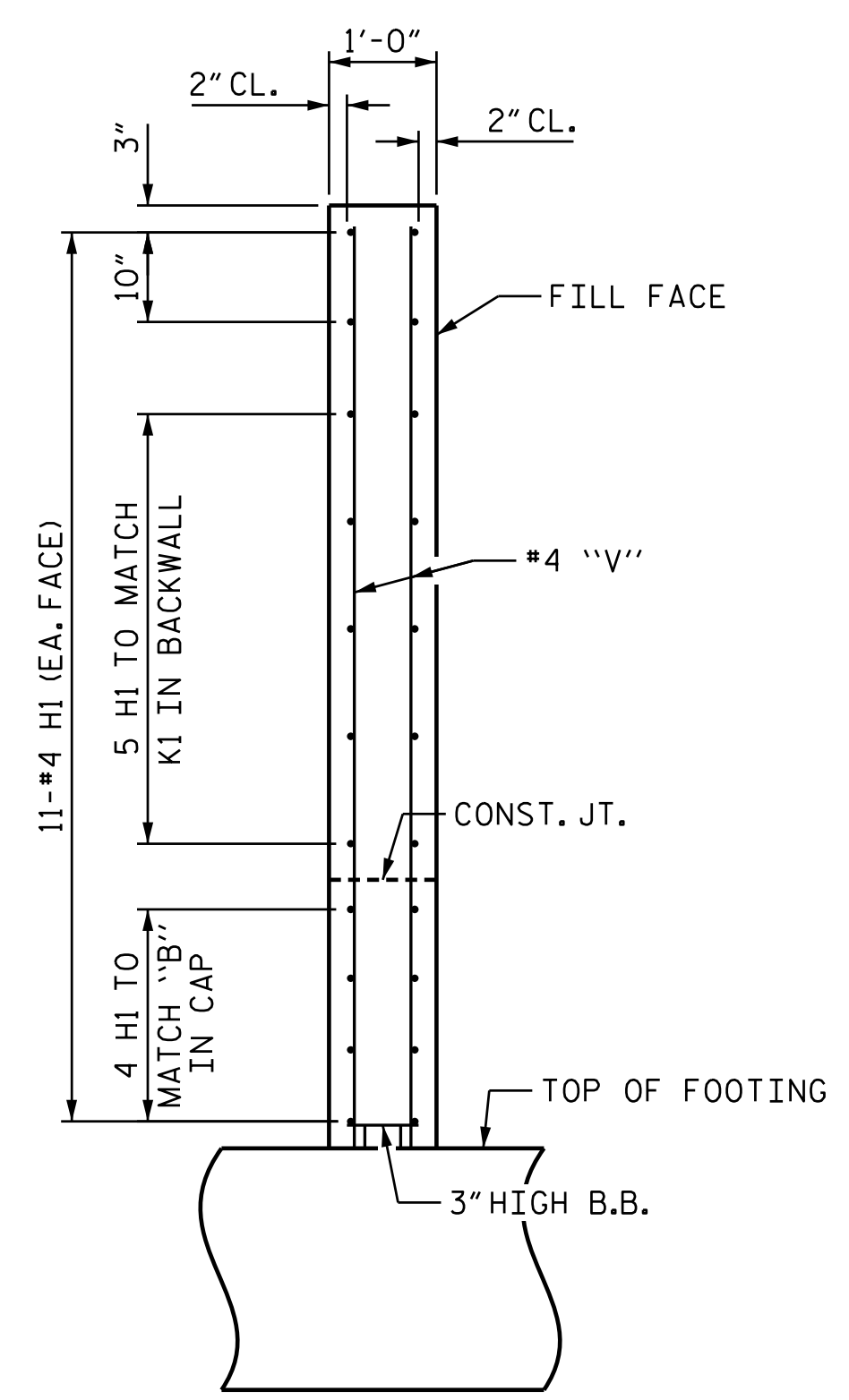

SECTION X-X

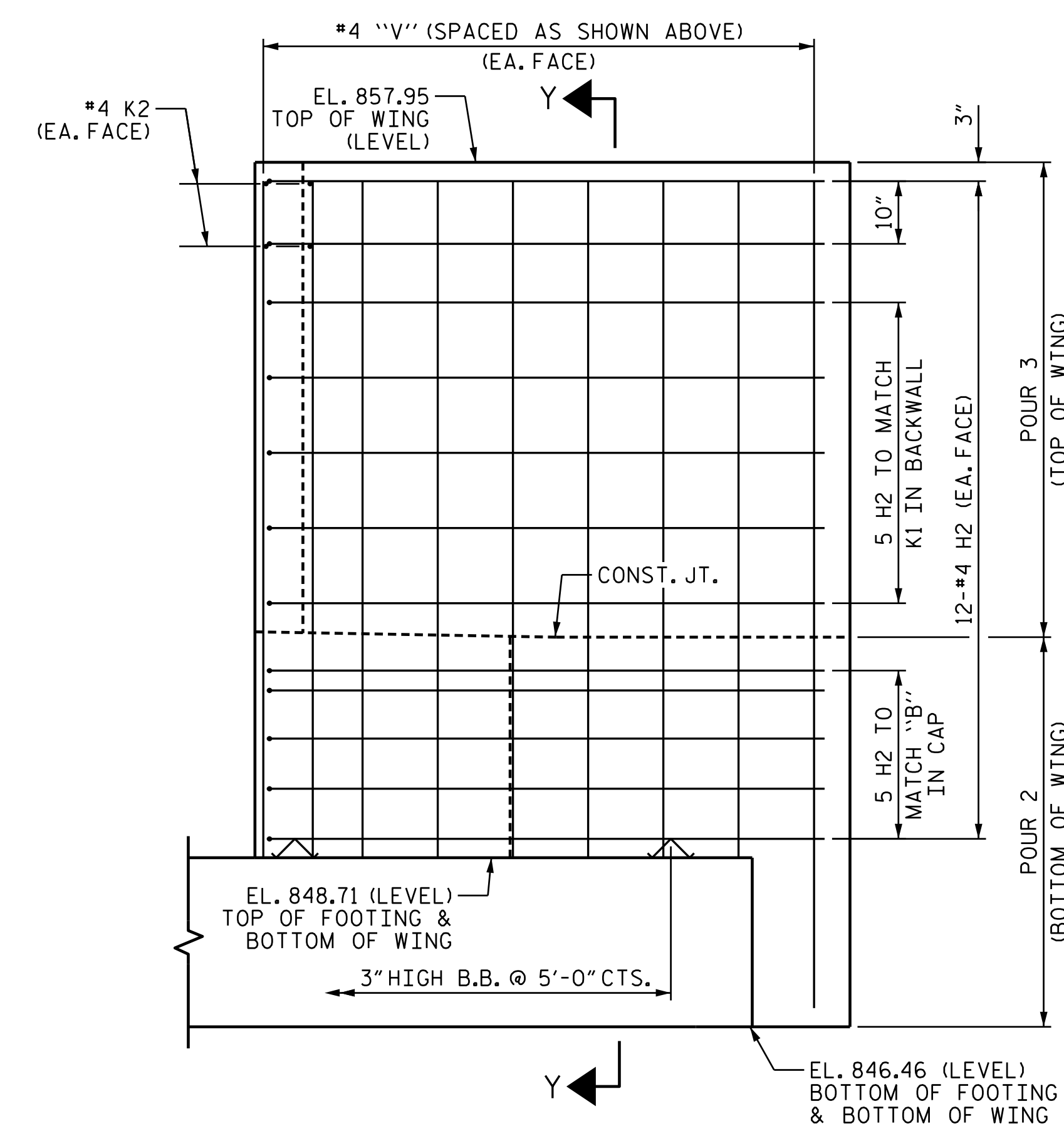

ELEVATION OF WING 2

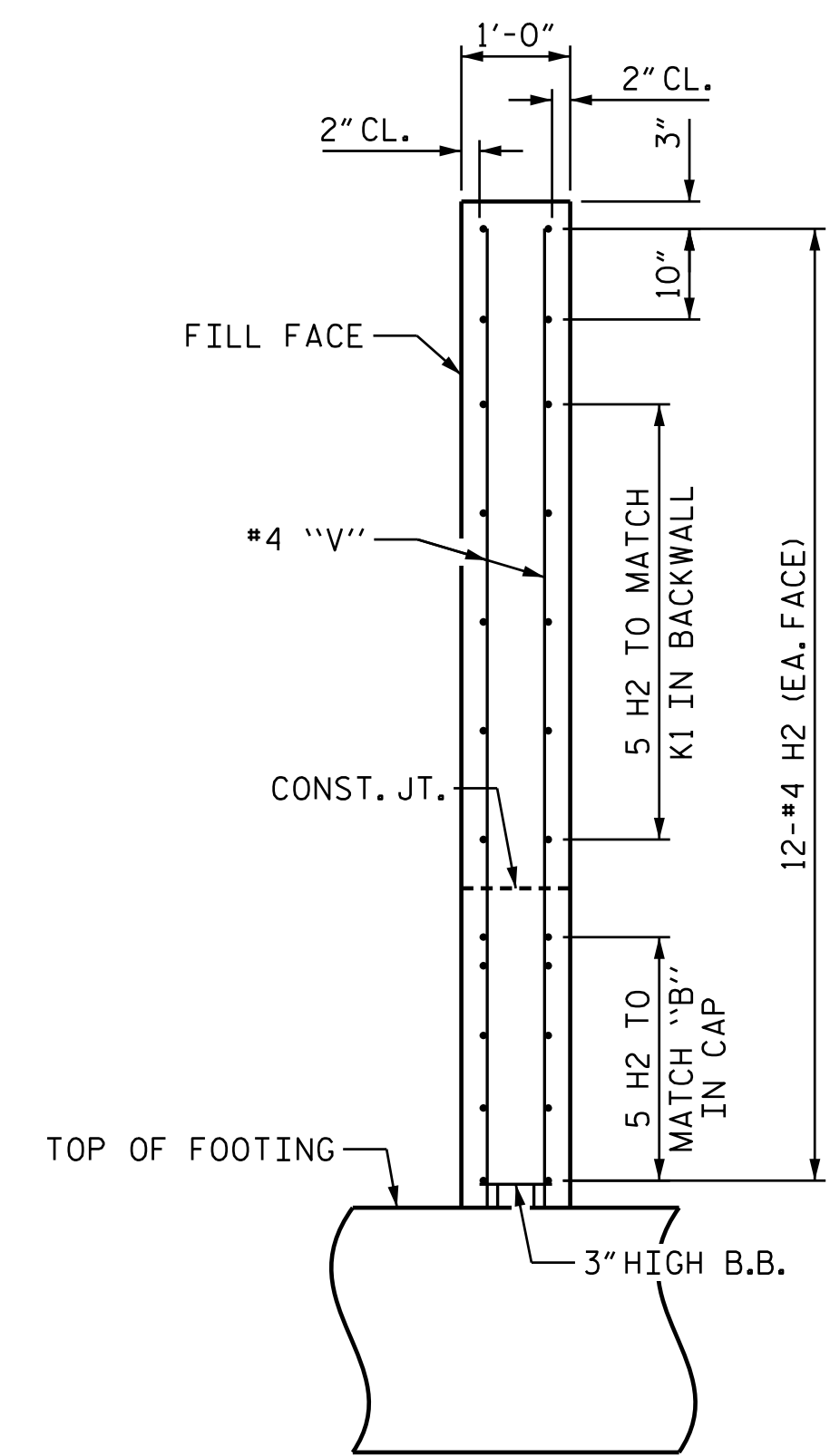

SECTION Y-Y

PROJECT NO. U-2525C  
 GUILFORD COUNTY  
 STATION: 22+29.98 -Y5-

SHEET 2 OF 3

STATE OF NORTH CAROLINA  
 DEPARTMENT OF TRANSPORTATION  
 RALEIGH  
 SUBSTRUCTURE  
 END BENT 1

REVISIONS						SHEET NO.
NO.	BY:	DATE:	NO.	BY:	DATE:	S7-19
1			3			TOTAL SHEETS
2			4			28

DOCUMENT NOT CONSIDERED FINAL UNLESS ALL SIGNATURES COMPLETED

PLANS PREPARED BY:  
**M** MOTT MACDONALD  
 PO Box 700  
 Fuquay-Varina, NC 27526  
 (919) 552-2253  
 www.mottmac.com  
 LICENSE NO. F-0669

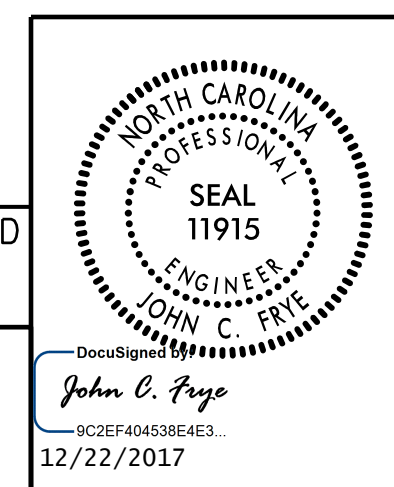

157077  
 12/21/2017 3:37:50 PM  
 C:\Users\Y5\_North\_Church\_St\Plans\U-2525C-SMU-EL-401246.dgn

DRAWN BY: R. H. BRAINARD DATE: 11-2017  
 CHECKED BY: J. E. MONDOLFI DATE: 11-2017  
 DESIGN ENGINEER OF RECORD: J. E. MONDOLFI DATE: 12-2017