

BENCH MARK #3 : N 875011, E 1776909 -BY1A- STA. 11+32.41, 111.18' LEFT, ELEV. 853.86

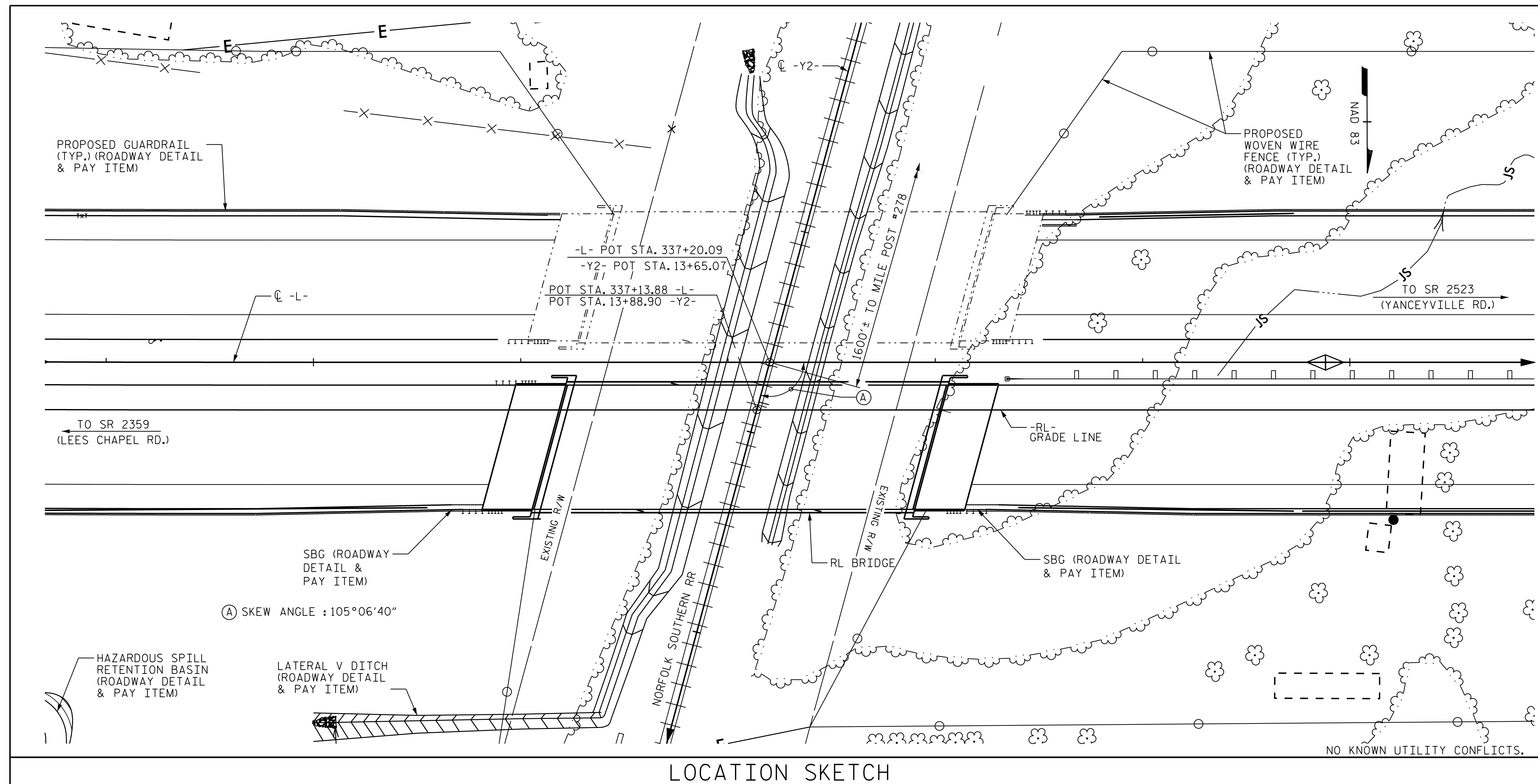

NOTES:

- ASSUMED LIVE LOAD = HL-93 OR ALTERNATE LOADING.
- THIS BRIDGE HAS BEEN DESIGNED IN ACCORDANCE WITH THE AASHTO LRFD BRIDGE DESIGN SPECIFICATIONS.
- THIS BRIDGE IS LOCATED IN SEISMIC ZONE 1.
- FOR OTHER DESIGN DATA AND GENERAL NOTES, SEE SHEET SN.
- FOR SUBMITTAL OF WORKING DRAWINGS, SEE SPECIAL PROVISIONS.
- THE CLASS AA CONCRETE IN THE BRIDGE DECK SHALL CONTAIN FLY ASH OR GROUND GRANULATE BLAST FURNACE SLAG AT THE SUBSTITUTION RATE SPECIFIED IN ARTICLE 1024-1 AND IN ACCORDANCE WITH ARTICLES 1024-5 AND 1024-6 OF THE STANDARD SPECIFICATIONS. NO PAYMENT WILL BE MADE FOR THIS SITUATION AS IT IS CONSIDERED INCIDENTAL TO THE COST OF THE REINFORCED CONCRETE DECK SLAB.
- FOR MAINTENANCE AND PROTECTION OF TRAFFIC BENEATH PROPOSED STRUCTURE, SEE SPECIAL PROVISIONS.
- FOR CRANE SAFETY, SEE SPECIAL PROVISIONS.
- FOR GROUT FOR STRUCTURES, SEE SPECIAL PROVISIONS.
- REMOVABLE FORMS MAY BE USED IN LIEU OF METAL STAY-IN-PLACE FORMS IN ACCORDANCE WITH ARTICLE 420-3 OF THE STANDARD SPECIFICATIONS.
- THE RAILROAD TRACK TOP OF RAIL ELEVATIONS SHOWN ON THE PLANS ARE FROM THE BEST INFORMATION AVAILABLE. PRIOR TO BEGINNING BRIDGE CONSTRUCTION, VERIFY THE TOP OF RAIL ELEVATIONS AND REPORT ANY VARIATIONS TO THE ENGINEER. ANY PLAN REVISIONS NECESSARY TO ACHIEVE THE REQUIRED MINIMUM VERTICAL CLEARANCE WILL BE PROVIDED BY THE DEPARTMENT.
- NEEDLE BEAMS WILL NOT BE ALLOWED UNLESS OTHERWISE CALLED FOR ON THE PLANS OR APPROVED BY THE ENGINEER.
- THE LOCATION OF THE CONSTRUCTION JOINT IN THE DRILLED PIERS IS BASED ON AN APPROXIMATE GROUND LINE ELEVATION. IF THE CONSTRUCTION JOINT IS ABOVE THE ACTUAL GROUND ELEVATION, THE CONTRACTOR SHALL PLACE THE CONSTRUCTION JOINT 1 FT. BELOW THE GROUND LINE.
- FOR EROSION CONTROL MEASURES, SEE EROSION CONTROL PLANS.
- FOR FALSEWORK AND FORMWORK, SEE SPECIAL PROVISIONS.
- PRESTRESSED CONCRETE DECK PANELS MAY BE USED IN LIEU OF METAL STAY-IN-PLACE FORMS IN ACCORDANCE WITH ARTICLE 420-3 OF THE STANDARD SPECIFICATIONS.

LOCATION SKETCH

TOTAL BILL OF MATERIAL

	3'-6" Ø DRILLED PIERS IN SOIL	3'-6" DIA. DRILLED PIERS NOT IN SOIL	SID INSPECTIONS	SPT TESTING	CSL TESTING	REINFORCED CONCRETE DECK SLAB	GROOVING BRIDGE FLOORS	CLASS A CONCRETE	BRIDGE APPROACH SLABS	REINFORCING STEEL	SPIRAL COLUMN REINFORCING STEEL	45" PRESTRESSED CONC. GIRDERS	HP 12 X 53 STEEL PILES	PILE DRIVING EQUIPMENT SETUP FOR HP 12X53 STEEL PILES	CONCRETE BARRIER RAIL	4" CONCRETE SLOPE PROTECTION	ELASTOMERIC BEARINGS		
	LIN. FT.	LIN. FT.	EA.	EA.	EA.	SQ. FT.	SQ. FT.	CU. YDS.	LUMP SUM	LBS.	LBS.	NO.	LIN. FT.	NO.	LIN. FT.	EA.	SQ. YDS.	LUMP SUM	
SUPERSTRUCTURE						12,186	13,616		LUMP SUM			21	1,318.63		381.9		LUMP SUM		
END BENT No. 1								53.7		7,778			9	675.00	9	971			
BENT No. 1	165.00	15.00						77.2		32,835	7,325								
BENT No. 2	174.67	16.00						76.9		33,145	6,768								
END BENT No. 2								53.3		7,631			9	675.00	9	826			
TOTAL	339.67	31.00	8	8	8	12,186	13,616	261.1	LUMP SUM	81,389	14,093	21	1,318.63	18	1,350.00	18	381.9	1,797	LUMP SUM

PROJECT NO. U-2525C
GUILFORD COUNTY
 STATION: 337+20.09 -L-

SHEET 3 OF 4



Stantec Consulting Services Inc.
 801 Jones Franklin Road
 Suite 300
 Raleigh, NC 27606
 Tel. (919) 851-6866
 Fax. (919) 851-7024
 www.stantec.com
 License No. F-0672

DRAWN BY : J. E. HAGENBUSH DATE : 05-09-16
 CHECKED BY : V. E. FRAGA DATE : 05-17-17
 DESIGN ENGINEER OF RECORD : T. R. DUDECK DATE : 01/16/18

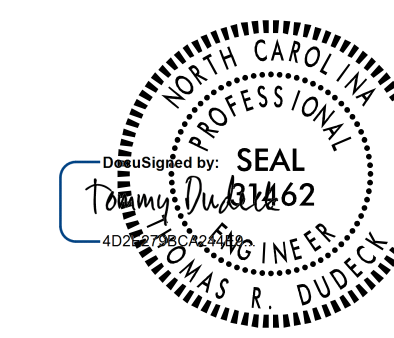

1/16/2018

DOCUMENT NOT CONSIDERED FINAL UNLESS ALL SIGNATURES COMPLETED

STATE OF NORTH CAROLINA
 DEPARTMENT OF TRANSPORTATION
 RALEIGH

GENERAL DRAWING
 FOR BRIDGE ON GEL I-85 BYPASS (-L-) OVER NORFOLK SOUTHERN RR (-Y2-) BETWEEN SR 2526 (SUMMIT AVE.) AND SR 2523 (YANCEYVILLE RD.)
 (RL)

REVISIONS						SHEET NO.
NO.	BY:	DATE:	NO.	BY:	DATE:	
1			3			S5-3
2			4			TOTAL SHEETS 38

1/12/2018 5:48:25 PM jgelle U:\Structures\Drawings\Site 5\Final\RL U-2525C-SD_CD_2.dgn