

PLAN OF WING 1

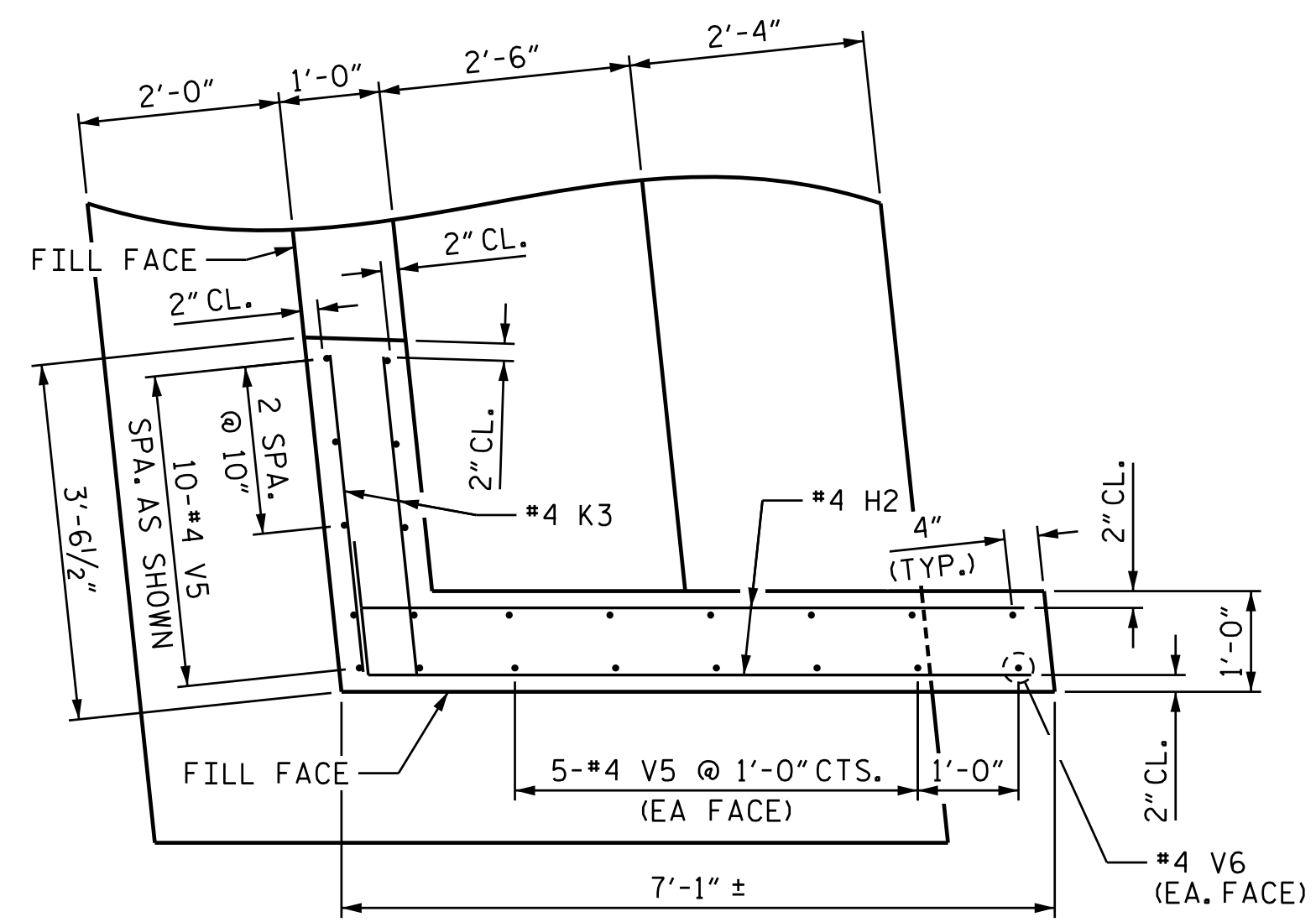

PLAN OF WING 2

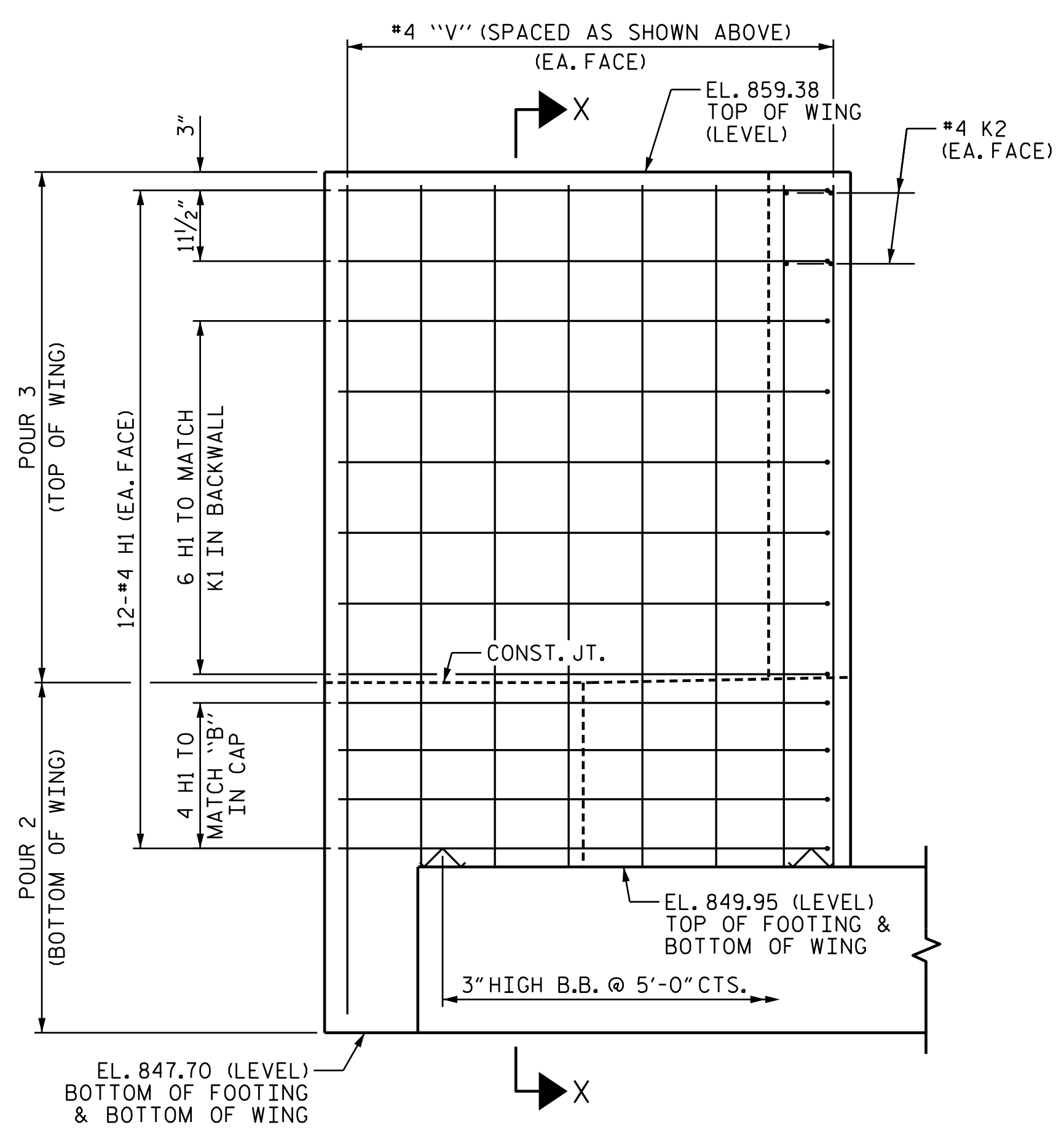

ELEVATION OF WING 1

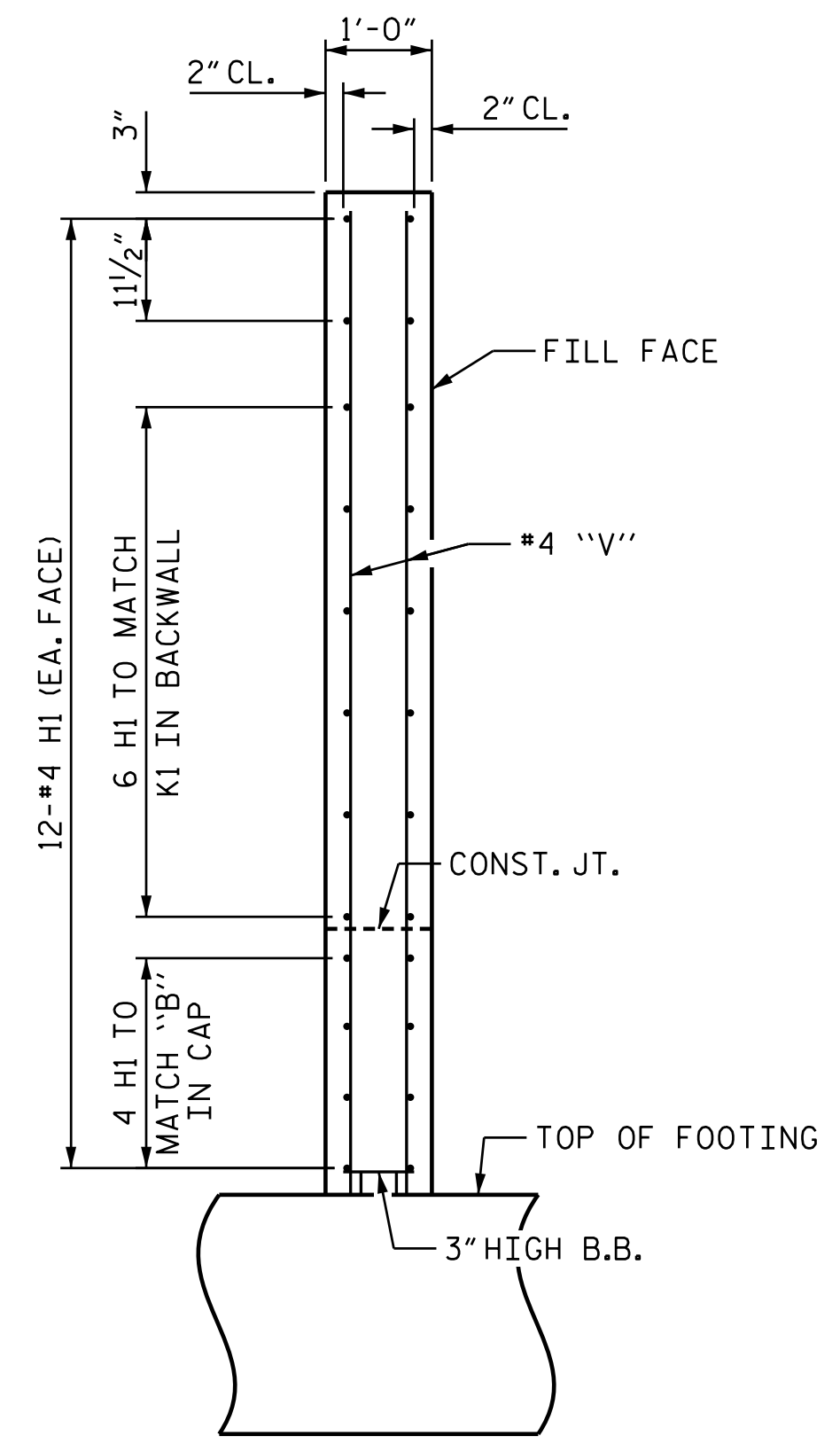

SECTION X-X

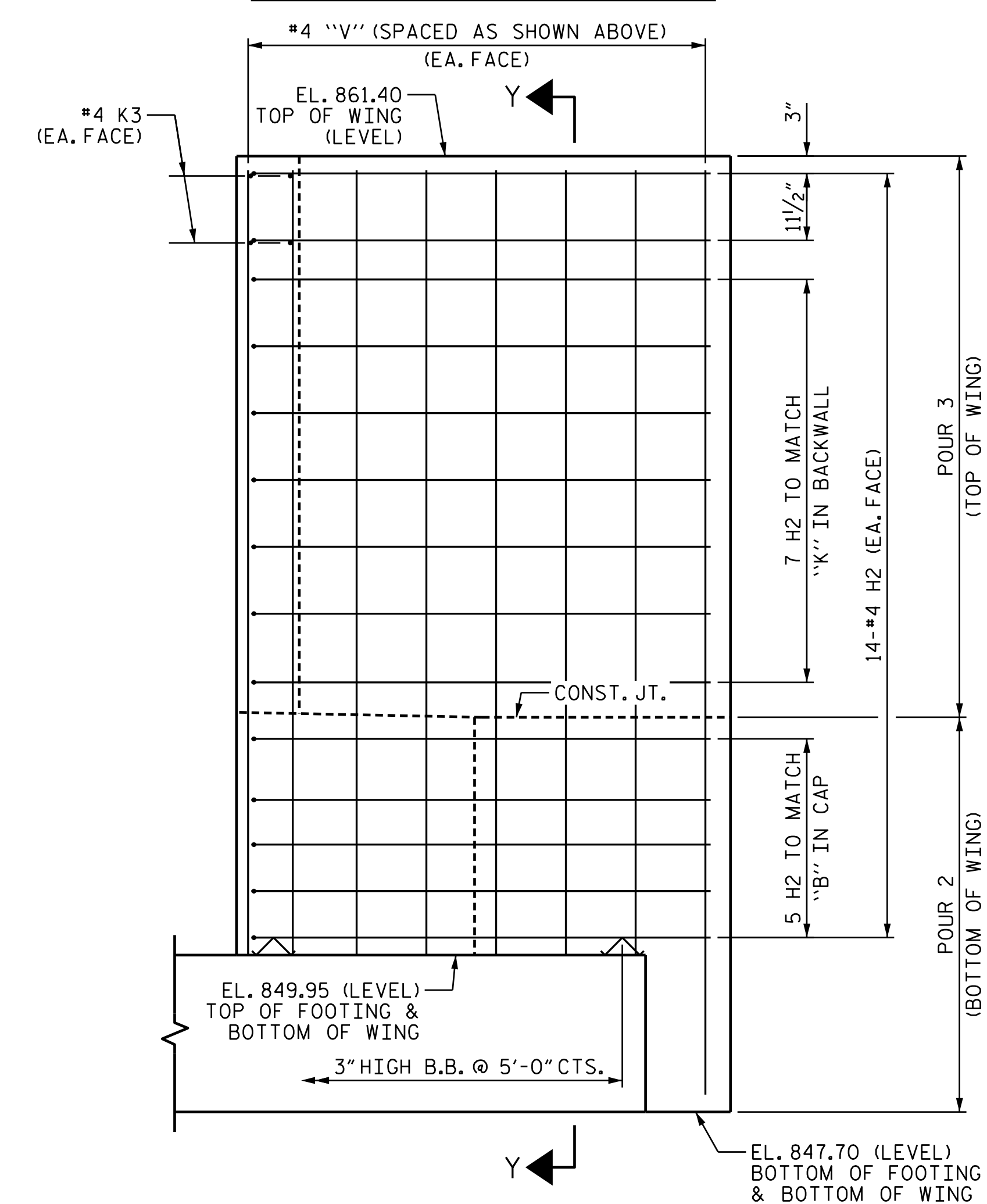

ELEVATION OF WING 2

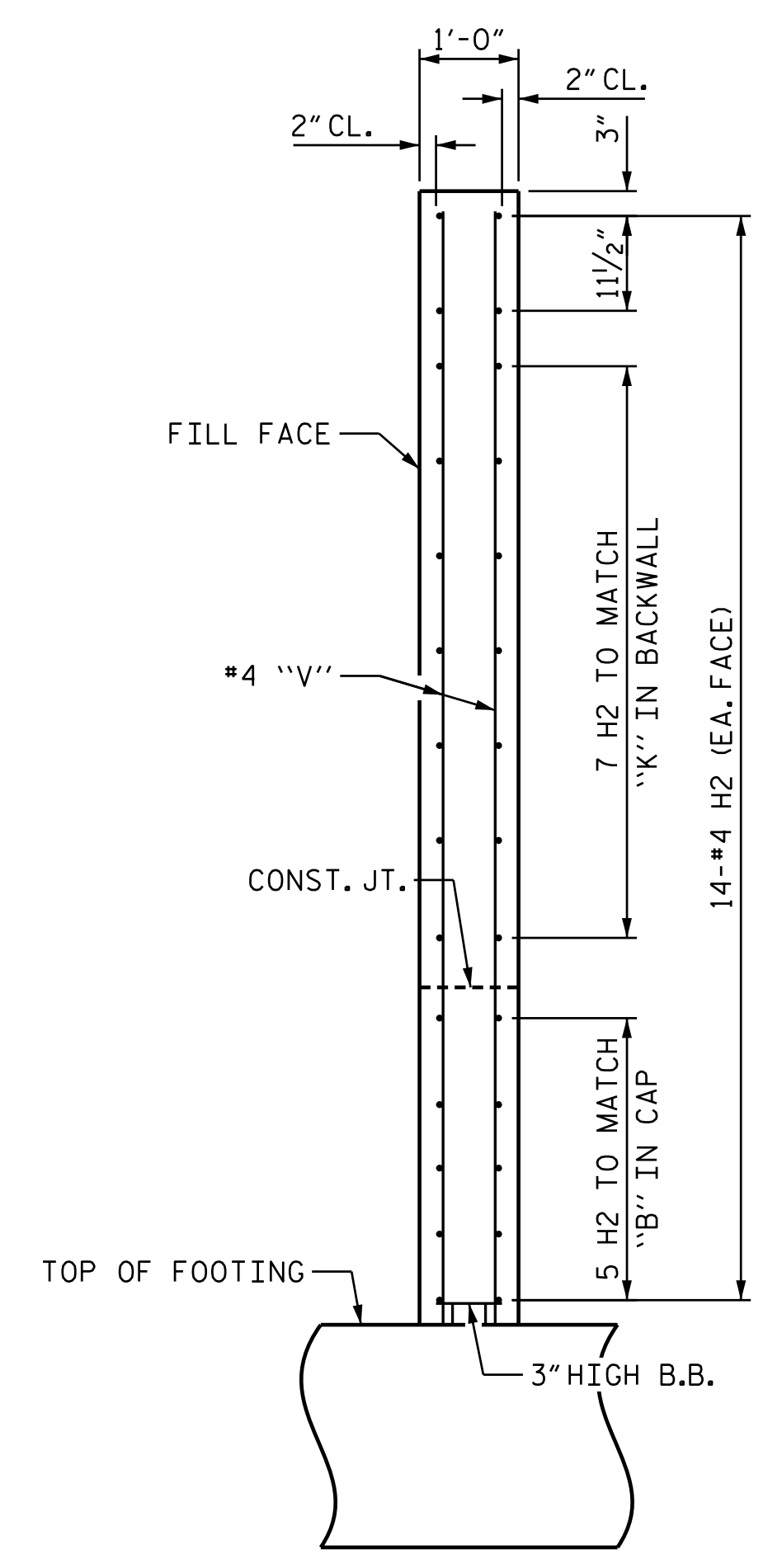

SECTION Y-Y

PROJECT NO. U-2525C
 GUILFORD COUNTY
 STATION: 17+37.28 -Y16-

SHEET 2 OF 3

STATE OF NORTH CAROLINA
 DEPARTMENT OF TRANSPORTATION
 RALEIGH

SUBSTRUCTURE
 END BENT 1

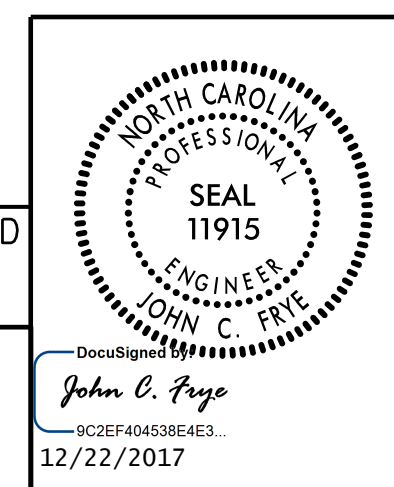

DOCUMENT NOT CONSIDERED
 FINAL UNLESS ALL
 SIGNATURES COMPLETED

PLANS PREPARED BY:
 MOTT MACDONALD

PO Box 700
 Fuquay-Varina, NC 27526
 (919) 552-2253
 www.mottmac.com
 LICENSE NO. F-0669

REVISIONS						SHEET NO.
NO.	BY:	DATE:	NO.	BY:	DATE:	S1-20
1			3			TOTAL SHEETS
2			4			29

11/27/2017 12:21:20 PM
 C:\Users\jwilliams\Documents\Projects\16_Summit_Ave\Plans\U-2525C_SML\EL_401240.dgn
 3:32:49 PM

DRAWN BY: J. T. WILLIAMS DATE: 9-2017
 CHECKED BY: J. E. MONDOLFI DATE: 9-2017
 DESIGN ENGINEER OF RECORD: J. E. MONDOLFI DATE: 11-2017