

**POURING SEQUENCE AND LAYOUT FOR COMPUTING AREA OF REINFORCED CONCRETE DECK SLAB**

( CONTINUOUS FOR LIVE LOAD ) (10,245 SF)

⊙ = INDICATES POUR NUMBER AND DIRECTION OF POUR

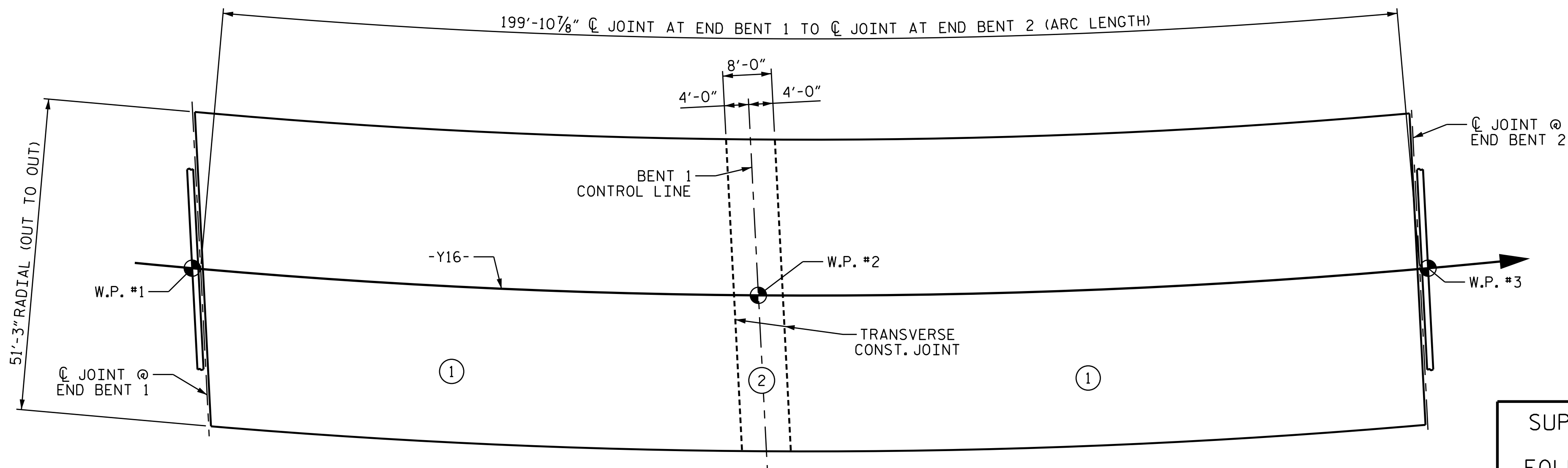

**OPTIONAL POURING SEQUENCE**

( CONTINUOUS FOR LIVE LOAD )

NOTE: POUR 2 CAN NOT BE STARTED UNTIL BOTH ADJACENT 1 POURS REACH A MINIMUM OF 3000 PSI.

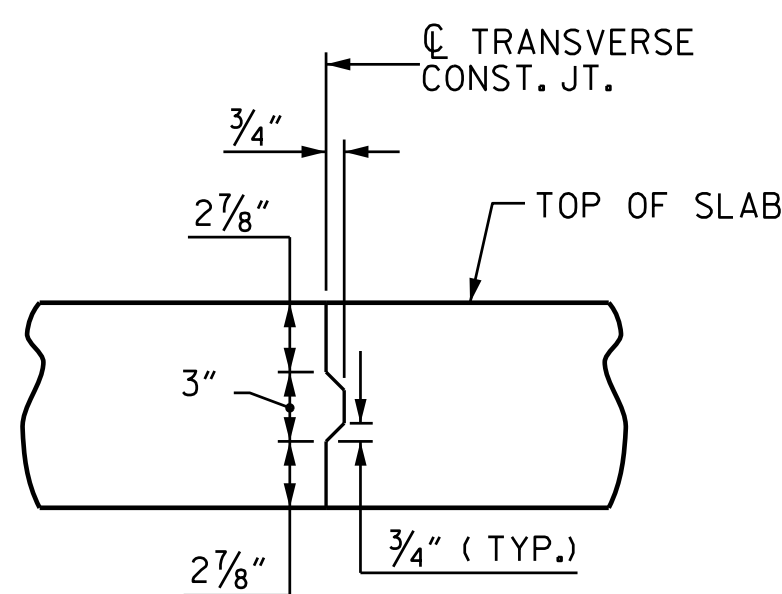

**TRANSVERSE CONSTRUCTION JOINT DETAIL**

NOTE: REINFORCING STEEL IN SLAB NOT SHOWN. LONGITUDINAL REINFORCING STEEL SHALL BE CONTINUOUS THRU JOINT

**BILL OF MATERIAL**

BAR	NO.	SIZE	TYPE	LENGTH	WEIGHT
*A1	83	#5	STR	51'-2"	4429
A2	83	#5	STR	51'-2"	4429
*A3	285	#5	STR	50'-11"	15135
A4	285	#5	STR	50'-11"	15135
B1	192	#5	STR	51'-6"	10313
*B2	34	#7	STR	30'-6"	2120
*B3	70	#7	STR	38'-2"	5461
*B4	105	#4	STR	21'-5"	1502
*B5	105	#4	STR	25'-5"	1783
*G1	1	#5	STR	51'-4"	54
*G2	1	#5	STR	50'-11"	53
*K1	8	#8	1	15'-8"	335
*K2	12	#8	2	25'-6"	817
*K3	16	#6	STR	7'-1"	170
K4	8	#4	STR	7'-4"	39
K5	32	#4	STR	10'-1"	216
K6	8	#4	STR	7'-1"	38
K7	12	#4	STR	24'-6"	196
*S1	64	#5	4	5'-9"	384
*S2	32	#4	5	3'-1"	66
*S3	32	#4	5	2'-7"	55
S4	176	#4	6	2'-9"	323
U1	8	#4	3	8'-11"	48
U2	32	#4	2	17'-0"	363
REINFORCING STEEL				LBS.	31,100
*EPOXY COATED REINFORCING STEEL				LBS.	32,364

**GROOVING BRIDGE FLOORS**

APPROACH SLABS	2,217 SQ.FT.
BRIDGE DECK	9,174 SQ.FT.
TOTAL	11,391 SQ.FT.

**BAR TYPES**

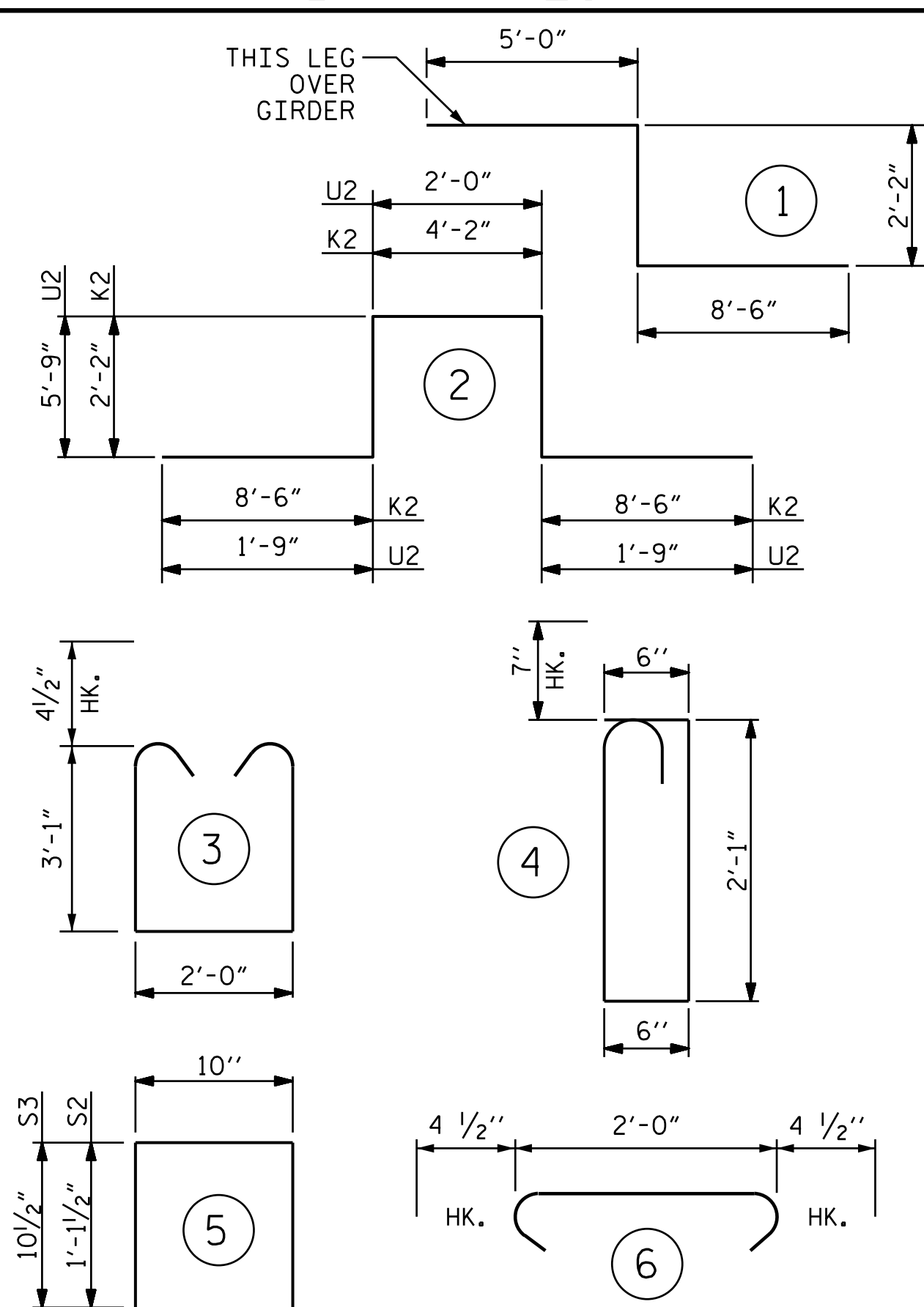

ALL BAR DIMENSIONS ARE OUT TO OUT

**SUPERSTRUCTURE BILL OF MATERIAL**

	CLASS AA CONCRETE ( CU. YDS. )	REINFORCING STEEL ( LBS. )	EPOXY COATED REINFORCING STEEL ( LBS. )
SPANS A & B		31,100	32,364
POUR 1	153.1		
POUR 2	224.6		
TOTALS**	377.7	31,100	32,364

\*\*QUANTITIES FOR BARRIER RAIL ARE NOT INCLUDED

**SUPERSTRUCTURE REINFORCING STEEL LENGTHS ARE BASED ON THE FOLLOWING MINIMUM SPLICE LENGTHS**

BAR SIZE	SUPERSTRUCTURE EXCEPT APPROACH SLABS, PARAPET, AND BARRIER RAIL		APPROACH SLABS		PARAPET AND BARRIER RAIL
	EPOXY COATED	UNCOATED	EPOXY COATED	UNCOATED	
#4	2'-0"	1'-9"	2'-0"	1'-9"	2'-9"
#5	2'-6"	2'-2"	2'-6"	2'-2"	3'-5"
#6	3'-0"	2'-7"	3'-10"	2'-7"	4'-4"
#7	5'-3"	3'-6"			
#8	6'-10"	4'-7"			

PROJECT NO. U-2525C  
GUILFORD COUNTY  
 STATION: 17+37.28 -Y16-

STATE OF NORTH CAROLINA  
 DEPARTMENT OF TRANSPORTATION  
 RALEIGH  
 SUPERSTRUCTURE  
 BILL OF MATERIAL

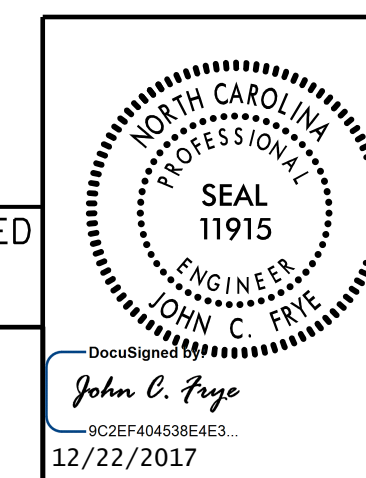

DOCUMENT NOT CONSIDERED FINAL UNLESS ALL SIGNATURES COMPLETED  
 PLANS PREPARED BY:  
**M** MOTT MACDONALD  
 PO Box 700 Fuquay-Varina, NC 27526  
 (919) 552-2253 www.mottmac.com  
 LICENSE NO. F-0669

**REVISIONS**

NO.	BY:	DATE:	NO.	BY:	DATE:
1			3		
2			4		

SHEET NO. S1-18  
 TOTAL SHEETS 29

157077  
 12/21/2017 3:32:43 PM  
 C:\Users\Y16\_Summit\_Ave\Plans\U-2525C-SML\BM\_401240.dgn

DRAWN BY: J. T. WILLIAMS DATE: 8-2017  
 CHECKED BY: J. E. MONDOLFI DATE: 8-2017  
 DESIGN ENGINEER OF RECORD: J. E. MONDOLFI DATE: 11-2017