

**-L-**

Pts Sta 435+13.54 $\Delta s = 0^\circ 45' 50.2''$ $L_s = 200.00'$ $LT = 133.33'$ $ST = 66.67'$	PI Sta 469+05.74 $\Delta = 47^\circ 49' 31.4''$ (RT) $D = 0^\circ 45' 50.2''$ $L = 6,260.33'$ $T = 3,325.53'$ $R = 7,500.00'$ $SE = .03$
--	--

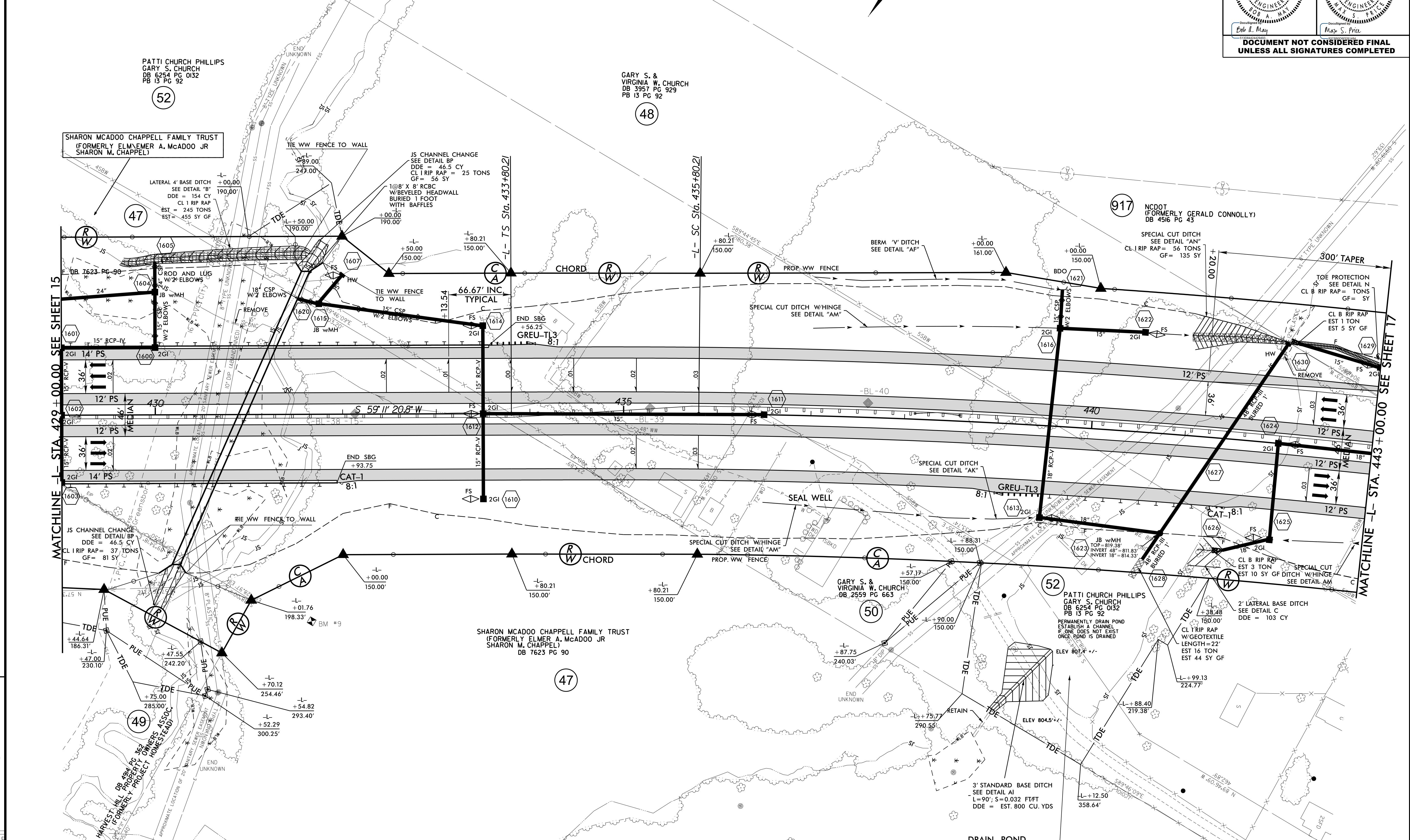
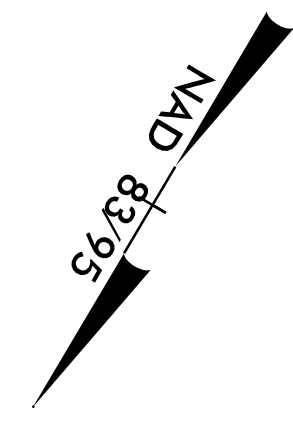

REVISIONS

MATCHLINE -L- STA. 429+00.00 SEE SHEET 15

MATCHLINE -L- STA. 443+00.00 SEE SHEET 17

12/27/2017 11:58:11 AM U-2525C-rdy-psh-16.dgn

**DRAIN POND**  
 -L- STA. 440+15 TO 441+97  
 310' RT. TO 92' LT.

SEE SHEETS 2D-1 THRU 2D-7 FOR DRAINAGE DETAILS  
 SEE SHEET 39 FOR -L- PROFILE  
 SEE SHEETS C3-1 THRU C3-5 FOR CULVERT PLANS