

**This electronic collection of documents is provided
for the convenience of the user
and is Not a Certified Document –**

**The documents contained herein were originally issued
and sealed by the individuals whose names and license
numbers appear on each page, on the dates appearing
with their signature on that page.**

**This file or an individual page
shall not be considered a certified document.**

6/23/16



PROJ. REFERENCE NO.	SHEET NO.
B-5374	X-1

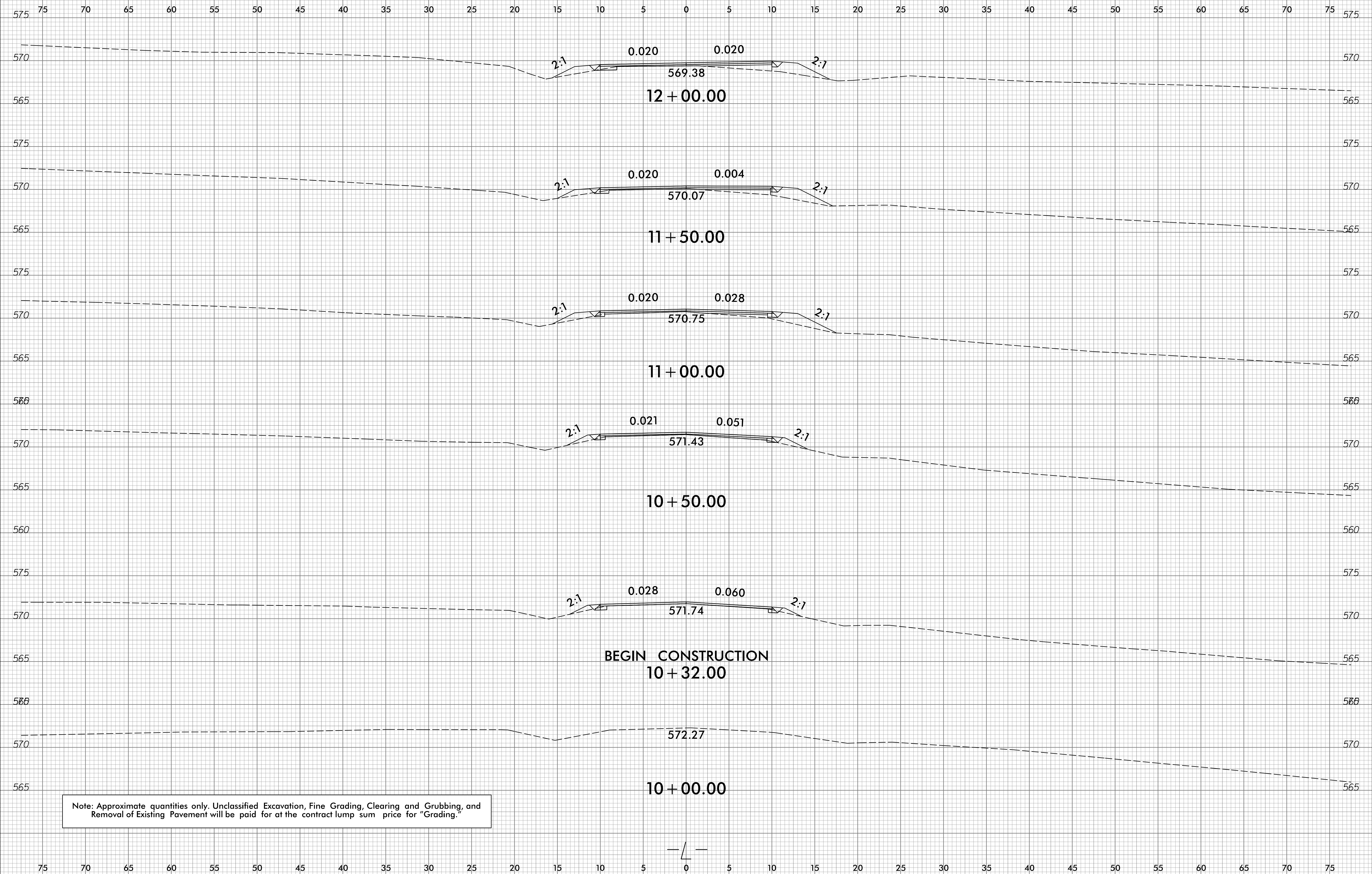

Note: Approximate quantities only. Unclassified Excavation, Fine Grading, Clearing and Grubbing, and Removal of Existing Pavement will be paid for at the contract lump sum price for "Grading."

2/7/2017
 G:\FA\8522-06\CADD\B5374\Roadway\Corridor-Modeling\B5374_rdy_xpl.dgn
 chulman

75 70 65 60 55 50 45 40 35 30 25 20 15 10 5 0 5 10 15 20 25 30 35 40 45 50 55 60 65 70 75

6/23/16



PROJ. REFERENCE NO.	SHEET NO.
B-5374	X-2

75 70 65 60 55 50 45 40 35 30 25 20 15 10 5 0 5 10 15 20 25 30 35 40 45 50 55 60 65 70 75

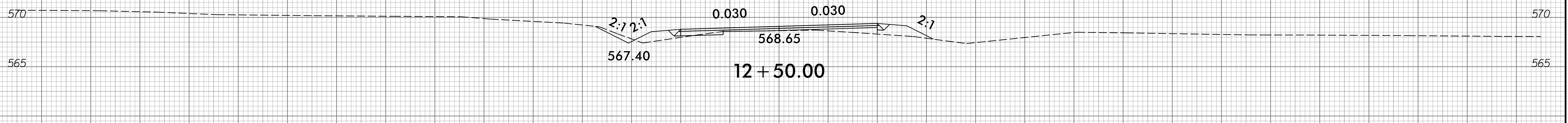
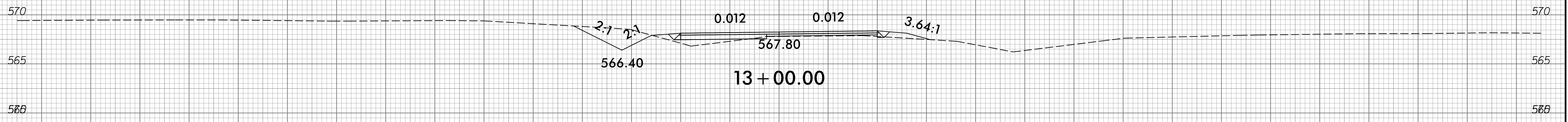
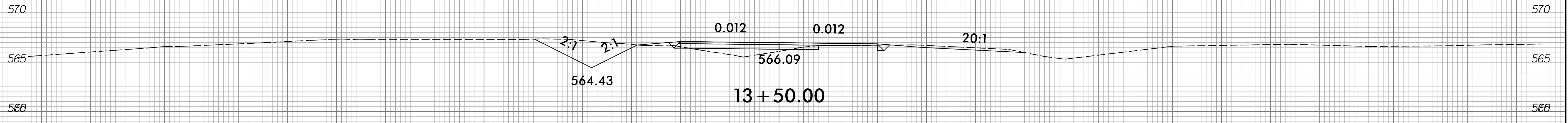
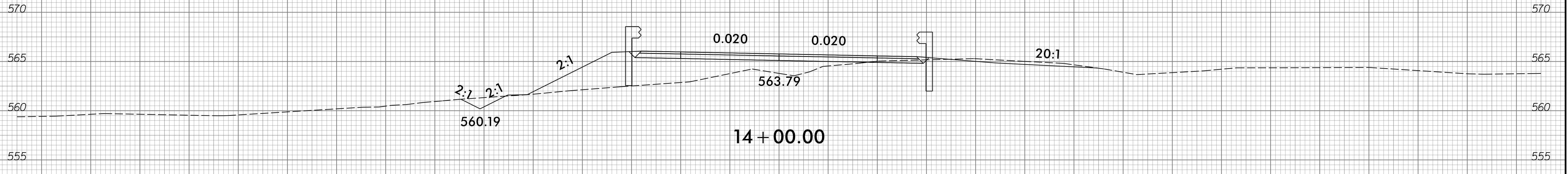
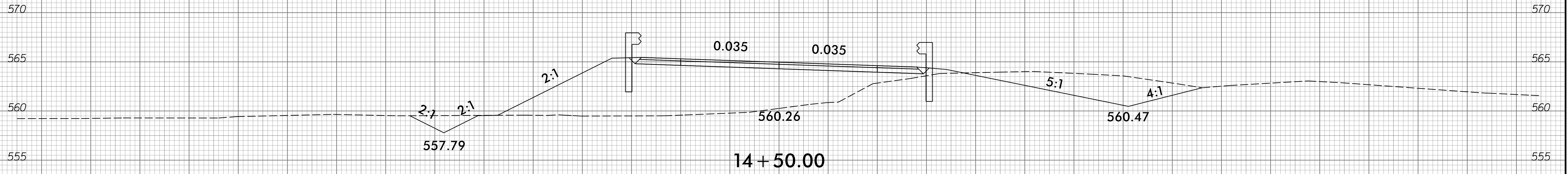

75 70 65 60 55 50 45 40 35 30 25 20 15 10 5 0 5 10 15 20 25 30 35 40 45 50 55 60 65 70 75

I:\9\2017\01\FA\8522-06\CADD\B5374\Roadway\Corridor-Model\ing_b5374_r.dwg_xpl.dgn
 User: jman

6/23/16



PROJ. REFERENCE NO.
B-5374

SHEET NO.
X-3

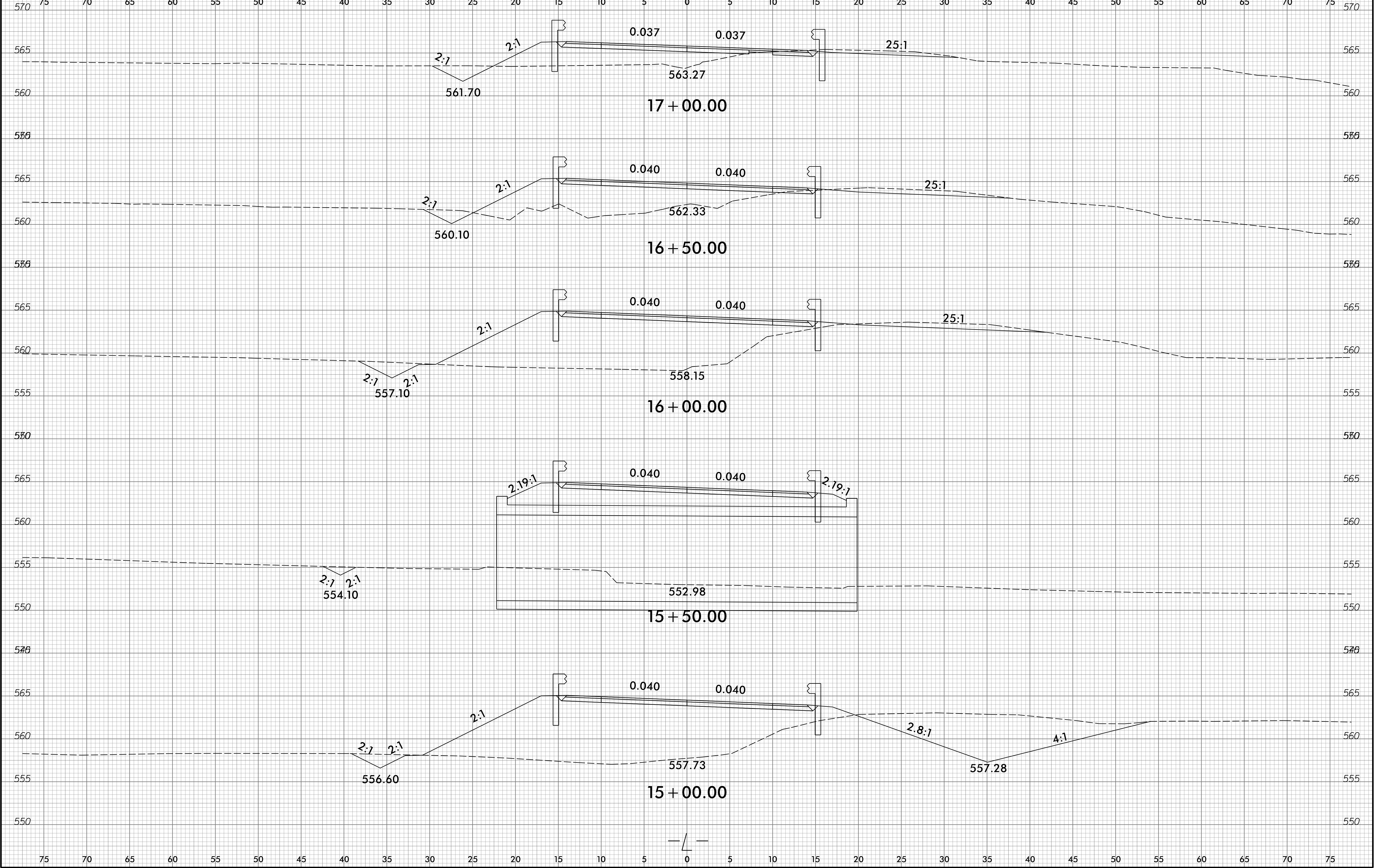

I:\9\2017\01\FA\8522-06\CADD\B5374\Roadway\Corridor-Model\ing_b5374_r.dwg_xpl.dgn

6/23/16



PROJ. REFERENCE NO.
B-5374

SHEET NO.
X-4

75 70 65 60 55 50 45 40 35 30 25 20 15 10 5 0 5 10 15 20 25 30 35 40 45 50 55 60 65 70 75

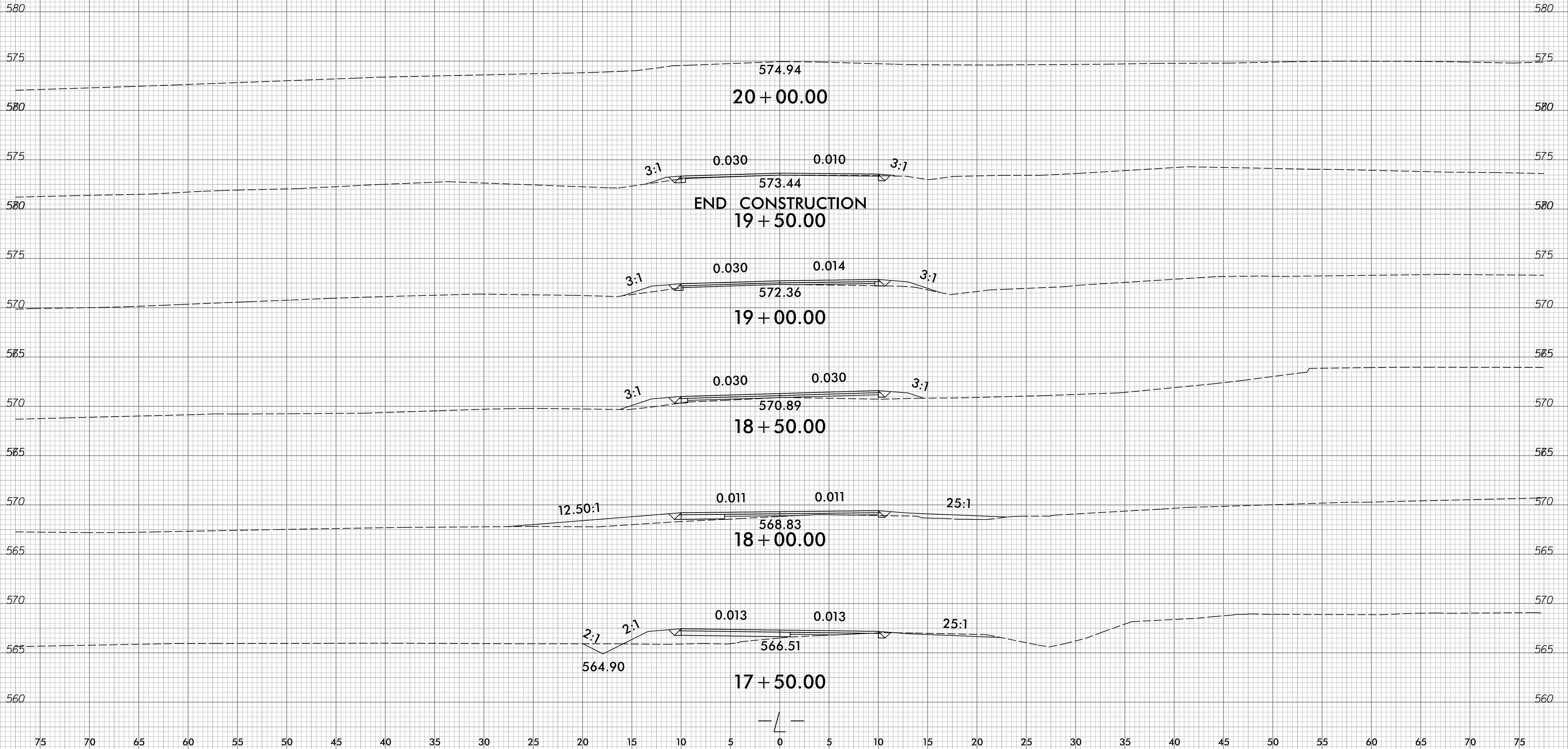

I:\9\2017\01\FA\8522-06\CADD\B5374\Roadway\Corridor-Model\ing_b5374_rdy_xpl.dgn

75 70 65 60 55 50 45 40 35 30 25 20 15 10 5 0 5 10 15 20 25 30 35 40 45 50 55 60 65 70 75