

09/08/99

See Sheet 1A For Index of Sheets
 See Sheet 1B For Conventional Symbols
 See Sheet 1C-1 & 1C-2 For Survey Control Sheets

STATE OF NORTH CAROLINA
 DIVISION OF HIGHWAYS

YANCEY COUNTY

**LOCATION: REPLACE BRIDGE 3 OVER POSSUM TROT CREEK
 ON SR 1128**
TYPE OF WORK: GRADING, PAVING, DRAINAGE AND CULVERT

STATE	STATE PROJECT REFERENCE NO.	SHEET NO.	TOTAL SHEETS
N.C.	B-4848	1	
STATE PROJ. NO.	F.A. PROJ. NO.	DESCRIPTION	
38618.1.1	BRZ-1128(7)	PE	
38618.1.2		RW & UTILITIES	
38618.3.1		CONST	



TIP PROJECT: B-4848

CONTRACT: C204011

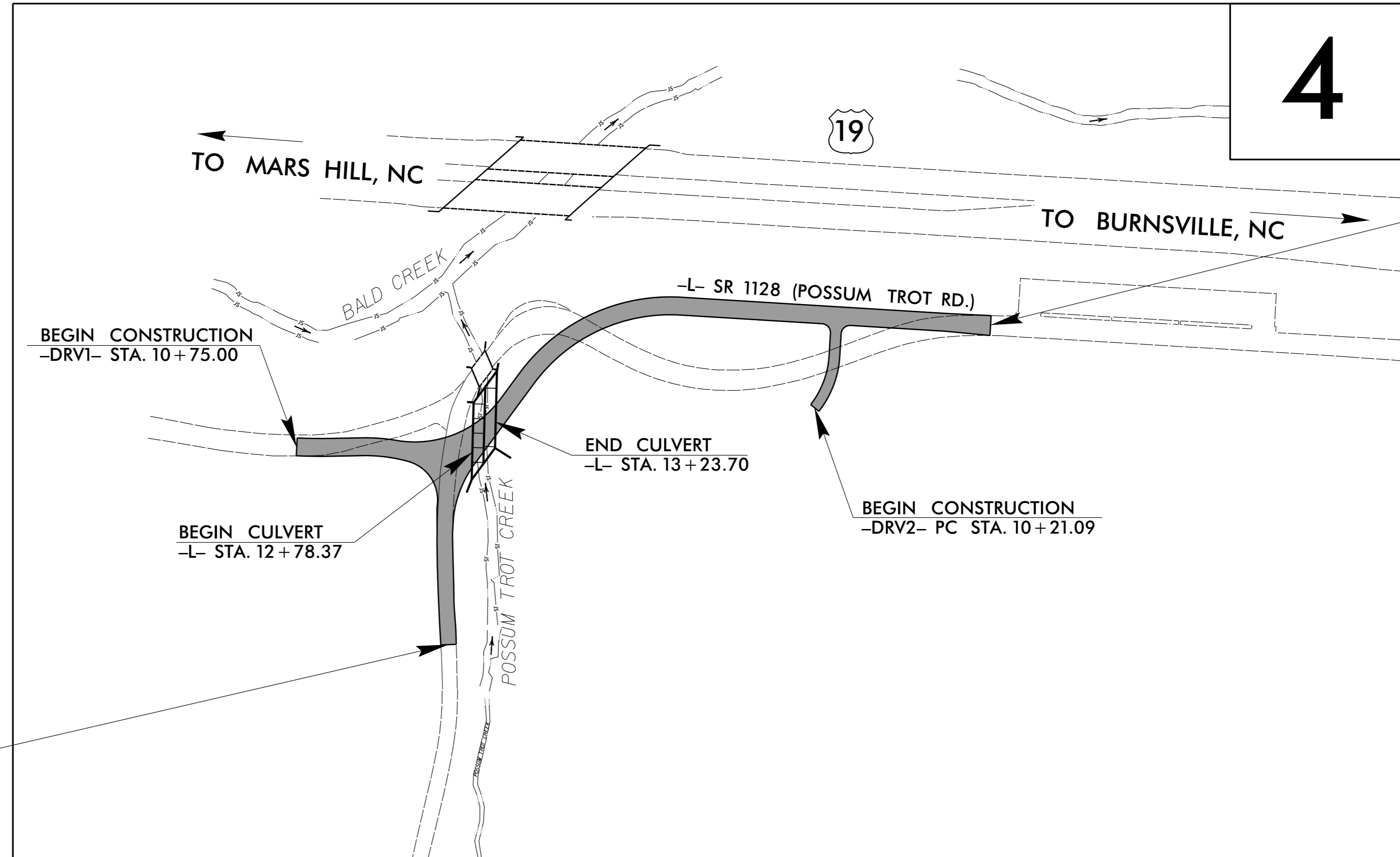
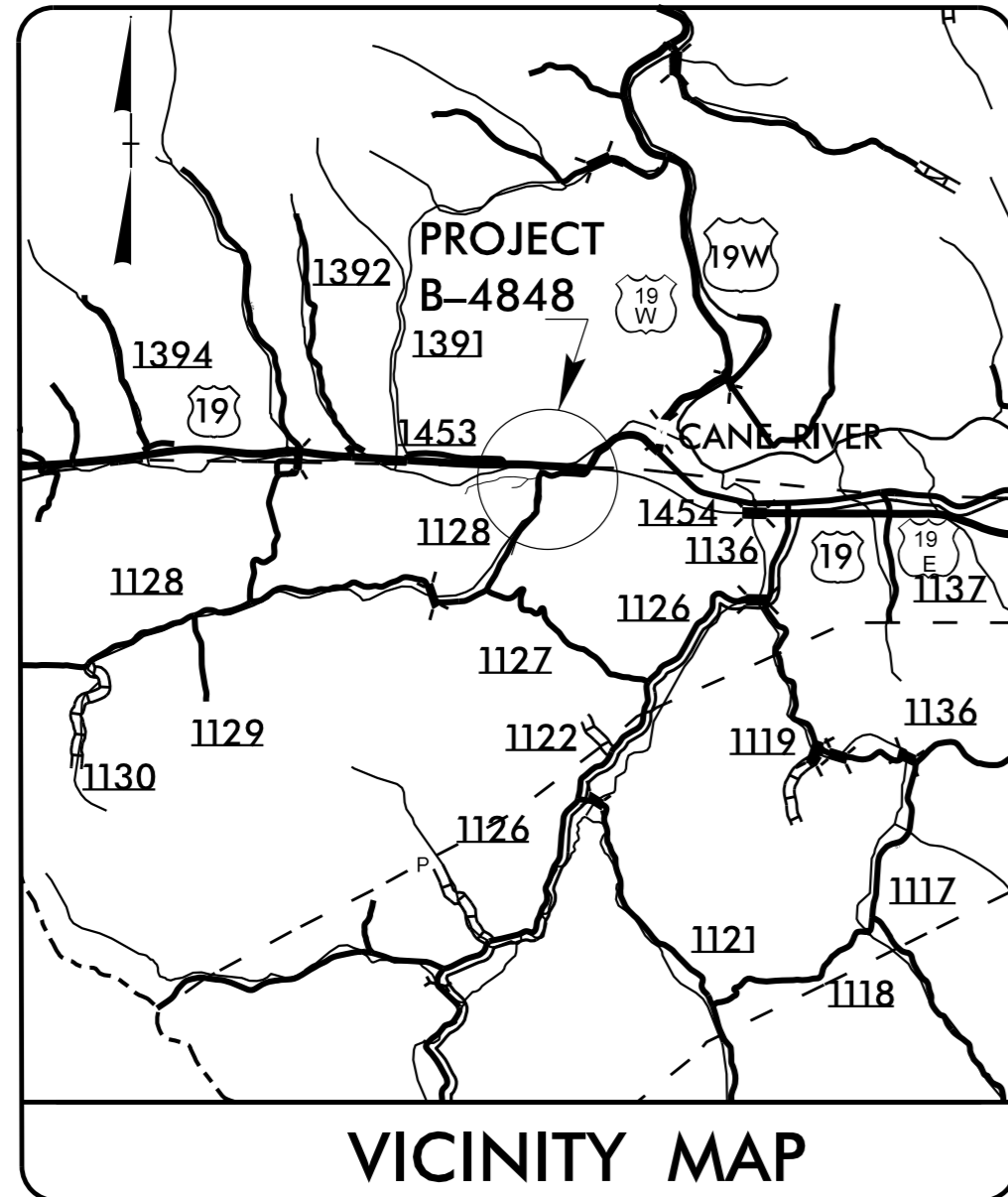

END TIP PROJECT B-4848
 -L- STA. 19+25.00

BEGIN TIP PROJECT B-4848
 -L- STA. 10+50.00



DOCUMENT NOT CONSIDERED FINAL
 UNLESS ALL SIGNATURES COMPLETED

GRAPHIC SCALES

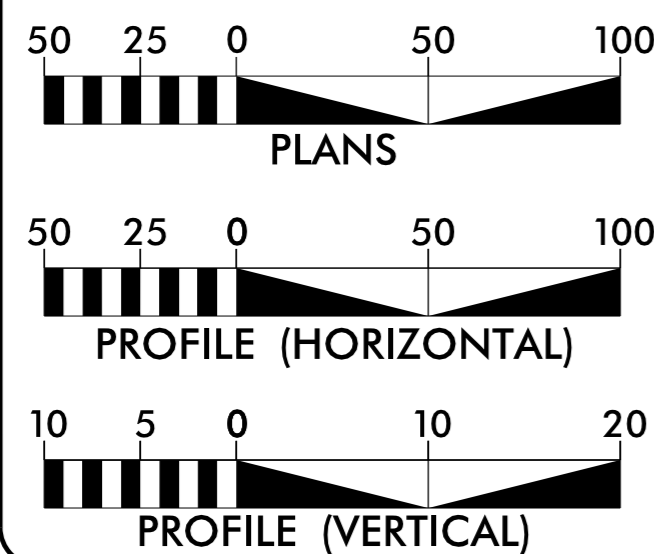

DESIGN DATA

ADT 2018 = 1274
 ADT 2040 = 1600
 K = 10 %
 D = 55 %
 T = 10 % *
 V = 25 MPH
 * TTST 1% DUAL 9%
 FUNC CLASS = LOCAL
 SUBREGIONAL TIER

PROJECT LENGTH

LENGTH OF ROADWAY TIP NO. B-4848 = 0.158 MILE
 LENGTH OF STRUCTURE TIP NO. B-4848 = 0.008 MILE
 TOTAL LENGTH OF TIP NO. B-4848 = 0.166 MILE

Prepared in the Office of:
DIVISION OF HIGHWAYS
 1000 Birch Ridge Dr., Raleigh NC, 27610

2018 STANDARD SPECIFICATIONS

RIGHT OF WAY DATE:
 JANUARY 26, 2017

LETTING DATE:
 JANUARY 16, 2018

KEVIN E. MOORE, PE
 PROJECT ENGINEER

BRYAN KEY, PE
 PROJECT DESIGN ENGINEER

HYDRAULICS ENGINEER

DocuSigned by:
Trenton J. Corrier
 BAE073A858A4428
 11/16/2017

SIGNATURE:

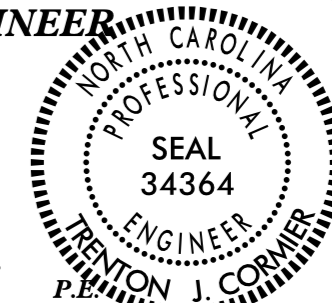

ROADWAY DESIGN ENGINEER

DocuSigned by:
Bryan C. Key
 328038A94F124FC...
 11/17/2017

SIGNATURE:

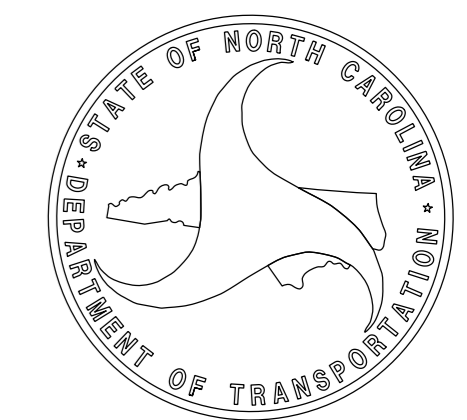
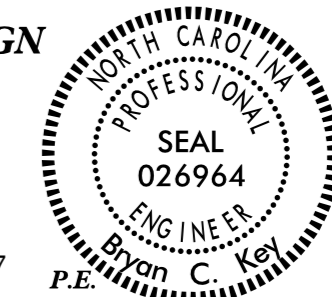

12-OCT-2017 15:03
 R:\Roadway\Proj\B4848_Rdy_tsh.dgn
 \$\$\$USERNAME\$\$\$