

8/17/99

PROJECT REFERENCE NO. R-2707F	SHEET NO. 24
ROADWAY DESIGN ENGINEER	HYDRAULICS ENGINEER
DOCUMENT NOT CONSIDERED FINAL UNLESS ALL SIGNATURES COMPLETED	

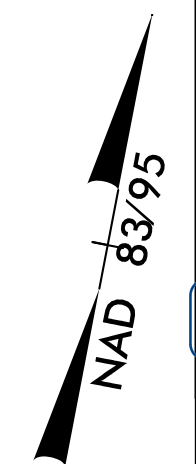

WAL-MART STORES EAST, LP
 DB 1359 PG 1800

MATCH LINE -L- STA 321+00
SEE SHEET 23

MATCH LINE -L- STA 334+00
SEE SHEET 25

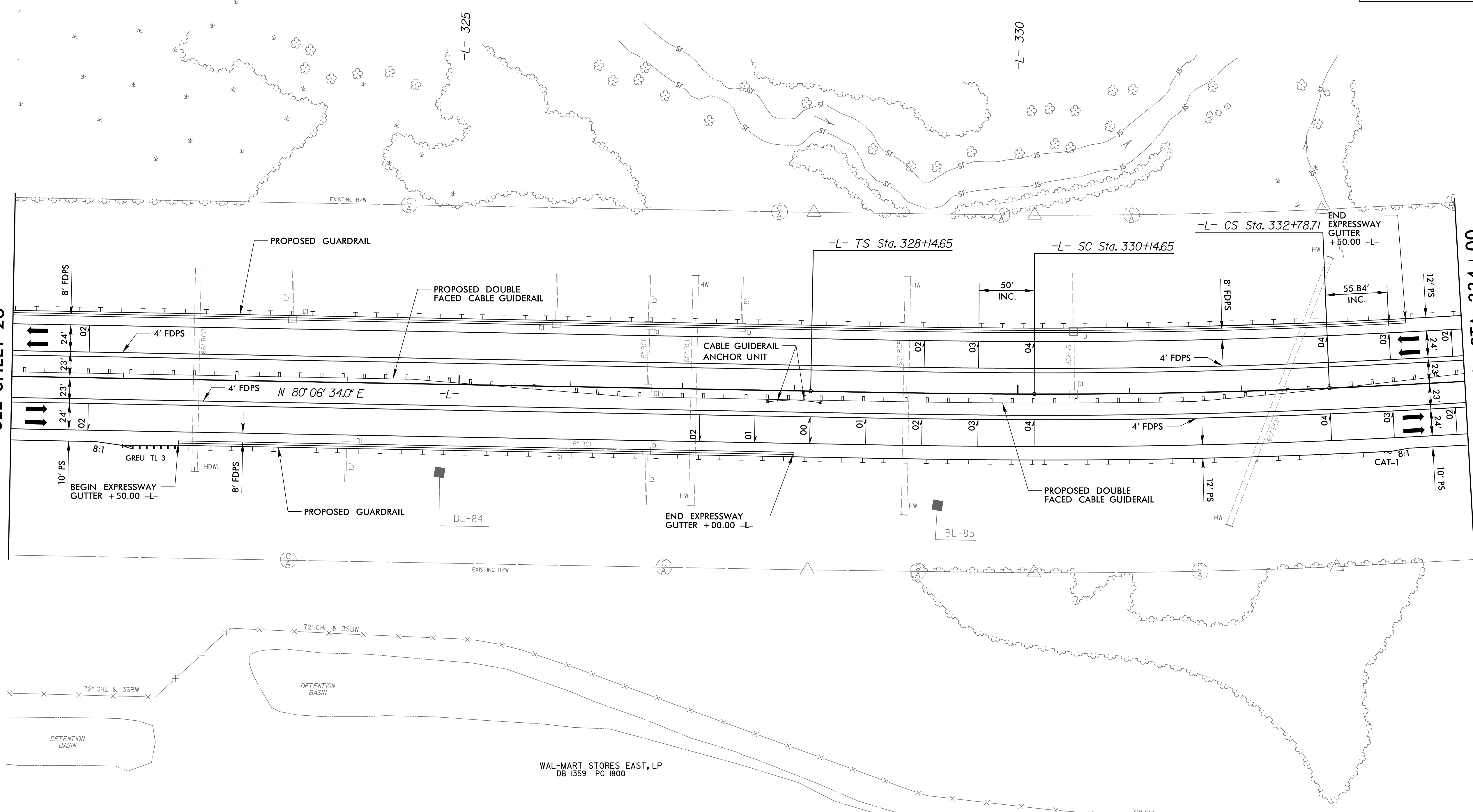

WAL-MART STORES EAST, LP
 DB 1359 PG 1800

-L-

PIs Sta 329+47.99	PI Sta 331+46.70	PIs Sta 333+45.38
$\Theta_s = 0^\circ 57' 17.7''$	$\Delta = 2^\circ 31' 17.8''$ (LT)	$\Theta_s = 0^\circ 57' 17.8''$
$L_s = 200.00'$	$D = 0^\circ 57' 17.7''$	$L_s = 200.00'$
$LT = 133.34'$	$L = 264.06'$	$LT = 133.34'$
$ST = 66.67'$	$T = 132.05'$	$ST = 66.67'$
	$R = 6,000.00'$	
	$DS = 70$ MPH	
	$e = .04$	

FOR -L- PROFILE, SEE SHEET 40

REVISIONS

08-DEC-2017 13:48
 N:\Roadway\Proje\172707F_rdy_psh24.dgn
 HNTB