

8/17/99

PROJECT REFERENCE NO. R-2707F	SHEET NO. 17
ROADWAY DESIGN ENGINEER	HYDRAULICS ENGINEER
DOCUMENT NOT CONSIDERED FINAL UNLESS ALL SIGNATURES COMPLETED	

-LPB-
 Pls Sta 12+03.91 PI Sta 15+59.00
 $\theta_s = 34^{\circ}22'38.9''$ $\Delta = 92^{\circ}01'34.7''$ (RT)
 $L_s = 300.00'$ $D = 22^{\circ}55'05.9''$
 $LT = 203.91'$ $L = 401.54'$
 $ST = 103.56'$ $T = 259.00'$
 $V = 30$ MPH $R = 250.00'$
 $e = .08$ $V = 30$ MPH
 $e = .08$

-RPB-
 Pls Sta 12+00.18 PI Sta 14+91.88 Pls Sta 17+80.39
 $\theta_s = 7^{\circ}30'00.0''$ $\Delta = 19^{\circ}00'40.8''$ (LT) $\theta_s = 7^{\circ}30'00.0''$
 $L_s = 300.00'$ $D = 5^{\circ}00'00.0''$ $L_s = 300.00'$
 $LT = 200.18'$ $L = 380.23'$ $LT = 200.18'$
 $ST = 100.16'$ $T = 191.88'$ $ST = 100.16'$
 $DS = 50$ MPH $R = 1,145.92'$ $DS = 50$ MPH
 $e = .08$ $DS = 50$ MPH $e = .08$

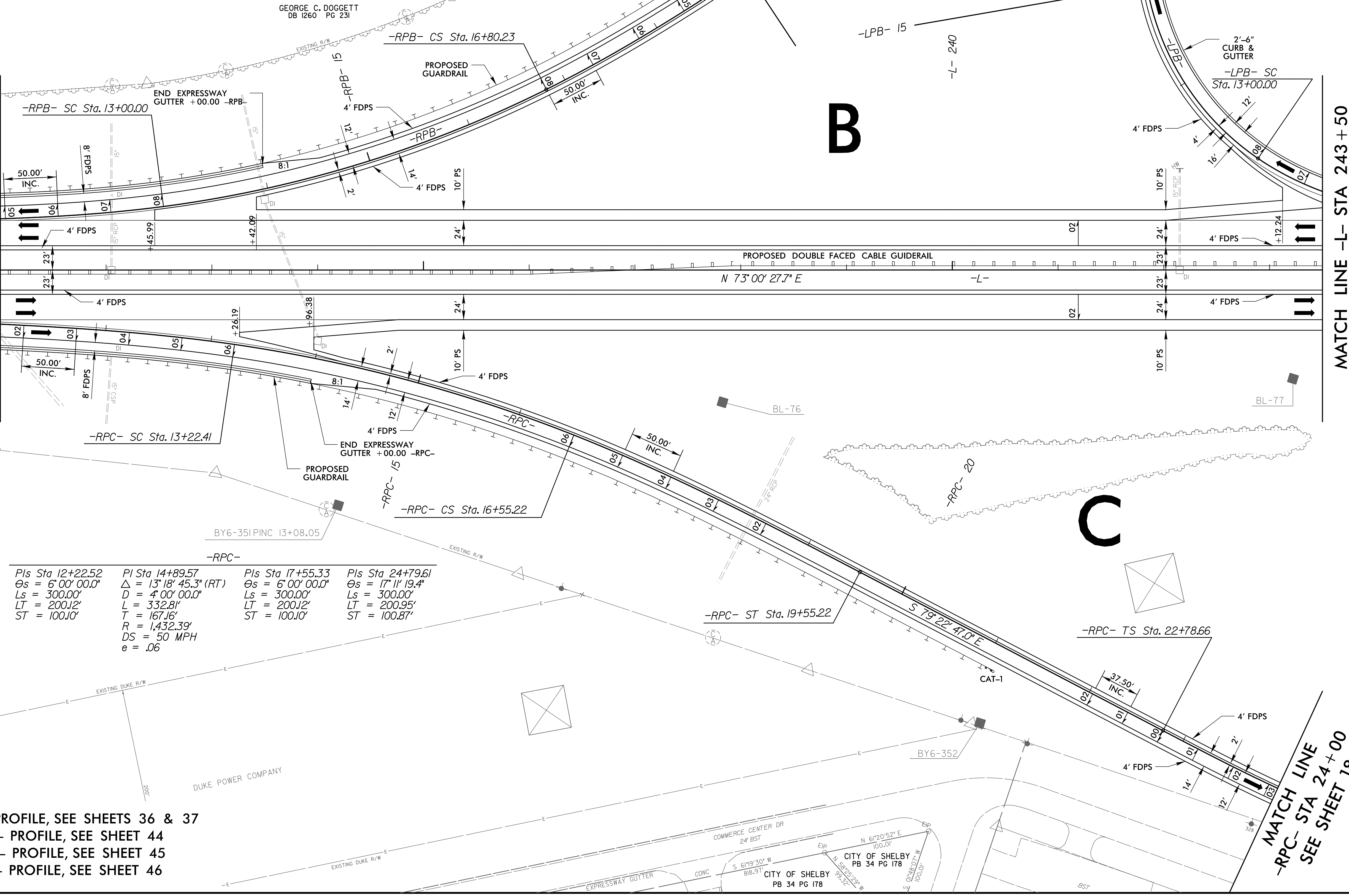

MATCH LINE -L- STA 231+00
SEE SHEET 16

MATCH LINE -RPB- STA 19+00
SEE SHEET 28

MATCH LINE -LPB- STA 15+00
SEE SHEET 28

MATCH LINE -L- STA 243+50
SEE SHEET 18

-RPC-
 Pls Sta 12+22.52 PI Sta 14+89.57 Pls Sta 17+55.33 Pls Sta 24+79.61
 $\theta_s = 6^{\circ}00'00.0''$ $\Delta = 13^{\circ}18'45.3''$ (RT) $\theta_s = 6^{\circ}00'00.0''$ $\theta_s = 17^{\circ}11'19.4''$
 $L_s = 300.00'$ $D = 4^{\circ}00'00.0''$ $L_s = 300.00'$ $L_s = 300.00'$
 $LT = 200.12'$ $L = 332.81'$ $LT = 200.12'$ $LT = 200.95'$
 $ST = 100.10'$ $T = 167.16'$ $ST = 100.10'$ $ST = 100.87'$
 $R = 1,432.39'$
 $DS = 50$ MPH
 $e = .06$

FOR -L- PROFILE, SEE SHEETS 36 & 37
 FOR -RPB- PROFILE, SEE SHEET 44
 FOR -RPC- PROFILE, SEE SHEET 45
 FOR -LPB- PROFILE, SEE SHEET 46

08-DEC-2017 13:48
 (P:\oadway\Proj\R2707F_rdy_psh17.dgn
 HNTB