

NOTE: OVERHANG DIAPHRAGMS TO BE REMOVED AND REPLACED, ARE SHOWN ON "PLAN OF SPAN" SHEETS. OVERHANG DIAPHRAGMS SHALL BE REMOVED PRIOR TO CLEANING AND PAINTING OF BEAMS AND REPLACED AFTER BEAM REPAIRS AND PAINTING ARE COMPLETE.

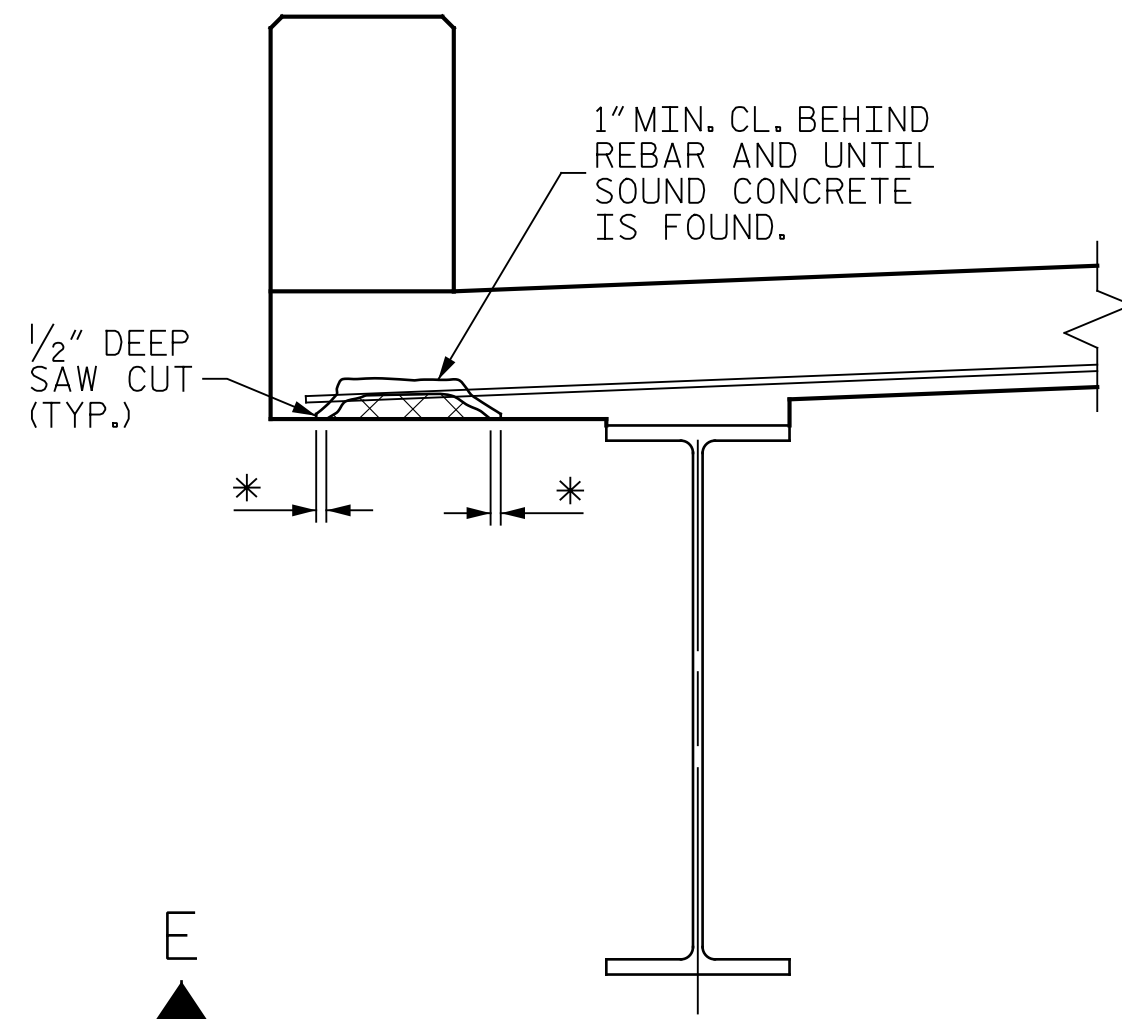

TYPICAL SECTION

DAMAGED AREA * REMOVE CONCRETE UNTIL SOUND CONCRETE IS FOUND (1" MIN. DEPTH)

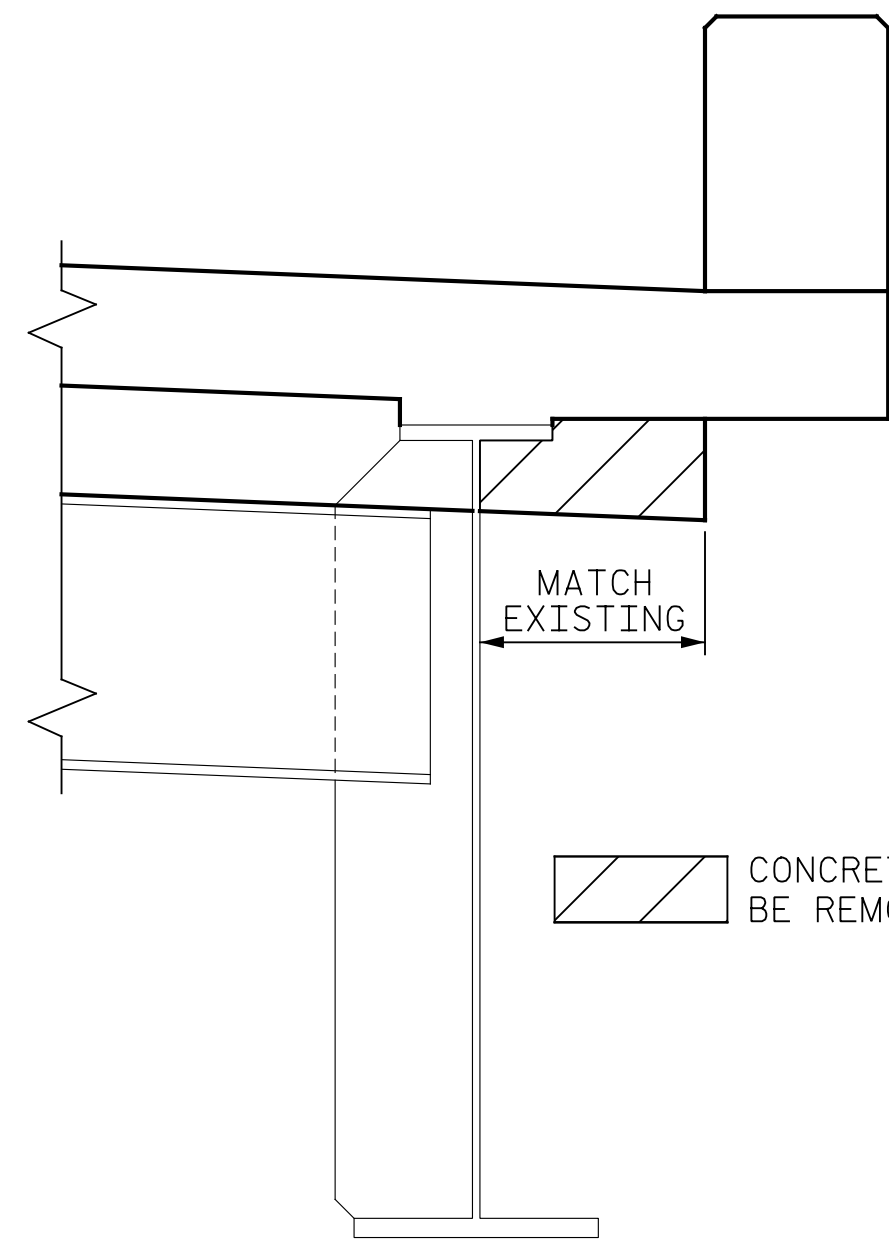

TYPICAL SECTION

CONCRETE IN THIS AREA SHALL BE REMOVED AND REPLACED

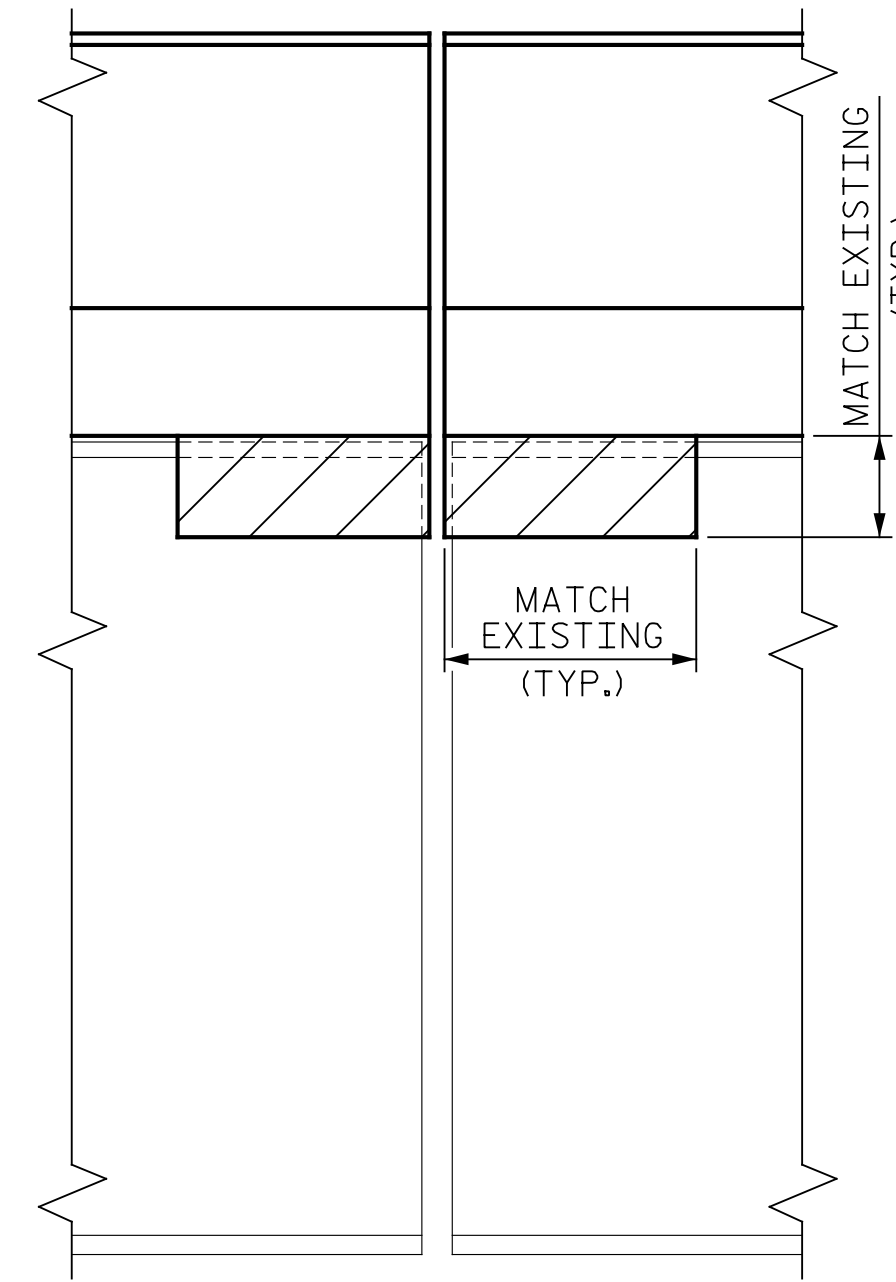

SECTION D-D

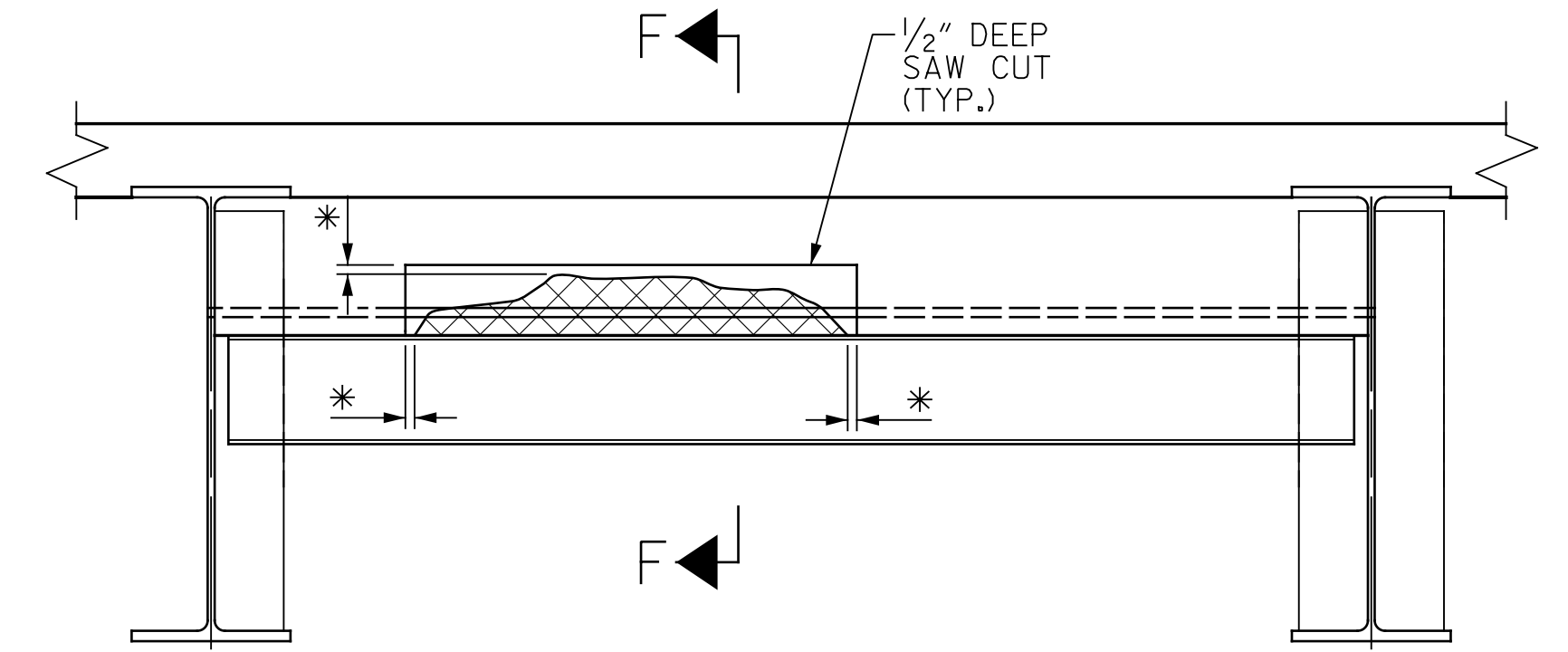

TYPICAL SECTION

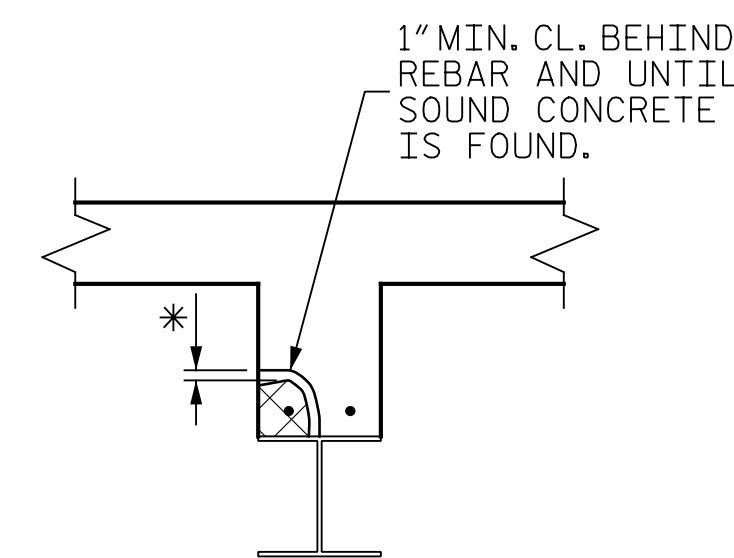

SECTION F-F

* REMOVE CONCRETE UNTIL SOUND CONCRETE IS FOUND (1" MIN. DEPTH)

DAMAGED AREA

NOTE: EXISTING REBAR TO REMAIN IN PLACE. CLEAN AND REPAIR AS NECESSARY.

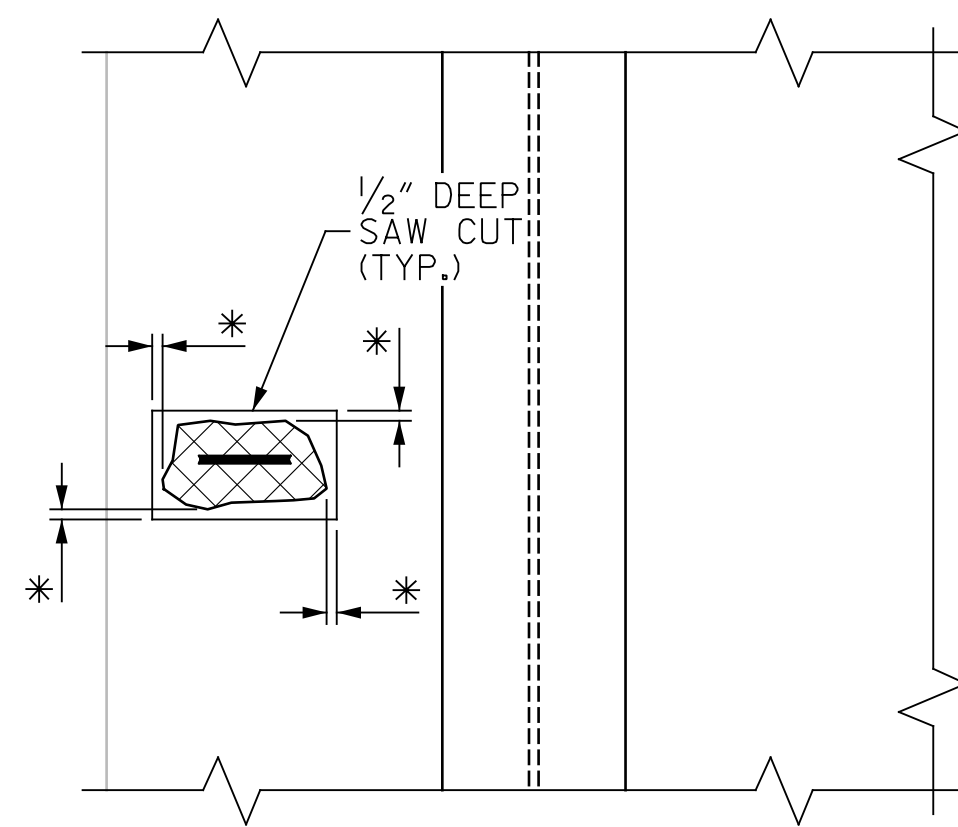

SECTION E-E

OVERHANG DETAILS

OVERHANG DIAPHRAGM REPLACEMENT DETAILS

INTERIOR DIAPHRAGM REPAIR DETAILS

PROJECT NO. I-5889A
BUNCOMBE COUNTY
 BRIDGE NO. 334, 339, 344, 347,
352, 356, 358, 366,
369, 374, 377, 378



DocuSigned by:
Eric B. Nelson
 11/20/2017
 BA9F918207044A

STATE OF NORTH CAROLINA
 DEPARTMENT OF TRANSPORTATION
 RALEIGH

OVERHANG & DIAPHRAGM
 REPAIR DETAILS

DRAWN BY : J. BOYER DATE : 10/17
 CHECKED BY : R. NELSON DATE : 10/17

PLANS PREPARED BY:

 Suite 102
 2610 Wycliff Road
 Raleigh, NC 27607-3073
 (919) 420-7660
 Excellence Delivered As Promised NC Lic. No. F-0270

DOCUMENT NOT CONSIDERED
 FINAL UNLESS ALL
 SIGNATURES COMPLETED

REVISIONS						SHEET NO.
NO.	BY:	DATE:	NO.	BY:	DATE:	S-206
1			3			TOTAL SHEETS 208
2			4			