

**NOTES:**

REPAIR LOCATIONS AND ESTIMATE OF QUANTITIES ARE GIVEN WITH THE BEST INFORMATION AVAILABLE. IF ADDITIONAL REPAIRS NOT SHOWN ON THE DRAWINGS ARE DEEMED NECESSARY BY THE INSPECTOR OR ENGINEER THE CONTRACTOR SHALL NOTE ON THE DRAWINGS THE APPROXIMATE LOCATION AND DESCRIPTION OF THE REPAIRS AND ADJUST THE ACTUAL QUANTITIES ENTERED INTO THE REPAIR QUANTITY TABLE.

SHOTCRETE REPAIRS MAY BE REPLACED WITH CONCRETE REPAIRS WITH THE APPROVAL OF THE ENGINEER.

FOR SHOTCRETE REPAIRS, SEE SPECIAL PROVISIONS.

FOR CONCRETE REPAIR DETAILS, SEE "TYPICAL CAP & COLUMN REPAIR DETAILS" SHEET.

SPAN A

SPAN B

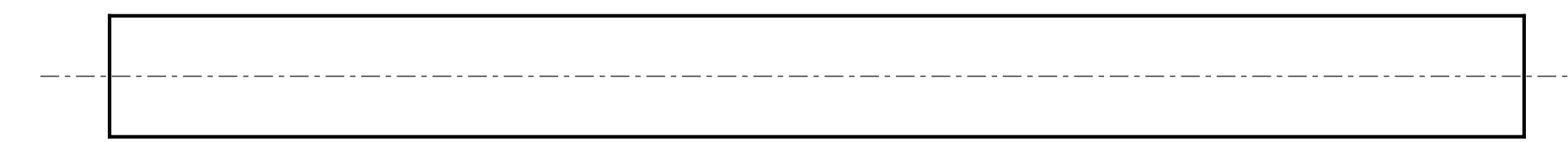

BOTTOM OF CAP

- SHOTCRETE REPAIR

- CONCRETE REPAIR

3.4 SF. SHOTCRETE REPAIR

13.0 SF. SHOTCRETE REPAIR

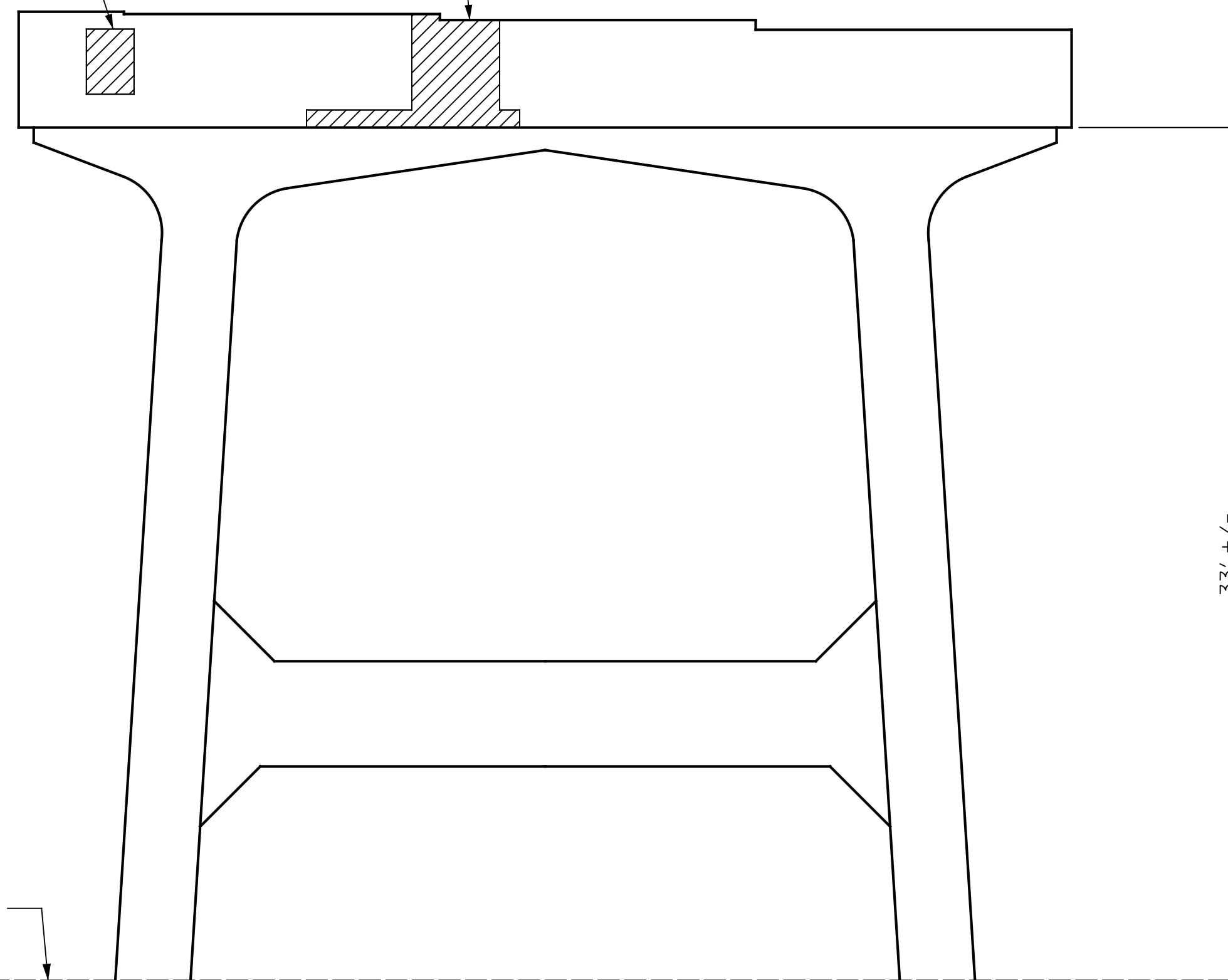

33' +/-

APPROX. EXISTING GROUND

APPROX. EXISTING GROUND

END VIEW  
(SOUTH FACE)

SPAN B  
(EAST FACE)

BENT 1  
(SPAN B SIDE)

PROJECT NO. I-5889A  
BUNCOMBE COUNTY  
BRIDGE NO. 356



DocuSigned by:  
*Eric B. Nelson*  
11/16/2017

STATE OF NORTH CAROLINA  
DEPARTMENT OF TRANSPORTATION  
RALEIGH

BENT 1  
SPAN B SIDE

REVISIONS

NO.	BY:	DATE:	NO.	BY:	DATE:	SHEET NO.
1			3			S-73
2			4			TOTAL SHEETS 208

DRAWN BY : M.A. LEE DATE : 9/2017  
CHECKED BY : R.F. WERTMAN DATE : 10/2017

PLANS PREPARED BY:  
 **Gannett Fleming**  
2610 Wycliff Road  
Suite 102  
Raleigh, NC 27607-3073  
(919) 420-7660  
Excellence Delivered *As Promised* [NC Lic. No. F-0270]

DOCUMENT NOT CONSIDERED FINAL UNLESS ALL SIGNATURES COMPLETED