

TIP NO. U-5315 A&B	SHEET NO. SIGN-14
APPROVED: _____	
DATE: _____	
SEAL	
<small>DocuSigned by: Barry Brandt 11/13/2017</small>	
DOCUMENT NOT CONSIDERED FINAL UNLESS ALL SIGNATURES COMPLETED	

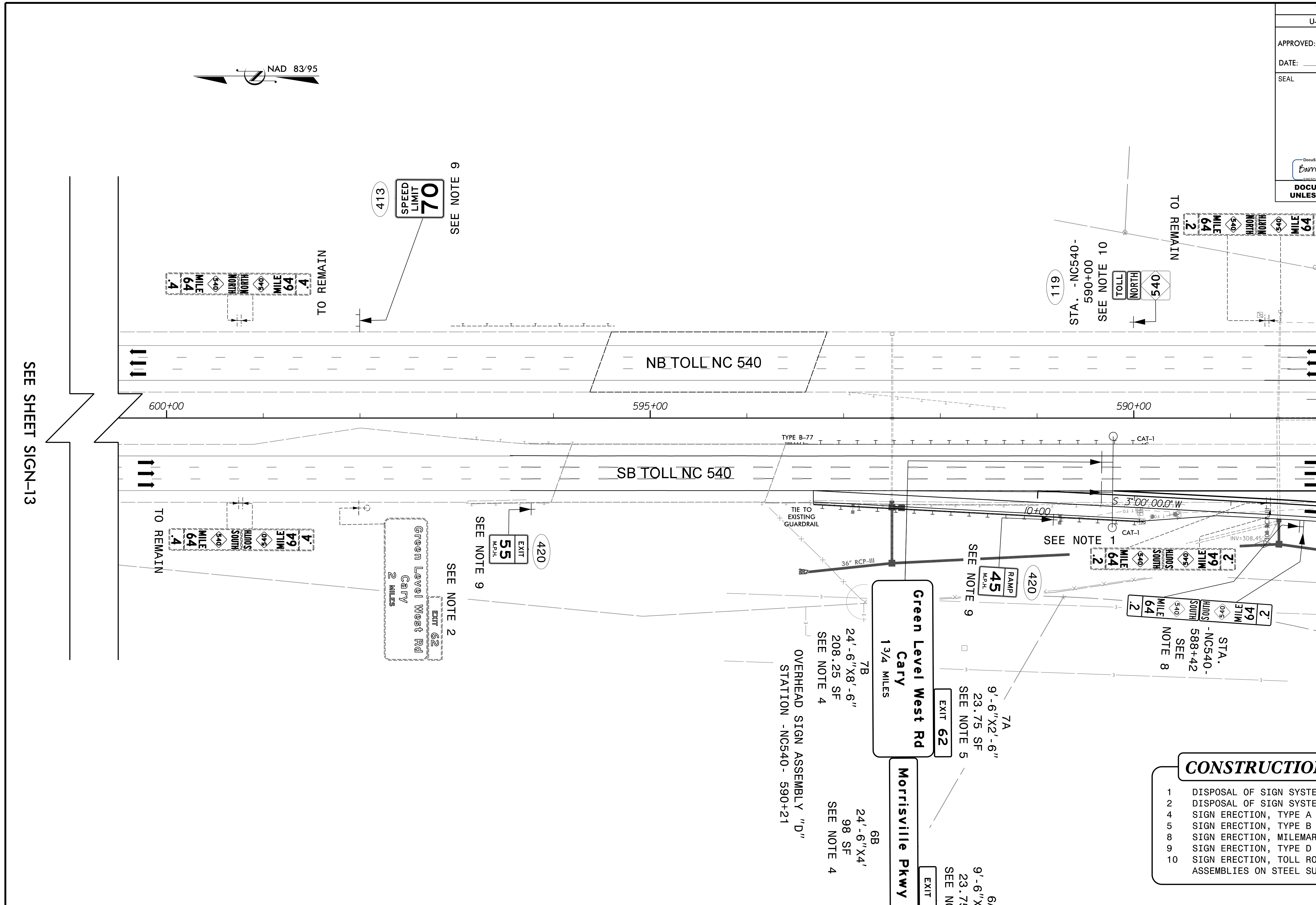

- CONSTRUCTION NOTES**
- DISPOSAL OF SIGN SYSTEM, U-CHANNEL
 - DISPOSAL OF SIGN SYSTEM, OVERHEAD
 - SIGN ERECTION, TYPE A (OVERHEAD)
 - SIGN ERECTION, TYPE B (OVERHEAD)
 - SIGN ERECTION, MILEMARKERS
 - SIGN ERECTION, TYPE D OR E
 - SIGN ERECTION, TOLL ROUTE SIGN ASSEMBLIES ON STEEL SUPPORTS

PLANS PREPARED BY :

 RUMMEL, KLEPPER & KAHL, LLP
 900 RIDGEFIELD DRIVE SUITE 350
 RALEIGH, NORTH CAROLINA 27609-3960
 NC LICENSE NO. F-0112 (919) 878-9560
 FOR
**THE NORTH CAROLINA
 TURNPIKE AUTHORITY**

**EXISTING AND
 PROPOSED SIGNS
 STA. -NC540-
 600+50 TO 588+00**

10/13/2017
 R:\Tref\c\Signing\CADD\Signing_Layout_Plans\Pages\5315_sgn_14.dgn
 NUM