

PROJ. REFERENCE NO.	SHEET NO.
R-5703	TMP-6B

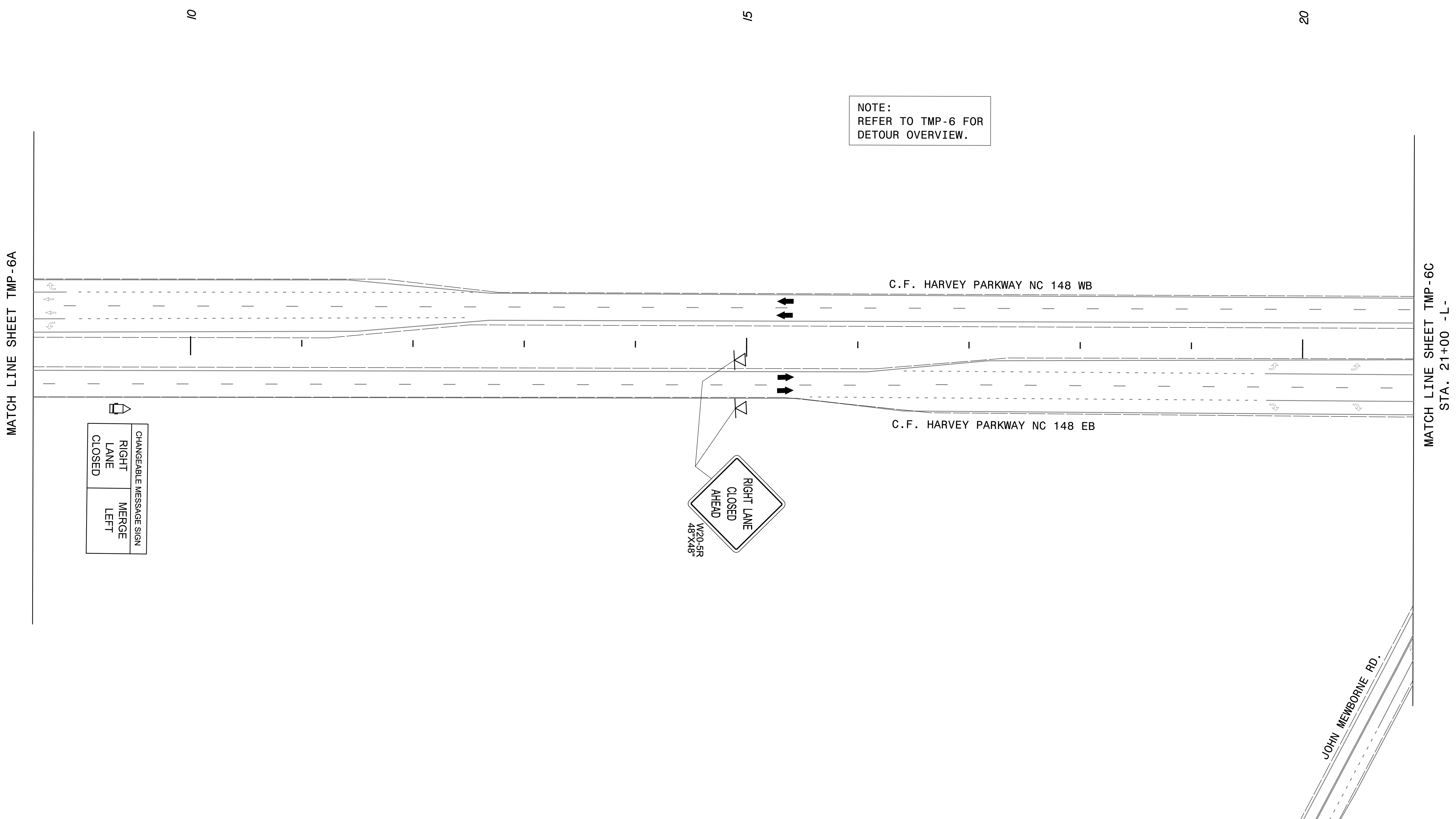

CHANGEABLE MESSAGE SIGN
RIGHT LANE CLOSED
MERGE LEFT

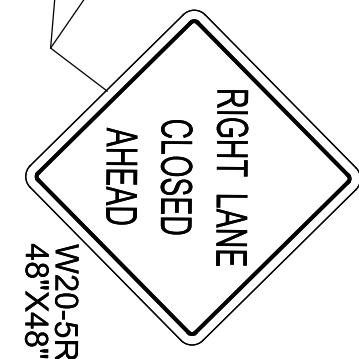

NOTE:
REFER TO TMP-6 FOR
DETOUR OVERVIEW.

9/14/2017
R:\TrafficControl\TMP PLAN SHEETS\NR-5703 TMP 06B PHASE 03 STEP 01 & 02.dgn
bir-git.mackenzie

Michael Baker
INTERNATIONAL
8000 Regency Parkway, Suite 600,
Cary, NC 27518
Phone: (919) 463-5488
MBAKERINTL.COM

DOCUMENT NOT CONSIDERED FINAL UNLESS ALL SIGNATURES COMPLETED

SEAL



PHASE III
STEPS 1 & 2